

FINAL SURVEY	BY	DATE
SURVEYED		
PLOTTED		
NOTE BOOK		
NO.		

ORIGINAL SURVEY	BY	DATE
SURVEYED		
PLOTTED		
NOTE BOOK		
NO.		

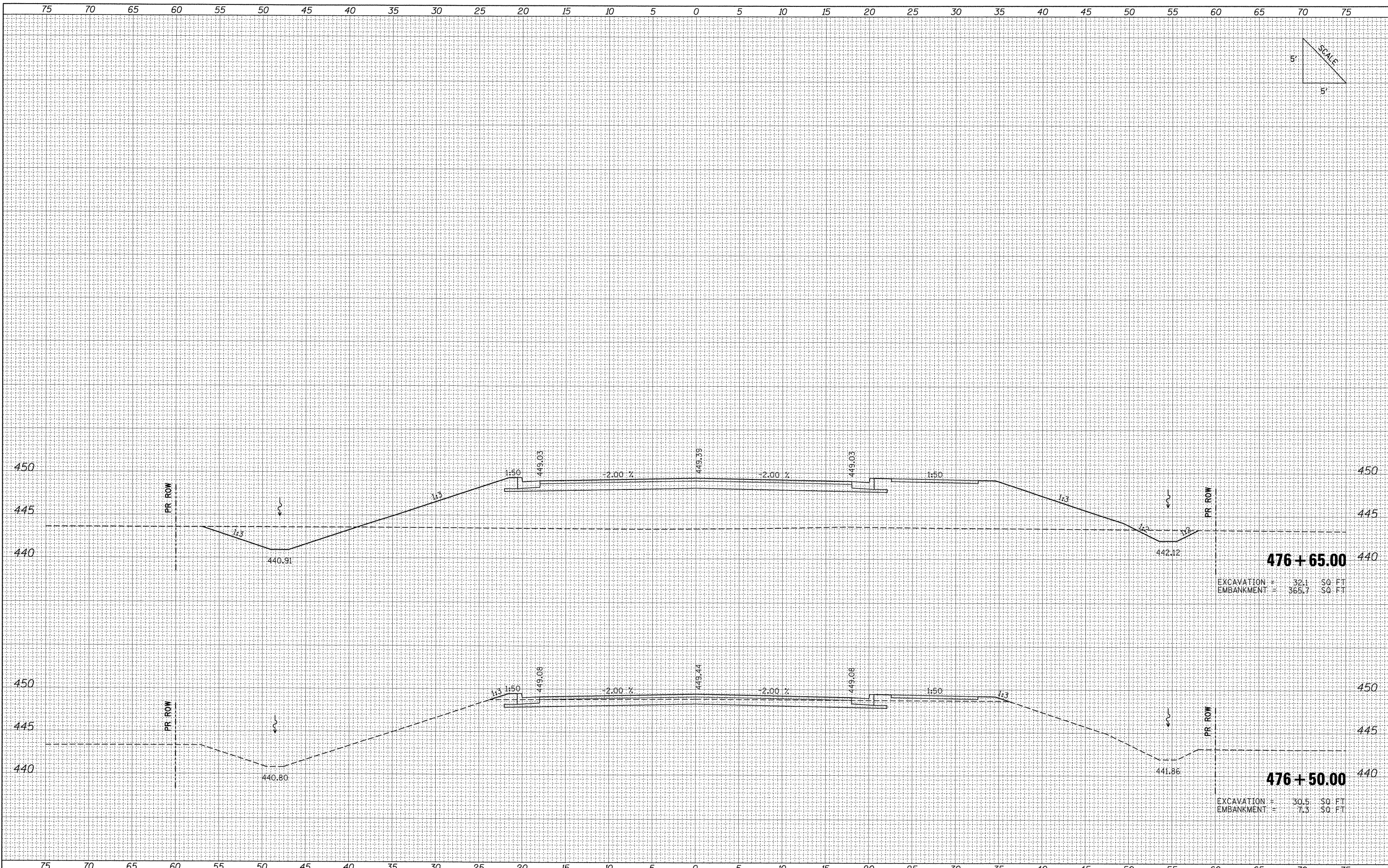
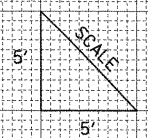

476 + 65.00
 EXCAVATION = 32.1 \$0. FT
 EMBANKMENT = 365.7 \$0. FT

476 + 50.00
 EXCAVATION = 30.5 \$0. FT
 EMBANKMENT = 7.3 \$0. FT

FILE NAME =	USER NAME = Matt Overbay	DESIGNED - BMB	REVISED -	F.A. RTE.	SECTION	COUNTY	TOTAL SHEETS	SHEET NO.
I:\dot\0906603\draw\cadd_sheets\0998859-sht-4\Frontage.dgn		DRAWN - RAH	REVISED -	331	(1X-1) VB-1, B-1, N-4, R-1	WILLIAMSON	367	338
	PLOT SCALE = 5,0000 ' / IN.	CHECKED - SPH	REVISED -	CONTRACT NO. 98859				
	PLOT DATE = 12/13/2011	DATE - 12/9/11	REVISED -	ILLINOIS FED. AID PROJECT				

**STATE OF ILLINOIS
 DEPARTMENT OF TRANSPORTATION**

**PROPOSED CROSS SECTIONS
 FRONTAGE ROAD**

SCALE: SHEET NO. OF SHEETS STA. 476+50.00 TO STA. 476+65.00