

FINAL SURVEY	BY	DATE
PLOTTED		
REVISIONS		
NOTE BOOK		
NO.		

ORIGINAL SURVEY	BY	DATE
PLOTTED		
REVISIONS		
NOTE BOOK		
NO.		

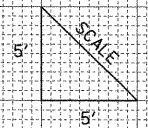
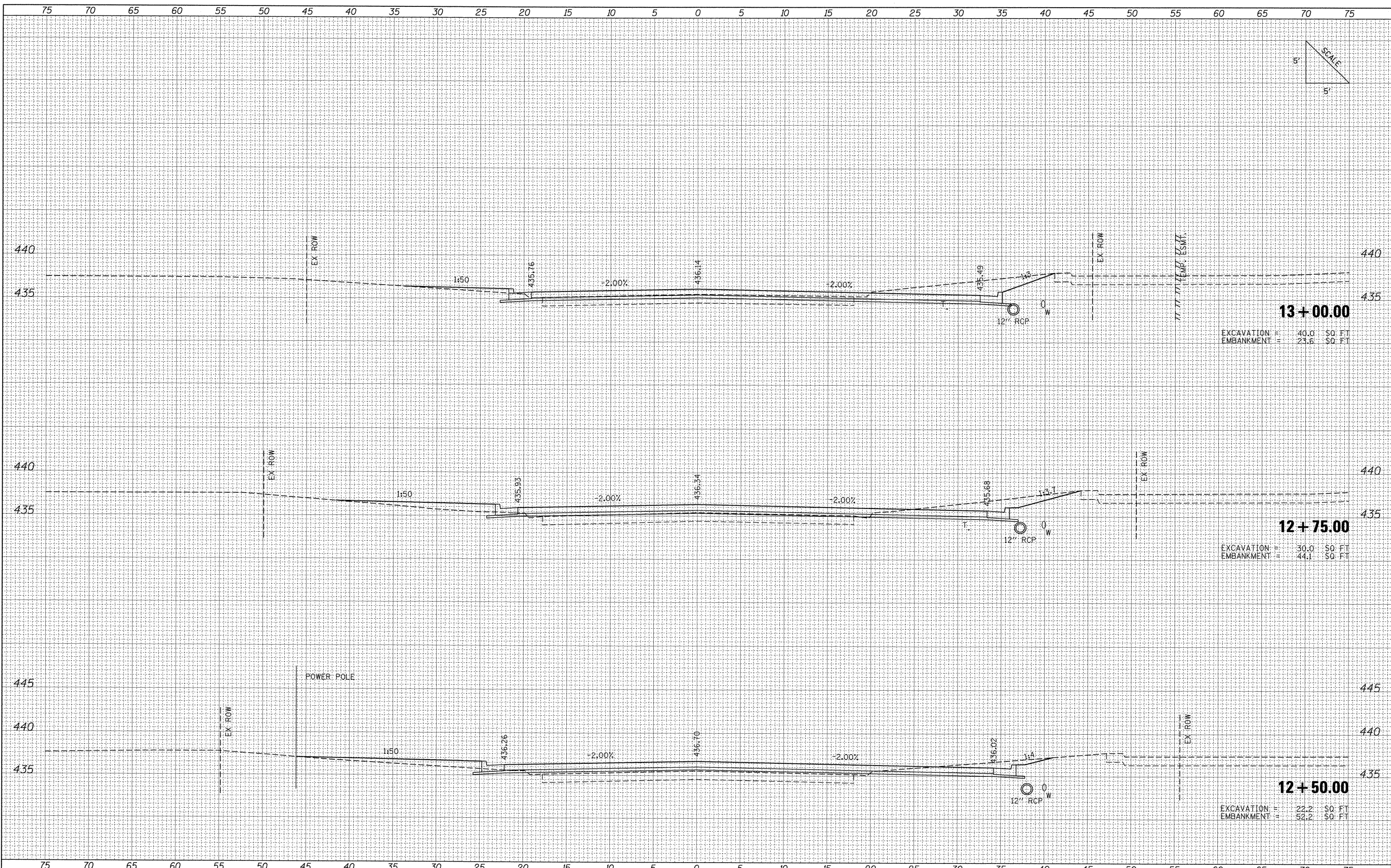

**13+00.00**  
 EXCAVATION = 40.0 SQ. FT.  
 EMBANKMENT = 23.6 SQ. FT.

**12+75.00**  
 EXCAVATION = 30.0 SQ. FT.  
 EMBANKMENT = 44.1 SQ. FT.

**12+50.00**  
 EXCAVATION = 22.2 SQ. FT.  
 EMBANKMENT = 52.2 SQ. FT.

FILE NAME =	USER NAME = Matt Overbey	DESIGNED -	REVISED -	F.A. RTE.	SECTION	COUNTY	TOTAL SHEETS	SHEET NO.
1:\dot\906603\draw\cadd\sheets\0998859-sht-x	SkylineNorth.dgn	DRAWN -	REVISED -	331	(1X-1) VB-1, B-1, N-4, R-3	WILLIAMSON	367	352
	PLOT SCALE = 5.0000' / IN.	CHECKED -	REVISED -	FED. ROAD DIST. NO.		ILLINOIS FED. AID PROJECT	CONTRACT NO. 98859	
	PLOT DATE = 12/13/2011	DATE = 12/9/11	REVISED -	SCALE: SHEET NO. OF SHEETS STA. 12+50.00 TO STA. 13+00.00				

**STATE OF ILLINOIS  
 DEPARTMENT OF TRANSPORTATION**

**PROPOSED CROSS SECTIONS  
 SKYLINE DRIVE NORTH**