

FINAL SURVEY
 SURVEYED BY: _____ DATE: _____
 NOTE BOOK NO.: _____
 TEMPLATE AREAS CHECKED: _____

ORIGINAL SURVEY
 SURVEYED BY: _____ DATE: _____
 NOTE BOOK NO.: _____
 TEMPLATE AREAS CHECKED: _____

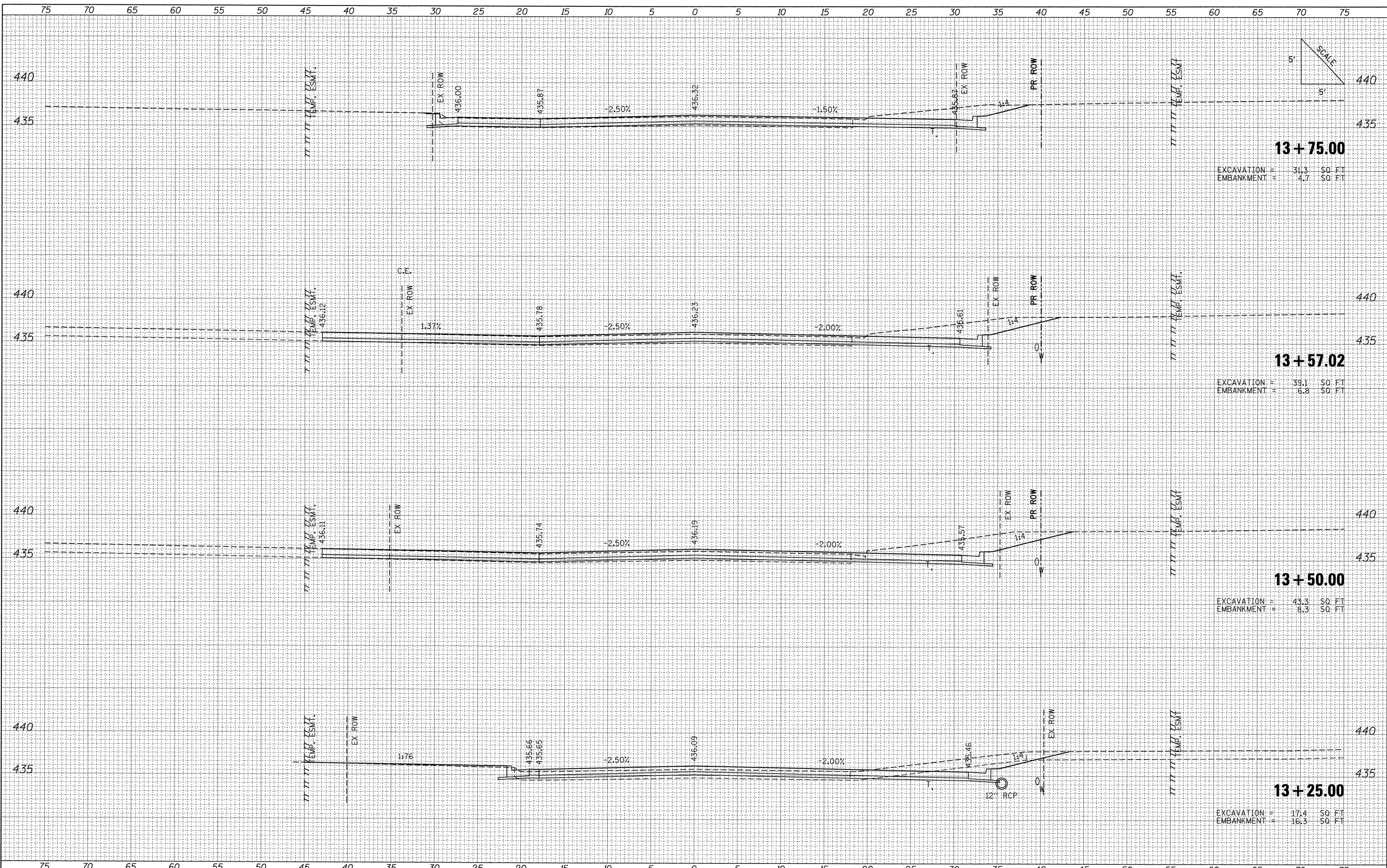

13+75.00
 EXCAVATION = 31.3 SO. FT
 EMBANKMENT = 4.7 SO. FT

13+57.02
 EXCAVATION = 39.1 SO. FT
 EMBANKMENT = 6.8 SO. FT

13+50.00
 EXCAVATION = 43.3 SO. FT
 EMBANKMENT = 8.3 SO. FT

13+25.00
 EXCAVATION = 17.4 SO. FT
 EMBANKMENT = 16.3 SO. FT

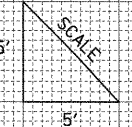

FILE NAME = I:\dot\0926603\draw\cadd\sheets\0998859-sht-x\SkylineNorth.dgn	USER NAME = Matt Overbey	DESIGNED -	REVISED -	STATE OF ILLINOIS DEPARTMENT OF TRANSPORTATION	PROPOSED CROSS SECTIONS SKYLINE DRIVE NORTH		F.A. RTE. 331	SECTION (1X-1) VB-1, B-1, N-4, R-3	COUNTY WILLIAMSON	TOTAL SHEETS 367	SHEET NO. 353
PLOT SCALE = 5.0000' / IN.	PLOT DATE = 12/13/2011	DRAWN -	REVISED -		SCALE:	SHEET NO. OF SHEETS	STA. 13+25.00 TO STA. 13+75.00	FED. ROAD DIST. NO.	ILLINOIS FED. AID PROJECT	CONTRACT NO. 98859	
		CHECKED -	REVISED -								
		DATE = 12/9/11	REVISED -								