

03-09-2018 LETTING ITEM 013

STATE OF ILLINOIS
DEPARTMENT OF TRANSPORTATION

F.A.U. RTE.	SECTION	COUNTY	TOTAL SHEETS	SHEET NO.
1320	109-I-BR	COOK	18	1
		ILLINOIS	CONTRACT NO. 62F33	

FOR INDEX OF SHEETS, SEE SHEET NO. 2

THE IMPROVEMENT IS LOCATED
IN THE VILLAGE OF HOFFMAN
ESTATES.

TRAFFIC DATA

IL 58 (GOLF RD.)
ADT (2015) = 13,400
POSTED SPEED LIMIT = 50 MPH

**PROPOSED
HIGHWAY PLANS**
F.A.U. ROUTE: 1320 - IL 58 (GOLF RD.)
AT POPLAR CREEK
SECTION: 109-I-BR
BRIDGE DECK REPAIRS /THIN POLYMER OVERLAY
COOK COUNTY
C-91-283-17

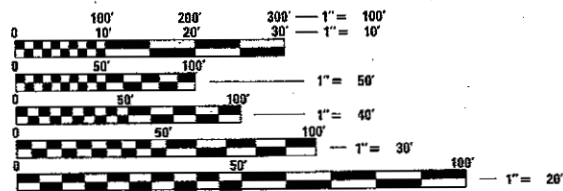
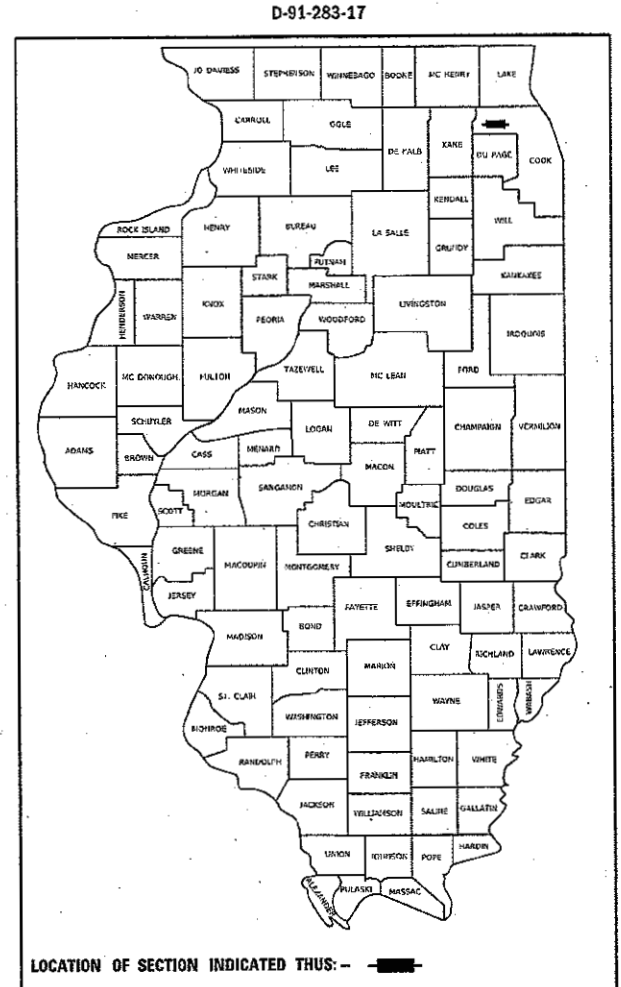

FULL SIZE PLANS HAVE BEEN PREPARED USING STANDARD ENGINEERING SCALES. REDUCED SIZED PLANS WILL NOT CONFORM TO STANDARD SCALES. IN MAKING MEASUREMENTS ON REDUCED PLANS, THE ABOVE SCALES MAY BE USED.

J.U.L.I.E.
JOINT UTILITY LOCATION INFORMATION FOR EXCAVATION
1-800-892-0123
OR 811

LOCATION OF
IMPROVEMENT:
SN 016-2087

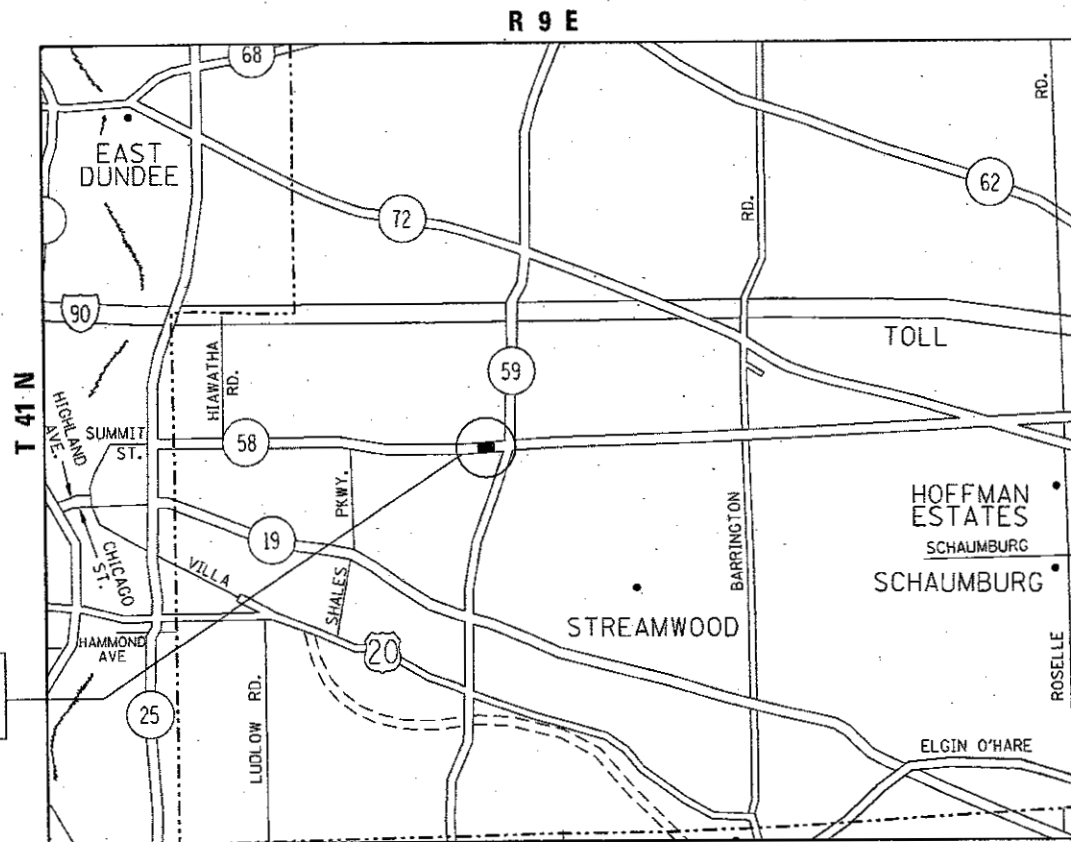

HANOVER TOWNSHIP

GROSS & NET LENGTH = 91.0 FT. = 0.017 MILE

PROJECT ENGINEER J. ALAIN MIDY (847) 221-3056
PROJECT MANAGER FAWAD AQUEEL (847) 705-4247

CONTRACT NO. 62F33

STATE OF ILLINOIS
DEPARTMENT OF TRANSPORTATION

SUBMITTED ~~December 8, 2017~~

Anthony J. Quigley / AS
Feb 2 20 18 REGIONAL ENGINEER

gaw
Feb 3 20 18 ENGINEER OF DESIGN AND ENVIRONMENT

David DIRECTOR OF PROGRAM DEVELOPMENT

PRINTED BY THE AUTHORITY
OF THE STATE OF ILLINOIS

INDEX OF SHEETS

SHEET NO.	DESCRIPTION
1	COVER SHEET
2	INDEX OF SHEETS, STANDARDS, AND GENERAL NOTES
3	SUMMARY OF QUANTITIES
4	BRIDGE REPAIR PLAN (SN 016-2087)
5	TYPICAL CROSS SECTION (SN 016-2087)
6-12	STAGING PLANS
13	FINAL PAVEMENT MARKING PLAN
14	RAISED REFLECTIVE PAVEMENT MARKERS (SNOW-PLOW RESISTANT) (TC-11)
15	DISTRICT ONE TYPICAL PAVEMENT MARKINGS (TC-13)
16	TRAFFIC CONTROL AND PROTECTION AT TURN BAYS (TO REMAIN OPEN TO TRAFFIC) (TC-14)
17	SHORT TERM PAVEMENT MARKING LETTERS AND SYMBOLS (TC-16)
18	ARTERIAL ROAD INFORMATION SIGN (TC-22)

HIGHWAY STANDARDS

STANDARD NO.	DESCRIPTION
701101-05	OFF-ROAD OPERATIONS, MULTILANE, 15' TO 24" FROM PAVEMENT EDGE
701426-09	LANE CLOSURE, MULTILANE, INTERMITTENT OR MOVING OPERATIONS, FOR SPEEDS ≥ 45 MPH
701427-05	LANE CLOSURE, MULTILANE, INTERMITTENT OR MOVING OPERATIONS, FOR SPEEDS < 40 MPH
701701-10	URBAN LANE CLOSURE, MULTILANE, INTERSECTION
701901-07	TRAFFIC CONTROL DEVICES

GENERAL NOTES

BEFORE STARTING ANY EXCAVATION, THE CONTRACTOR SHALL CALL J.U.L.I.E. AT (800) 892-0123 OR 811 FOR FIELD LOCATIONS OF BURIED ELECTRIC, TELEPHONE AND GAS UTILITIES. 48 HOUR NOTIFICATION IS REQUIRED.

THE CONTRACTOR SHALL COORDINATE CONSTRUCTION ACTIVITIES WITH UTILITY COMPANIES, AND THE VILLAGE OF HOFFMAN ESTATES.

PLAN DIMENSIONS AND DETAILS RELATIVE TO EXISTING PLANS ARE SUBJECT TO NOMINAL CONSTRUCTION VARIATIONS. THE CONTRACTOR SHALL FIELD VERIFY EXISTING DIMENSIONS AND DETAILS AFFECTING NEW CONSTRUCTION AND MAKE NECESSARY APPROVED ADJUSTMENTS PRIOR TO CONSTRUCTION OR ORDERING OF MATERIALS. SUCH VARIATIONS SHALL NOT BE CAUSE FOR ADDITIONAL COMPENSATION FOR A CHANGE IN SCOPE OF THE WORK, HOWEVER, THE CONTRACTOR WILL BE PAID FOR THE QUANTITY ACTUALLY FURNISHED BASED AT THE UNIT PRICE BID FOR THE WORK.

THE CONTRACTOR WILL NOT BE ALLOWED TO SET UP A YARD OR FIELD OFFICE ON STATE PROPERTY WITHOUT WRITTEN PERMISSION FROM THE DEPARTMENT.

ALL DAMAGE TO EXISTING PAVEMENT MARKINGS OR RAISED REFLECTIVE PAVEMENT MARKERS OUTSIDE THE REMOVAL LINE SHOWN ON THE PLANS SHALL BE REPLACED AT NO ADDITIONAL COST TO THE DEPARTMENT.

THE CONTRACTOR SHALL CONTACT THE DISTRICT ONE TRAFFIC CONTROL SUPERVISOR AT (847)705-4470 A MINIMUM OF 72 HOURS IN ADVANCE OF BEGINNING WORK.

THE RESIDENT ENGINEER SHALL CONTACT DON CHIARUGI, IDOT'S AREA TRAFFIC FIELD ENGINEER, VIA EMAIL AT DON.CHIARUGI@ILLINOIS.GOV A MINIMUM OF TWO (2) WEEKS PRIOR TO THE PLACEMENT OF PERMANENT PAVEMENT MARKINGS.

THESE PLANS HAVE BEEN PREPARED FROM NOTES RECEIVED FROM THE BUREAU OF MAINTENANCE.

THE CONTRACTOR SHALL BE REQUIRED TO PROVIDE ACCESS TO ABUTTING PROPERTY AT ALL TIMES DURING THE CONSTRUCTION OF THIS PROJECT.

DO NOT SCALE PLANS FOR CONSTRUCTION DIMENSIONS.

MODEL: Default
FILE: \\p110484848\BENTLEY\EG\Illinois\p110484848\DOT\Documents\DOT - Offices\District 1\projects\128317\CAD\Drawings\128317-01.dwg.dgn

USER NAME = pyrzanowski	DESIGNED -	REVISED -	STATE OF ILLINOIS DEPARTMENT OF TRANSPORTATION	INDEX OF SHEETS, STATE STANDARDS AND GENERAL NOTES			F.A.U. RTE.	SECTION	COUNTY	TOTAL SHEETS	SHEET NO.
PLOT SCALE = 100.0000' / in.	DRAWN -	REVISED -					1320	109-I-BR	COOK	18	2
PLOT DATE = 12/7/2017	CHECKED -	REVISED -		SCALE: SHEET OF SHEETS STA. TO STA.			CONTRACT NO. 62F33				
	DATE -	REVISED -					ILLINOIS FED. AID PROJECT				

URBAN

URBAN



SUMMARY OF QUANTITIES			CONSTRUCTION TYPE CODE 0013				
CODE NO	ITEM	UNIT	TOTAL QUANTITIES	100% STATE 0013			
67000400	ENGINEER'S FIELD OFFICE, TYPE A	CAL MO	3	3			
67100100	MOBILIZATION	L SUM	1	1			
70300210	TEMPORARY PAVEMENT MARKING LETTERS AND SYMBOLS	SO FT	109.2	109.2			
70300904	PAVEMENT MARKING TAPE, TYPE IV 4"	FOOT	6639	6639			
70300906	PAVEMENT MARKING TAPE, TYPE IV 6"	FOOT	564	564			
* 78000200	THERMOPLASTIC PAVEMENT MARKING - LINE 4"	FOOT	622	622			
* 78000400	THERMOPLASTIC PAVEMENT MARKING - LINE 6"	FOOT	35	35			
X0327980	PAVEMENT MARKING REMOVAL - WATER BLASTING	SO FT	226	226			
X7010216	TRAFFIC CONTROL AND PROTECTION, (SPECIAL)	L SUM	1	1			
X7030005	TEMPORARY PAVEMENT MARKING REMOVAL	SO FT	2604	2604			
Z0012102	CONCRETE BRIDGE DECK SCARIFICATION 3/8 INCH	SO YD	709	709			
Z0012193	BRIDGE DECK THIN POLYMER OVERLAY 3/8"	SO YD	709	709			
Z0016200	DECK SLAB REPAIR (PARTIAL)	SO YD	8	8			
Z0021904	SILICONE JOINT SEALER, 1"	FOOT	101	101			
Z0021906	SILICONE JOINT SEALER, 1.5"	FOOT	202	202			
Z0030850	TEMPORARY INFORMATION SIGNING	SO FT	102.8	102.8			

SUMMARY OF QUANTITIES			CONSTRUCTION TYPE CODE 0013				
CODE NO	ITEM	UNIT	TOTAL QUANTITIES	100% STATE 0013			
Z0073510	TEMPORARY TRAFFIC SIGNAL TIMING	EACH	1	1			

*Specialty Item

16

LEGEND

-  = DECK SLAB REPAIR (PARTIAL DEPTH)
-  = SILICONE JOINT SEALER, 1.5" (ABUTMENT JOINTS)
SILICONE JOINT SEALER, 1" (PIER JOINT)

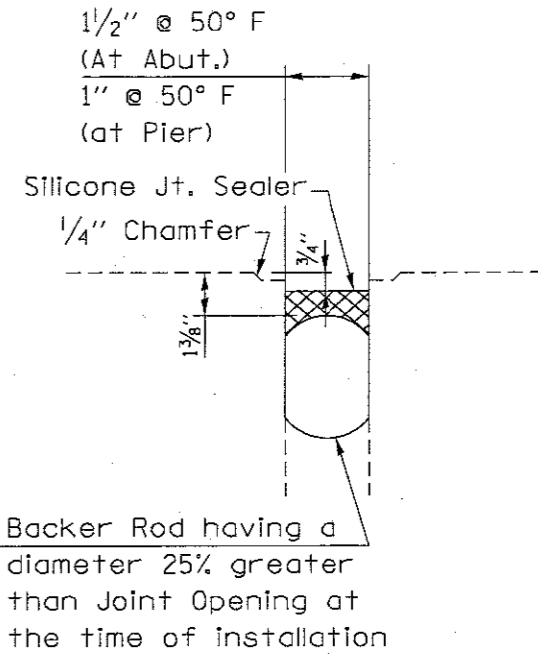

PROPOSED SILICONE JOINT SEAL

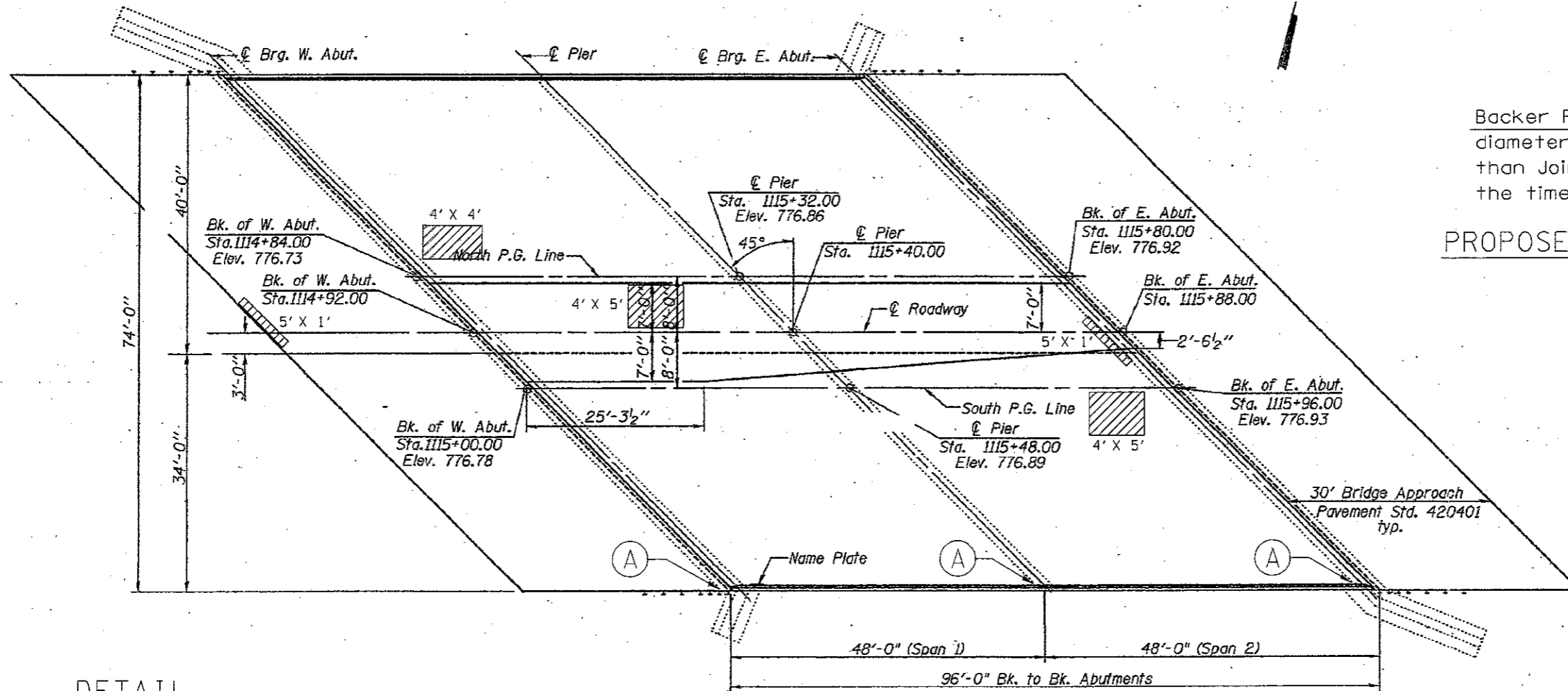

PLAN

DETAIL

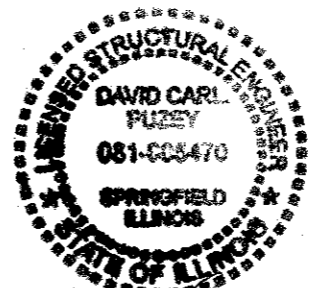
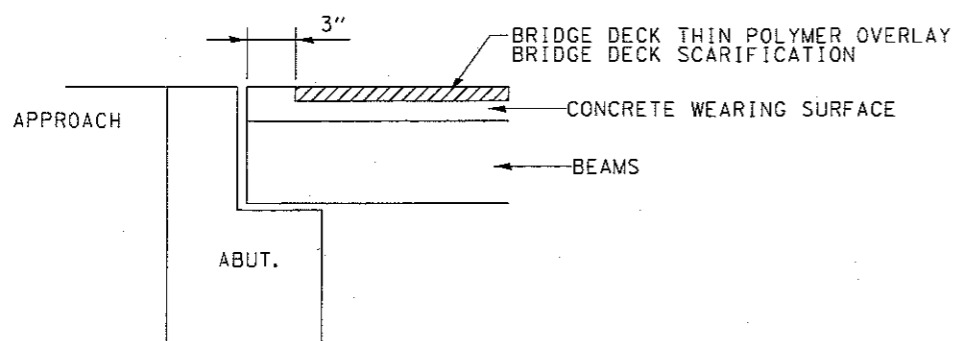

David Carl Puzey 1/22/18
Expires 11/30/18

TOTAL BILL OF MATERIALS

ITEM	UNIT	QUANTITY
CONCRETE BRIDGE DECK SCARIFICATION 3/8"	SG. YD.	709
BRIDGE DECK THIN POLYMER OVERLAY 3/8"	SG. YD.	705
DECK SLAB REPAIR (PARTIAL DEPTH)	SG. YD.	8
SILICONE JOINT SEALER, 1"	FOOT	101
SILICONE JOINT SEALER, 1 1/2"	FOOT	202

MODEL: Default
 FILE NAME: D:\Will\ORCHER\BIDDING\Illinois\pave\PROJECT\Documents\DOT\Office\Desk14\Project\12617\CADD\Drawings\12617-1-18-18.dgn

USER NAME = pyrzanowski	DESIGNED - JAM	REVISED -
PLOT SCALE = 100.0000' / in.	DRAWN - VHU	REVISED -
PLOT DATE = 12/14/2017	CHECKED -	REVISED -
	DATE -	REVISED -

STATE OF ILLINOIS
DEPARTMENT OF TRANSPORTATION

TYPICAL CROSS SECTION			
SN 016-2087			
SCALE:	SHEET	OF SHEETS	STA. TO STA.

F.A.U. RTE.	SECTION	COUNTY	TOTAL SHEETS	NO.
1320	109-1BR	COOK	18	4
CONTRACT NO. 62F33				
ILLINOIS FED. AID PROJECT				

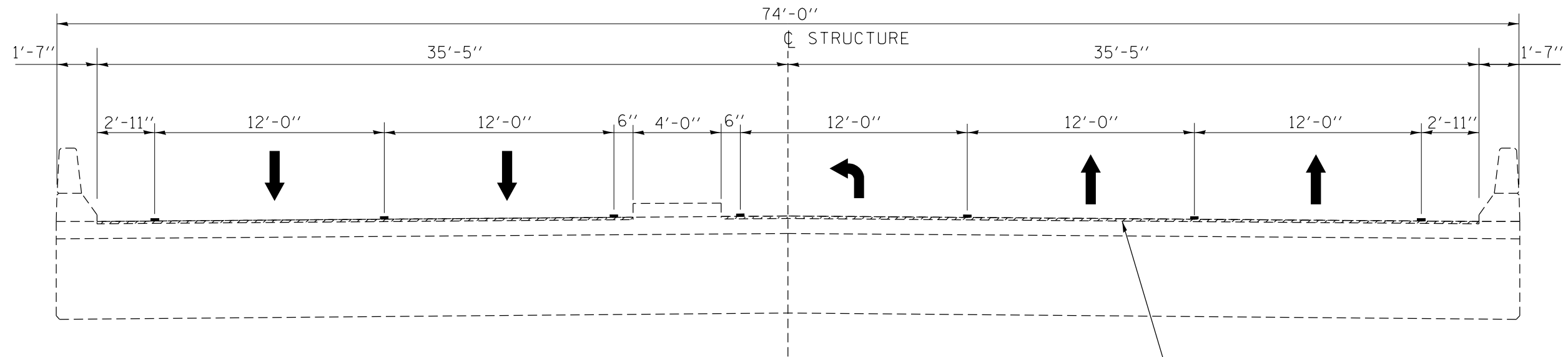

FINAL CROSS SECTION
(LOOKING EAST)

CONCRETE BRIDGE DECK SCARIFICATION, $\frac{3}{8}$ "
BRIDGE DECK THIN POLYMER OVERLAY, $\frac{3}{8}$ "

MODEL: Default
FILE: Model: p:\u0000\B&E\BIDD\ITEC\Illinois\gov\PI\DOT\Documents\DOT_Offices\Director\Projects\ID128317\CADD\Drawings\ID128317-shr-pln.dgn

USER NAME = pyrzanoskirb	DESIGNED -	REVISED -
	DRAWN -	REVISED -
PLOT SCALE = 100.0000' / in.	CHECKED -	REVISED -
PLOT DATE = 12/8/2017	DATE -	REVISED -

**STATE OF ILLINOIS
DEPARTMENT OF TRANSPORTATION**

**TYPICAL CROSS SECTION
SN 016-2087**

SCALE: SHEET OF SHEETS STA. TO STA.

F.A.U. RTE.	SECTION	COUNTY	TOTAL SHEETS	SHEET NO.
1320	109-I-BR	COOK	18	5
CONTRACT NO. 62F33				
ILLINOIS FED. AID PROJECT				

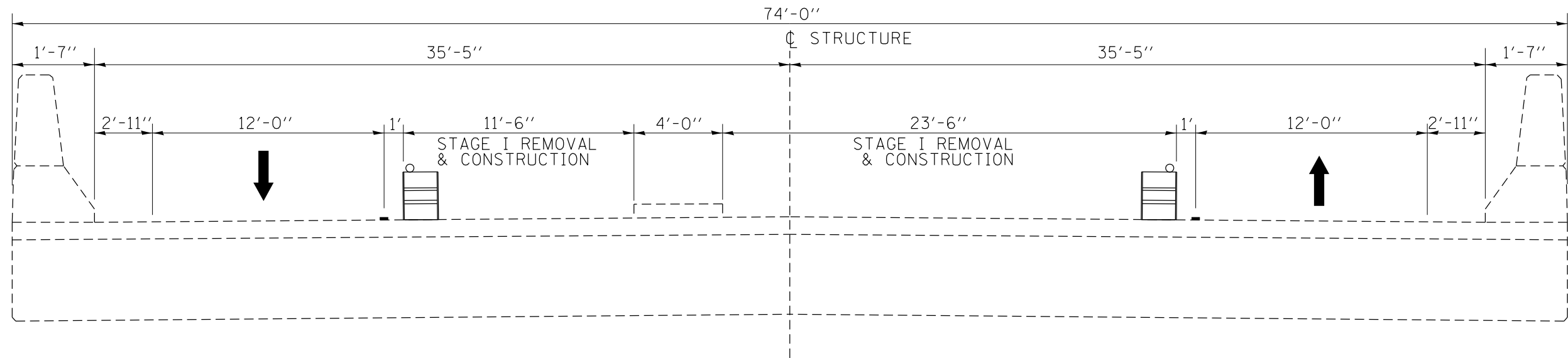

STAGE I
(LOOKING EAST)

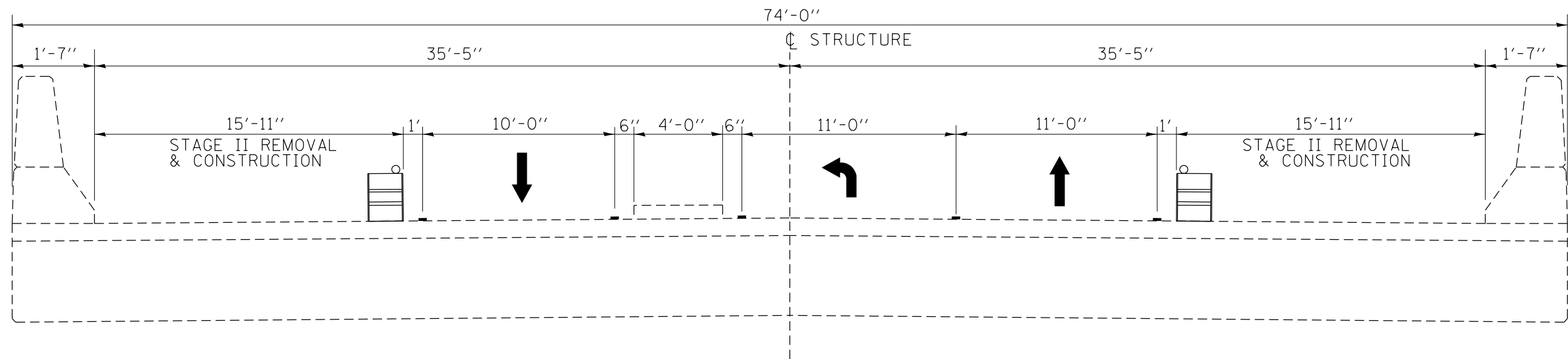

STAGE II
(LOOKING EAST)

MODEL: Default
 FILE: \\nas01.cpe.uiowa.edu\BID\NTEC\Illinois\gov\PIV\DOT\Documents\DOT_Offices\Director\1\Projects\ID128317\CADD\Drawings\ID128317-dht-plans.dgn

USER NAME = pyrzanowski	DESIGNED -	REVISED -
	DRAWN -	REVISED -
PLOT SCALE = 100.0000' / in.	CHECKED -	REVISED -
PLOT DATE = 12/8/2017	DATE -	REVISED -





STATE OF ILLINOIS
DEPARTMENT OF TRANSPORTATION

TRAFFIC CONTROL CROSS SECTION
IL 58 (GOLF RD.) AT POPLAR CREEK (SN 016-2087)

SCALE: SHEET OF SHEETS STA. TO STA.

F.A.U. RTE.	SECTION	COUNTY	TOTAL SHEETS	SHEET NO.
1320	109-I-BR	COOK	18	6
CONTRACT NO. 62F33				
ILLINOIS FED. AID PROJECT				

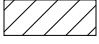
LEGEND

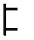
-  DIRECTION INDICATOR BARRICADE WITH STEADY BURN MONODIRECTIONAL LIGHT @ 25' SPACING
-  DRUM WITH STEADY BURN MONO-DIRECTIONAL LIGHT
-  WORK ZONE
-  ARROW BOARD
-  TYPE III BARRICADE

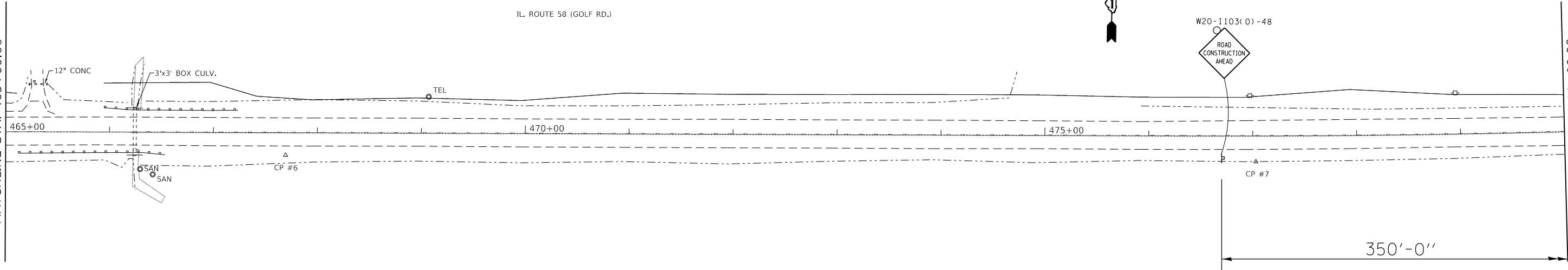
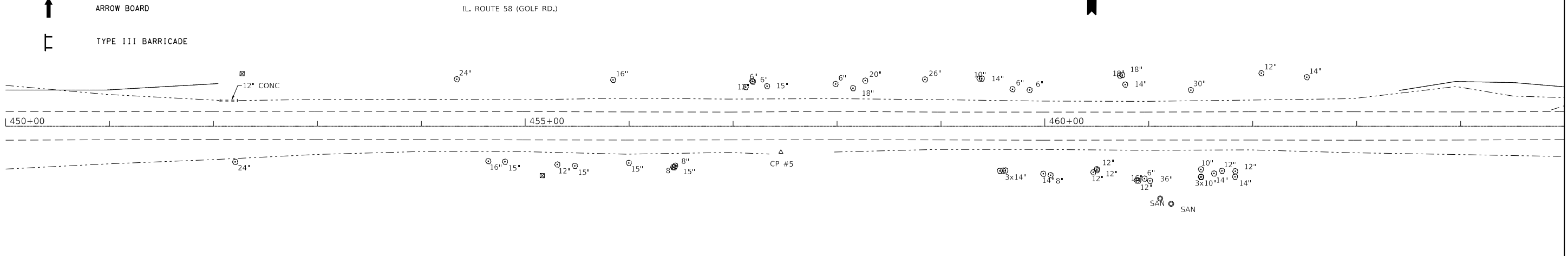

MODEL: Default
 FILE NAME: p:\u0000\B&E\BIDD\ITEC\Illinois\gov\PIWDOT\Documents\DOT_Offices\Bldg\11\proj\csd\128317\CADD\B&E\Defm\128317-shr-pln.dgn

USER NAME = pyrzanowski	DESIGNED -	REVISED -
PLOT SCALE = 100,0000' / in.	DRAWN -	REVISED -
PLOT DATE = 11/17/2017	CHECKED -	REVISED -
	DATE -	REVISED -

**STATE OF ILLINOIS
DEPARTMENT OF TRANSPORTATION**

STAGE I STAGING PLAN IL ROUTE 58 (GOLF RD) AT POPLAR CREEK			
SCALE: 1"= 50'	SHEET	OF SHEETS	STA. TO STA.

F.A.U. RTE.	SECTION	COUNTY	TOTAL SHEETS	SHEET NO.
1320	109-I-BR	COOK	18	7
CONTRACT NO. 62F33				
ILLINOIS FED. AID PROJECT				

LEGEND

- DIRECTION INDICATOR BARRICADE WITH STEADY BURN MONDIRECTIONAL LIGHT @ 25' SPACING
- DRUM WITH STEADY BURN MONO-DIRECTIONAL LIGHT
- WORK ZONE
- ARROW BOARD
- TYPE III BARRICADE

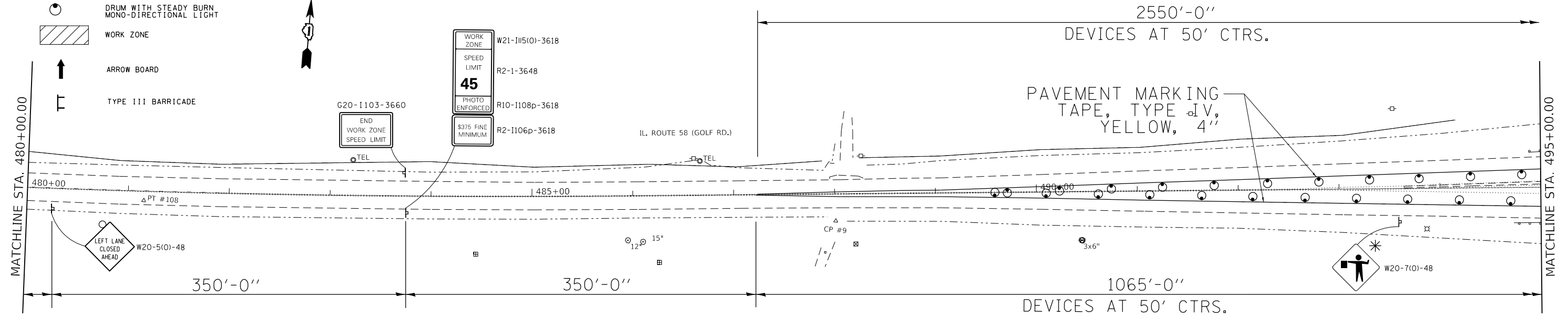

* MUST BE REMOVED WHEN FLAGGER IS NOT PRESENT FOR MORE THAN ONE HOUR

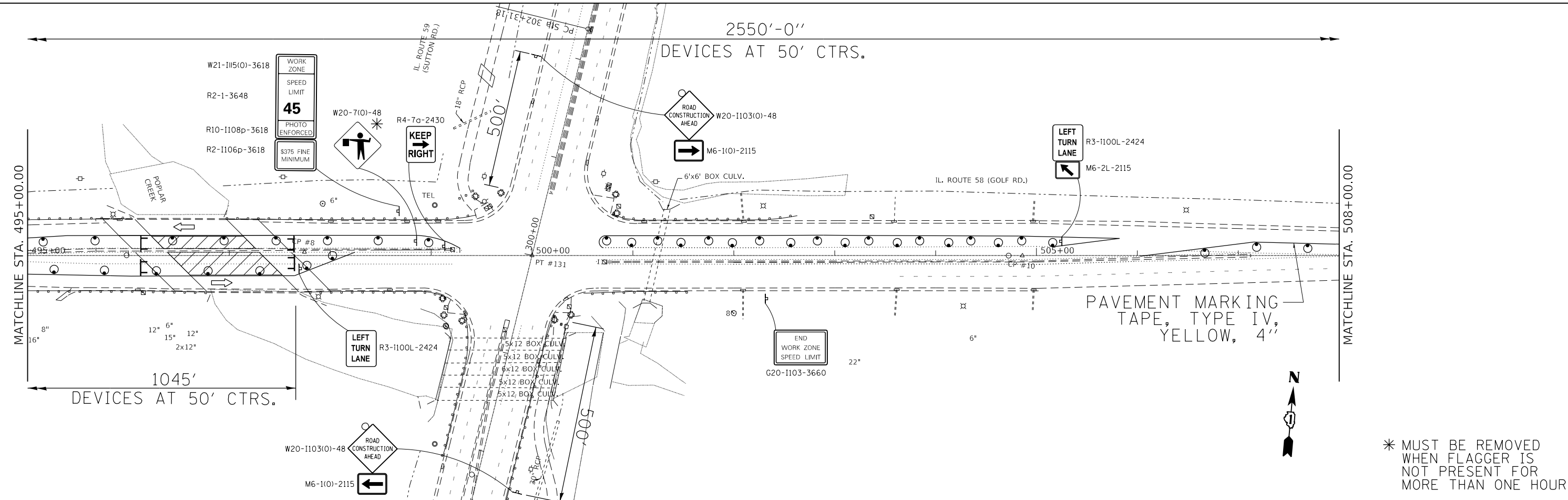

* MUST BE REMOVED WHEN FLAGGER IS NOT PRESENT FOR MORE THAN ONE HOUR

MODEL: Default
 FILE: \\nas01\proj\1109\11091008\BID\ITC\Illinois\gov\p\w\DOT\Documents\BIDD\Office\BID\11091008\BID\11091008\11091008\11091008.dgn

USER NAME = pyranowskirb	DESIGNED -	REVISED -
PLOT SCALE = 100.0000' / in.	DRAWN -	REVISED -
PLOT DATE = 12/7/2017	CHECKED -	REVISED -
	DATE -	REVISED -

**STATE OF ILLINOIS
DEPARTMENT OF TRANSPORTATION**

STAGE I STAGING PLAN			
IL. ROUTE 58 (GOLF RD) AT POPLAR CREEK			
SCALE: 1"= 50'	SHEET	OF SHEETS	STA. TO STA.

F.A.U. RTE.	SECTION	COUNTY	TOTAL SHEETS	SHEET NO.
1320	109-BR	COOK	18	8
CONTRACT NO. 62F33				
ILLINOIS FED. AID PROJECT				

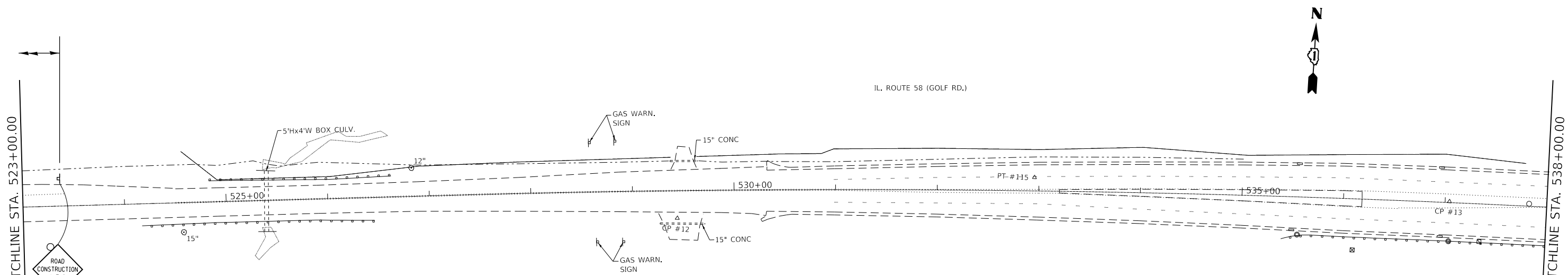
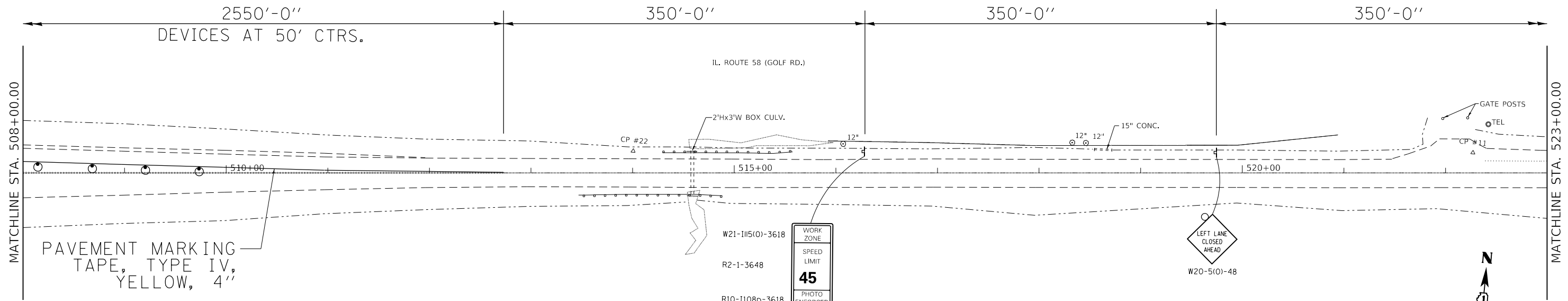

- LEGEND**
- DIRECTION INDICATOR BARRICADE WITH STEADY BURN MONODIRECTIONAL LIGHT @ 25' SPACING
 - DRUM WITH STEADY BURN MONO-DIRECTIONAL LIGHT
 - WORK ZONE
 - ARROW BOARD
 - TYPE III BARRICADE

MODEL: Default
 FILE NAME: p:\u0000\B&E\BID\ITEC\Illinois\gov\p\w\DOT\Documents\st\DOT Office\st\1103\110317\110317-ah-pln.dgn





USER NAME = pyrzanowski	DESIGNED -	REVISED -
DRAWN -	REVISOR -	
PLOT SCALE = 100.0000' / in.	CHECKED -	REVISED -
PLOT DATE = 12/7/2017	DATE -	REVISED -

**STATE OF ILLINOIS
DEPARTMENT OF TRANSPORTATION**

STAGE I STAGING PLAN			
IL. ROUTE 58 (GOLF RD) AT POPLAR CREEK			
SCALE: 1"= 50'	SHEET	OF SHEETS	STA. TO STA.

F.A.U. RTE.	SECTION	COUNTY	TOTAL SHEETS	SHEET NO.
1320	109-I-BR	COOK	18	9
CONTRACT NO. 62F33				
ILLINOIS FED. AID PROJECT				

LEGEND

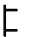
-  DIRECTION INDICATOR BARRICADE WITH STEADY BURN MONODIRECTIONAL LIGHT @ 25' SPACING
-  DRUM WITH STEADY BURN MONO-DIRECTIONAL LIGHT
-  WORK ZONE
-  ARROW BOARD
-  TYPE III BARRICADE

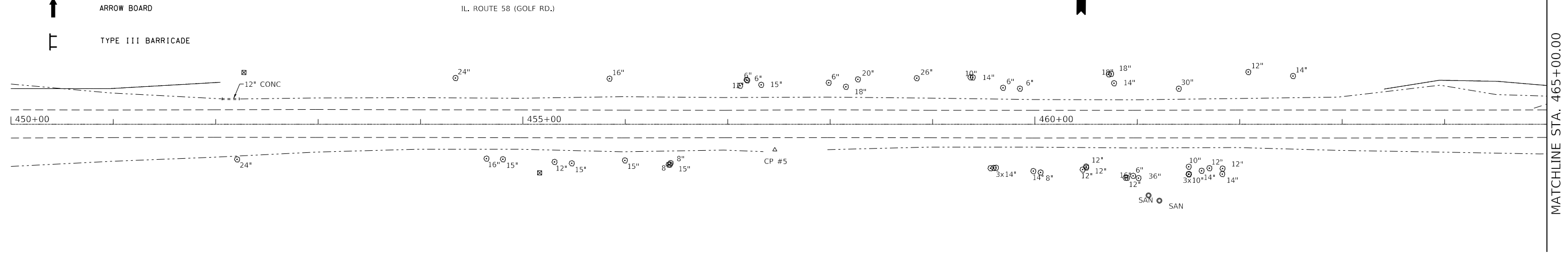

MODEL: Default
 FILE NAME: p:\u0008\BID\NTEC\Illinois\gov\PIWDOT\Documents\DOT_Offices\Director\1\proj\cscs\128317\CADD\DATA\Defm\128317-shr-pln.dgn

USER NAME = pyrzanowski	DESIGNED -	REVISED -
PLOT SCALE = 100.0000' / in.	DRAWN -	REVISED -
PLOT DATE = 11/17/2017	CHECKED -	REVISED -
	DATE -	REVISED -

**STATE OF ILLINOIS
DEPARTMENT OF TRANSPORTATION**

STAGE II STAGING PLAN IL ROUTE 58 (GOLF RD) AT POPLAR CREEK			
SCALE: 1"= 50'	SHEET	OF SHEETS	STA. TO STA.

F.A.U. RTE. 1320	SECTION 109-BR	COUNTY COOK	TOTAL SHEETS 18	SHEET NO. 10
CONTRACT NO. 62F33				
ILLINOIS FED. AID PROJECT				

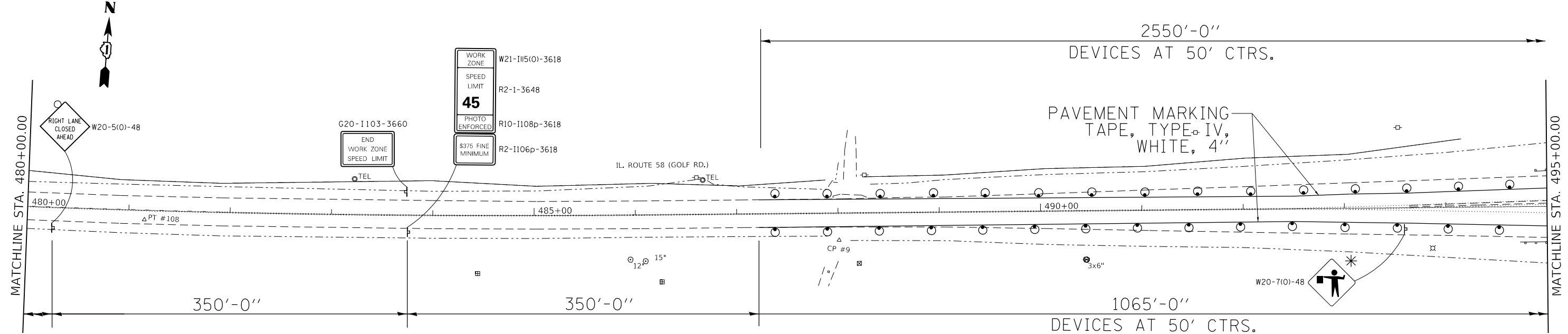

* MUST BE REMOVED WHEN FLAGGER IS NOT PRESENT FOR MORE THAN ONE HOUR

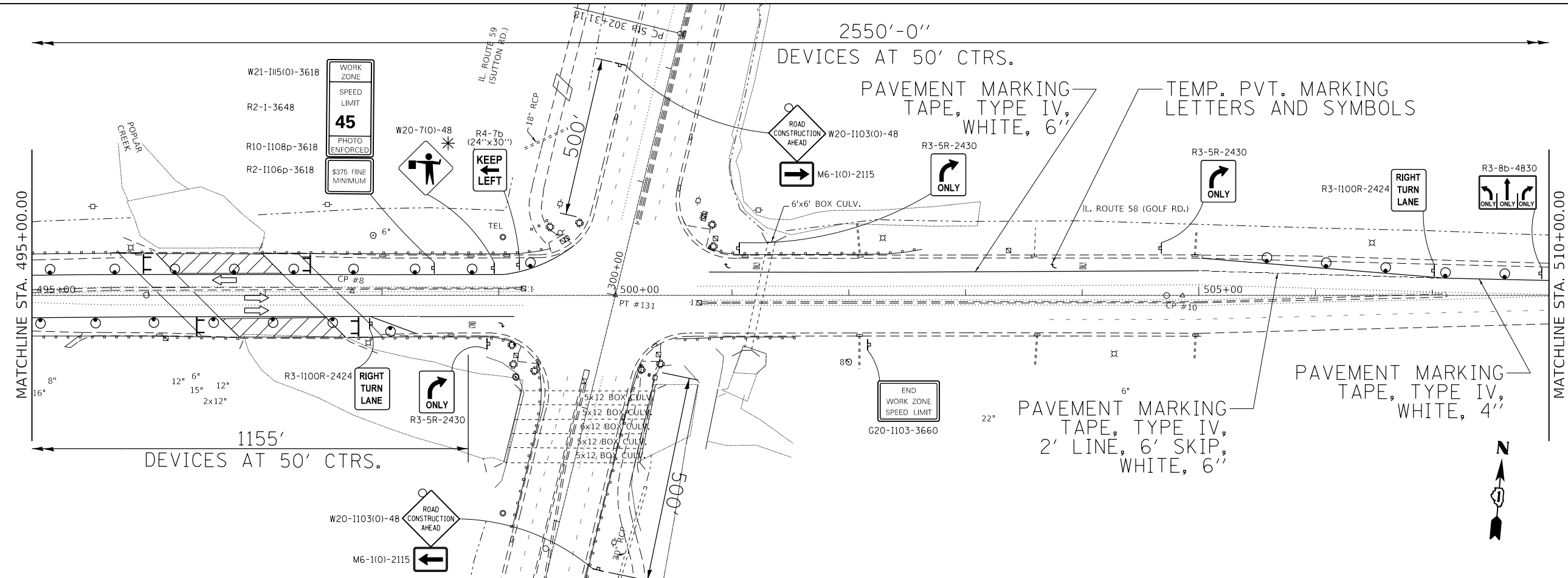

LEGEND

- DIRECTION INDICATOR BARRICADE WITH STEADY BURN MONIDIRECTIONAL LIGHT @ 25' SPACING
- DRUM WITH STEADY BURN MONO-DIRECTIONAL LIGHT
- WORK ZONE
- ARROW BOARD
- TYPE III BARRICADE

* MUST BE REMOVED WHEN FLAGGER IS NOT PRESENT FOR MORE THAN ONE HOUR

MODEL: Default
FILE: \\hulb08a\EBID\NTEC\Illinois\pov\PW\DOT\Documents\1328317\CADD\Drawings\1328317-shr-pln.dgn

USER NAME = pyzranowski	DESIGNED -	REVISED -
DRAWN -	REVISED -	REVISED -
PLOT SCALE = 100.0000' / in.	CHECKED -	REVISED -
PLOT DATE = 12/7/2017	DATE -	REVISED -

**STATE OF ILLINOIS
DEPARTMENT OF TRANSPORTATION**

**STAGE II STAGING PLAN
IL. ROUTE 58 (GOLF RD) AT POPLAR CREEK**

SCALE: 1" = 50'

SHEET	OF	SHEETS	STA.	TO	STA.
-------	----	--------	------	----	------

F.A.U. RTE.	SECTION	COUNTY	TOTAL SHEETS	SHEET NO.
1320	109-BR	COOK	18	11
CONTRACT NO. 62F33				
ILLINOIS FED. AID PROJECT				

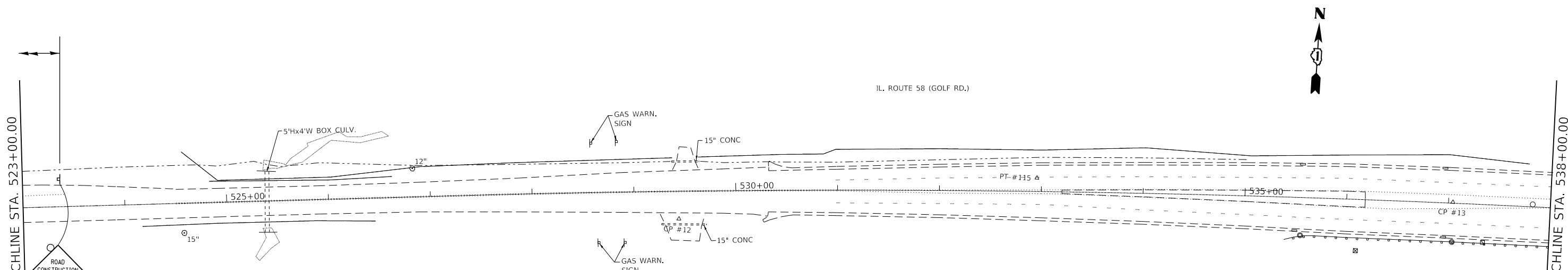
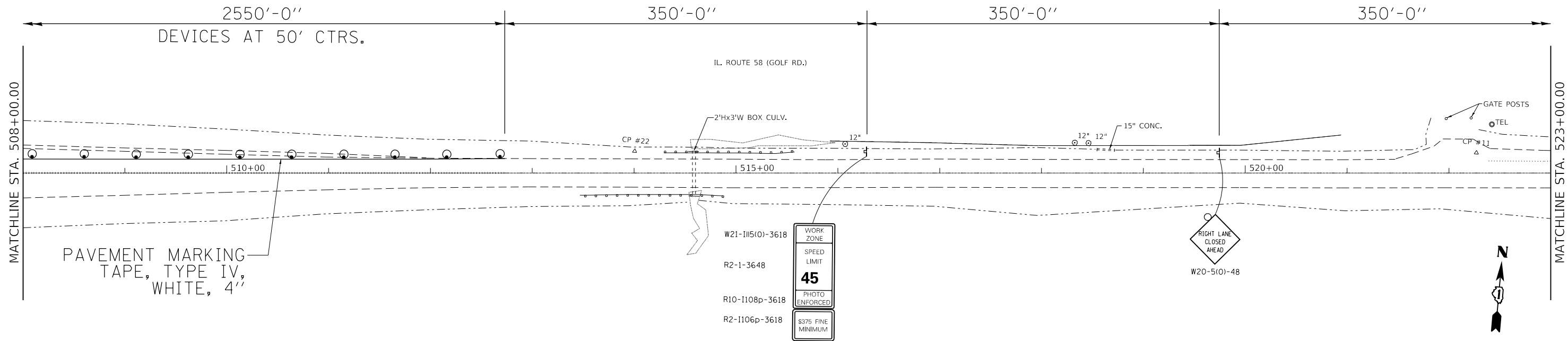

LEGEND

- DIRECTION INDICATOR BARRICADE WITH STEADY BURN MONODIRECTIONAL LIGHT @ 25' SPACING
- DRUM WITH STEADY BURN MONO-DIRECTIONAL LIGHT
- WORK ZONE
- ARROW BOARD
- TYPE III BARRICADE

MODEL: Default
 FILE NAME: p:\u0000\B&E\BIDD\ITEC\Illinois\gov\p\W\DOT\Documents\130317\CADD\B&E\p\130317-shr-pln.dgn

USER NAME = pyzranowski	DESIGNED -	REVISED -
DRAWN -	REVISOR -	
PLOT SCALE = 100.0000' / in.	CHECKED -	REVISOR -
PLOT DATE = 12/7/2017	DATE -	REVISOR -

STATE OF ILLINOIS
DEPARTMENT OF TRANSPORTATION

STAGE II STAGING PLAN
IL. ROUTE 58 (GOLF RD) AT POPLAR CREEK

F.A.U. RTE.	SECTION	COUNTY	TOTAL SHEETS	SHEET NO.
1320	109-I-BR	COOK	18	12
CONTRACT NO. 62F33				
ILLINOIS FED. AID PROJECT				

SCALE: 1" = 50' SHEET OF SHEETS STA. TO STA.

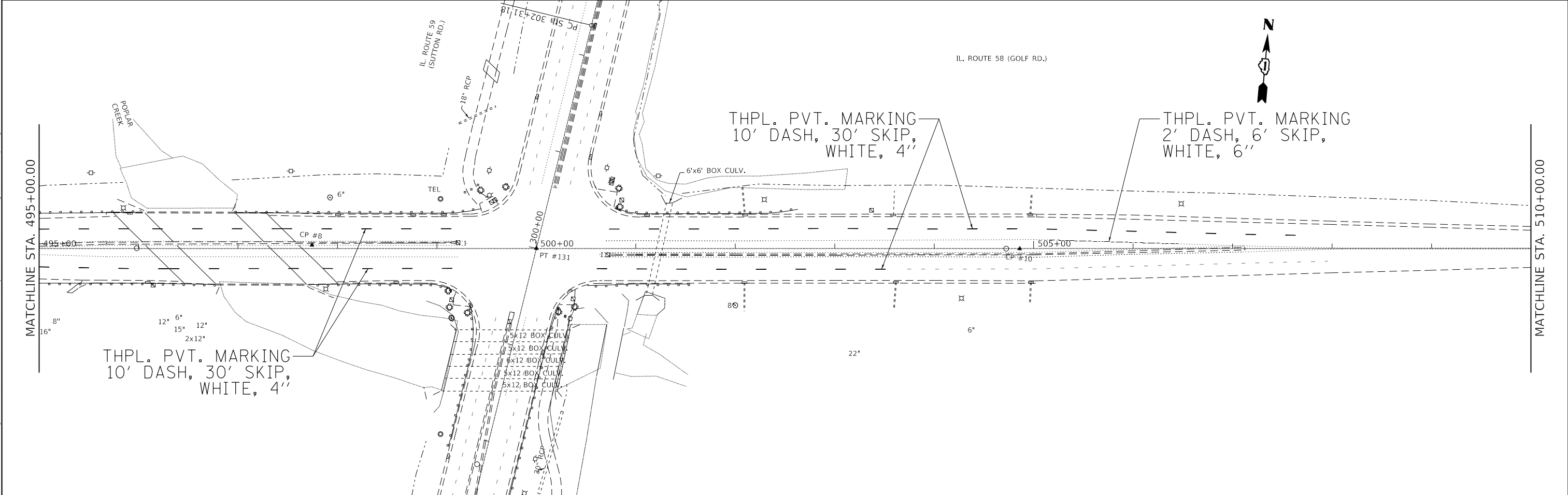
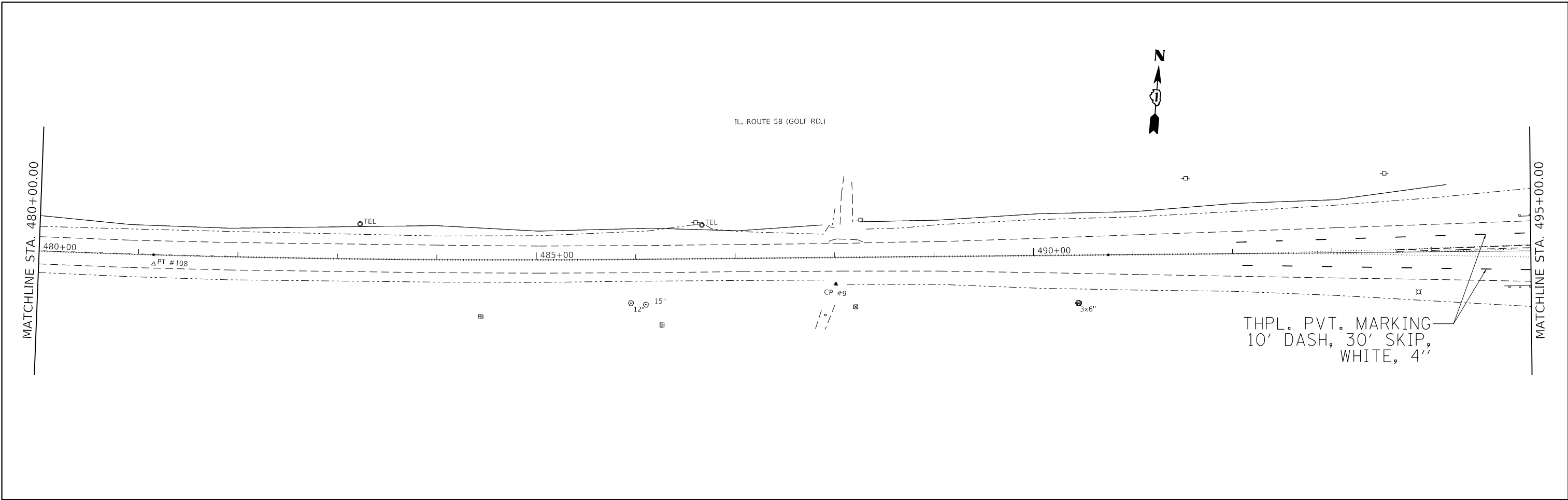

MODEL: Default
 FILE NAME: p:\u0000\B&E\BIDD\ITEC\Illinois.gov\PIVDOT\Documents\BIDD\Office\BIDD\1\Project\5128317\CADD\B&E\Design\BIDD\5128317-shr-pln.dgn

USER NAME = pyzranowski	DESIGNED -	REVISED -
DRAWN -	REVISI	REVISED -
PLOT SCALE = 100.0000' / in.	CHECKED -	REVISED -
PLOT DATE = 12/15/2017	DATE -	REVISED -

STATE OF ILLINOIS
DEPARTMENT OF TRANSPORTATION

FINAL PAVEMENT MARKING PLAN
IL. ROUTE 58 (GOLF RD) AT POPLAR CREEK

F.A.U. RTE.	SECTION	COUNTY	TOTAL SHEETS	SHEET NO.
1320	109-I-BR	COOK	18	13
CONTRACT NO. 62F33				
ILLINOIS FED. AID PROJECT				

SCALE: 1"= 50' SHEET OF SHEETS STA. TO STA.

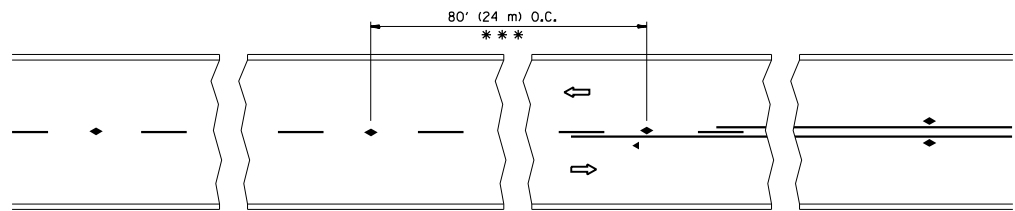

*** REDUCE TO 40' (12 m) O.C. ON CURVES WITH POSTED OR ADVISORY SPEED 45 M.P.H. (70 km/h) OR LESS.

TWO-LANE/TWO-WAY

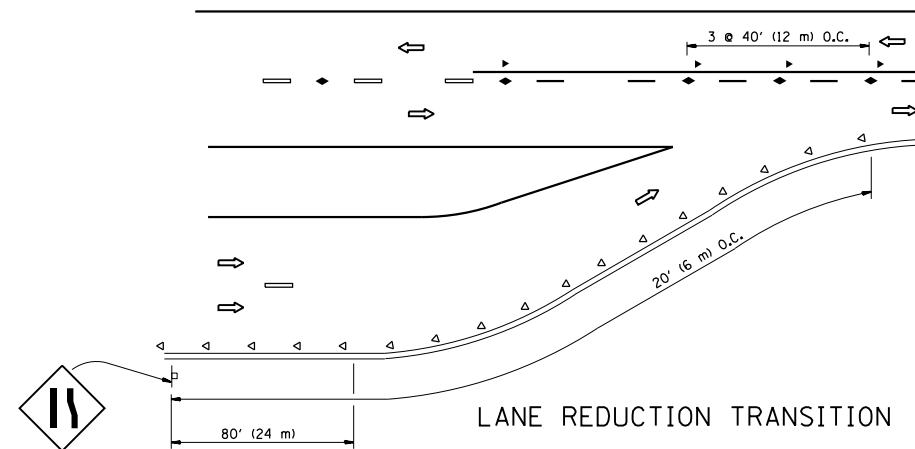

LANE REDUCTION TRANSITION

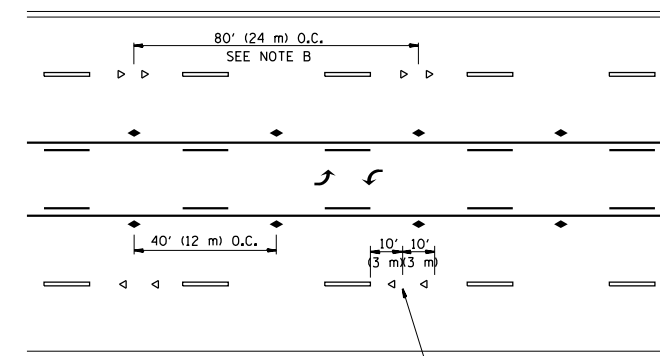

TWO-WAY LEFT TURN

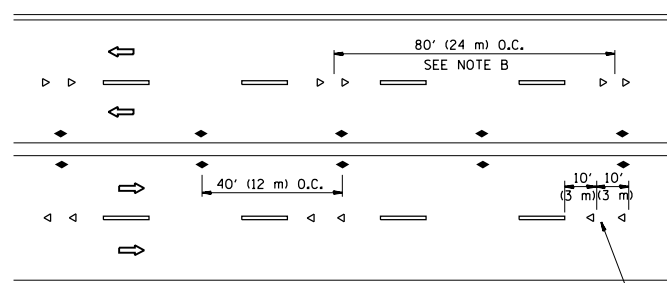

MULTI-LANE/UNDIVIDED

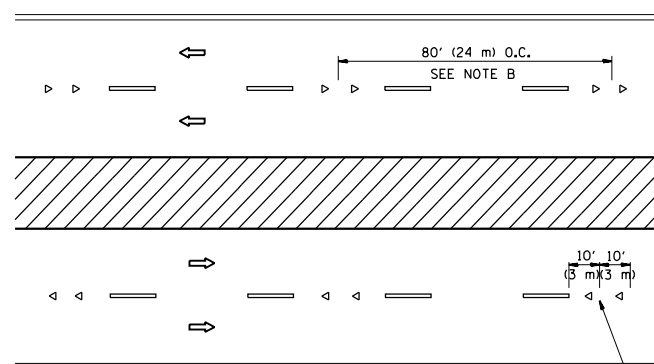

MULTI-LANE/DIVIDED

GENERAL NOTES

1. MARKERS USED WITH DASHED LINES SHALL BE CENTERED IN THE GAP BETWEEN SEGMENTS.
2. MARKERS USED ADJACENT TO SOLID LINES SHALL BE OFFSET 2 TO 3 (50 TO 75) TOWARD TRAFFIC AS SHOWN.
3. MARKERS THROUGH TANGENTS LESS THAN 500' (150 m) IN LENGTH BETWEEN CURVES SHALL BE INSTALLED AT THE LESSER OF THE TWO CURVE SPACINGS.

SYMBOLS

- YELLOW STRIPE
- WHITE STRIPE
- ◀ ONE-WAY AMBER MARKER
- ◁ ONE-WAY CRYSTAL MARKER (W/O)
- ◆ TWO-WAY AMBER MARKER

LANE MARKER NOTES

- A. USE DOUBLE LANE LINE MARKERS SPACED AS SHOWN.
- B. REDUCE TO 40' (12 m) O.C. ON CURVES WHERE ADVISORY SPEEDS ARE 10 M.P.H (20 km/h) LOWER THAN POSTED SPEEDS.

DESIGN NOTES

1. DOUBLE LANE LINE MARKERS SHALL BE USED UNLESS SPECIFIED OTHERWISE.
2. EXCEPT AS SHOWN ON THE LANE REDUCTION TRANSITION AND FREEWAY EXIT RAMP DETAIL, MARKERS ARE NOT TO BE SPECIFIED ON RIGHT EDGE LINES.
3. THE EXACT MARKER LIMITS, SPACING, AND COLOR SHALL BE INCLUDED IN THE PLANS WHEN STANDARD SPECIFICATIONS ARE NOT BEING USED.
4. MARKERS SHOULD NOT BE USED ALONGSIDE CURBS EXCEPT FOR EXTREMELY SHORT SECTIONS OF CURBS WHERE NOT MORE THAN TWO MARKERS WOULD BE INVOLVED.

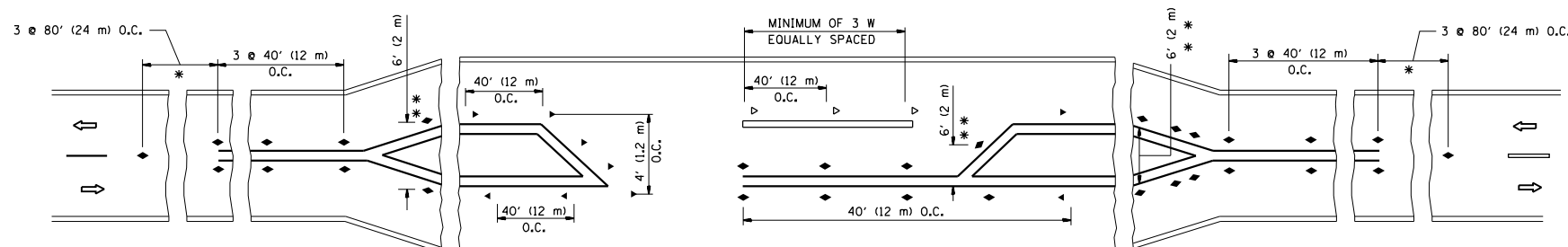

* SEE TWO-LANE/TWO-WAY WHERE MARKERS CONTINUE
 ** WHERE THE MEDIAN WIDTH IS 6' (2 m) OR LESS USE TWO-WAY MARKERS.

LEFT TURN

All dimensions are in inches (millimeters) unless otherwise shown.

FILE NAME =	USER NAME = pyrzenowski	DESIGNED -	REVISED - T. RAMMACHER 09-19-94
pw:\11084EBIDINTEG\illinois.gov\PIWIDOT\Documents\IDOT Offices\District 1\Projects\DI283\Drawings\Design\DistStd.dgn		CHECKED -	REVISED - T. RAMMACHER 03-12-99
		DATE -	REVISED - T. RAMMACHER 01-06-00
			REVISED - C. JUCIUS 09-09-09

STATE OF ILLINOIS
 DEPARTMENT OF TRANSPORTATION

TYPICAL APPLICATIONS
 RAISED REFLECTIVE PAVEMENT MARKERS (SNOW-PLOW RESISTANT)

SCALE: NONE SHEET NO. 1 OF 1 SHEETS STA. TO STA.

F.A.U. RTE.	SECTION	COUNTY	TOTAL SHEETS	SHEET NO.
1320	109-1-BR	COOK	18	14
TC-11		CONTRACT NO. 62F33		
FED. ROAD DIST. NO. 1 ILLINOIS FED. AID PROJECT				

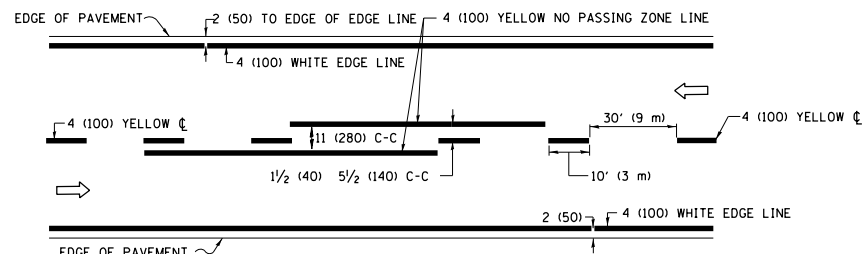

2-LANE ROADWAY

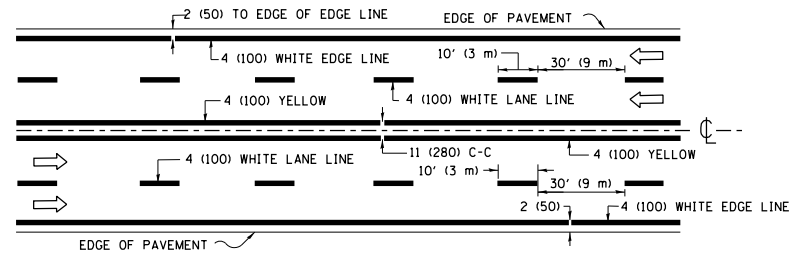

MULTI-LANE UNDIVIDED

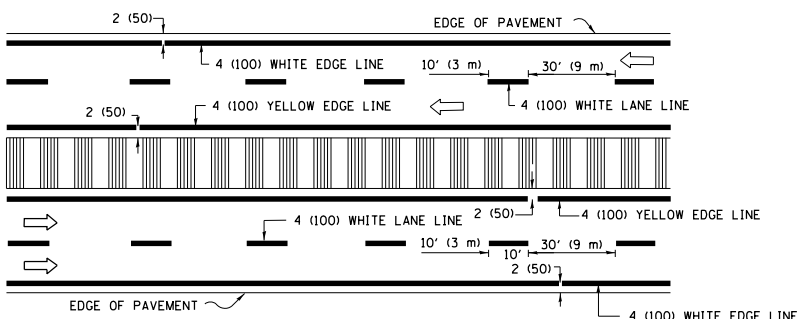

MULTI-LANE DIVIDED WITH MEDIAN

TYPICAL LANE AND EDGE LINE MARKING

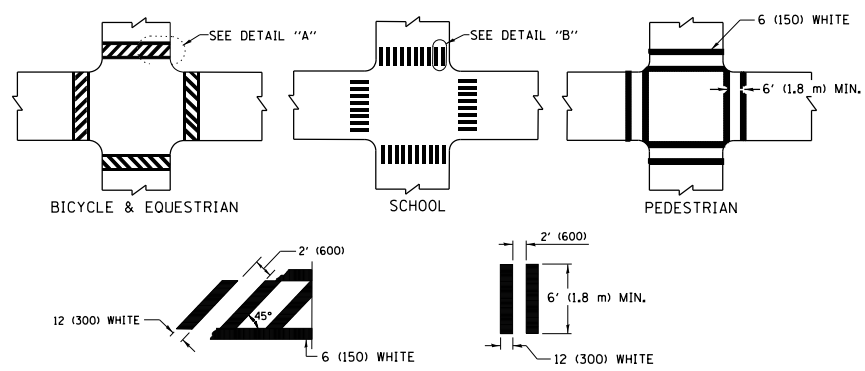

TYPICAL CROSSWALK MARKING

* MARKINGS SHALL BE INSTALLED PARALLEL TO THE CENTERLINE OF THE ROAD WHICH IT CROSSES

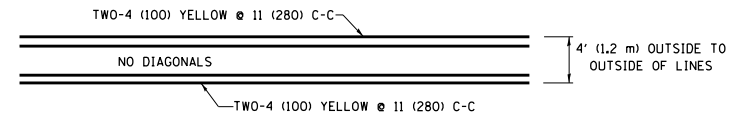

4' (1.2 m) WIDE MEDIANS ONLY

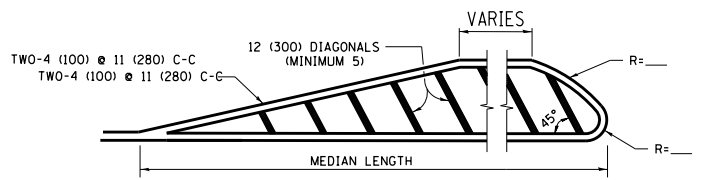

MEDIANS OVER 4' (1.2 m) WIDE

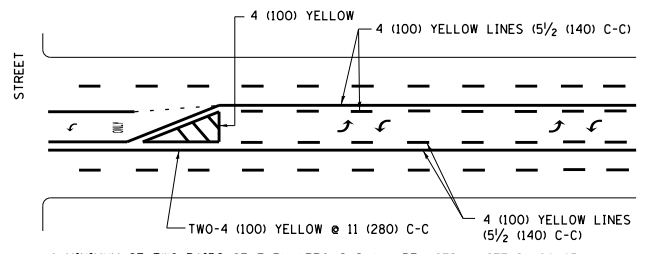

MEDIAN WITH TWO-WAY LEFT TURN LANE TYPICAL PAINTED MEDIAN MARKING

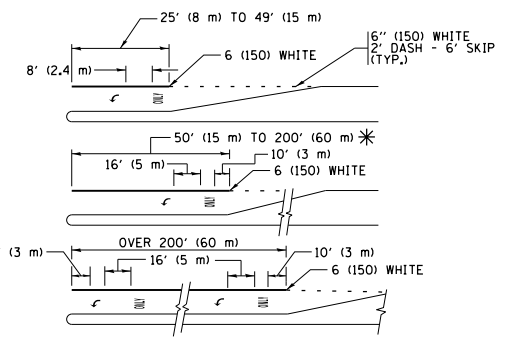

TYPICAL LEFT (OR RIGHT) TURN LANE TYPICAL TURN LANE MARKING

FULL SIZE LETTERS 8" (2.4 m) AND ARROWS SHALL BE USED. AREA = 15.6 SQ. FT. (1.5 m²) ONLY AREA = 20.8 SQ. FT. (1.9 m²)

* TURN LANES IN EXCESS OF 400' (120 m) IN LENGTH MAY HAVE AN ADDITIONAL SET OF ARROW - "ONLY" INSTALLED MIDWAY BETWEEN THE OTHER TWO SETS OF ARROW - "ONLY".

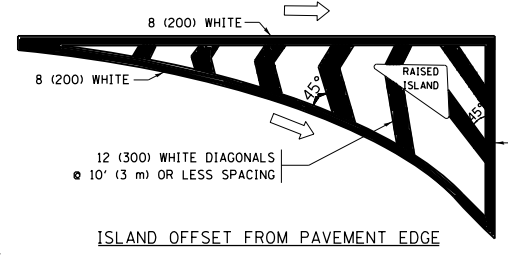

ISLAND OFFSET FROM PAVEMENT EDGE

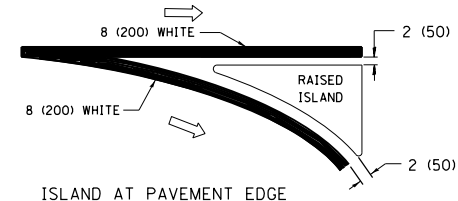

ISLAND AT PAVEMENT EDGE TYPICAL ISLAND MARKING

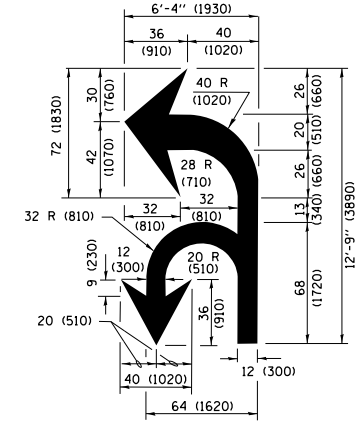

COMBINATION LEFT AND U-TURN

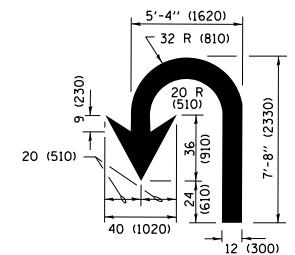

U-TURN

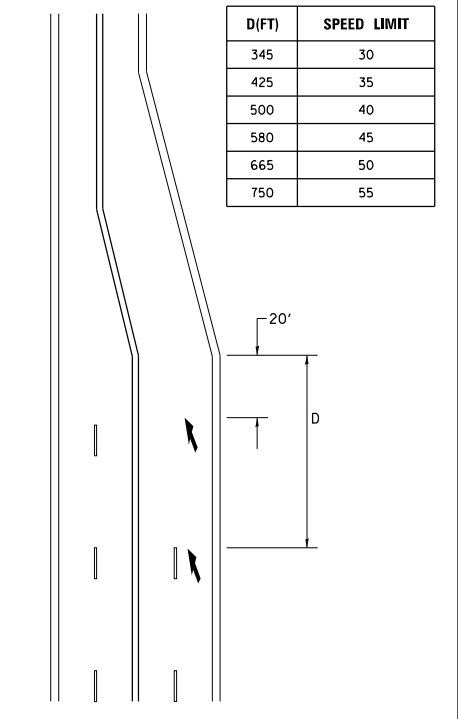

LANE REDUCTION TRANSITION
* LANE REDUCTION ARROWS REQUIRED AT SPEEDS OF 45 MPH OR GREATER OR WHEN SPECIFIED IN PLANS.

TYPE OF MARKING	WIDTH OF LINE	PATTERN	COLOR	SPACING /REMARKS
CENTERLINE ON 2 LANE PAVEMENT	4 (100)	SKIP-DASH	YELLOW	10' (3 m) LINE WITH 30' (9 m) SPACE
CENTERLINE ON MULTI-LANE UNDIVIDED PAVEMENT	2 @ 4 (100)	SOLID	YELLOW	11 (280) C-C
NO PASSING ZONE LINES FOR ONE DIRECTION FOR BOTH DIRECTIONS	4 (100) 2 @ 4 (100)	SOLID SOLID	YELLOW YELLOW	5 1/2 (140) C-C FROM SKIP-DASH CENTERLINE 11 (280) C-C OMIT SKIP-DASH CENTERLINE BETWEEN
LANE LINES	4 (100) 5 (125) ON FREEWAYS	SKIP-DASH SKIP-DASH	WHITE WHITE	10' (3 m) LINE WITH 30' (9 m) SPACE
DOTTED LINES (EXTENSIONS OF CENTER, LANE OR TURN LANE MARKINGS)	SAME AS LINE BEING EXTENDED	SKIP-DASH	SAME AS LINE BEING EXTENDED	2' (600) LINE WITH 6' (1.8 m) SPACE
EDGE LINES	4 (100)	SOLID	YELLOW-LEFT WHITE-RIGHT	OUTLINE MEDIANS IN YELLOW
TURN LANE MARKINGS	6 (150) LINE; FULL SIZE LETTERS & SYMBOLS (8' (2.4m))	SOLID	WHITE	SEE TYPICAL TURN LANE MARKING DETAIL
TWO WAY LEFT TURN MARKING	2 @ 4 (100) EACH DIRECTION 8' (2.4m) LEFT ARROW	SKIP-DASH AND SOLID IN PAIRS	YELLOW WHITE	10' (3 m) LINE WITH 30' (9 m) SPACE FOR SKIP-DASH; 5 1/2 (140) C-C BETWEEN SOLID LINE AND SKIP-DASH LINE SEE TYPICAL TWO-WAY LEFT TURN MARKING DETAIL
CROSSWALK LINES (PEDESTRIAN) A. DIAGONALS (BIKE & EQUESTRIAN) B. LONGITUDINAL BARS (SCHOOL)	2 @ 6 (150) 12 (300) @ 45° 12 (300) @ 90°	SOLID SOLID SOLID	WHITE WHITE WHITE	NOT LESS THAN 6' (1.8 m) APART 2' (600) APART 2' (600) APART SEE TYPICAL CROSSWALK MARKING DETAILS.
STOP LINES	24 (600)	SOLID	WHITE	PLACE 4' (1.2 m) IN ADVANCE OF AND PARALLEL TO CROSSWALK, IF PRESENT, OTHERWISE, PLACE AT DESIRED STOPPING POINT, PARALLEL TO CROSSROAD CENTERLINE, WHERE POSSIBLE
PAINTED MEDIANS	2 @ 4 (100) WITH 12 (300) DIAGONALS @ 45° NO DIAGONALS USED FOR 4' (1.2 m) WIDE MEDIANS	SOLID	YELLOW; TWO WAY TRAFFIC WHITE; ONE WAY TRAFFIC	11 (280) C-C FOR THE DOUBLE LINE SEE TYPICAL PAINTED MEDIAN MARKING.
GORE MARKING AND CHANNELIZING LINES	8 (200) WITH 12 (300) DIAGONALS @ 45°	SOLID	WHITE	DIAGONALS: 15' (4.5 m) C-C (LESS THAN 30MPH (50 km/h)) 20' (6 m) C-C 30MPH (50 km/h) TO 45MPH (70 km/h) 30' (9 m) C-C (OVER 45MPH (70 km/h))
RAILROAD CROSSING	24 (600) TRANSVERSE LINES; "RR" IS 6' (1.8 m) LETTERS; 16 (400) LINE FOR "X"	SOLID	WHITE	SEE STATE STANDARD 780001 AREA OF: "R"=3.6 SQ. FT. (0.33 m ²) EACH "X"=54.0 SQ. FT. (5.0 m ²)
SHOULDER DIAGONALS (REQUIRED FOR SHOULDERS ≥ 8')	12 (300) @ 45°	SOLID	WHITE - RIGHT YELLOW - LEFT	50' (15 m) C-C (LESS THAN 30MPH (50 km/h)) 75' (22.5 m) C-C (30 MPH (50 km/h) TO 45MPH (70 km/h)) 150' (45 m) C-C (OVER 45MPH (70 km/h))
U TURN ARROW	SEE DETAIL	SOLID	WHITE	16.3 SF
2 ARROW COMBINATION LEFT AND U TURN	SEE DETAIL	SOLID	WHITE	30.4 SF

FOR FURTHER DETAILS ON PAVEMENT MARKING REFER TO STANDARD SPECIFICATIONS FOR ROAD AND BRIDGE CONSTRUCTION AND STATE STANDARD 780001.

All dimensions are in inches (millimeters) unless otherwise shown.

FILE NAME =	USER NAME = pyznowskirb	DESIGNED - EVERS	REVISED - C. JUCIUS 09-09-09
pw\1\084EBIDINTEG\illinois.gov\PWIDOT\Documents\DOT Offices\District 1\Projects\DI283\Drawings\Design\DistStd.dgn		CHECKED -	REVISED - C. JUCIUS 07-01-13
Default	PLOT SCALE = 100.0000' / in.	DATE - 03-19-90	REVISED - C. JUCIUS 12-21-15
	PLOT DATE = 11/17/2017		REVISED - C. JUCIUS 04-12-16

STATE OF ILLINOIS DEPARTMENT OF TRANSPORTATION

DISTRICT ONE TYPICAL PAVEMENT MARKINGS			
SCALE: NONE	SHEET 1	OF 1 SHEETS	STA. TO STA.

F.A.U. RTE.	SECTION	COUNTY	TOTAL SHEETS	SHEET NO.
1320	109-1-BR	COOK	18	15
TC-13		CONTRACT NO. 62F33		
ILLINOIS FED. AID PROJECT				

TURN BAY ENTRANCE AT START OF LANE CLOSURE TAPER

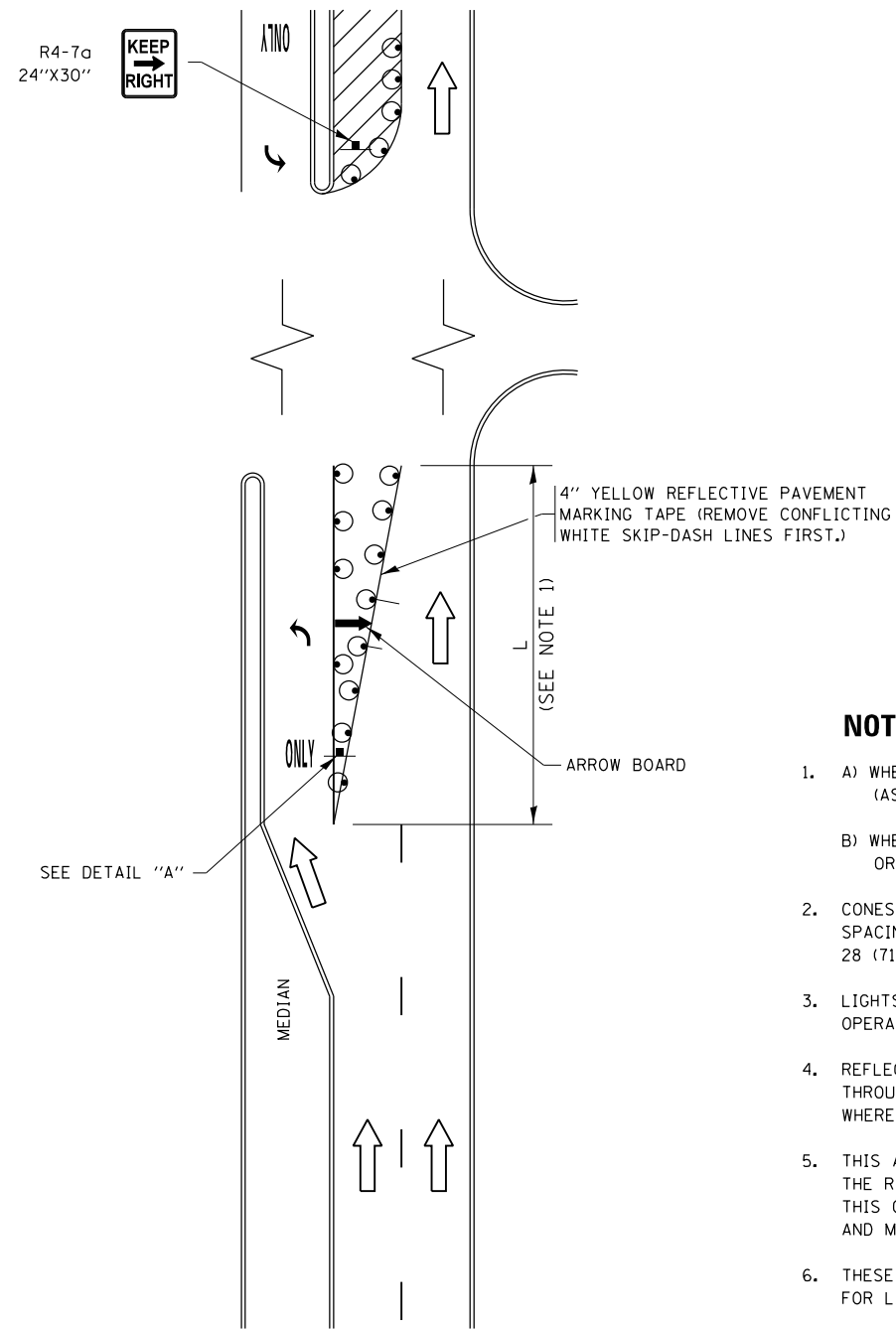

FIGURE 1

TURN BAY ENTRANCE WITHIN A LANE CLOSURE

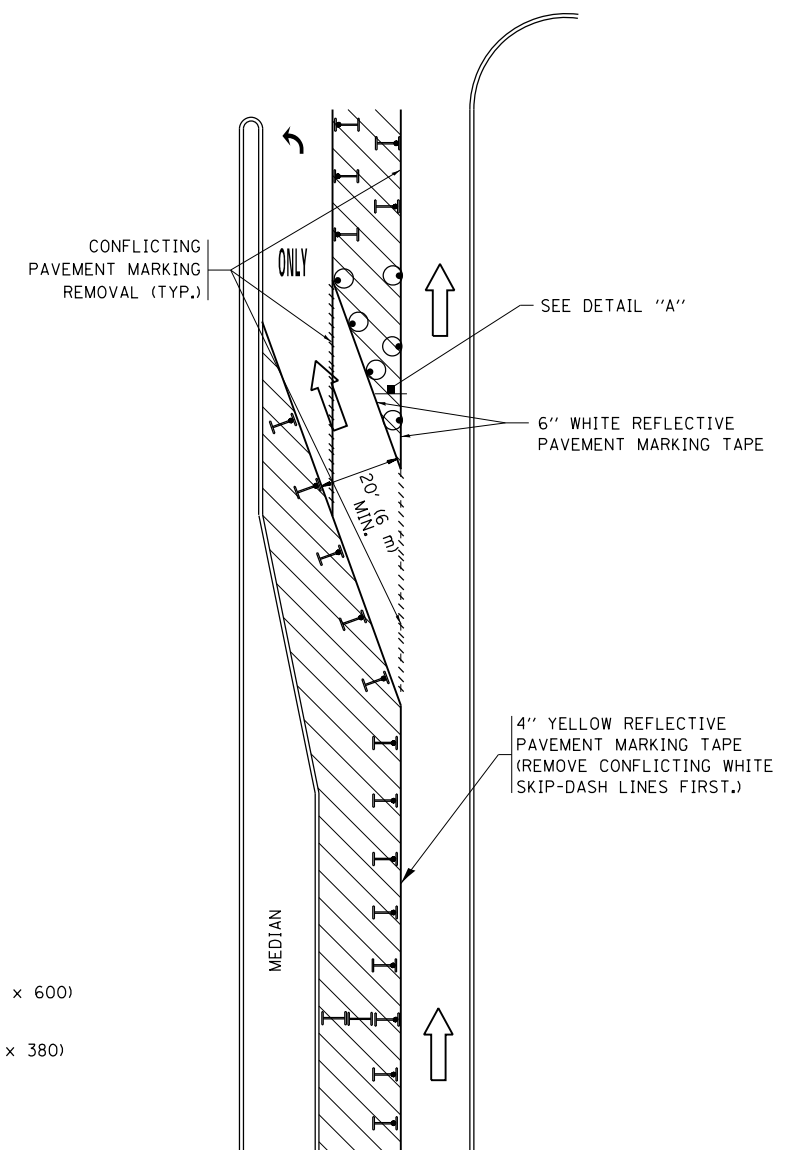
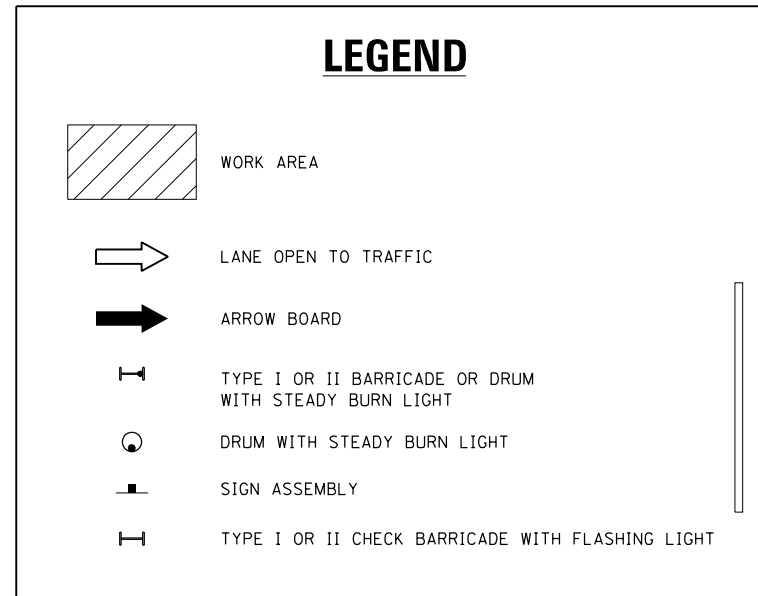
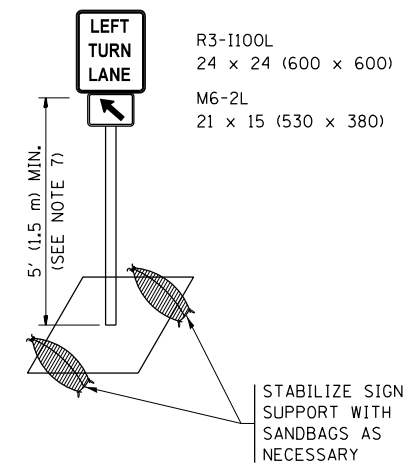

FIGURE 2



NOTES:

1. A) WHEN "L" IS \leq THE STORAGE LENGTH OF THE TURN LANE (AS SHOWN IN FIG. 1), USE FIGURE 1.
B) WHEN "L" IS $>$ THE STORAGE LENGTH OF THE TURN LANE OR THE TURN LANE IS WITHIN THE LANE CLOSURE, USE FIGURE 2.
2. CONES MAY BE SUBSTITUTED FOR BARRICADES OR DRUMS AT HALF THE SPACING DURING DAY OPERATIONS. CONES SHALL BE A MINIMUM OF 28 (710) IN HEIGHT.
3. LIGHTS WILL NOT BE REQUIRED ON BARRICADES OR DRUMS FOR DAY OPERATIONS. ALL LIGHTS SHALL BE MONODIRECTIONAL.
4. REFLECTIVE TEMPORARY PAVEMENT MARKINGS SHALL BE PLACED THROUGHOUT THE BARRICADED AREAS OF EACH TURN BAY AS SHOWN WHERE THE CLOSURE TIME IS GREATER THAN FOURTEEN (14) DAYS.
5. THIS APPLICATION ALSO APPLIES WHEN WORK IS BEING PERFORMED IN THE RIGHT LANE(S) AND THE RIGHT TURN BAY IS TO REMAIN OPEN. UNDER THIS CONDITION, "RIGHT TURN LANE" R3-1100R 24 x 24 (600 x 600) AND M6-2R 21 x 15 (530 x 380) SHALL BE USED.
6. THESE CONTROLS SHALL SUPPLEMENT MAINLINE TRAFFIC CONTROL FOR LANE CLOSURES.
7. THE SIGNS SHALL BE MOUNTED ABOVE THE BARRICADES/DRUMS ON SEPARATE SIGN SUPPORTS THAT MEET NCHRP 350 OR MASH PREQUIREMENTS.
8. TRAFFIC CONTROL AND PROTECTION AT TURN BAYS (TO REMAIN OPEN TO TRAFFIC) SHALL BE INCLUDED IN THE COST OF SPECIFIED TRAFFIC CONTROL STANDARDS OR ITEMS.



DETAIL A

All dimensions are in inches (millimeters) unless otherwise shown.

FILE NAME =	USER NAME = pyrzenowskirb	REVISED - T. RAMMACHER 09-08-94	REVISED - R. BORO 09-14-09	STATE OF ILLINOIS DEPARTMENT OF TRANSPORTATION	TRAFFIC CONTROL AND PROTECTION AT TURN BAYS (TO REMAIN OPEN TO TRAFFIC)			F.A.U. R.T.E.	SECTION	COUNTY	TOTAL SHEETS	SHEET NO.
pw:\IL\084EBIDINTEG\illinois.gov\PIDOT\Documents\IDOT Offices\District 1\Projects\DI283\REVISED Design\HOUSEH 11-07-95	REVISED - A. HOUSEH 11-07-95	REVISED - A. SCHUETZE 07-01-13	REVISED - A. SCHUETZE 07-01-13		1320	109-1-BR	COOK	18	16			
Default	PLOT SCALE = 100.0000' / in.	REVISED - A. HOUSEH 10-12-96	REVISED - A. SCHUETZE 09-15-16		TC-14			CONTRACT NO. 62F33				
	PLOT DATE = 11/17/2017	REVISED - T. RAMMACHER 01-06-00	REVISED -		ILLINOIS FED. AID PROJECT							

SCALE: NONE SHEET 1 OF 1 SHEETS STA. TO STA.

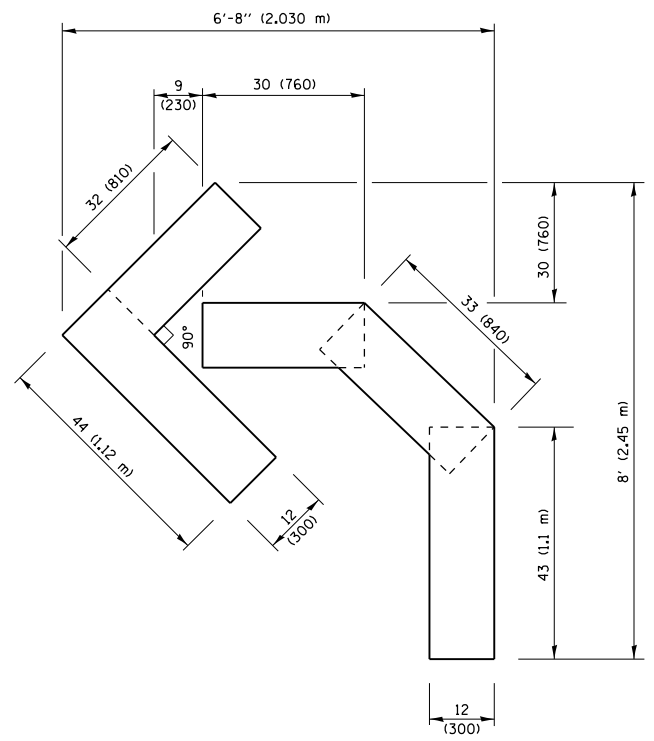

QUANTITY
 4 (100) LINE = 45.5 ft. (13.9 m)
 15.2 sq. ft. (1.41 sq. m)

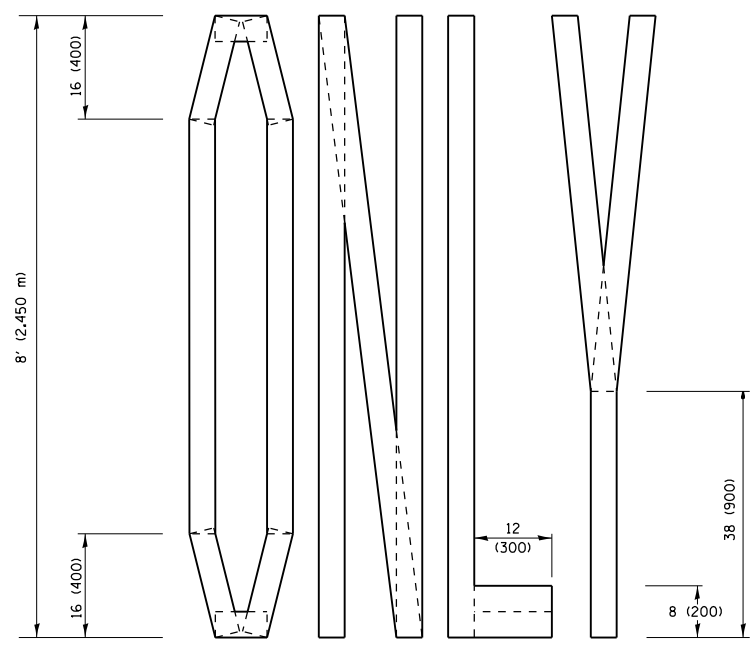
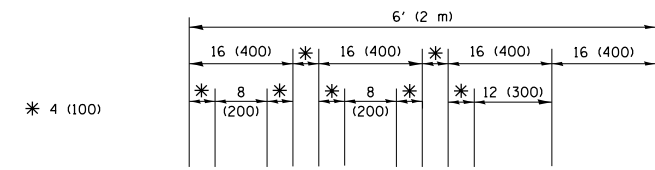

QUANTITY
 4 (100) LINE = 64.1 ft. (19.5 m)
 21.4 sq. ft. (1.99 sq. m)

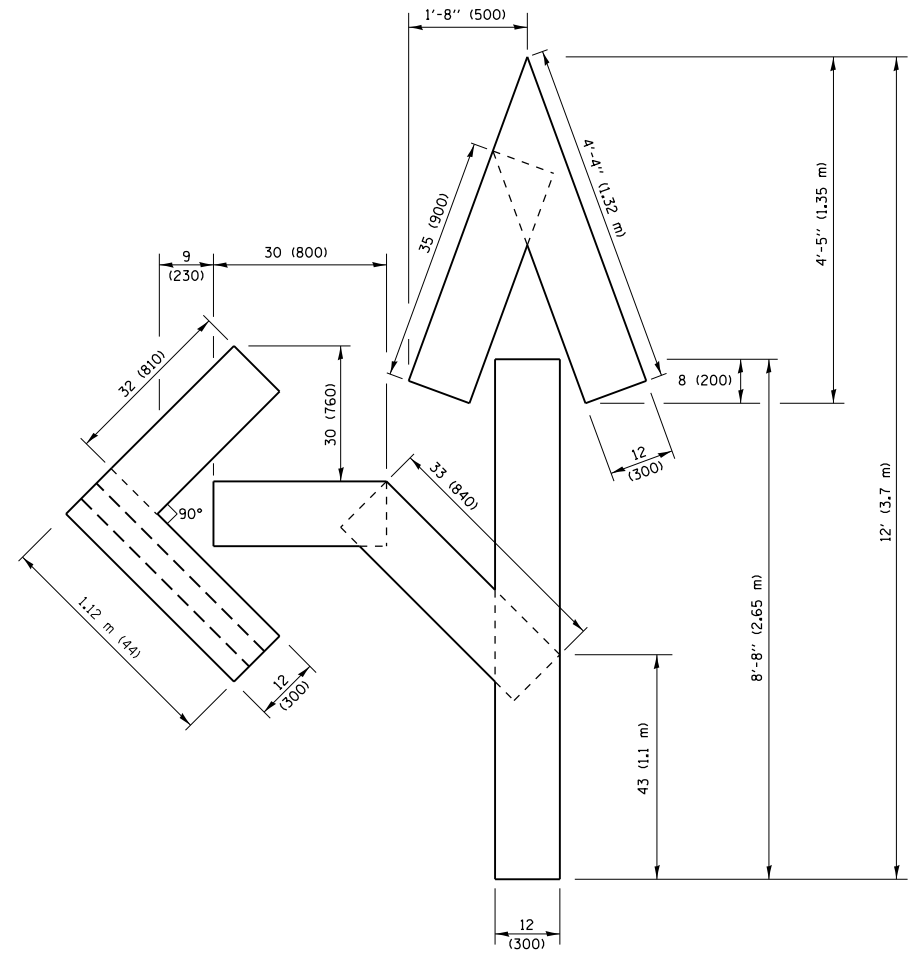

QUANTITY
 4 (100) LINE = 82.5 ft. (25.1 m)
 27.5 sq. ft. (2.53 sq. m)

NOTE:
 ALL QUANTITIES OF PLACEMENT ARE REPRESENTED IN LINEAR FEET OF 4" LINES TO MATCH THE 4" TEMPORARY TAPE PAY ITEM AND REPRESENTS THE TOTAL QUANTITY OF 4" TAPE REQUIRED.

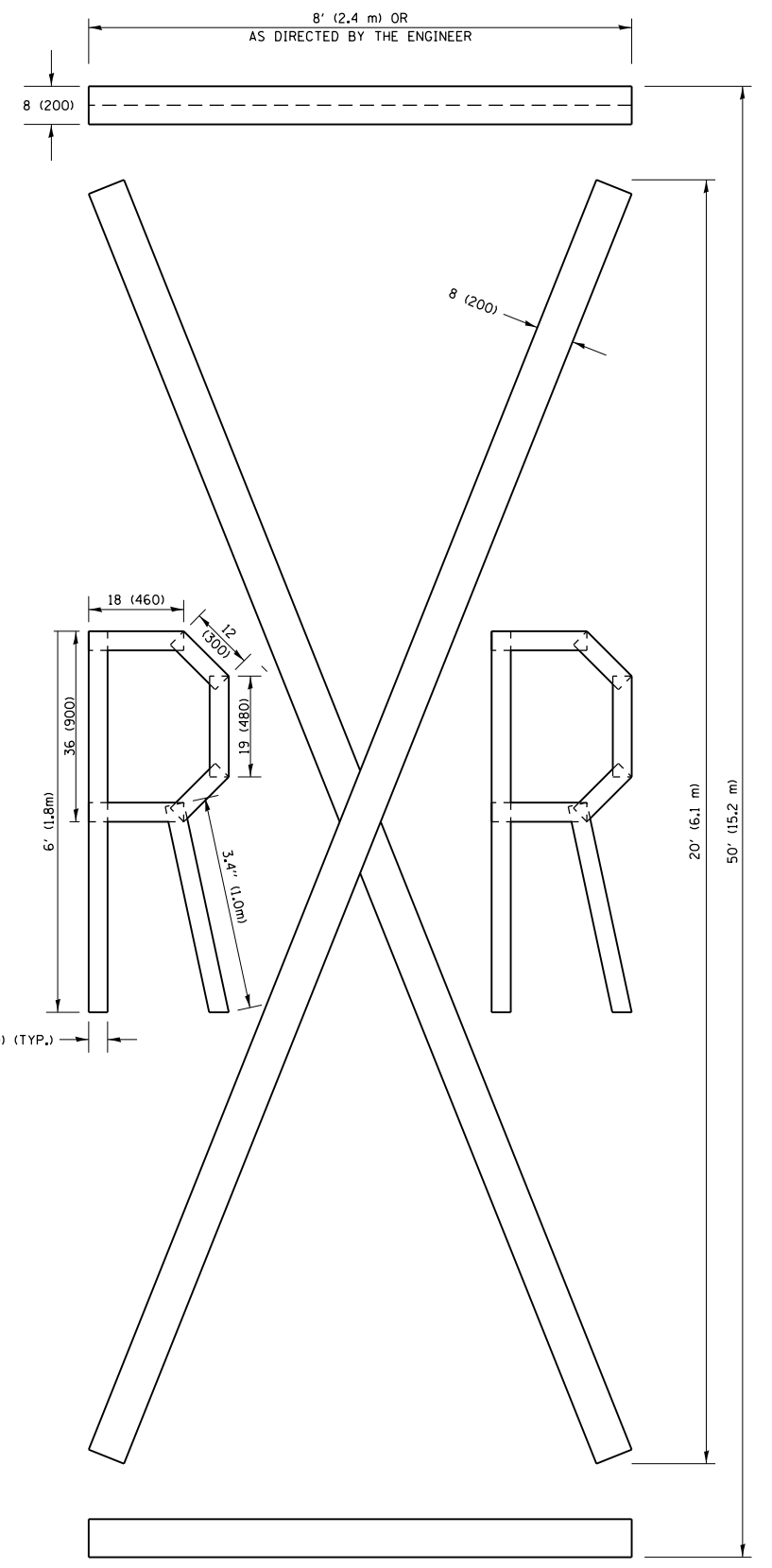

QUANTITY
 4 (100) LINE = 225.9 ft. (68.9 m)
 75.3 sq. ft. (6.99 sq. m)

All dimensions are in inches (millimeters) unless otherwise shown.

FILE NAME =	USER NAME = pyrzenowski	DESIGNED -	REVISED - T. RAMMACHER 03-02-98
p:\11\084EBIDINTEG\illinois.gov\PIWIDOT\Documents\DOT Offices\District 1\Projects\DI283\Drawings\Design\DistStd.dgn		CHECKED -	REVISED - E. GOMEZ 08-28-00
		DATE - 09-18-94	REVISED - E. GOMEZ 08-28-00
			REVISED - A. SCHUETZE 09-15-16

**STATE OF ILLINOIS
 DEPARTMENT OF TRANSPORTATION**

SHORT TERM PAVEMENT MARKING LETTERS AND SYMBOLS			
SCALE: NONE	SHEET NO. 1 OF 1 SHEETS	STA.	TO STA.

F.A.U. RTE.	SECTION	COUNTY	TOTAL SHEETS	SHEET NO.
1320	109-1-BR	COOK	18	17
TC-16			CONTRACT NO. 62F33	
FED. ROAD DIST. NO. 1 ILLINOIS FED. AID PROJECT				

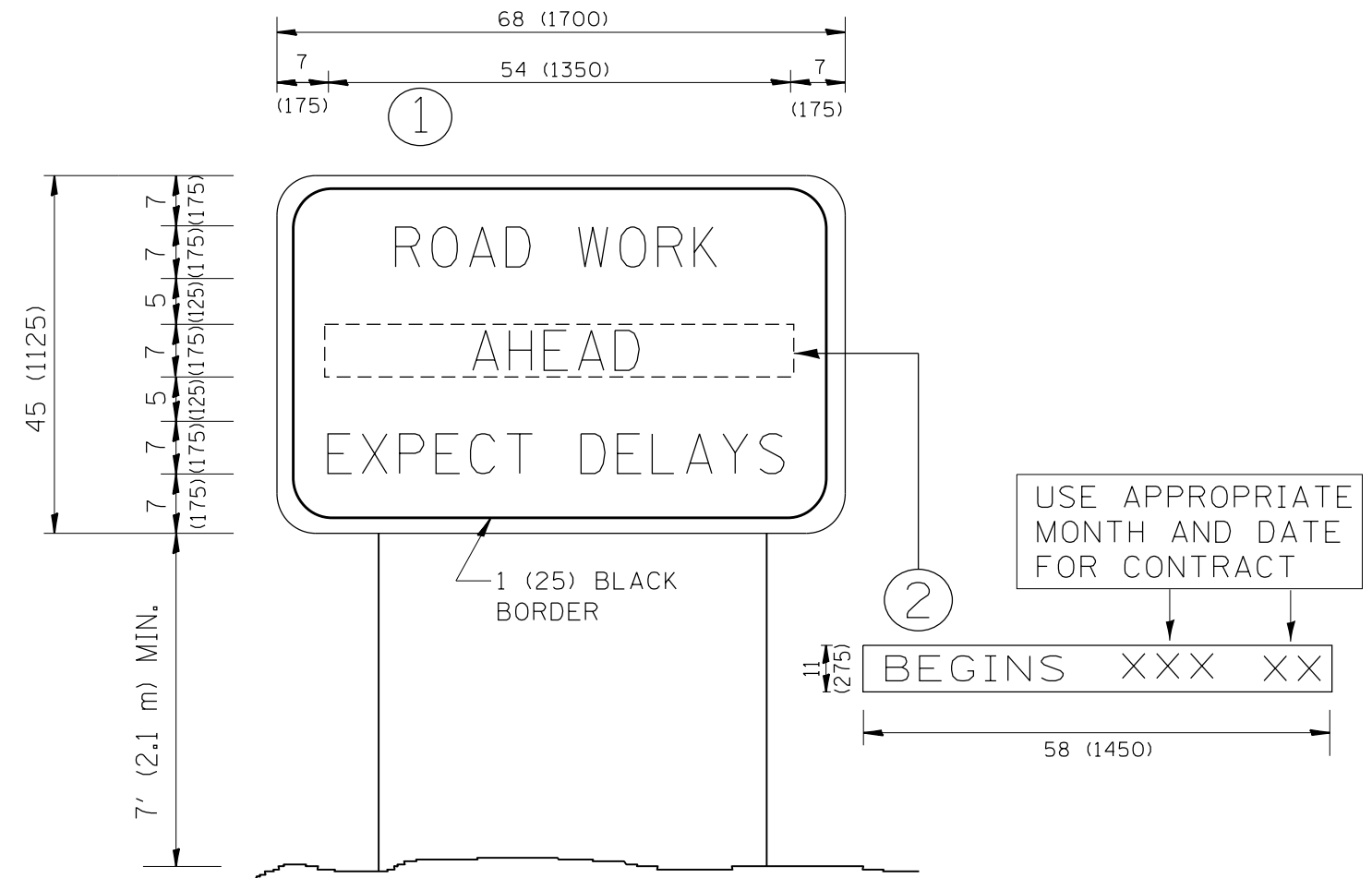

NOTES:

1. USE BLACK LETTERING ON ORANGE BACKGROUND.
2. ERECT SIGNS IN ADVANCE OF THE LOCATION FOR THE "ROAD CONSTRUCTION AHEAD" SIGN AT LOCATIONS AS DIRECTED BY THE ENGINEER.
3. ERECT SIGN ① WITH INSTALLED PANEL ② ONE WEEK PRIOR TO THE START OF CONSTRUCTION.
4. REMOVE PANEL ② SOON AFTER THE START OF CONSTRUCTION.
5. SEE SPECIAL PROVISION FOR "TEMPORARY INFORMATION SIGNING" FOR ADDITIONAL INFORMATION.
6. ONE SIGN ASSEMBLY EQUALS 25.70 SQ. FT. (2.3 SQ. M.)
7. SHALL BE PAID FOR AS TEMPORARY INFORMATION SIGNING.

ALL DIMENSIONS ARE IN INCHES (MILLIMETERS) UNLESS OTHERWISE SHOWN.

FILE NAME =	USER NAME = pyrzenowski	DESIGNED -	REVISED - R. MIRS 09-15-97	STATE OF ILLINOIS DEPARTMENT OF TRANSPORTATION	ARTERIAL ROAD INFORMATION SIGN	F.A.U. RTE.	SECTION	COUNTY	TOTAL SHEETS	SHEET NO.
p:\11084EBIDINTEG.illinois.gov\PIWIDOT\Documents\DOT Offices\District 1\Projects\11283\Drawings\Design\DistStd.dgn		CHECKED -	REVISED - R. MIRS 12-11-97			1320	109-1-BR	COOK	18	18
		PLOT SCALE = 100.0000' / 1in.	REVISED - T. RAMMACHER 02-02-99			TC-22		CONTRACT NO. 62F33		
		PLOT DATE = 11/17/2017	REVISED - C. JUCIUS 01-31-07			SCALE: NONE	SHEET NO. 1 OF 1 SHEETS	STA.	TO STA.	