

SHEET NO. 1 TITLE 03-09-2018 LETTING ITEM 108

- 1 COVER SHEET AND SUMMARY OF QUANTITIES
- 2 MISCELLANEOUS DETAILS AND TYPICAL SECTIONS
- 3 MISCELLANEOUS DETAILS
- 4-5 PLAN

STATE OF ILLINOIS  
DEPARTMENT OF TRANSPORTATION  
DIVISION OF HIGHWAYS

ROAD CLASSIFICATION: LOCAL ROAD  
DESIGN SPEED: 50 M.P.H.  
ROUTE SECTION COUNTY SHEET NO.  
CH 19 15-00185-00-RS FRANKLIN 1 OF 5  
CONTRACT 99595

ADT:  
(2017) = 550  
(2037) = 708  
PC = 623  
SU = 50  
MU = 35  
DHV<sub>20</sub> = 71

PLANS FOR PROPOSED ROADWAY IMPROVEMENTS

CH 19 Marcum Branch Road  
Franklin County, Illinois  
Section 15-00185-00-RS  
Project FLAP(009) Job  
C-99-520-16

| SUMMARY OF QUANTITIES |   |       |        |
|-----------------------|---|-------|--------|
| CODE NO.              | PAY ITEM  | UNIT  | TOTAL  |
| 40200800              | AGGREGATE SURFACE COURSE, TYPE B                | TON   | 40     |
| 40600290              | BITUMINOUS MATERIALS (TACK COAT)                | POUND | 5,145  |
| 40600982              | HOT-MIX ASPHALT SURFACE REMOVAL<br>- BUTT JOINT | SQ YD | 900    |
| 40603085              | HOT-MIX ASPHALT BINDER COURSE,<br>IL 19.10, N70 | TON   | 2,225  |
| 40603315              | HOT-MIX ASPHALT SURFACE COURSE,<br>MIX "C", N70 | TON   | 1,769  |
| 48100100              | AGGREGATE SHOULDERS, TYPE A                     | TON   | 1,595  |
| 67100100              | MOBILIZATION                                    | L SUM | 1      |
| 70300100              | SHORT-TERM PAVEMENT MARKING                     | FOOT  | 1,651  |
| 78001110              | PAINT PAVEMENT MARKING - LINE 4"                | FOOT  | 25,750 |
| △ SPECIALTY ITEMS     |   |       |        |



STANDARDS

- 701006-05
- 701301-04
- 701306-04
- 701311-03
- 701901-07
- 780001-05
- BLR 24-2

**LOCATION MAP**  
NET LENGTH = 1.56 MILES (8255 FEET)

STATE OF ILLINOIS  
DEPARTMENT OF TRANSPORTATION

APPROVED 11/2/2017  
*[Signature]*  
FRANKLIN COUNTY HIGHWAY ENGINEER

PASSED 12/29/2017  
*[Signature]*  
DISTRICT 9 ENGINEER OF LOCAL ROADS & STREETS

RELEASING FOR BID  
BASED ON LIMITED  
REVIEW 12/29/17  
*[Signature]*  
DEPUTY DIRECTOR OF HIGHWAYS, REGION 5 ENGINEER

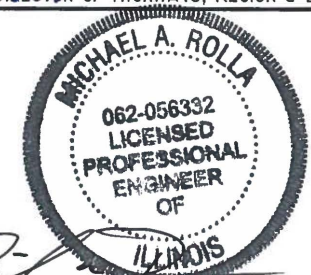

*[Signature]*  
MICHAEL A. ROLLA  
ILLINOIS REGISTERED PROFESSIONAL ENGINEER  
#062-056332  
LIC. EXPIRES 11/30/2017

| ROUTE           | SECTION        | COUNTY   | SHEET NO. |
|-----------------|----------------|----------|-----------|
| CH 19           | 15-00185-00-RS | FRANKLIN | 2 OF 5    |
| CONTRACT 99 595 |                |          |           |

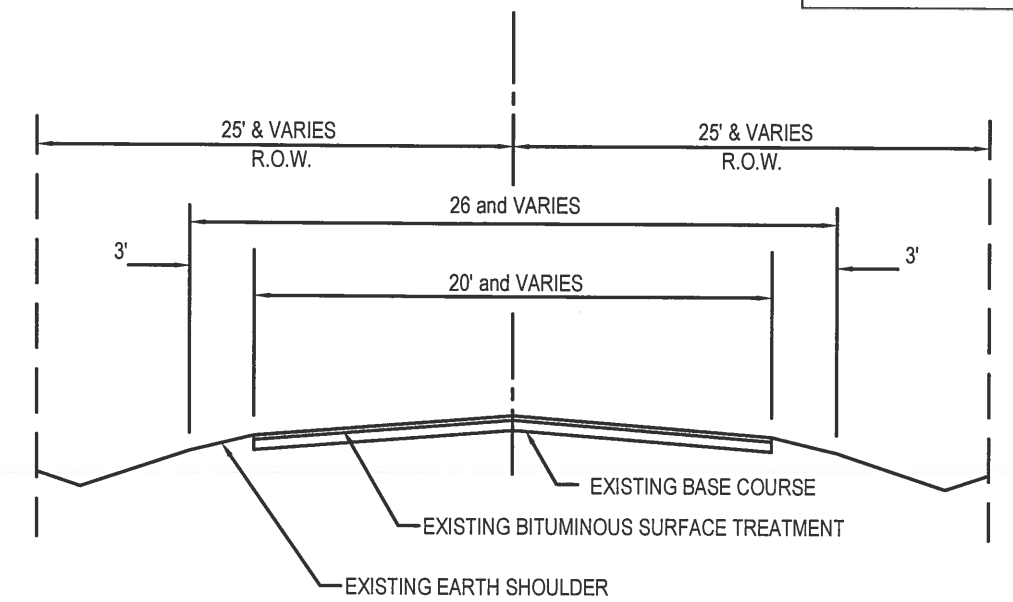
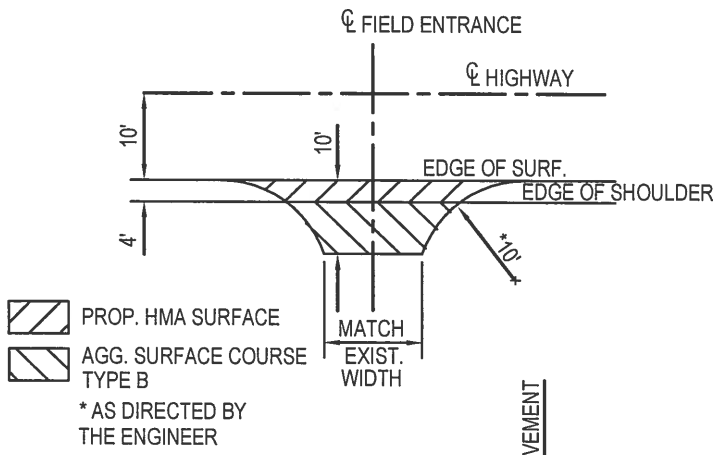
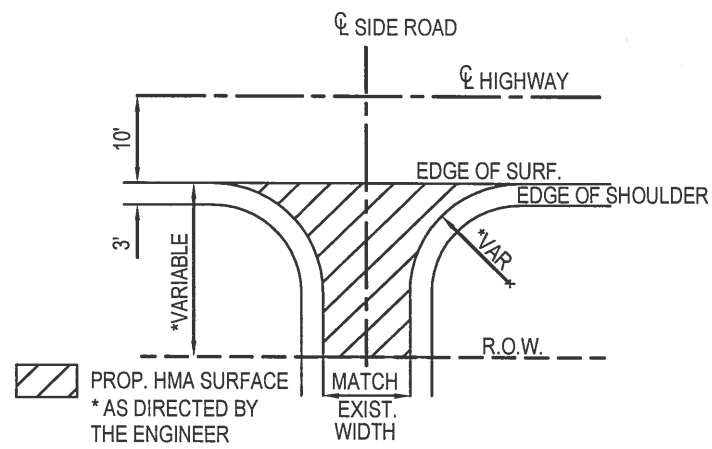

TYPICAL EXISTING SECTION

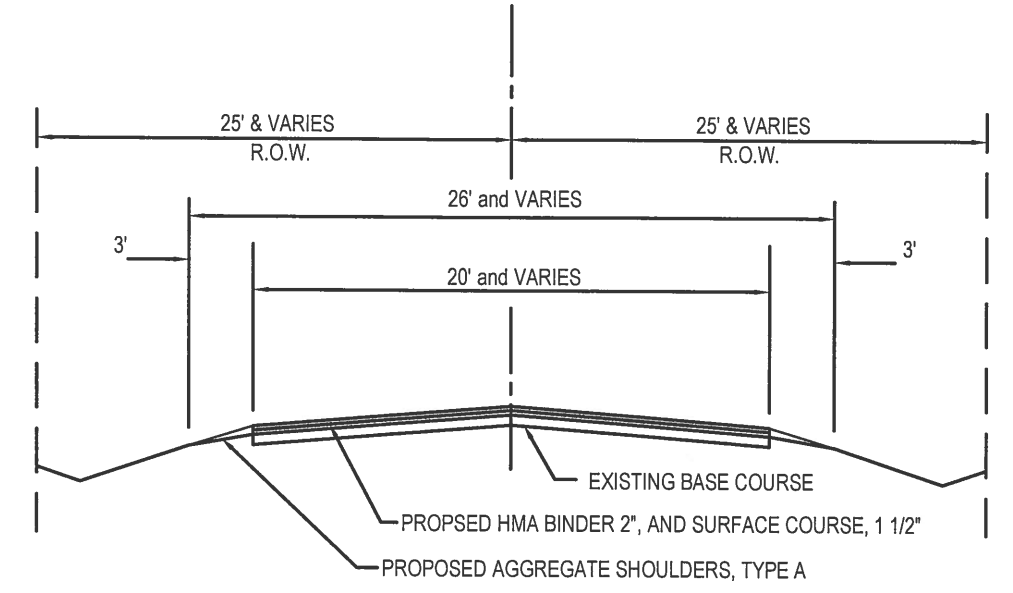

TYPICAL PROPOSED SECTION

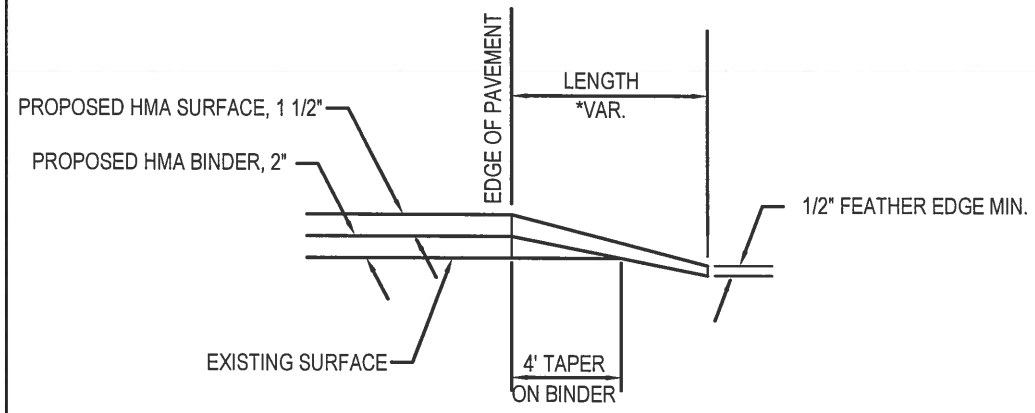

SIDEROAD DETAILS

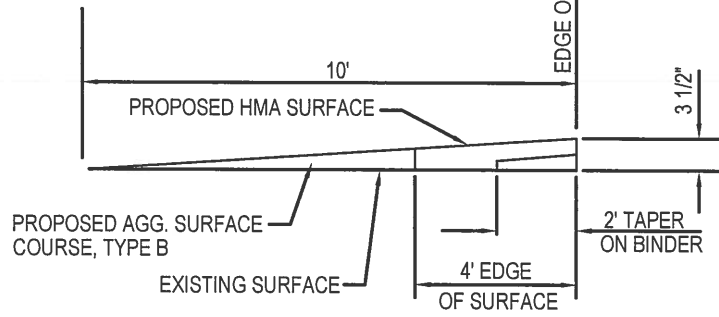

FIELD ENTRANCE DETAILS

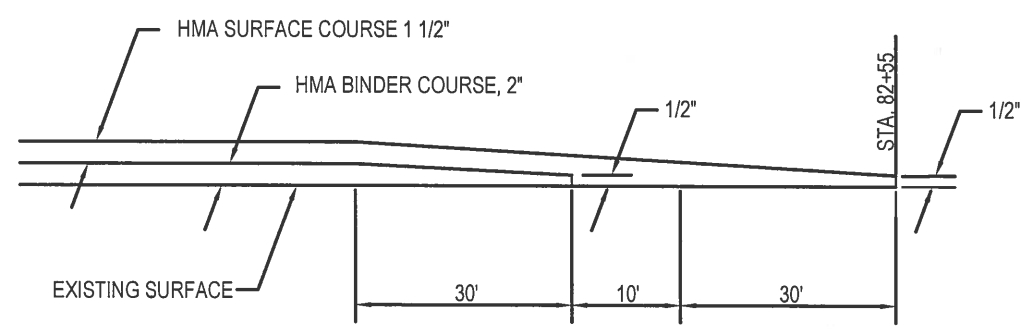

FEATHER JOINT

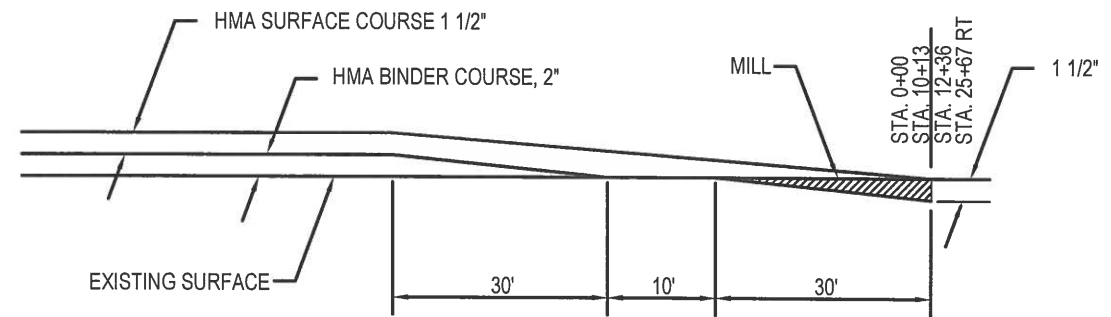

BUTT JOINT

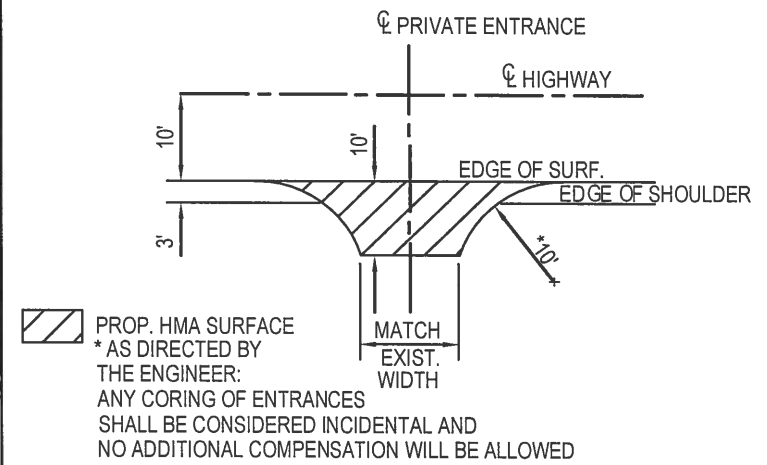

PRIVATE AND COMMERCIAL ENTRANCE DETAILS

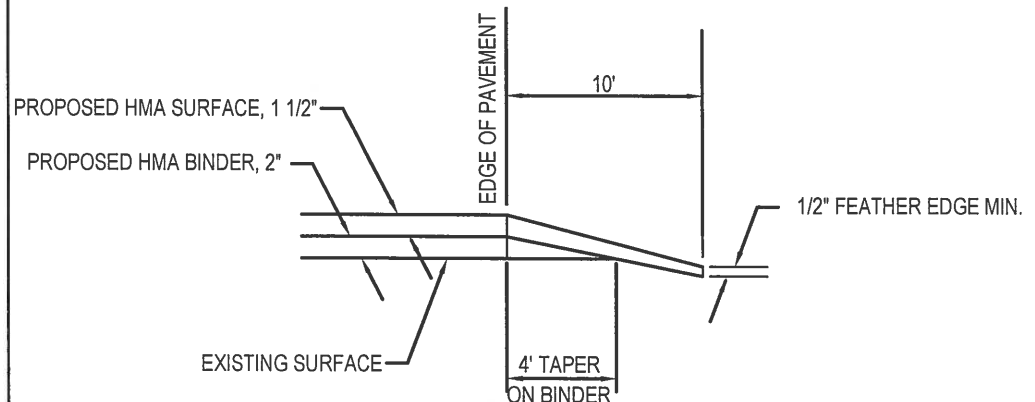

MISCELLANEOUS DETAILS & TYPICAL SECTIONS

SCHEDULE OF PAVEMENT MARKING LINE, 4"

| WESTBOUND LANE |                     |                  | EASTBOUND LANE |                           |                  |               |                         |
|----------------|---------------------|------------------|----------------|---------------------------|------------------|---------------|-------------------------|
| STATION        | NO PASSING (YELLOW) | PASSING (YELLOW) | STATION        | NO PASSING (YELLOW SOLID) | PASSING (YELLOW) | STATION       | EDGE LINE (WHITE SOLID) |
| 0+00 TO 12+20  | 1220                |                  | 0+00 TO 10+13  |                           | 253              | 0+00 TO 82+55 | 16172                   |
| 12+20 TO 18+00 |                     | 145              | 10+13 TO 20+50 | 1037                      |                  |               |                         |
| 18+00 TO 23+00 | 500                 |                  | 20+50 TO 23+00 |                           | 63               |               |                         |
| 23+00 TO 25+00 |                     | 50               | 25+00 TO 27+50 |                           | 63               |               |                         |
| 25+00 TO 33+00 | 800                 |                  | 27+50 TO 32+00 | 450                       |                  |               |                         |
| 33+00 TO 35+40 |                     | 60               | 32+00 TO 33+00 |                           | 25               |               |                         |
| 35+40 TO 42+50 | 710                 |                  | 34+55 TO 42+50 | 795                       |                  |               |                         |
| 42+50 TO 66+00 |                     | 588              | 44+50 TO 52+00 | 750                       |                  |               |                         |
| 66+00 TO 76+00 | 1000                |                  | 66+00 TO 76+00 |                           | 250              |               |                         |
| 76+00 TO 82+55 |                     | 164              | 76+00 TO 82+55 | 655                       |                  |               |                         |
| TOTALS         | 4230                | 1007             |                | 3687                      | 654              |               | 16172                   |

FIELD ENTRANCE QUANTITIES

| ENTRANCES            | AGGREGATE SURFACE COURSE TYPE B, TON | HOT MIX ASPHALT SURFACE COURSE, MIX "C", N70, TON |
|----------------------|--------------------------------------|---|
| ONE (1) ENTRANCE     | 4                                    | 1   |
| TOTAL = 10 ENTRANCES | 40                                   | 10  |

COMMERCIAL ENTRANCE QUANTITIES

| ENTRANCES           | BITUMINOUS MATERIALS (PRIME COAT) GALLON | HOT MIX ASPHALT SURFACE COURSE, MIX "C", N70, TON |
|---------------------|--|---|
| ONE (1) ENTRANCE    | 18                                       | 4.5   |
| TOTAL = 5 ENTRANCES | 90                                       | 22.5  |

PRIVATE ENTRANCE QUANTITIES

| ENTRANCES           | BITUMINOUS MATERIALS (PRIME COAT) GALLON | HOT MIX ASPHALT SURFACE COURSE, MIX "C", N70, TON |
|---------------------|--|---|
| ONE (1) ENTRANCE    | 7  | 3   |
| TOTAL = 2 ENTRANCES | 14                                       | 6   |

SIDEROAD ENTRANCE QUANTITIES

| LOCATION            | HOT MIX ASPHALT SURFACE COURSE, MIX "C", N70, TON |
|---------------------|---|
| STA 25+67 RT        | 49.0  |
| STA 52+81 RT        | 5.7   |
| STA 52+85 LT        | 6.3   |
| STA 64+76 RT        | 9.5   |
| TOTAL = 4 SIDEROADS | 70.5  |

MILLING SCHEDULE

| LOCATION            | TYPE       | COLD MILLING |
|---------------------|------------|--------------|
| STA. 0+00 TO 0+30   | BUTT JOINT | 183 SQ YD    |
| STA. 9+83 TO 10+13  | BUTT JOINT | 67 SQ YD     |
| STA. 12+36 TO 12+66 | BUTT JOINT | 67 SQ YD     |
| STA. 25+67 RT       | BUTT JOINT | 583 SQ YD    |
| TOTAL               |            | 900 SQ YD    |

MISCELLANEOUS DETAILS

SCALE 1" = 200'

| ROUTE           | SECTION        | COUNTY   | SHEET NO. |
|-----------------|----------------|----------|-----------|
| CH 19           | 15-00185-00-RS | FRANKLIN | 4 OF 5    |
| CONTRACT 99 595 |                |          |           |

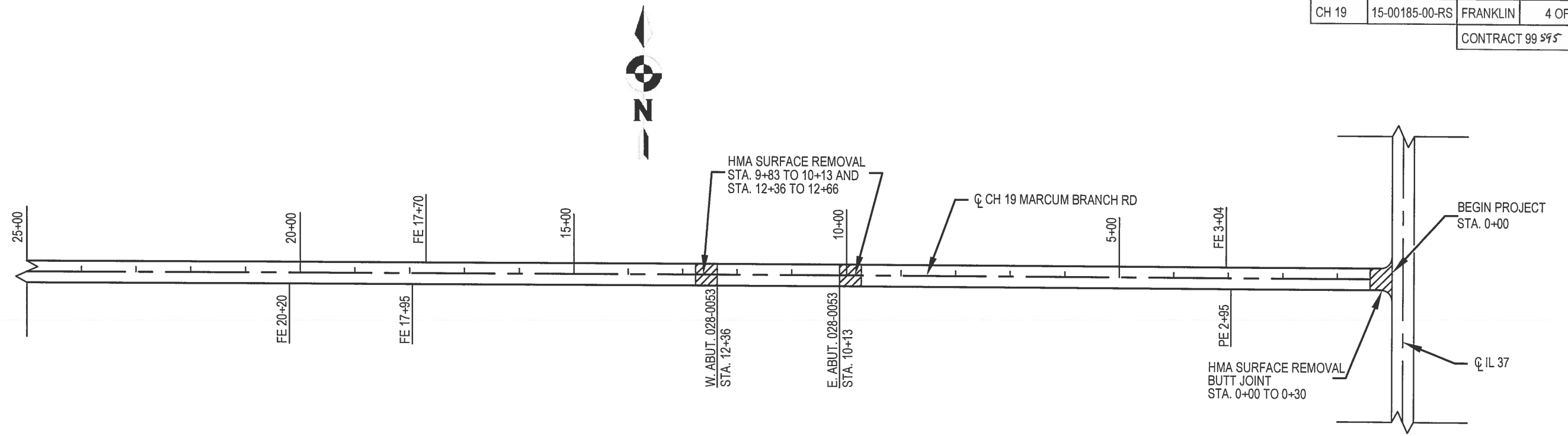

SCALE 1" = 200'

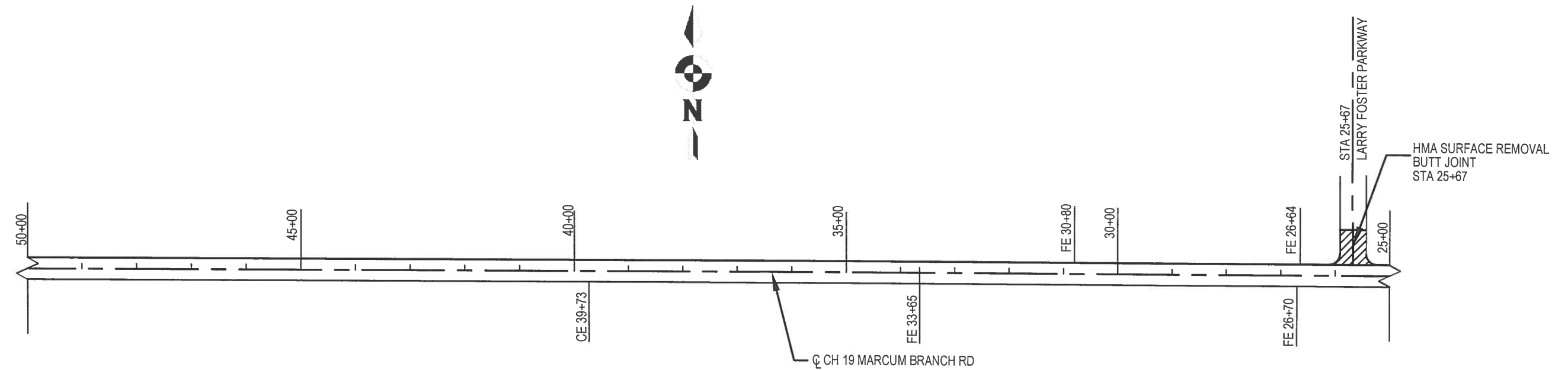

PLAN  
STATION 0+00 TO 50+00

SCALE 1" = 200'

| ROUTE | SECTION        | COUNTY   | SHEET NO. |
|-------|----------------|----------|-----------|
| CH 19 | 15-00185-00-RS | FRANKLIN | 5 OF 5    |

CONTRACT 99375

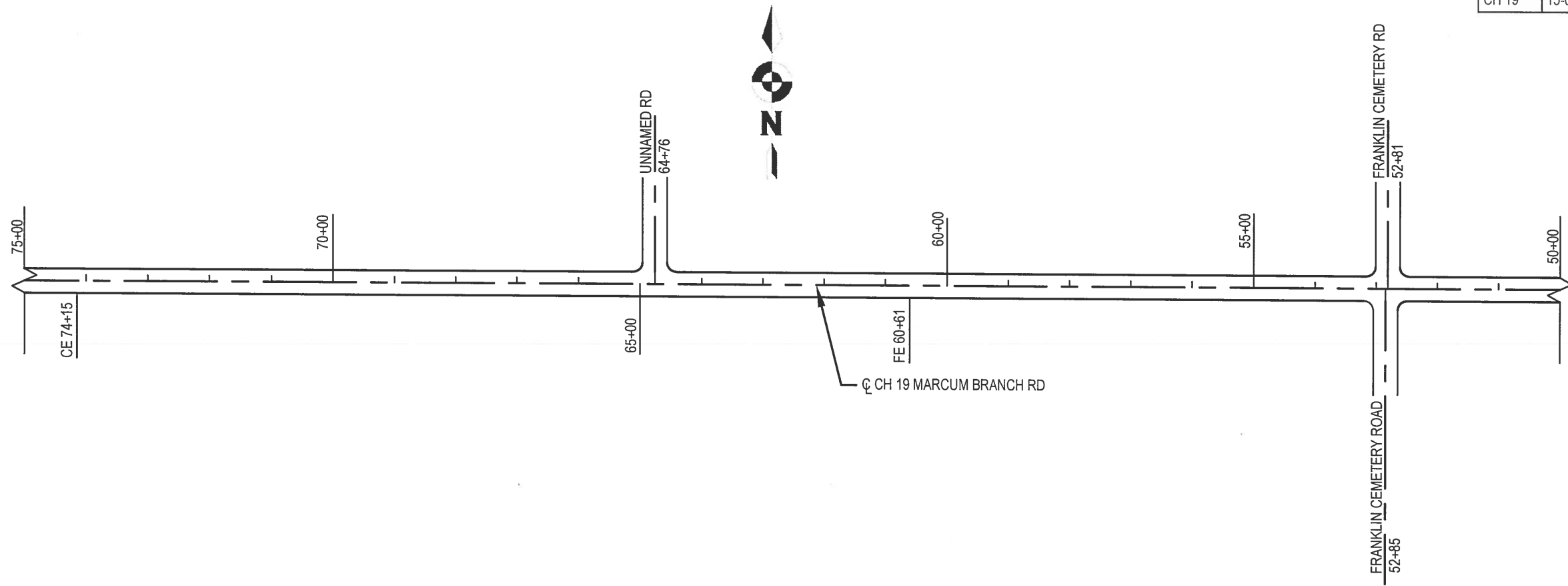

SCALE 1" = 200'

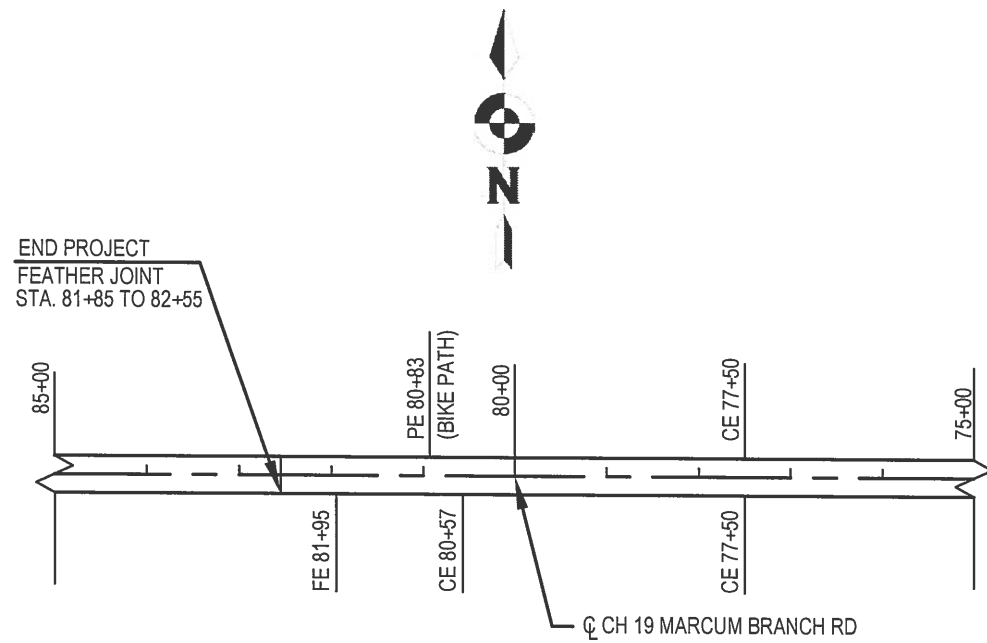

PLAN  
STATION 50+00 TO 82+55