

*REF-topo24
*REF-topo25

CONTRACT NO. 60A09

F.A.I. RTE.	SECTION	COUNTY	TOTAL SHEETS	SHEET NO.
I-57	2005-038 I	WILL	58	19
STA. 443+00		TO STA. 473+00		
FED. ROAD DIST. NO.	ILLINOIS	FED. AID PROJECT		

EXIST. CURVE I57-6
 PI STA. = 455+85.15
 $\Delta = 10^\circ 26' 16''$ (LT)
 $D = 0^\circ 28' 07''$
 $R = 12,229.00'$
 $T = 1,116.98'$
 $L = 2,227.78'$
 $E = 50.91'$
 $e = \text{---}$
 T.R. = ---
 S.E. RUN = ---
 P.C. STA. = 444+68.16
 P.T. STA. = 466+95.95

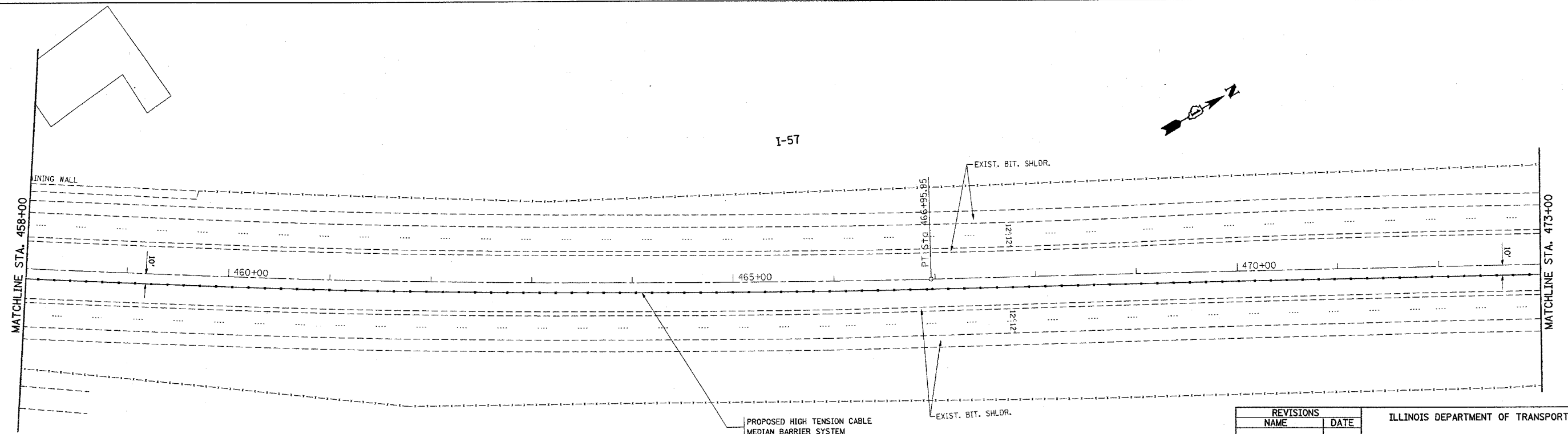
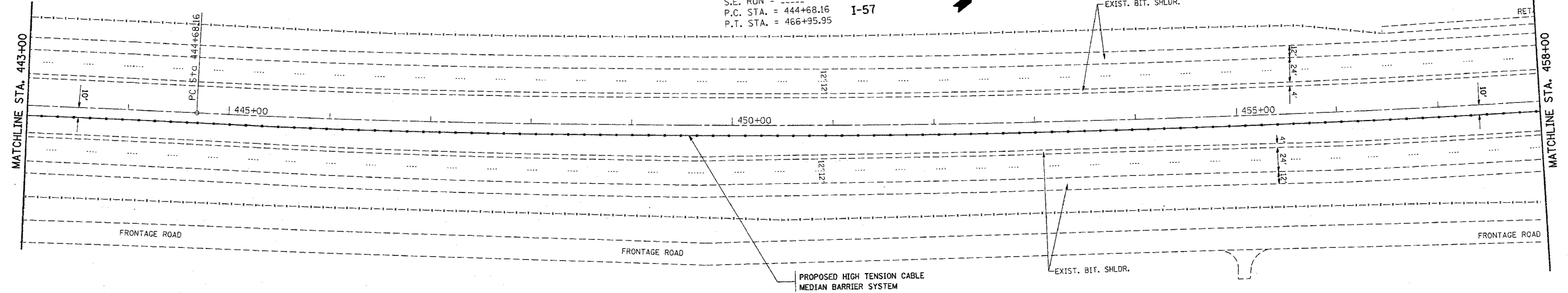

PLOT DATE = 1/4/2006
 FILE NAME = c:\p\proj\sect\27985\ah_rdyj_a.dgn
 USER = ah_rdyj
 SCALE = 1/4" = 50'

REVISIONS	
NAME	DATE

ILLINOIS DEPARTMENT OF TRANSPORTATION
 I-57 (I-80 TO COUNTY LINE RD.)
 PROPOSED PLAN
 SCALE: VERT. 1"=50'
 HORIZ. 1"=50'
 DATE 1/4/2006
 DRAWN BY
 CHECKED BY