

*REF-topo28
*REF-topo29

CONTRACT NO. 60A09

| F.A.I. RTE. | SECTION | COUNTY | TOTAL SHEETS | SHEET NO. |
|---------------------|------------|---------------------------|--------------|-----------|
| I-57 | 2005-038 I | WILL | 58 | 22 |
| STA. 503+00 | | TO STA. 533+00 | | |
| FED. ROAD DIST. NO. | | ILLINOIS FED. AID PROJECT | | |

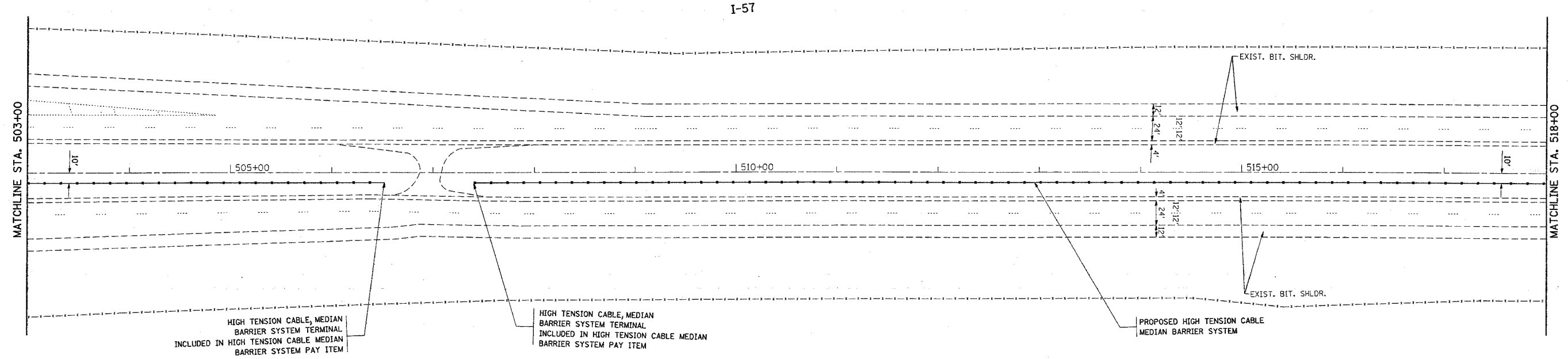

HIGH TENSION CABLE, MEDIAN BARRIER SYSTEM TERMINAL INCLUDED IN HIGH TENSION CABLE MEDIAN BARRIER SYSTEM PAY ITEM

HIGH TENSION CABLE, MEDIAN BARRIER SYSTEM TERMINAL INCLUDED IN HIGH TENSION CABLE MEDIAN BARRIER SYSTEM PAY ITEM

PROPOSED HIGH TENSION CABLE MEDIAN BARRIER SYSTEM

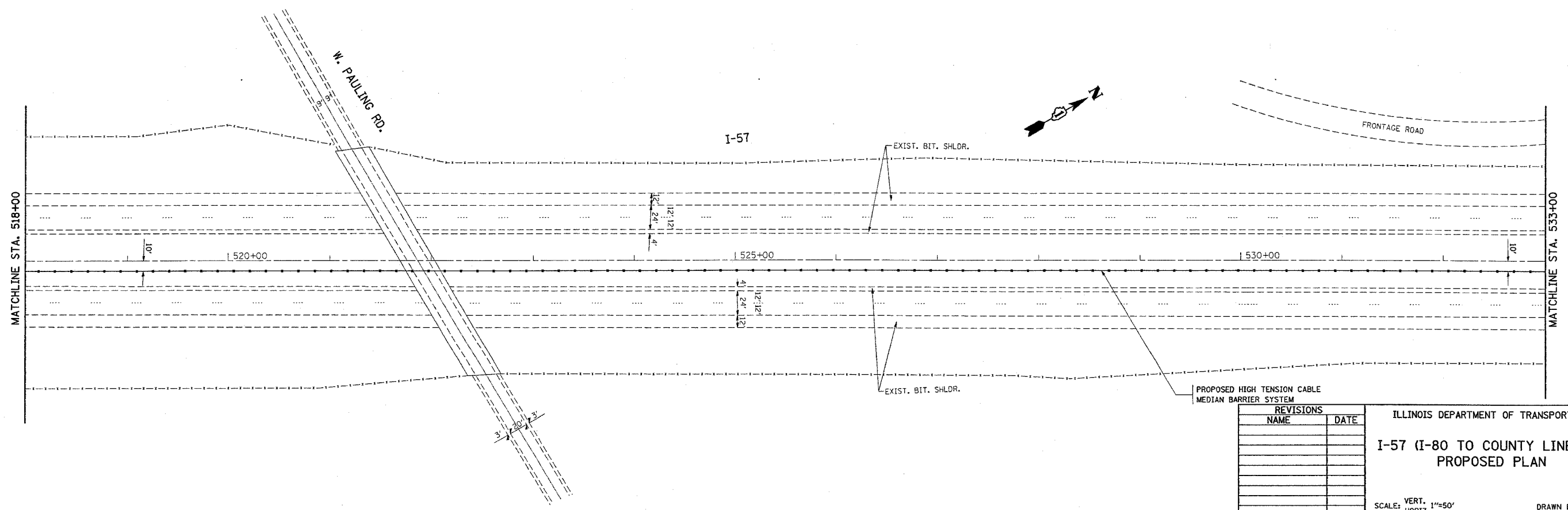

PROPOSED HIGH TENSION CABLE MEDIAN BARRIER SYSTEM

| REVISIONS | |
|-----------|------|
| NAME | DATE |
| | |
| | |
| | |
| | |
| | |
| | |
| | |
| | |
| | |
| | |

ILLINOIS DEPARTMENT OF TRANSPORTATION
I-57 (I-80 TO COUNTY LINE RD.)
PROPOSED PLAN

SCALE: VERT. 1"=50'
HORIZ. 1"=50'
DATE 1/4/2006

DRAWN BY
CHECKED BY

PLOT DATE = 1/4/2006
FILE NAME = c:\p\c\mets\dl27005\w\rdy\m.dgn
PLOT SCALE = 50.0000 / IN.
USER NAME = lrcelerf