

F.A.I. RTE.	SECTION	COUNTY	TOTAL SHEETS	SHEET NO.
I-57	2005-038.L	WILL	58	44
STA. 1118+00		TO STA. 1133+00		
FED. ROAD DIST. NO. ILLINOIS		FED. AID PROJECT		

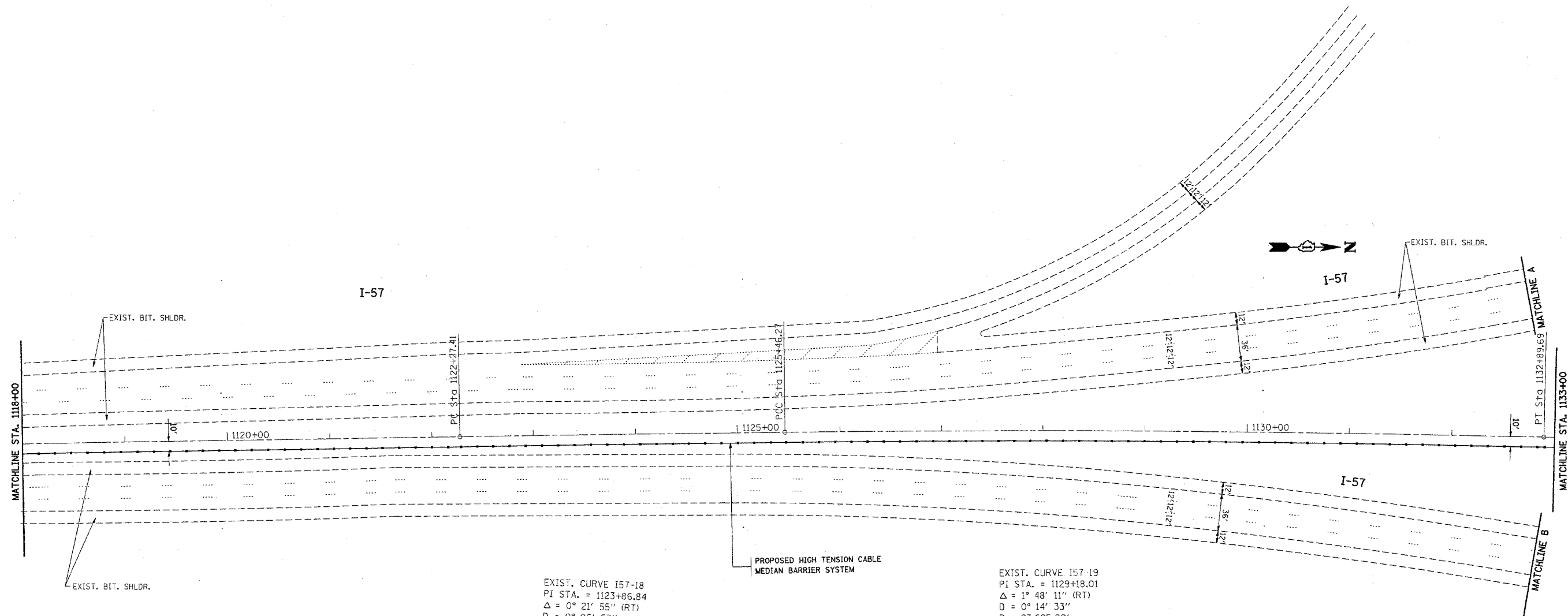

EXIST. CURVE 157-18
 PI STA. = 1123+86.84
 $\Delta = 0^\circ 21' 55''$ (RT)
 $D = 0^\circ 06' 53''$
 $R = 50,000.00'$
 $T = 159.43'$
 $L = 318.86'$
 $E = 0.25'$
 $e =$
 $T.R. =$
 $S.E. RUN =$
 $P.C. STA. = 1122+27.41$
 $P.T. STA. = 1125+46.27$

EXIST. CURVE 157-19
 PI STA. = 1129+18.01
 $\Delta = 1^\circ 48' 11''$ (RT)
 $D = 0^\circ 14' 33''$
 $R = 23,625.00'$
 $T = 371.74'$
 $L = 743.42'$
 $E = 2.92'$
 $e =$
 $T.R. =$
 $S.E. RUN =$
 $P.C. STA. = 1125+46.27$
 $P.T. STA. = 1132+89.69$

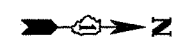

PLOT DATE = 1/4/2006
 PLOT SCALE = 1"=50'
 USER NAME = lrazakr

REVISIONS	
NAME	DATE

ILLINOIS DEPARTMENT OF TRANSPORTATION
PLAN I-57
 (I-80 TO COUNTYLINE RD.)
 PROPOSED PLAN

SCALE: VERT. 1"=50'
 HORIZ. 1"=50'
 DATE 1/4/2006

DRAWN BY
 CHECKED BY