

Existing Structure: Weigh Stations at Frankfort were originally built in 1969 as F.A.I. Route 80, Section (99-5, 99-5-1)I-1, Project I-80-4(104) 142 Will County. The existing concrete deck and upper 1'-0" of concrete pit perimeter are to be removed and replaced. Traffic will be detoured.

STATE OF ILLINOIS
DEPARTMENT OF TRANSPORTATION

ROUTE NO.	SECTION	COUNTY	SHEET	SHEET NO.
F.A.I. 80	2005-0561	Will	6	7
FED. ROAD DIST. NO. 7	ILLINOIS	FED. AID PROJECT-		

Contract #60A44

INDEX OF SHEETS

1. General Data
- 2-3. General Plan & Elevation
4. Concrete Removal Details
5. Concrete Deck Details
- 6-7. Concrete Pit Details

SCOPE OF WORK

1. Remove and replace concrete decks of the 4 platform scales.
2. Clean and paint structural steel.
3. Remove and replace the top 1'-0" of the concrete pit on the perimeter of the 4 platform scales.

GENERAL NOTES

Reinforcement bars shall conform to the requirements of AASHTO M 31 or M 322, Grade 60.
Plan dimensions and details relative to existing structure have been taken from existing plans and are subject to nominal construction variations. It shall be the Contractor's responsibility to verify such dimensions and details in the field and make necessary approved adjustments prior to construction or ordering of materials. Such variations shall not be cause for additional compensation for a change in the scope of the work, however, the Contractor will be paid for the quantity actually furnished at the unit price for the work.
All construction joints shall be bonded.
The existing structural steel coating contains lead. The Contractor shall take appropriate precautions to deal with the presence of lead on this project.
The cost of any structure excavation shall be included with Concrete Removal.
Cleaning and painting of the existing structural steel shall be as specified in the special provision for "Cleaning and Painting Existing Steel Structures". All existing steel shall be cleaned per Near White Blast Cleaning-SSPC-SP10. All existing steel shall be painted according to the requirements of Paint System 1-02/E/U. The color of the final finish coat shall be Gray, Munsell No 5B 7/1.
The SSPC-QP1 and SSPC-QP2 Painting Contractor Certifications will not be required for for this Bridge.
Field welding of construction accessories will not be permitted to beams.
Prior to pouring the new concrete deck, all loose rust, loose mill scale, and other loose potentially detrimental foreign material shall be removed from the surfaces of the beams or girders in contact with concrete. The cost of this work will be included in the pay item covering removal of the existing concrete. All heavy rust and other tightly adhered potentially detrimental foreign matter shall also be removed from the surfaces of the beams or girders in contact with concrete. Tightly adhered paint may remain unless otherwise noted. This removal shall be accomplished by methods that will not damage the steel. The cost of this work will be paid for according to Article 109.04.
The Contractor shall fine the concrete surface of the platforms according to Article 420.11(e)(1) of the Standard Specifications. Cost included in Concrete Superstructure.

TOTAL BILL OF MATERIAL

ITEM	UNIT	SUPER	SUB	TOTAL
Concrete Superstructure	Cu. Yd.	41.5		41.5
Removal of Existing Concrete Deck	L. Sum	0.5		0.5
Reinforcement Bars, Epoxy Coated	Pound	14960		14960
Concrete Removal	Cu. Yd.		20.1	20.1
Protective Coat	Sq. Yd.	248.9		248.9
Furnishing and Erecting Structural Steel	Pound		10120	10120
Concrete Structures	Cu. Yd.		20.1	20.1
Reinforcement Bars	Pound		2540	2540
Cleaning and Painting Steel Bridge No. 2	L. Sum			1
Containment and Disposal of Lead Paint Cleaning Residues No. 2	L. Sum			1
Jack, Remove and Replace Load Cells	L. Sum			0.5

LOADING HS20-44

No future wearing surface allowed

DESIGN SPECIFICATIONS

1996 AASHTO w/ 1997 thru 2002 Interims

DESIGN STRESSES

NEW CONSTRUCTION

$f'_c = 3,500$ psi (Deck and Pit)
 $f_y = 60,000$ psi (Reinforcement)
 $f_y = 36,000$ psi (Structural Steel AASHTO M270 Grade 36)

FIELD UNITS

$f'_c = 1,000$ psi (Pit)
 $f_s = 20,000$ psi (Reinforcement)
 $f_s = 20,000$ psi (Structural Steel)

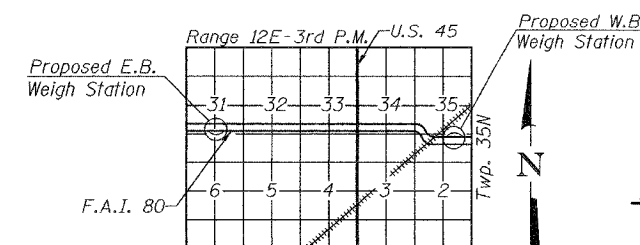

LOCATION SKETCH

GENERAL DATA
FRANKFORT WEIGH STATIONS
F.A.I. ROUTE 80 SECTION 2005-0561
WILL COUNTY
STA. 1212+05.06 (W.B.) &
STA. 989+44.94 (E.B.)

DESIGNED	Stephen M. Ryan
CHECKED	[Signature]
DRAWN	R. Sommer
CHECKED	SMR/PAL/SEM

January 20, 2006
EXAMINED [Signature]
PASSED [Signature]
ENGINEER OF BRIDGE DESIGN
ENGINEER OF BRIDGES AND STRUCTURES



EXPIRES 11-30-2006