

F.A.P. RTE.	SECTION	COUNTY	TOTAL SHEETS	SHEET NO.
330	91 Y-T	COOK	12	1

STATE OF ILLINOIS
DEPARTMENT OF TRANSPORTATION
DIVISION OF HIGHWAYS

PROPOSED HIGHWAY PLANS

FAP ROUTE 330: US 12 / 20 / 45 (MANNHEIM ROAD)
AT (1107 MANNHEIM RD.) NORTH OF IL 38 (ROOSEVELT RD.)

SECTION: 91Y - T
DRAINAGE IMPROVEMENT
COOK COUNTY
C-91-077-06

FOR INDEX OF SHEETS, SEE SHEET NO. 2

IMPROVEMENT IS LOCATED IN
THE VILLAGE OF WESTCHESTER

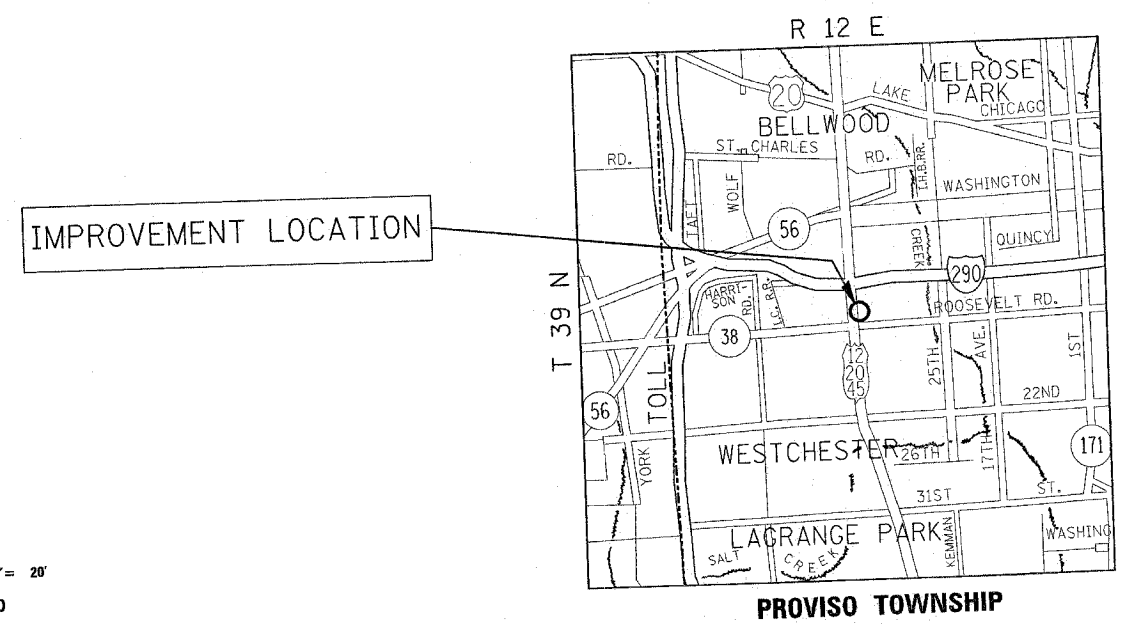
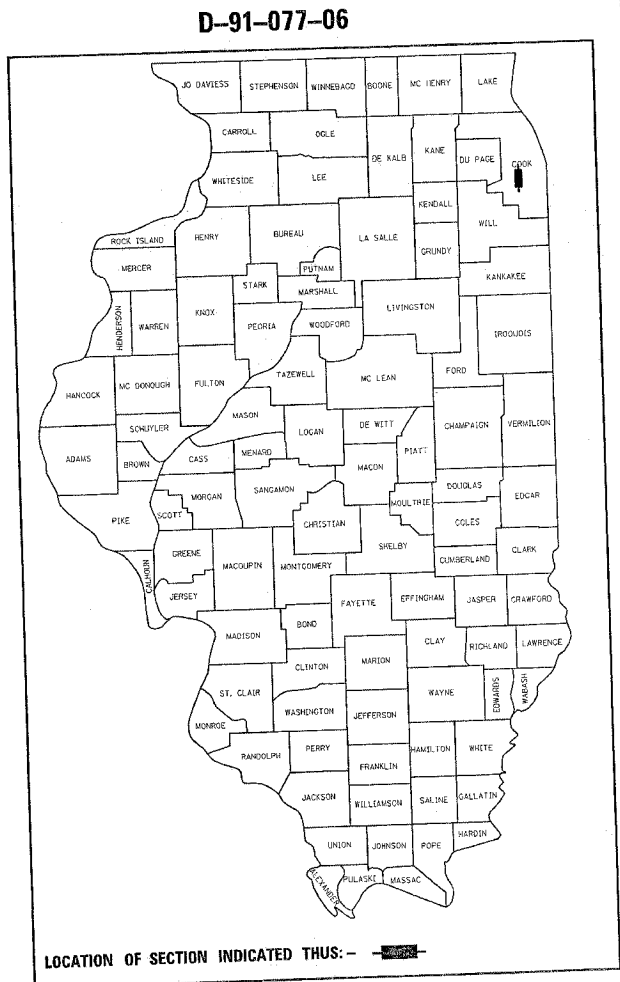

TRAFFIC DATA
2004 ADT = 44,800
POSTED SPEED LIMIT = 45 MPH

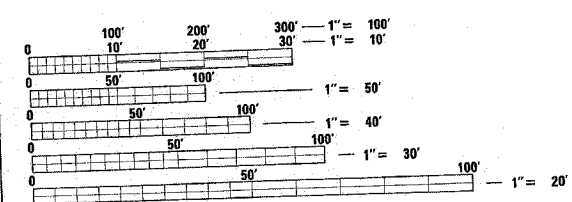

FULL SIZE PLANS HAVE BEEN PREPARED USING STANDARD ENGINEERING SCALES. REDUCED SIZED PLANS WILL NOT CONFORM TO STANDARD SCALES. IN MAKING MEASUREMENTS ON REDUCED PLANS, THE ABOVE SCALES MAY BE USED.

J.U.L.I.E.
JOINT UTILITY LOCATION INFORMATION FOR EXCAVATION
1-800-892-0123

STATE OF ILLINOIS
DEPARTMENT OF TRANSPORTATION
DIVISION OF HIGHWAYS

SUBMITTED Dec. 17 2005
Diane M. O'Keefe / CO
DEPUTY DIRECTOR OF HIGHWAYS, REGION ENGINEER

February 3, 2006
Mike Hine / RD
ENGINEER OF DESIGN AND ENVIRONMENT

February 3, 2006
Milton R. Sosa, P.E. / RD
DIRECTOR OF HIGHWAYS, CHIEF ENGINEER

PRINTED BY THE AUTHORITY
OF THE STATE OF ILLINOIS

CONTRACT NO. 60A59

DISTRICT ONE DESIGN PLAN PREPARATION ENGINEER: KEN ENG / JENPAI CHANG (847) 705-4432

F.A.P. RTE.	SECTION	COUNTY	TOTAL SHEETS	SHEET NO.
330	91 Y-T	COOK	12	2
STA.		TO STA.		
FED. ROAD DIST. NO. 1		ILLINOIS HIGHWAY PROJECT		

INDEX OF SHEETS

STATE STANDARDS

GENERAL NOTES

<u>SHEET NO.</u>	<u>DESCRIPTION</u>
1	TITLE SHEET
2	INDEX OF SHEETS, STATE STANDARDS, GENERAL NOTES & SUMMARY OF QUANTITIES
3	SUMMARY OF QUANTITIES
4	EXISTING TYPICAL SECTION
5	EXISTING BOX CULVERT (FOR INFORMATION ONLY)
6	EXISTING CONDITIONS
7	PROPOSED IMPROVEMENT
8	CURB OR CURB AND GUTTER REMOVAL AND REPLACEMENT
9	METHOD OF FLAGGING
10	TRAFFIC CONTROL AND PROTECTION FOR SIDE ROADS, INTERSECTIONS AND DRIVEWAYS
11	TRAFFIC CONTROL AND PROTECTION OF TURN BAYS (TO REMAIN OPEN TO TRAFFIC)
12	TEMPORARY INFORMATION SIGNING DETAIL

<u>STANDARD NO.</u>	<u>DESCRIPTION</u>
000001-01	TYPICAL SYMBOLS, ABBREVIATIONS AND PATTERNS
602001	CATCH BASIN, TYPE A
602401	MANHOLE, TYPE A
604001-02	FRAME AND LIDS, TYPE 1
606001-02	CONCRETE CURB AND COMBINATION CONCRETE CURB AND GUTTER
701101-01	OFF-ROAD OPERATIONS, MULTILANE, 15' TO 2' FROM PAVEMENT EDGE
701421-01	URBAN LANE CLOSURE, MULTILANE, DAY OPERATIONS ONLY, FOR SPEEDS 45 TO 55 MPH
701701-04	URBAN LANE CLOSURE, MULTILANE INTERSECTION
702001-05	TRAFFIC CONTROL DEVICES

BEFORE STARTING ANY EXCAVATION, THE CONTRACTOR SHALL CALL "JULIE" AT (800) 892-0123 FOR FIELD LOCATIONS OF BURIED ELECTRIC, TELEPHONE, AND GAS FACILITIES. (48 HOUR NOTIFICATION REQUIRED)

THE CONTRACTOR SHALL COORDINATE CONSTRUCTION ACTIVITIES WITH UTILITY COMPANIES AND THE VILLAGES OF HILLSIDE AND WESTCHESTER.

THE CONTRACTOR WILL NOT BE ABLE TO SET UP A YARD OR FIELD OFFICE ON STATE PROPERTY WITHOUT THE WRITTEN PERMISSION OF THE DEPARTMENT.

THE CONTRACTOR SHALL REPLACE ANY AND ALL PAVEMENT MARKINGS AND SIGNING DISTURBED OR DAMAGED BY WORK ACTIVITIES AT CONTRACTOR'S EXPENSE. REPLACEMENT FOR PAVEMENT MARKINGS SHALL BE POLYUREA. AND WHEN THIS HAPPENS THE RESIDENT ENGINEER SHALL CONTACT MR. SCOTT KUZNICKI, AREA TRAFFIC FIELD ENGINEER AT (847) 715-8423 A MINIMUM OF 72 HOURS PRIOR TO PLACEMENT OF PAVEMENT MARKING.

3 METERS (10 FEET) TRANSITION SHALL BE USED TO MATCH PROPOSED CURB AND GUTTER TO EXISTING CURB AND GUTTER IN THE FIELD, UNLESS OTHERWISE SHOWN. THE TRANSITION SHALL BE PAID FOR AT THE CONTRACT UNIT PRICE FOR THE PROPOSED ITEMS OF WORK SPECIFIED.

ALL PARKING LOT PAVEMENT, SIDEWALK, AND CURB & GUTTER REMOVED SHALL BE REPLACED "IN KIND".

MIXTURE TABLE

MIXTURE TYPE	AC/PG	RAP MAX	AIR VOIDS
BITUMINOUS CONCRETE SURFACE COURSE, SUPERPAVE, MIXTURE C, N50, 1 3/4"	PG 64-22	4% @ 50 GYR	15%
CLASS D PATCHES, 8" IL-19	PG 64-22	4% @ 70 GYR	15%

THE UNIT WEIGHT USED TO CALCULATE ALL BITUMINOUS MIXTURES IS 112 LB/SQ YD/IN

REVISIONS		ILLINOIS DEPARTMENT OF TRANSPORTATION
NAME	DATE	
		INDEX OF SHEETS, STATE STANDARDS, AND GENERAL NOTES
SCALE:	VERT. HORIZ.	DRAWN BY
DATE		CHECKED BY

PLOT DATE = 12/13/2005
 FILE NAME = c:\p\c\p\107706\design_002.dgn
 PLOT SCALE = 900000 / IN
 USER NAME = chngj

F.A.P. RTE.	SECTION	COUNTY	TOTAL SHEETS	SHEET NO.
330	91 Y - T	COOK	12	3
FED. ROAD DIST. NO. 1		ILLINOIS	HIGHWAY PROJECT	

SUMMARY OF QUANTITIES			TOTAL QUANTITIES	CONSTRUCTION TYPE CODE					
CODE NO	ITEM	UNIT		URBAN Y007					
20200100	EARTH EXCAVATION	CU YD	120	120					
20700420	POROUS GRANULAR EMBANKMENT, SUBGRADE	CU YD	75	75					
20800150	TRENCH BACKFILL	CU YD	45	45					
28000500	INLET AND PIPE PROTECTION	EACH	2	2					
28000510	INLET FILTERS	EACH	2	2					
42001300	PROTECTIVE COAT	SQ YD	70	70					
42400200	PORTLAND CEMENT CONCRETE SIDEWALK 5"	SQ FT	50	50					
44000600	SIDEWALK REMOVAL	SQ FT	50	50					
44001700	COMBINATION CONCRETE CURB AND GUTTER REMOVAL AND REPLACEMENT	FOOT	20	20					
44201747	CLASS D PATCHES, TYPE IV, 8 INCH	SQ YD	40	40					
55039700	STORM SEWERS TO BE CLEANED	FOOT	25	25					
67100100	MOBILIZATION	L SUM	1	1					
70100310	TRAFFIC CONTROL AND PROTECTION, STANDARD 701421	L SUM	1	1					
70102635	TRAFFIC CONTROL AND PROTECTION, STANDARD 701701	L SUM	1	1					
X0322256	TEMPORARY INFORMATION SIGNING	SQ FT	25.7	25.7					
X4066414	BITUMINOUS CONCRETE SURFACE COURSE, SUPERPAVE, MIX "C", N50	TON	4	4					
XX004210	DUCTILE IRON PIPE STORM SEWERS, 12"	FOOT	50	50					
XX146400	STORM SEWER REMOVAL	FOOT	35	35					
Z0018500	DRAINAGE STRUCTURES TO BE CLEANED	EACH	1	1					
XX006262	STEEL CASING PIPE AUGGERED AND JACKED 24"	FOOT	55	55					

SUMMARY OF QUANTITIES			TOTAL QUANTITIES	CONSTRUCTION TYPE CODE					
CODE NO	ITEM	UNIT							

12/13/2005 8:58:03 AM

REVISIONS	
NAME	DATE

ILLINOIS DEPARTMENT OF TRANSPORTATION
SUMMARY OF QUANTITIES

Rev.

CONTRACT NO. 60A59				
F.A.P. RTE.	SECTION	COUNTY	TOTAL SHEETS	SHEET NO.
330	91 Y - T	COOK	12	4
STA.		TO STA.		
FED. ROAD DIST. NO. 1		ILLINOIS HIGHWAY PROJECT		

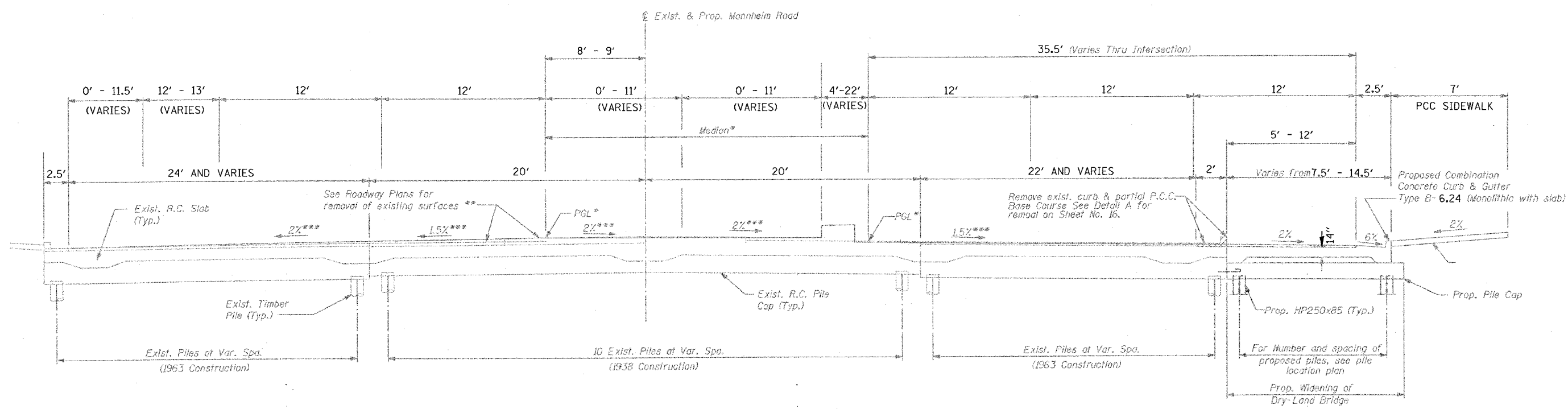

TYPICAL SECTION: US 12/20/45 (MANNHEIM RD.)

* PGL RUNS ALONG OTUSIDE EDGES OF MEDIAN

NOTE:

DASHED LINES INDICATE EXISTING CONDITIONS PRIOR TO CONSTRUCTION OF THE HILLSIDE STRANGLER IN THE YEAR 2000

SOLID LINES INDICATE PROPOSED IMPROVEMENT AT THAT TIME. THEREFORE, THEY CURRENTLY WOULD BE EXISTING.

REVISIONS	
NAME	DATE

ILLINOIS DEPARTMENT OF TRANSPORTATION

US 12/20/45 (MANNHEIM RD.)

TYPICAL SECTION

DRY LAND BRIDGE

SCALE: VERT. _____

HORIZ. _____

DATE _____

DRAWN BY _____

CHECKED BY _____

PLOT DATE = 11/21/2005
 FILE NAME = c:\projects\dl07786\design02.dgn
 PLOT SCALE = 5/8"=1' IN.
 USER NAME = grant

CONTRACT NO. 60A59				
F.A.P. RTE.	SECTION	COUNTY	TOTAL SHEETS	SHEET NO.
330	91 Y - T	COOK	12	5
STA.		TO STA.		
FED. ROAD DIST. NO.	ILLINOIS	HIGHWAY PROJECT		

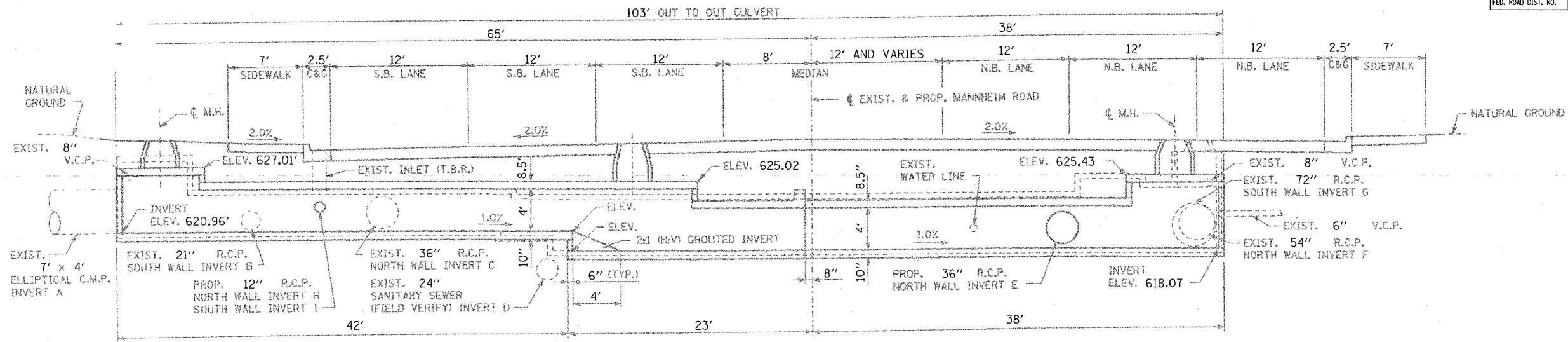

LONGITUDINAL SECTION

(SECTION TAKEN THRU CL OF CULVERT; LOOKING NORTH)

NOTE:
COST OF GROUTED INVERT IS INCLUDED
IN "CONCRETE BOX CULVERTS".

- C.I.P. - CAST-IN-PLACE
- C.M.P. - CORRUGATED METAL PIPE
- M.H. - MANHOLE
- R.C.P. - REINFORCED CONCRETE PIPE
- V.C.P. - VITRIFIED CLAY PIPE
- C&G - CURB AND CUTTER
- T.B.R. - TO BE REMOVED

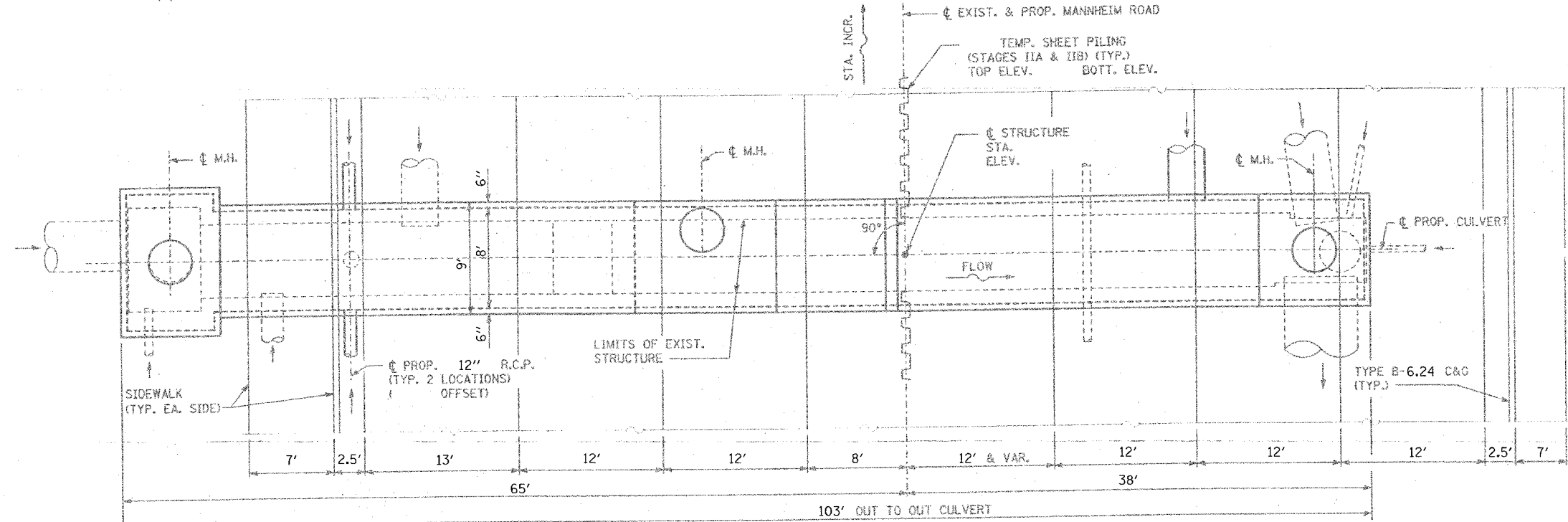

PLAN

NOTE:

DASHED LINES INDICATE EXISTING CONDITIONS PRIOR TO CONSTRUCTION OF THE HILLSIDE STRANGLER IN THE YEAR 2000

SOLID LINES INDICATE PROPOSED IMPROVEMENT AT THAT TIME. THEREFORE, THEY CURRENTLY WOULD BE EXISTING.

REVISIONS	
NAME	DATE

ILLINOIS DEPARTMENT OF TRANSPORTATION

US 12/20/45 (MANNHEIM RD.)

TYPICAL SECTION

DRY LAND BRIDGE

(FOR INFORMATION ONLY)

SCALE: VERT. _____

DATE: _____ HORIZ. _____

DRAWN BY _____

CHECKED BY _____

PLOT DATE = 11/21/2005
 FILE NAME = c:\p\projects\107796\design\road2.dgn
 PLOT SCALE = 50:0000 / 1" = 100'
 USER NAME = t-bank

CONTRACT NO. 60A59				
F.A.P. RTE.	SECTION	COUNTY	TOTAL SHEETS	SHEET NO.
330	91 Y - T	COOK	12	6
STA.		TO STA.		
FED. ROAD DIST. NO. 1		ILLINOIS HIGHWAY PROJECT		



LEGEND		
SANITARY SEWER	8" PVC	8" PVC
FORCE MAIN	FM - FM	FM - FM
STORM SEWER	8" RCP	8" RCP
UNDERDRAIN	UD	UD
MANHOLE	○	○
CATCH BASIN	○	○
INLET	□	□
CLEANOUT	○	○
WATER MAIN	W - 18"	W - 18"
VALVE VAULT	⊗	⊗
VALVE BOX	⊗	⊗
FIRE HYDRANT	⋈	⋈
UTILITY CROSSING	∩	∩
FLARED END SECTION	∩	∩
TRENCH BACKFILL	⊘	⊘
RIP RAP	⊘	⊘
STREET LIGHT/PARKING LOT LIGHT	⊘	⊘
POWER POLE	⊘	⊘
STREET SIGN	⊘	⊘
FENCE	X - X	X - X
GAS MAIN	G - 18"	G - 18"
OVERHEAD LINE	OH	OH
TELEPHONE LINE	T - T	T - T
ELECTRIC LINE	E - E	E - E
CABLE TV LINE	CATV - CATV	CATV - CATV
HIGH WATER LEVEL	HWL XX	HWL XX
NORMAL WATER LEVEL	NWL XX	NWL XX
CONTOUR LINE	XXXX	XXXX
TOP OF CURB ELEVATION	TC XXX.XX	TC XXX.XX
GUTTER ELEVATION	G XXX.XX	G XXX.XX
SPOT ELEVATION	XXX.XX	XXX.XX
TOP OF FOUNDATION	TF XXX.XX	TF XXX.XX
GRADE AT FOUNDATION	GF XXX.XX	GF XXX.XX
HIGH OR LOW POINT	⊕ = ⊖	⊕ = ⊖
OVERLAND FLOOD ROUTE	→	→
PAVEMENT FLOW DIRECTION	→	→
SWALE FLOW DIRECTION	→	→
DEPRESSED CURB AND GUTTER	▬	▬
REVERSE CURB AND GUTTER	▬	▬

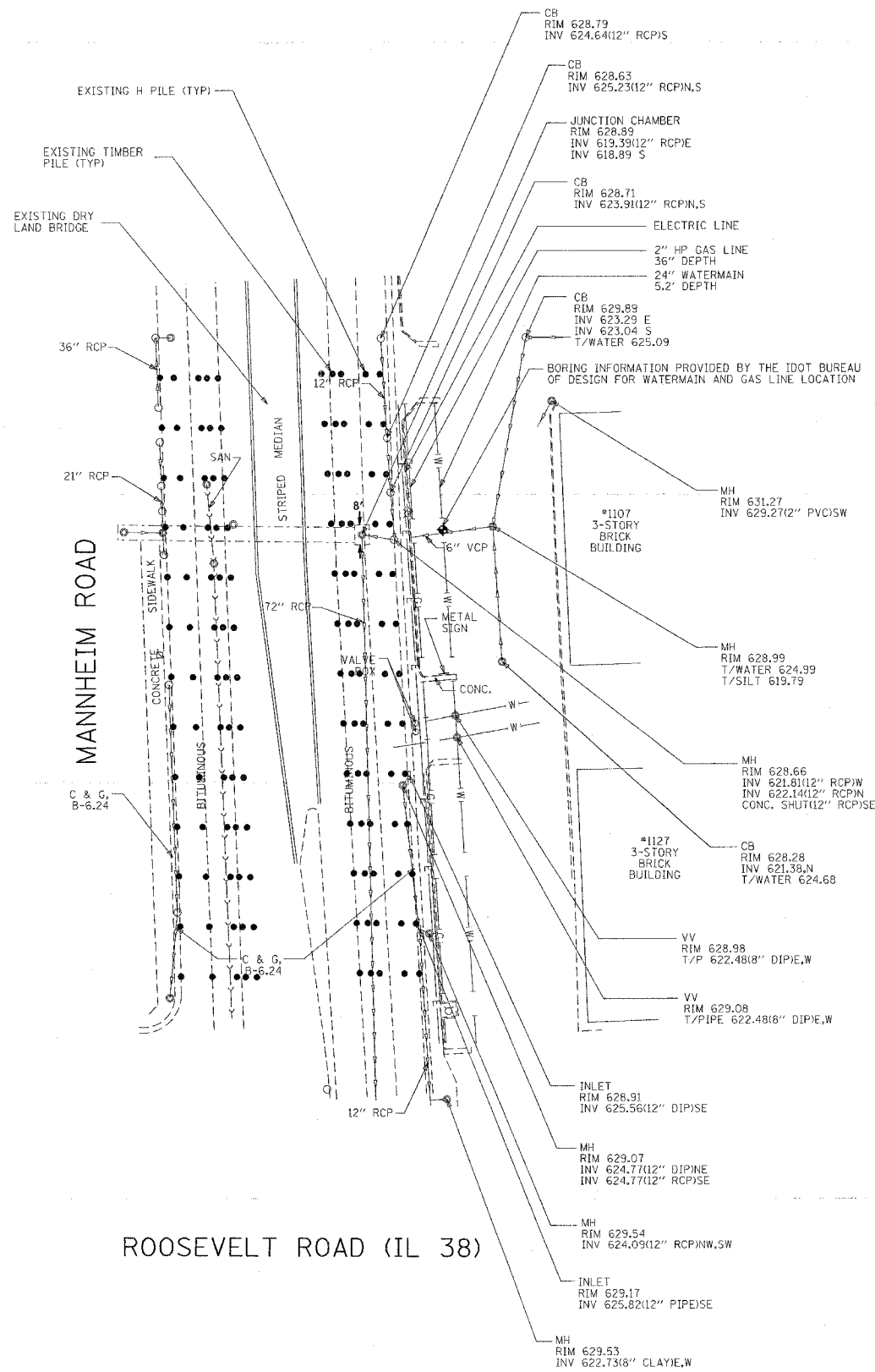

REVISIONS	
NAME	DATE

ILLINOIS DEPARTMENT OF TRANSPORTATION

EXISTING CONDITIONS

SCALE: VERT. 1" = 50'
HORIZ. DATE

DRAWN BY
CHECKED BY

PLOT DATE = 11/21/2005
PLOT SCALE = 50.0000' / IN.
USER NAME = trent

CONTRACT NO. 60A59				
F.A.P. RTE.	SECTION	COUNTY	TOTAL SHEETS	SHEET NO.
330	91 Y - T	COOK	12	7
STA.		TO STA.		
FED. ROAD DIST. NO. 1		ILLINOIS HIGHWAY PROJECT		

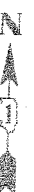
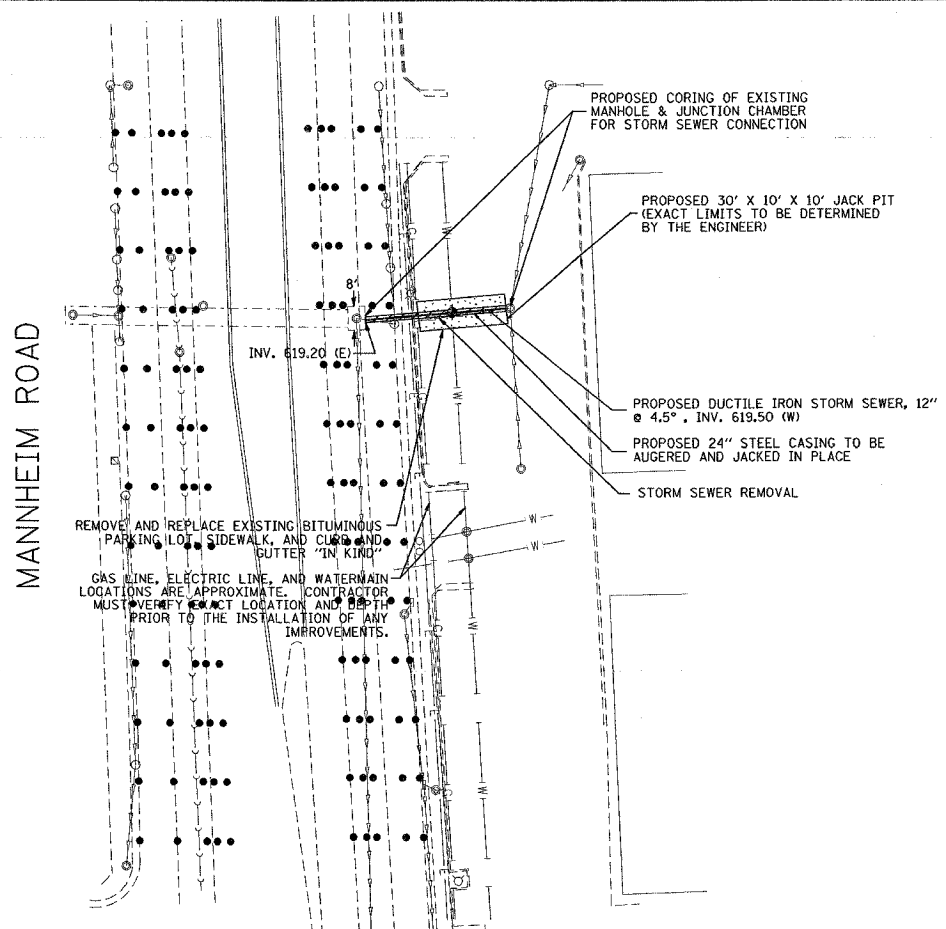

NOTE: THE PROPOSED STEEL CASING SHALL BE REINFORCED IN PREPARATION FOR AUGERING THROUGH P.G.E.

COST OF GROUT INVERT IS INCLUDED IN PROPOSED DUCTILE IRON STORM SEWER, 12"

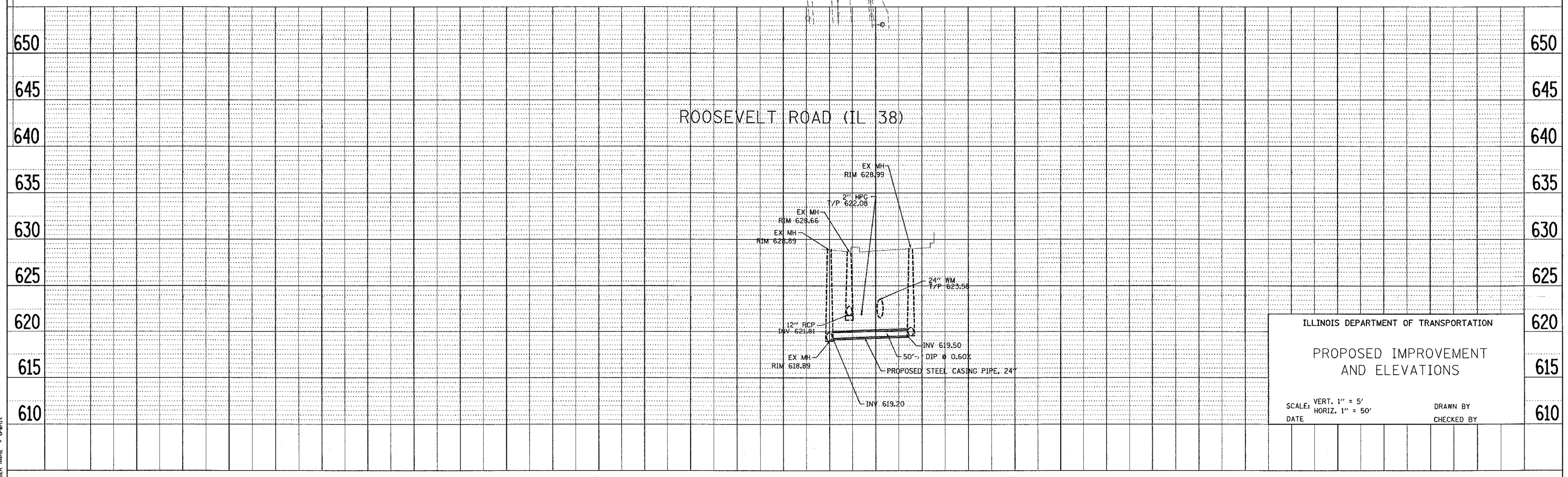

ILLINOIS DEPARTMENT OF TRANSPORTATION
PROPOSED IMPROVEMENT AND ELEVATIONS
 SCALE: VERT. 1" = 5'
 HORIZ. 1" = 50'
 DATE _____ DRAWN BY _____
 CHECKED BY _____

PLAN	DATE
DESIGNED	
CHECKED	
NOTED	
DATE	

PROFILE	DATE
DESIGNED	
CHECKED	
NOTED	
DATE	

PLOT DATE = 11/21/2005
 PLOT SCALE = 60.0000 / IN.
 USER NAME = t-rent

F. A. RTEL.	SECTION	COUNTY	TOTAL SHEETS	SHEET NO.
330	91Y-T	COOK	12	8
STA.		TO STA.		
FED. ROAD DIST. NO.		ILLINOIS	FED. AID PROJECT	

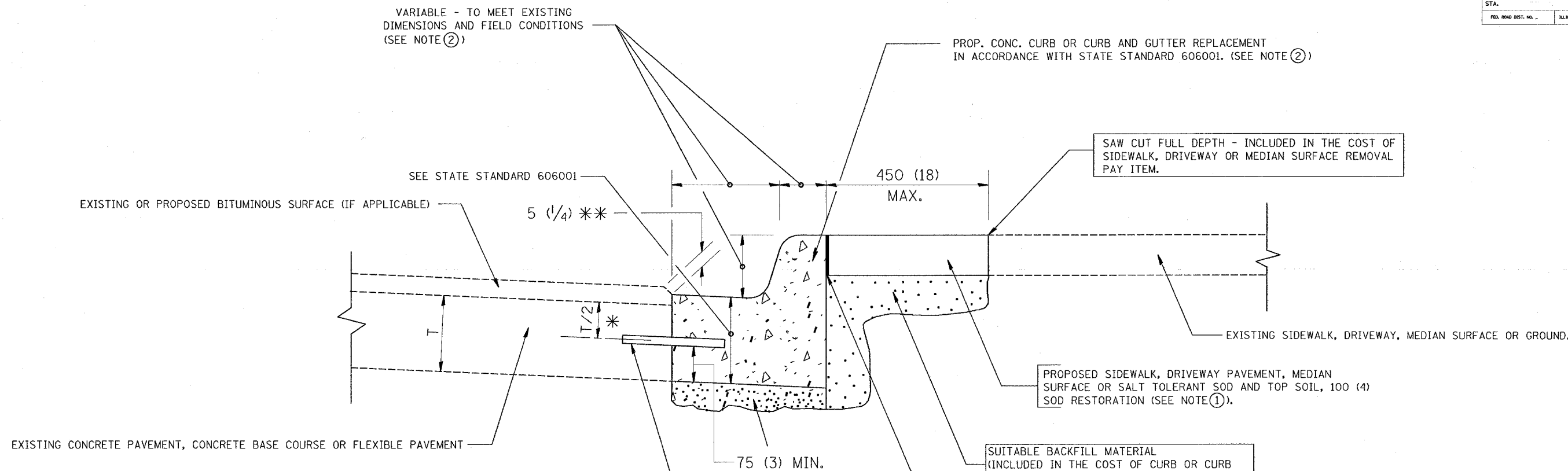

- * 75 (3) MINIMUM FROM TOP AND BOTTOM OF THE CONCRETE PAVEMENT OR BASE COURSE.
- * * IF THE FINAL SURFACE OF THE PAVEMENT IS CONCRETE, THE GUTTER IS TO BE FLUSH WITH THE PAVEMENT.

- NOTE: ① SIDEWALK, DRIVEWAY PAVEMENT OR MEDIAN SURFACE SHALL BE SIMILAR TO THE MATERIAL BEING REMOVED AND WILL BE PAID FOR SEPARATELY.
- SALT TOLERANT SOD AND TOP SOIL, 100 (4) RESTORATION WILL NOT BE PAID FOR SEPARATELY, BUT SHALL BE INCLUDED IN THE COST OF CURB OR CURB AND GUTTER REMOVAL AND REPLACEMENT.
- ② CURB OR CURB AND GUTTER REPLACEMENT SHALL MATCH THE SHAPE OF THE EXISTING CURB OR CURB AND GUTTER UNLESS OTHERWISE SPECIFIED.
- ③ FOR CURB OR CURB AND GUTTER REMOVAL AND REPLACEMENT ADJACENT TO FLEXIBLE PAVEMENT DELETE EPOXY COATED TIE BARS.
- ④ LONGITUDINAL BARS, IF ENCOUNTERED IN THE EXISTING CURB OR CURB AND GUTTER, ARE NOT TO BE REPLACED. CUTTING AND REMOVING LONGITUDINAL BARS SHALL BE INCLUDED IN THE COST OF CURB OR CURB AND GUTTER REMOVAL AND REPLACEMENT.
- ⑤ THE COST OF BITUMINOUS SURFACE REMOVAL IN THE EXISTING GUTTER FLAG SHALL BE INCLUDED IN THE COST OF THE CURB AND GUTTER REMOVAL AND REPLACEMENT.
- ⑥ THE REMOVAL AND REPLACEMENT OF THE EXISTING CURB OR CURB AND GUTTER SHALL BE DONE IN ACCORDANCE WITH THE APPLICABLE PORTIONS OF SECTION 440 AND 606 OF THE STANDARD SPECIFICATIONS.
- ⑦ THE LOCATIONS OF REMOVAL AND REPLACEMENT OF EXISTING CURB OR CURB AND GUTTER SHALL BE DETERMINED BY THE RESIDENT ENGINEER AT THE TIME OF CONSTRUCTION.

PROPOSED 20 (3/4) PREFORMED EXPANSION JOINT AT CONCRETE SIDEWALKS, DRIVEWAYS, AND MEDIANS. (INCLUDED IN THE COST OF CURB OR CURB AND GUTTER REMOVAL AND REPLACEMENT.)

UNSUITABLE SUB-BASE MATERIAL TO BE REMOVED, IF DIRECTED BY THE ENGINEER, SHALL BE REPLACED WITH EITHER SUB-BASE GRANULAR MATERIAL, TYPE B OR ADDITIONAL THICKNESS OF CONCRETE.

REMOVAL AND REPLACEMENT 100 (4) OR LESS IS INCLUDED IN THE COST OF CURB OR CURB AND GUTTER REMOVAL AND REPLACEMENT.

REMOVAL AND REPLACEMENT IN EXCESS OF 100 (4) WILL BE PAID FOR IN ACCORDANCE WITH ARTICLE 109.04 OF THE STANDARD SPECIFICATIONS.

PROPOSED NO. 20 (NO. 6) EPOXY COATED TIE BARS 600 (24) LONG AT 600 (24) CENTERS WILL NOT BE PAID FOR SEPARATELY. DELETE EPOXY COATED TIE BARS IF EXISTING TIE BARS ARE USABLE AS DETERMINED BY THE ENGINEER. (SEE NOTE ③).

BASIS OF PAYMENT:
THIS WORK WILL BE PAID FOR AT THE CONTRACT UNIT PRICE PER METER (FOOT) FOR "CURB REMOVAL AND REPLACEMENT" OR "COMBINATION CONCRETE CURB AND GUTTER REMOVAL AND REPLACEMENT".

CURB OR CURB AND GUTTER REMOVAL AND REPLACEMENT

ALL DIMENSIONS ARE IN MILLIMETERS (INCHES) UNLESS OTHERWISE SHOWN.

REVISIONS	
NAME	DATE
M. DE YONG	05/28/91
A. HOUSEH	03/11/94
R. SHAH	02/24/95
R. SHAH	03/02/95
R. SHAH	08/19/96
R. SHAH	09/12/96
R. SHAH	09/19/96
R. SHAH	10/03/96
A. ABBAS	03/21/97
M. GOMEZ	01/22/01

ILLINOIS DEPARTMENT OF TRANSPORTATION
**CURB OR
CURB AND GUTTER
REMOVAL AND REPLACEMENT**

SCALE: NONE
DATE 11/21/2005
DRAWN BY
CHECKED BY
BD600-06 (BD-24)

REVISION DATE: 12/06/88

F.A. RTE.	SECTION	COUNTY	TOTAL SHEETS	SHEET NO.
330	91Y-T	COOK	12	9
STA.		TO STA.		
FED. ROAD DIST. NO.		ILLINOIS	FED. AID PROJECT	

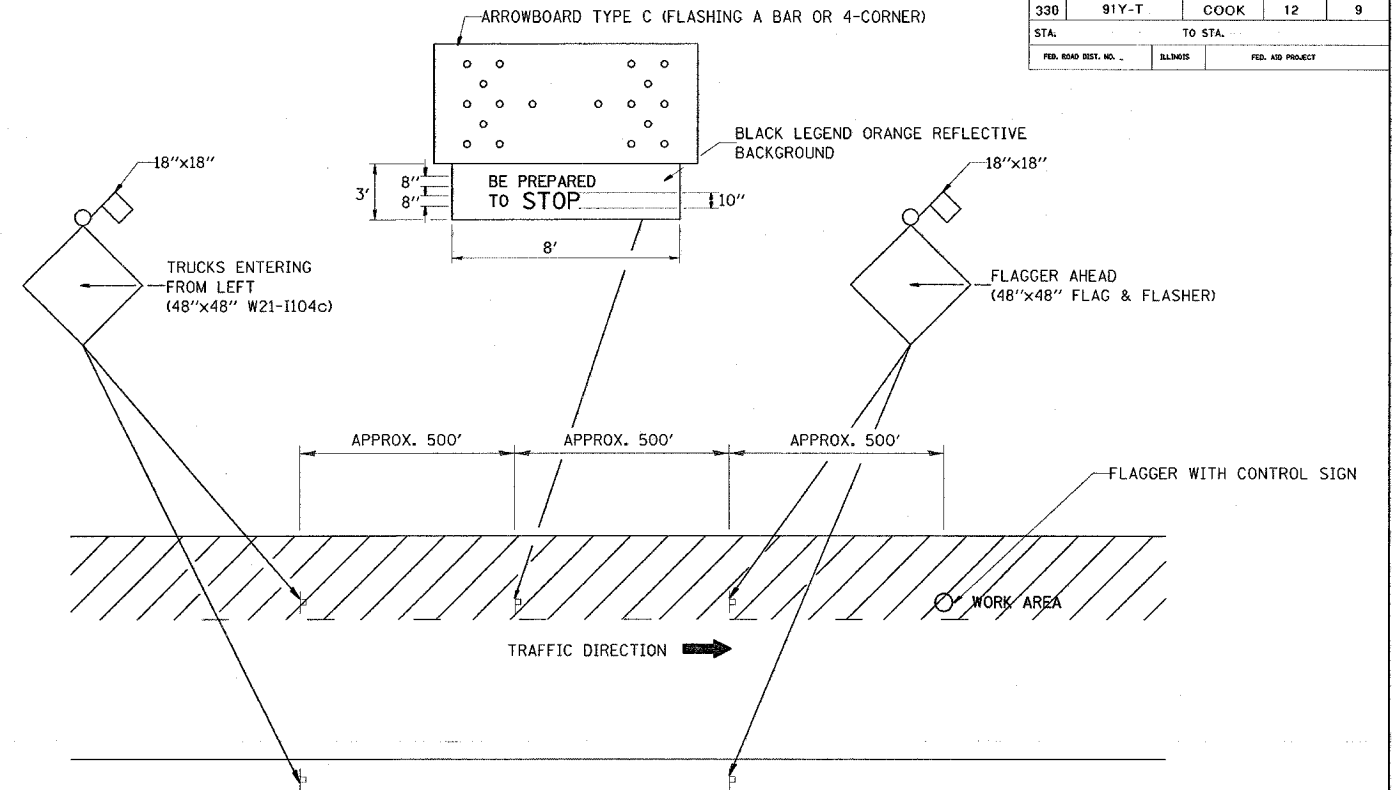

METHOD OF FLAGGING

NOTE:

1. SIGNS SHALL BE MOUNTED AT A MINIMUM CLEARANCE HEIGHT OF 5 FEET
2. ALL SIGNS SHALL BE REMOVED WHEN THE FLAGGING OPERATION CEASES.
3. THIS CASE ALSO APPLIES WHEN THE WORK ZONE IS ON THE RIGHT. UNDER THESE CONDITIONS "TRUCKS ENTERING FROM RIGHT" SIGNS SHALL BE SUBSTITUTED FOR "TRUCKS ENTERING FROM LEFT" SIGNS. ALSO THE ARROWBOARD AND "BE PREPARED TO STOP" SIGNS SHALL BE RELOCATED TO THE RIGHT SIDE OF THE ROAD.
4. WORK ZONE ACCESS POINTS SHOULD BE A MINIMUM OF ONE HALF MILE APART. MEDIAN WORK ZONE ACCESS POINTS SHOULD NOT BE LOCATED OPPOSITE OF EACH OTHER.
5. NIGHTTIME FLAGGING OPERATIONS: THE FLAG STATION SHALL BE LIGHTED WITH ADDITIONAL LIGHTS OTHER THAN STREET LIGHTS. THE FLAGGER CONTROL SIGN AND THE FLAGGER'S VEST SHALL BE REFLECTORIZED. IN ADDITION, THE FLAGGER SHALL HAVE A FLASHLIGHT OR LIGHTED WAND.

REVISIONS	
NAME	DATE
RAY RITCHIE	5/10/00

ILLINOIS DEPARTMENT OF TRANSPORTATION

METHOD OF FLAGGING

SCALE: NOT TO SCALE
DATE 11/21/2005

DRAWN BY C.A.D.
CHECKED BY
BM-14

REVISION DATE: 05/10/00

F.A. RTE.	SECTION	COUNTY	TOTAL SHEETS	SHEET NO.
330	91Y-T	COOK	12	10
STA.		TO STA.		
FED. ROAD DIST. NO. 1		ILLINOIS	FED. AID PROJECT	

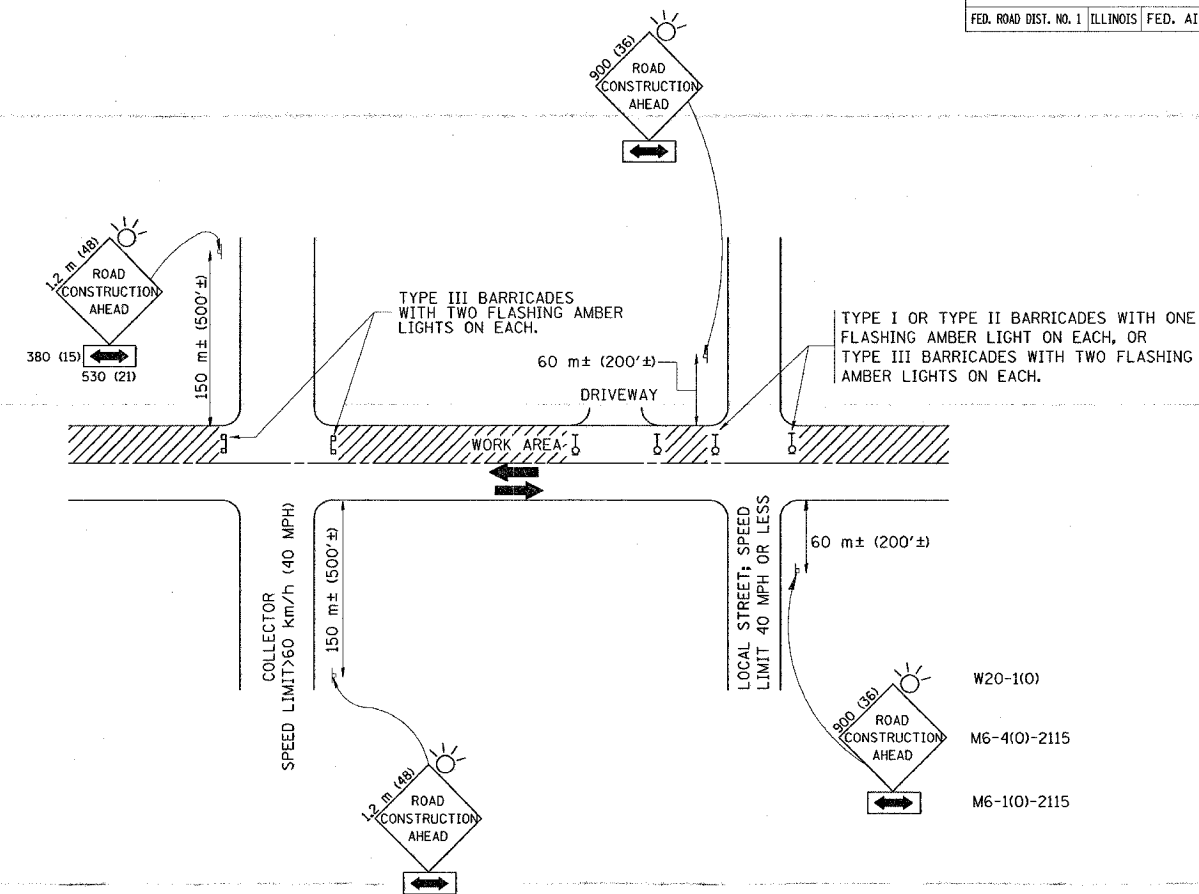

TRAFFIC CONTROL AND PROTECTION FOR SIDE ROADS, INTERSECTIONS, AND DRIVEWAYS

NOTES:

A. FOR NO LANE RESTRICTION ON THE SIDE ROAD OR DRIVEWAYS

- SIDE ROAD WITH A SPEED LIMIT OF 60 km/h (40 MPH) OR LESS AS SHOWN ON THE DRAWING AND AS DIRECTED BY THE ENGINEER:
 - ONE **ROAD CONSTRUCTION AHEAD** SIGN 900x900 (36x36) WITH A FLASHER AND FLAG MOUNTED ON IT APPROXIMATELY 60 m (200') IN ADVANCE OF THE MAIN ROUTE.
 - THE CLOSED PORTION OF THE MAIN ROUTE SHALL BE PROTECTED BY BLOCKING WITH TYPE I, TYPE II OR TYPE III BARRICADES, 1/3 OF THE CROSS SECTION OF THE CLOSED PORTION.
- SIDE ROAD WITH A SPEED LIMIT GREATER THAN 60 km/h (40 MPH) AS SHOWN ON THE DRAWING AND AS DIRECTED BY THE ENGINEER:
 - ONE **ROAD CONSTRUCTION AHEAD** SIGN 1.2 m x 1.2 m (48x48) WITH A FLASHER MOUNTED ON IT APPROXIMATELY 150 m (500') IN ADVANCE OF THE MAIN ROUTE.
 - THE CLOSED PORTION OF THE MAIN ROUTE SHALL BE PROTECTED BY BLOCKING WITH TYPE III BARRICADES, 1/2 OF THE CROSS SECTION OF THE CLOSED PORTION.
- WHEN THE SIDE ROAD LIES BETWEEN THE BEGINNING OF THE MAINLINE SIGNING AND THE WORK ZONE, A SINGLE HEADED ARROW (M6-1) SHALL BE USED IN LIEU OF THE DOUBLE HEADED ARROW (M6-4).

B. FOR A LANE CLOSURE ON A SIDE ROAD OR DRIVEWAY:

USE APPLICABLE PORTIONS OF THE TYPICAL APPLICATION OF TRAFFIC CONTROL DEVICES (STD. 701501, STD. 701606 OR THE APPROPRIATE STANDARD). THE SPACING OF SIGNS AND BARRICADES SHALL BE ADJUSTED FOR FIELD CONDITIONS AS DIRECTED BY THE ENGINEER. THE DIRECTIONAL ARROW SHALL BE COVERED OR REMOVED WHEN NO LONGER CONSISTENT WITH THE SIDE ROAD LANE CLOSURE.

C. ADVANCE WARNING SIGNS ARE TO BE OMITTED ON DRIVEWAY UNLESS OTHERWISE NOTED.

D. THE TRAFFIC CONTROL AND PROTECTION FOR SIDE ROADS, INTERSECTIONS, AND DRIVEWAYS SHALL BE INCIDENTAL TO THE COST OF SPECIFIED TRAFFIC CONTROL STANDARDS OR ITEMS.

REVISIONS	
NAME	DATE
LHA	6/89
T. RAMMACHER	09/08/94
J. OBERLE	10/18/95
A. HOUSEH	03/06/96
A. HOUSEH	10/15/96
T. RAMMACHER	01/06/00

ILLINOIS DEPARTMENT OF TRANSPORTATION
TRAFFIC CONTROL AND PROTECTION FOR SIDE ROADS, INTERSECTIONS, AND DRIVEWAYS

SCALE: VERT. HORIZ. DATE 11/21/2005

DRAWN BY CHECKED BY TC-10

REVISION DATE: 01/06/00



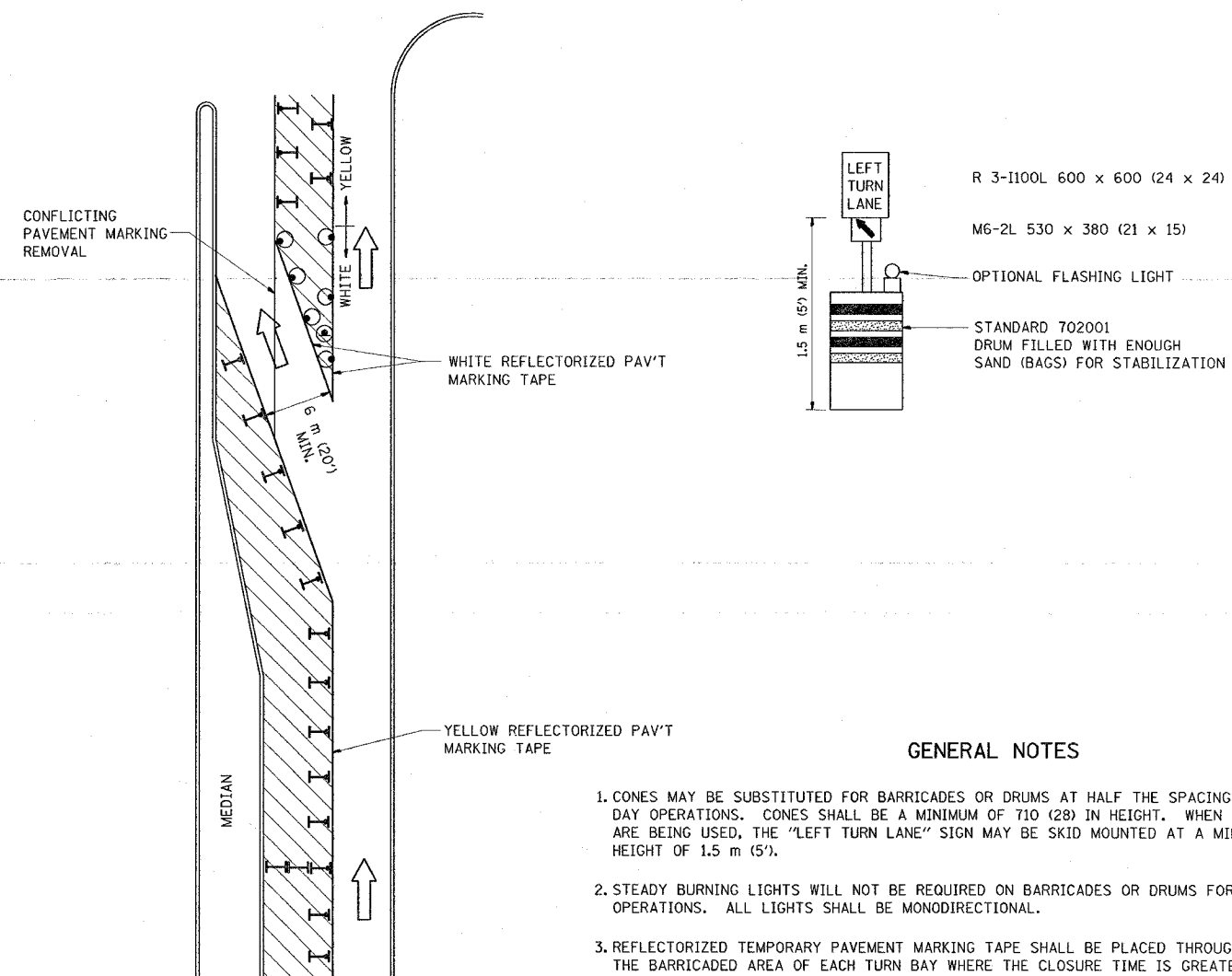



F. A. DIST.	SECTION	COUNTY	TOTAL SHEETS	SHEET NO.
330	91Y-T	COOK	12	11
STA.		TO STA.		
FED. ROAD DIST. NO.	ILLINOIS	FED. AID PROJECT		

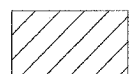

GENERAL NOTES

1. CONES MAY BE SUBSTITUTED FOR BARRICADES OR DRUMS AT HALF THE SPACING DURING DAY OPERATIONS. CONES SHALL BE A MINIMUM OF 710 (28) IN HEIGHT. WHEN CONES ARE BEING USED, THE "LEFT TURN LANE" SIGN MAY BE SKID MOUNTED AT A MINIMUM HEIGHT OF 1.5 m (5').
2. STEADY BURNING LIGHTS WILL NOT BE REQUIRED ON BARRICADES OR DRUMS FOR DAY OPERATIONS. ALL LIGHTS SHALL BE MONODIRECTIONAL.
3. REFLECTORIZED TEMPORARY PAVEMENT MARKING TAPE SHALL BE PLACED THROUGHOUT THE BARRICADED AREA OF EACH TURN BAY WHERE THE CLOSURE TIME IS GREATER THAN FOURTEEN DAYS.
4. THIS APPLICATION ALSO APPLIES WHEN WORK IS BEING PERFORMED IN THE RIGHT LANE(S) AND THE RIGHT TURN BAY IS TO REMAIN OPEN. UNDER THIS CONDITION, "RIGHT TURN LANE" R3-100 600 x 600 (24 x 24) AND M6-2R 530 x 380 (21 x 15) SHALL BE USED.
5. THESE CONTROLS SHALL SUPPLEMENT MAINLINE TRAFFIC CONTROL FOR LANE CLOSURES.
6. LONGITUDINAL DIMENSIONS MAY BE ADJUSTED TO FIT FIELD CONDITIONS.
7. FORM BT 725 IS REQUIRED.
8. TRAFFIC CONTROL AND PROTECTION AT TURN BAYS (TO REMAIN OPEN TO TRAFFIC) SHALL BE INCLUDED IN THE COST SPECIFIED TRAFFIC CONTROL STANDARDS OR ITEMS.

LEGEND

-  WORK AREA
-  LANE OPEN TO TRAFFIC
-  TYPE I OR II BARRICADE WITH STEADY BURN LIGHT
-  DRUM WITH STEADY BURN LIGHT
-  DRUM WITH SIGN (WITH OPTIONAL FLASHING LIGHT) SEE DETAIL
-  TYPE I OR II CHECK BARRICADE WITH FLASHING LIGHT

All dimensions are in millimeters (inches) unless otherwise shown.

ILLINOIS DEPARTMENT OF TRANSPORTATION
**TRAFFIC CONTROL AND PROTECTION
 AT TURN BAYS
 (TO REMAIN OPEN TO TRAFFIC)**

REVISIONS	
NAME	DATE
T. RAMMACHER	09/08/94
A. HOUSEH	11/07/95
A. HOUSEH	10/12/96
T. RAMMACHER	01/06/00

SCALE: NONE
 DATE: 11/21/2005
 DRAWN BY
 CHECKED BY LHA
 TC-14

REVISION DATE: 01/06/00

F.A. RTE.	SECTION	COUNTY	TOTAL SHEETS	SHEET NO.
330	91Y-T	COOK	12	12
STA.		TO STA.		
FED. ROAD DIST. NO. 1		ILLINOIS FED. AID PROJECT		

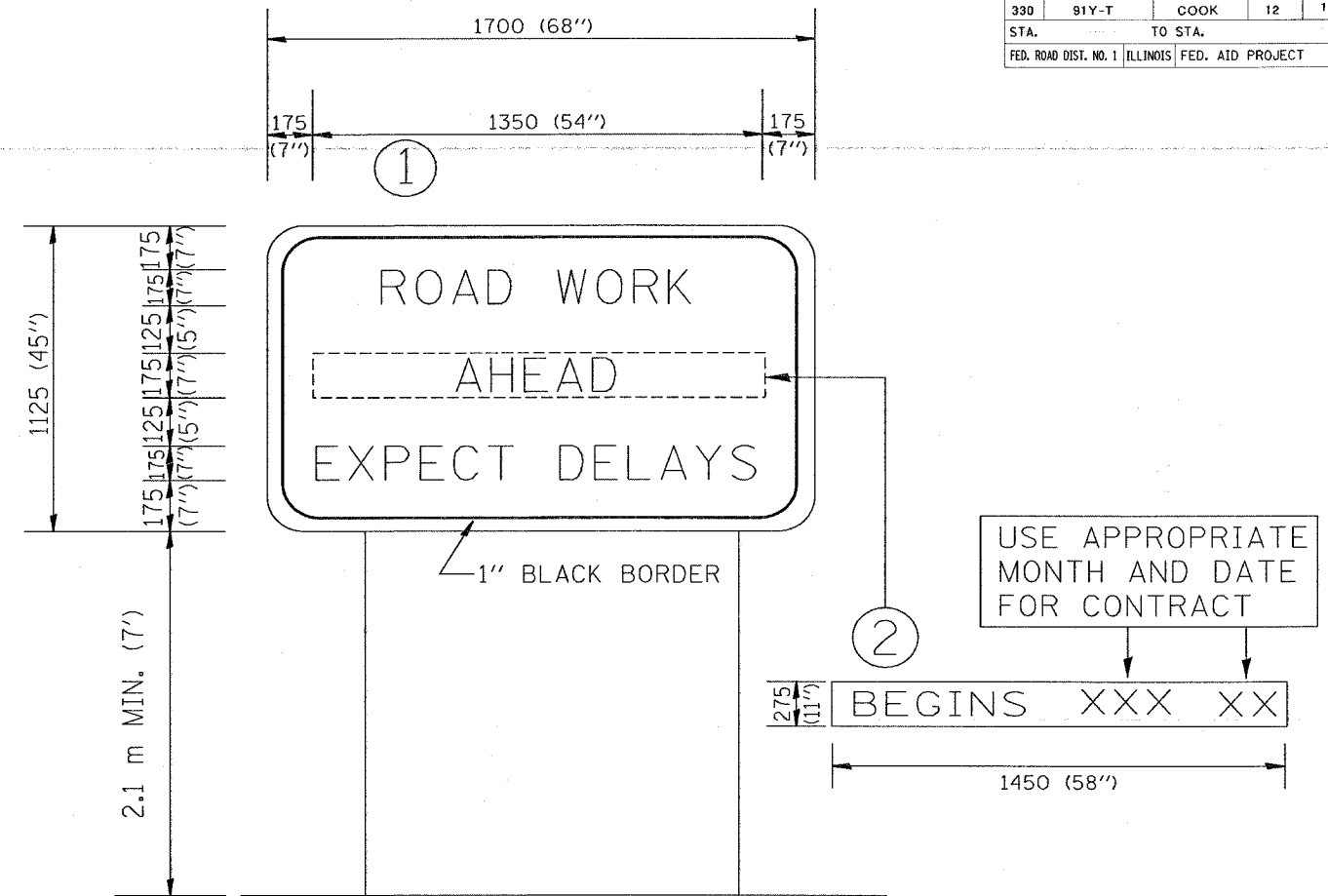

NOTES:

1. USE BLACK LETTERING ON ORANGE BACKGROUND.
2. ERECT SIGNS IN ADVANCE OF THE LOCATION FOR THE "ROAD CONSTRUCTION AHEAD" SIGN AT LOCATIONS AS DIRECTED BY THE ENGINEER.
3. ERECT SIGN ① WITH INSTALLED PANEL ② ONE WEEK PRIOR TO THE START OF CONSTRUCTION.
4. REMOVE PANEL ② SOON AFTER THE START OF CONSTRUCTION.
5. SEE SPECIAL PROVISION FOR "TEMPORARY INFORMATION SIGNING" FOR ADDITIONAL INFORMATION.
6. ONE SIGN ASSEMBLY EQUALS 2.3 SQ. M. (25.70 SQ. FT.)

ALL DIMENSIONS ARE IN MILLIMETERS (INCHES) UNLESS OTHERWISE SHOWN.

REVISIONS		ILLINOIS DEPARTMENT OF TRANSPORTATION TEMPORARY INFORMATION SIGNING
NAME	DATE	
R. MIRS	9-15-97	
R. MIRS	2-11-97	
T. RAMMACHER	2-2-99	

SCALE: DATE 11/21/2005
 DRAWN BY: BUR. OF DESIGN
 CHECKED BY: TC22
 REVISION DATE: 02/02/99