

62969

FAP RTE.	SECTION	COUNTY	TOTAL SHEETS	SHEET NO.
330	(102 & 102X) LS	COOK	14	1

STATE OF ILLINOIS  
DEPARTMENT OF TRANSPORTATION  
DIVISION OF HIGHWAYS

**PLANS FOR PROPOSED HIGHWAY**  
**F.A.P. 330 U.S. ROUTE 12/20/45 (LAGRANGE ROAD)**  
**IL. ROUTE 171 (ARCHER AVENUE) TO NORTH OF**  
**CAL SAG CHANNEL AND ORLAND TOWNSHIP IN**  
**UNINCORPORATED COOK COUNTY**  
**SECTION: (102 & 102X) LS**  
**LANDSCAPING /FOREST MANAGEMENT**  
**COOK COUNTY**  
**C-91-227-05**

**INDEX OF SHEETS**

- 1 TITLE SHEET  
LOCATION MAPS  
INDEX OF SHEETS  
HIGHWAY STANDARDS
- 2 SUMMARY OF QUANTITIES
- 3 SCHEDULE OF LANDSCAPE ITEMS  
GENERAL NOTES
- 4 CALENDAR OF LANDSCAPE  
CONSTRUCTION AND  
ESTABLISHMENT WORK
- 5-9 LANDSCAPING PLANS  
U.S. 12/20/45 (LA GRANGE ROAD)
- 10 RAMP F LANDSCAPE PLAN
- 11 TREE MITIGATION PLAN  
SCHEDULE OF QUANTITIES  
(TREE MITIGATION SITE ONLY)
- 12 FPDCC DEVELOPMENT PLAN  
TREE GROUPING KEY A
- 13-14 TREE GROUPING KEYS B - E

**LIST OF IDOT HIGHWAY STANDARDS**

- 701001-01
- 702001-05
- 701101-01
- 701006-01
- 701106-01
- 701311-02
- 701426-01

IMPROVEMENT IS LOCATED  
IN THE VILLAGE OF WILLOW  
SPRINGS AND UNINCORPORATED  
COOK COUNTY

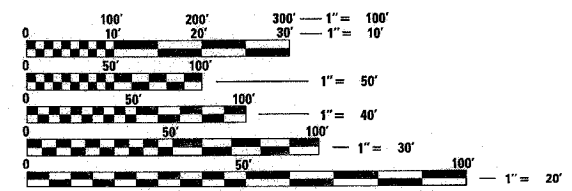

FULL SIZE PLANS HAVE BEEN PREPARED USING STANDARD  
ENGINEERING SCALES. REDUCED SIZED PLANS WILL NOT  
CONFORM TO STANDARD SCALES. IN MAKING MEASUREMENTS  
ON REDUCED PLANS, THE ABOVE SCALES MAY BE USED.

J.U.L.I.E.  
JOINT UTILITY LOCATION INFORMATION FOR EXCAVATION  
1-800-892-0123

**CONTRACT NO. 62969**

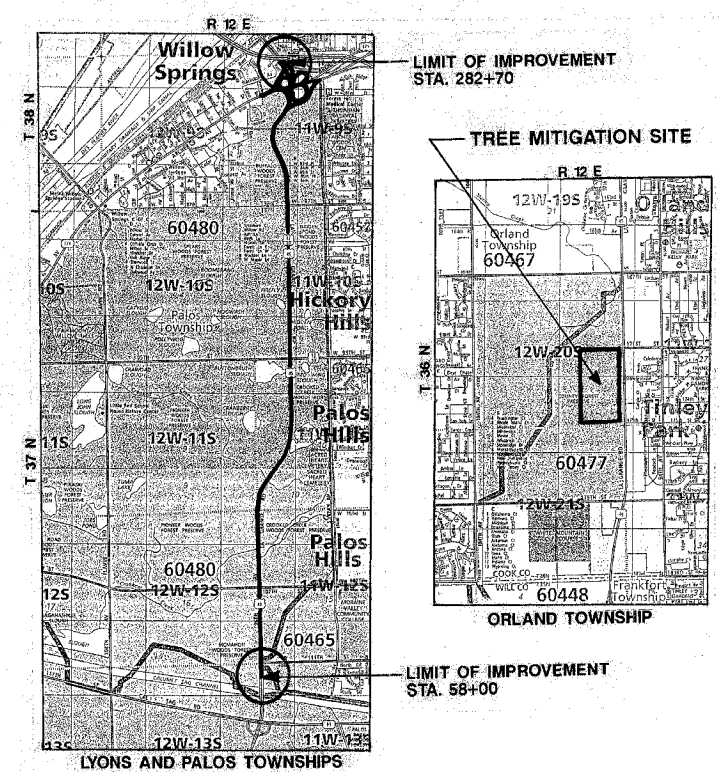
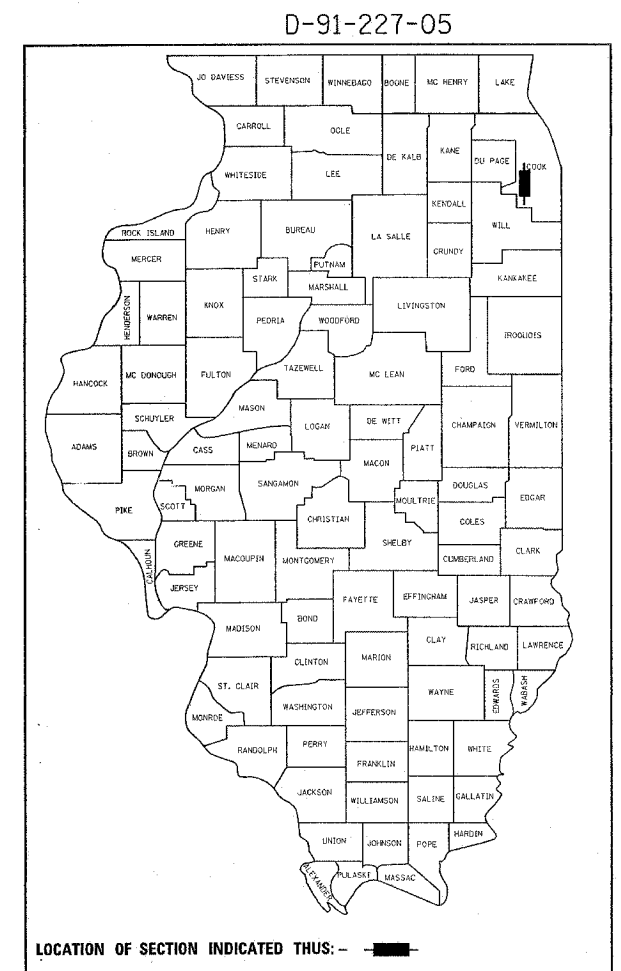

LOCATION MAPS  
SCALE: 1"=1300'

GROSS LENGTH OF PROJECT: 4.25 MILES  
NET LENGTH OF PROJECT: 4.25 MILES

STATE OF ILLINOIS  
DEPARTMENT OF TRANSPORTATION  
DIVISION OF HIGHWAYS

SUBMITTED Oct 26 20 05

Diane M. O'Keefe  
DEPUTY DIRECTOR OF HIGHWAYS, REGION ENGINEER

December 9, 20 05

Mike Hine  
ENGINEER OF DESIGN AND ENVIRONMENT

December 9, 20 05

Eric Harsh  
DEPUTY DIRECTOR OF HIGHWAYS, CHIEF ENGINEER

**PRINTED BY THE AUTHORITY  
OF THE STATE OF ILLINOIS**

DISTRICT ONE - BUREAU OF MAINTENANCE  
MAINTENANCE LANDSCAPE DESIGNER: R. WANNER / S. LIPKIE (847) 705-4171

SUMMARY OF QUANTITIES			TOTAL QUANTITIES	CONSTRUCTION TYPE CODE				
CODE NO	ITEM	UNIT		URBAN				
				100% STATE				
			Y003					
20101350	TREE PRUNING (OVER 10 INCH DIAMETER)	EACH	5	5				
25000400	NITROGEN FERTILIZER NUTRIENT	POUND	155	155				
25000750	MOWING	ACRE	24	24				
25200200	SUPPLEMENTAL WATERING	UNIT	60	60				
67100100	MOBILIZATION	L SUM	1	1				
A2002516	TREE, CARPINUS CAROLINIANA (AMERICAN HORNBEAM), 2" CALIPER, BALLED AND BURLAPPED	EACH	3	3				
A2006712	TREE, QUERCUS MACROCARPA (BUR OAK), 1-1/2" CALIPER, BALLED AND BURLAPPED	EACH	14	14				
A2007114	TREE, QUERCUS RUBRA (RED OAK), 1-3/4" CALIPER, BALLED AND BURLAPPED	EACH	14	14				
A2016614	TREE, QUERCUS ELLIPSOIDALIS (HILL'S OAK), 1-3/4" CALIPER, BALLED AND BURLAPPED	EACH	14	14				
B2000562	TREE, AMELANCHIER CANADENSIS (SHADBLOW SERVICEBERRY), 4' HEIGHT, SHRUB FORM, BALLED AND BURLAPPED	EACH	50	50				
B2001164	TREE, CERCIS CANADENSIS (EASTERN REDBUD) 5' HEIGHT, CLUMP FORM, BALLED AND BURLAPPED	EACH	8	8				
C2000524	SHRUB, ARONIA MELANOCARPA (BLACK CHOKE BERRY), 2' HEIGHT, BALLED AND BURLAPPED	EACH	50	50				
C2001124	SHRUB, CEPHALANTHUS OCCIDENTALIS (BUTTON BUSH), 2' HEIGHT, BALLED AND BURLAPPED	EACH	10	10				
C2002024	SHRUB, CORYLUS AMERICANA (AMERICAN FILBERT), 2' HEIGHT, BALLED AND BURLAPPED	EACH	490	490				
C2003348	SHRUB, HAMAMELIS VIRGINIANA (COMMON WITCHHAZEL), 4' HEIGHT, BALLED AND BURLAPPED	EACH	50	50				
C2C06024	SHRUB, RHUS TYPHINA (STAGHORN SUMAC), 2' HEIGHT, CONTAINER	EACH	20	20				
C2C09418	SHRUB, SALIX HUMILIS (PRAIRIE WILLOW), 18" HEIGHT, CONTAINER	EACH	150	150				
C2C09624	SHRUB, SAMBUCUS CANADENSIS (AMERICAN ELDER), 2' HEIGHT, CONTAINER	EACH	75	75				
D2001560	EVERGREEN, JUNIPERUS VIRGINIANA (EASTERN RED CEDAR), 5' HEIGHT, BALLED AND BURLAPPED	EACH	48	48				

SUMMARY OF QUANTITIES			TOTAL QUANTITIES	CONSTRUCTION TYPE CODE				
CODE NO	ITEM	UNIT		URBAN				
				100% STATE				
			Y003					
D2003848	EVERGREEN, THUJA OCCIDENTALIS TECHN (TECHNY ARBORVITAE), 4' HEIGHT, BALLED AND BURLAPPED	EACH	67	67				
X0322856	WEED CONTROL, NON-SELECTIVE AND NON-RESIDUAL	GALLON	2.5	2.5				
X0322859	WEED CONTROL, PRE-EMERGENT GRANULAR HERBICIDE	POUND	160	160				
Z0013798	CONSTRUCTION LAYOUT	L SUM	1	1				
A2C02463	TREE, CELTIS OCCIDENTALIS (HACKBERRY), <sup>COMMON</sup> CONTAINER GROWN, 3-GALLON	EACH	70	70				
A2C03563	TREE, JUGLANS NIGRA (BLACK WALNUT), CONTAINER GROWN, 3-GALLON	EACH	70	70				
A2C04163	TREE, OSTRYA VIRGINIANA (AMERICAN HOPHORNBEAM), CONTAINER GROWN, 3-GALLON	EACH	140	140				
A2C04963	TREE, QUERCUS ALBA (WHITE OAK), CONTAINER GROWN, 3-GALLON	EACH	180	180				
A2C05263	TREE, QUERCUS ELLIPSOIDALIS (HILL'S OAK), CONTAINER GROWN, 3-GALLON	EACH	40	40				
A2C05363	TREE, QUERCUS IMBRICARIA (SHINGLE OAK), CONTAINER GROWN, 3-GALLON	EACH	120	120				
A2C05663	TREE, QUERCUS MACROCARPA (BUR OAK), CONTAINER GROWN, 3-GALLON	EACH	450	450				
A2C06163	TREE, QUERCUS RUBRA (RED OAK), CONTAINER GROWN, 3-GALLON	EACH	190	190				
A2C07263	TREE, TILIA AMERICANA (AMERICAN LINDEN), CONTAINER GROWN, 3-GALLON	EACH	140	140				

10/27/2005

REVISIONS	
NAME	DATE

ILLINOIS DEPARTMENT OF TRANSPORTATION  
SUMMARY OF QUANTITIES  
U.S. RTE. 12/24/45  
(LA GRANGE ROAD)

REV.

SCHEDULE OF LANDSCAPE ITEMS										
ITEM	UNIT	TOTAL	SHEET NUMBER							
			5	6	7	8	9	10	11	
<b>SHADE TREES</b>										
Carpinus caroliniana (American Hornbeam), 2" Caliper, Balled & Burlapped	EACH	3		3						
Celtis occidentalis (Hackberry), Container Grown, 3-Gallon	EACH	70								70
Juglans nigra (Black Walnut), Container Grown, 3-Gallon	EACH	70								70
Ostrya virginiana (American Hophornbeam), Container Grown, 3-Gallon	EACH	140						60		80
Quercus alba (White Oak), Container Grown, 3-Gallon	EACH	270				50	50			170
Quercus ellipsoidalis (Hill's Oak), 1-3/4" Caliper, Balled & Burlapped	EACH	14								14
Quercus ellipsoidalis (Hill's Oak), Container Grown, 3-Gallon	EACH	40								40
Quercus imbricaria (Shingle Oak), Container Grown, 3-Gallon	EACH	120						60		60
Quercus macrocarpa (Bur Oak), 1-1/2" Caliper, Balled & Burlapped	EACH	14								14
Quercus macrocarpa (Bur Oak), Container Grown, 3-Gallon	EACH	360						50		310
Quercus rubra (Red Oak), 1-3/4" Caliper, Balled & Burlapped	EACH	14								14
Quercus rubra (Red Oak), Container Grown, 3-Gallon	EACH	190				50	50			90
Tilia americana (American Linden), Container Grown, 3-Gallon	EACH	140				50				90
<b>INTERMEDIATE TREES</b>										
Amelanchier canadensis (Shadblow Serviceberry), 4' Height, Shrub Form, B & B	EACH	50						50		
Cercis canadensis (Eastern Redbud), 5' Height, Clump Form, Balled & Burlapped	EACH	8	8							
<b>SHRUBS</b>										
Aronia melanocarpa (Black Chokeberry), 2' Height, Balled & Burlapped	EACH	50								50
Cephalanthus occidentalis (Buttonbush), 2' Height, Balled & Burlapped	EACH	10		10						
Corylus americana (American Filbert), 2' Height, Balled & Burlapped	EACH	490	200			200				90
Hamamelis virginiana (Common Witchhazel), 2' Height, Balled & Burlapped	EACH	50						50		
Rhus typhina (Staghorn Sumac), 2' Height, Container	EACH	20		20						
Salix humilis (Prairie Willow), 18" Height, Container	EACH	150								150
Sambucus canadensis (American Elder), 2' Height, Container	EACH	75								75
<b>EVERGREENS</b>										
Juniperus virginiana (Eastern Red Cedar), 5' Height, Balled & Burlapped	EACH	48								48
Thuja occidentalis Techny (Techny Arborvitae), 4' Height, Balled & Burlapped	EACH	67								67
<b>OTHER</b>										

**GENERAL NOTES**

BEFORE STARTING ANY EXCAVATION, THE CONTRACTOR SHALL CALL "J.U.L.I.E." AT (800) 892-0123 FOR FIELD LOCATIONS OF BURIED ELECTRIC, TELEPHONE AND GAS UTILITIES. (48 HOUR NOTIFICATION IS REQUIRED).

VILLAGE WATER, SEWER MAINS AND OTHER UTILITIES MAY BE LOCATED IN THE LANDSCAPE AREA. THE ACTUAL LOCATION OF PROPOSED LANDSCAPING WILL BE ADJUSTED IN THE FIELD TO AVOID UTILITIES. THE VILLAGE OF WILLOW SPRINGS AND THE FOREST PRESERVE DISTRICT OF COOK COUNTY ARE NOT PART OF "J.U.L.I.E." THE CONTRACTOR SHALL CONTACT THE RESPECTIVE VILLAGES TO LOCATE THEIR UTILITIES.

THE CONTRACTOR WILL NOT BE ALLOWED TO PROCEED WITH ANY PLANTING WORK UNTIL ALL UTILITY OWNERS FIELD LOCATE THEIR FACILITIES WHICH MAY INTERFERE WITH LANDSCAPING OPERATIONS.

THE CONTRACTOR WILL NOT BE ALLOWED TO SET UP A YARD OR FIELD OFFICE ON STATE PROPERTY OR FOREST PRESERVE HOLDINGS WITHOUT WRITTEN PERMISSION FROM THE DEPARTMENT OR THE FOREST PRESERVE DISTRICT OF COOK COUNTY.

IT SHALL BE THE CONTRACTOR'S RESPONSIBILITY TO VERIFY ALL DIMENSIONS AND CONDITIONS EXISTING IN THE FIELD PRIOR TO CONSTRUCTION AND ORDERING OF MATERIALS.

THE CONTRACTOR SHALL CONTACT THE DISTRICT ONE TRAFFIC CONTROL SUPERVISOR AT (847) 705-4155 A MINIMUM OF 72 HOURS IN ADVANCE OF BEGINNING WORK.

UNDERBRUSH OR DEBRIS AT PLANTING LOCATIONS SHALL BE REMOVED AND DISPOSED OF IN ACCORDANCE WITH SECTION 201 OF THE STANDARD SPECIFICATIONS. THIS WORK WILL NOT BE PAID FOR SEPARATELY, BUT THE COSTS SHALL BE CONSIDERED AS INCLUDED IN THE CONTRACT UNIT PRICES FOR THE CONSTRUCTION ITEMS INVOLVED, AND NO ADDITIONAL COMPENSATION WILL BE ALLOWED.

THE CONTRACTOR SHALL PROTECT ALL EXISTING PLANT MATERIAL FROM DAMAGE FOR WHICH THE CONTRACT DOES NOT PROVIDE REMOVAL. THE PROTECTION OF EXISTING PLANT MATERIAL AND THE REPAIR OR REPLACEMENT OF EXISTING PLANT MATERIAL DAMAGED BY THE CONTRACTOR SHALL BE DONE IN ACCORDANCE WITH THE REQUIREMENTS OF SECTION 201 OF THE STANDARD SPECIFICATIONS UNLESS OTHERWISE NOTED.

THE CONTRACTOR SHALL ORDER ALL CONTAINER TREES IMMEDIATELY FOLLOWING EXECUTION OF THE CONTRACT TO ASSURE AVAILABILITY OF THE PLANT MATERIAL FOR SPRING PLANTING.

THE RESIDENT ENGINEER IN COORDINATION WITH THE DISTRICT LANDSCAPE ARCHITECT WILL STAKE ALL TREE PLANTINGS AT THE TREE MITIGATION SITE. UNLESS OTHERWISE NOTIFIED, THE CONTRACTOR SHALL PROVIDE AN ADEQUATE NUMBER OF LATHES SEVERAL WEEKS PRIOR TO THE SCHEDULED TREE PLANTING.

WHERE MULCH BEDS ARE SPECIFIED, ALL EXISTING GRASS, WEEDS, AND DEBRIS ARE TO BE REMOVED AND THE BEDS TILLED TO A DEPTH OF 6 INCHES PRIOR TO PLACING PROPOSED PLANTS. FOLLOWING PLANTING, BEDS SHALL BE MULCHED TO A DEPTH OF 4 INCHES. THIS WORK WILL BE CONSIDERED INCLUDED IN THE CONTRACT UNIT PRICE FOR THE PLANTING ITEMS.

REVISIONS	
NAME	DATE

ILLINOIS DEPARTMENT OF TRANSPORTATION

**SCHEDULE OF LANDSCAPE ITEMS**

**GENERAL NOTES**

SCALE: VERT. \_\_\_\_\_  
 HORIZ. \_\_\_\_\_

DATE \_\_\_\_\_ DRAWN BY \_\_\_\_\_  
 CHECKED BY \_\_\_\_\_

### CALENDAR OF CONSTRUCTION AND ESTABLISHMENT WORK

Phase I	YEAR	WORK DATES		TREE MITIGATION SITE		CORRIDOR SITE	
		FROM	TO	CONSTRUCTION WORK	ESTABLISHMENT WORK	CONSTRUCTION WORK	ESTABLISHMENT WORK
Phase I	2005-2006	Prior to start of work		Layout of mowing areas by IDOT and others			
				Mowing designated areas by others			
				Layout of tree planting locations by IDOT and others			
			March 15			Selective Clearing	
		Thawed Soil	Apr. 1	Period of establishment plant care required for woody plants.*		Period of establishment plant care required for woody plants.*	
		Thawed Soil	Apr. 15	Finish installation of all container trees by April 15. Apply Pre-emergent Granular Herbicide.	1) Supplemental Watering of woody plants if required by Engineer. 2) Weed spray of non-selective, non-residual herbicide around planted trees if required by Engineer.	Finish installation of all container trees by April 15. Apply Pre-emergent Granular Herbicide.	1) Supplemental Watering of woody plants if required by Engineer. 2) Weed spray of non-selective, non-residual herbicide around planted trees if required by Engineer.
		Apr. 1	Apr. 15	Period of establishment plant care required for woody plants.*		Period of establishment plant care required for woody plants.*	
		April 17		Certification to the Bureau of Maintenance that all container trees have been installed and are in a live healthy condition and eligible for a May 15, 2006 period of establishment inspection.			
		Thawed Soil	Apr. 30			Install evergreens.	
		Apr. 15	Apr. 30			Period of establishment plant care required for woody plants.*	
		May 1	May 15			Period of establishment plant care required for woody plants.*	
		May 15	May 31	Installation of all required replacement container trees and all required clean up shall be completed by this date. Apply Pre-Emergent Granular Herbicide.		1) Installation of all required replacement container trees and all required clean up shall be completed by this date. Apply Pre-Emergent Granular Herbicide. 2) Period of establishment plant care required for woody plants.*	
	Thawed Soil	May 31			Finish installation of all woody plants by May 15. Apply Pre-Emergent Granular Herbicide.		

Phase II	YEAR	WORK DATES		TREE MITIGATION SITE		CORRIDOR SITE	
		FROM	TO				
Phase II	2006	June 1				Certification to the Bureau of Maintenance that all woody plants have been installed and are in a live healthy condition and eligible for a September 2006 period of establishment inspection.	
		June 1	June 15			Period of establishment plant care required for woody plants.*	
		June 15	June 30			Period of establishment plant care required for woody plants.*	
		July 1	July 15			Period of establishment plant care required for woody plants.*	
		July 15	July 31			Period of establishment plant care required for woody plants.*	
		Aug. 1	Aug. 15			Period of establishment plant care required for woody plants.*	
		Aug. 15	Aug. 31			Period of establishment plant care required for woody plants.*	
		Sept. 1	Sept. 15			Period of establishment plant care required for woody plants.*	
		Sept. 15	Sept. 30			Period of establishment plant care required for woody plants.*	

Phase III	YEAR	WORK DATES		CONSTRUCTION WORK	ESTABLISHMENT WORK	CONSTRUCTION WORK	ESTABLISHMENT WORK
		FROM	TO				
Phase III	2007	Thawed Soil	May 15			Installation of all required replacement woody plants, and all required clean up of woody plants shall be completed by this date.	Apply Pre-Emergent Granular Herbicide to all woody plants.
		May 15	May 31				Mow turf areas to a turf height of 3 inches.

\* Weeding, watering and other work which is necessary to maintain health and satisfactory appearance of the planting is included in the cost of the contract.

ILLINOIS DEPARTMENT OF TRANSPORTATION	
<b>CALENDAR OF CONSTRUCTION AND ESTABLISHMENT WORK</b>	
SCALE: VERT. _____	
HORIZ. _____	
DATE _____	DRAWN BY _____
	CHECKED BY _____

TWP	SECTION	COUNTY	TOTAL SHEETS	SHEET NO.
330	(102 & 102X) LS	COOK	14	5
STA.	115+00	TO STA.	140+00	
FED. ROAD DIST. NO.	1	ILLINOIS	FED. AID PROJECT	

D-91-227-05

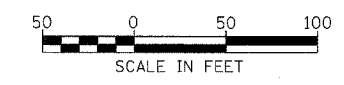
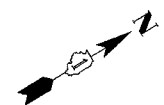
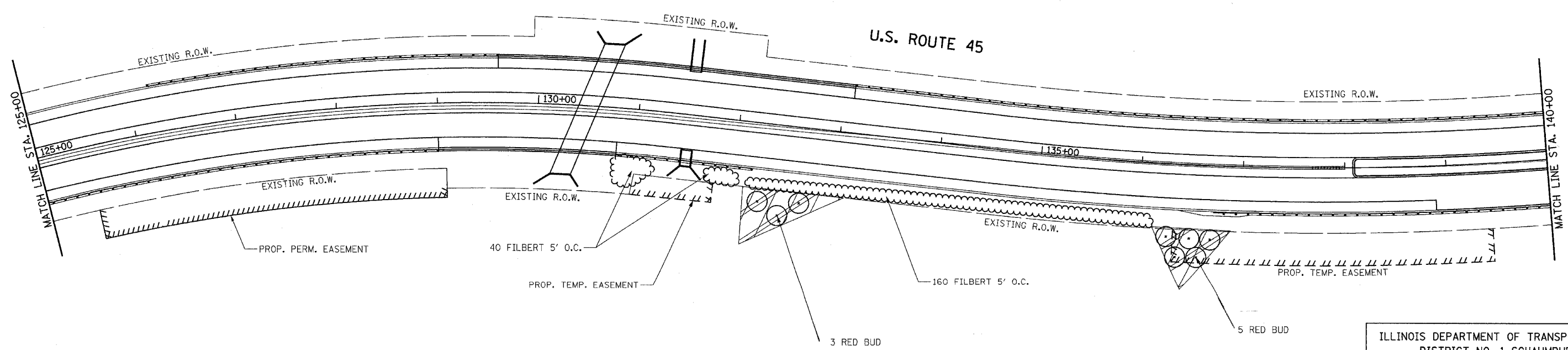
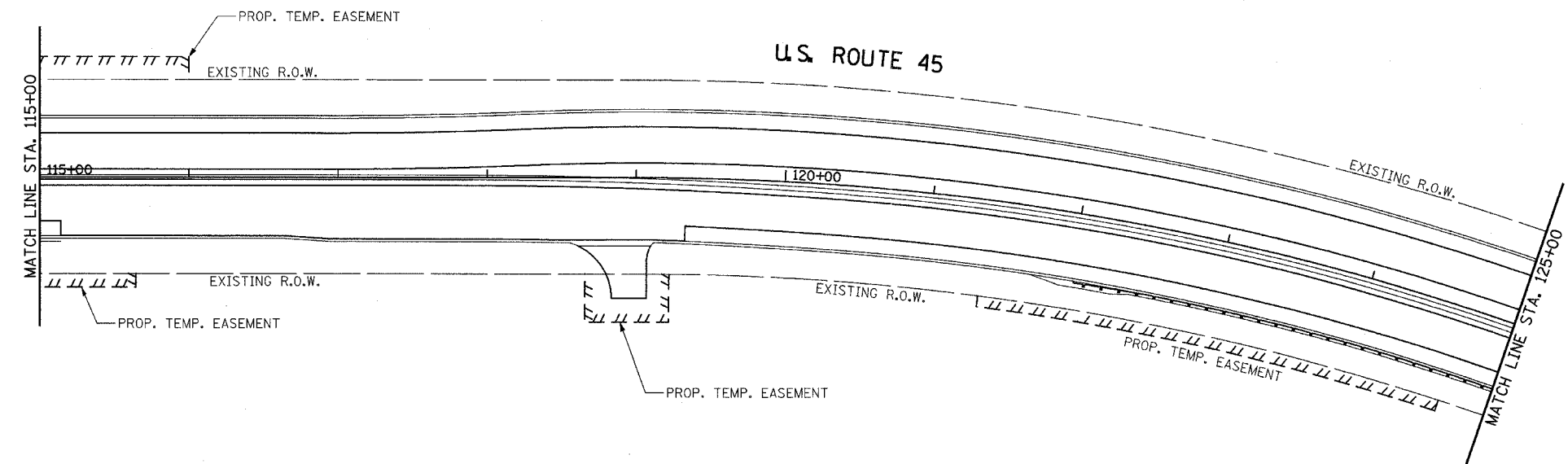

ILLINOIS DEPARTMENT OF TRANSPORTATION  
DISTRICT NO. 1 SCHAUMBURG  
**LANDSCAPING PLAN**  
**U.S. ROUTE 45**  
SCALE AS SHOWN  
DATE OCT 25, 2005  
DRAWN BY BSB  
CHECKED BY CES

F&P REF.	SECTION	COUNTY	TOTAL SHEETS	SHEET NO.
330 (102 & 102X) LS		COOK	14	6
STA. 140+00		TO STA. 165+00		
FED. ROAD DIST. NO. 1	ILLINOIS	FED. AID PROJECT		

D-91-227-05

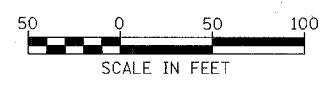
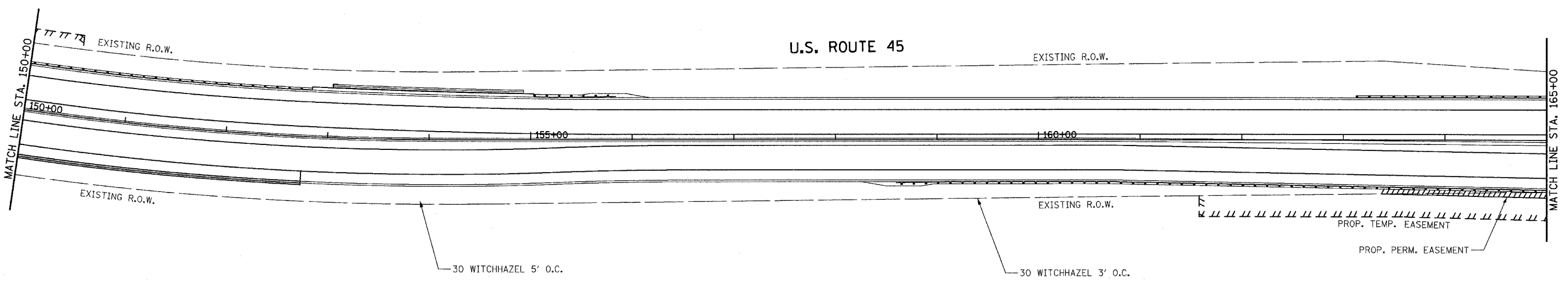
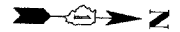
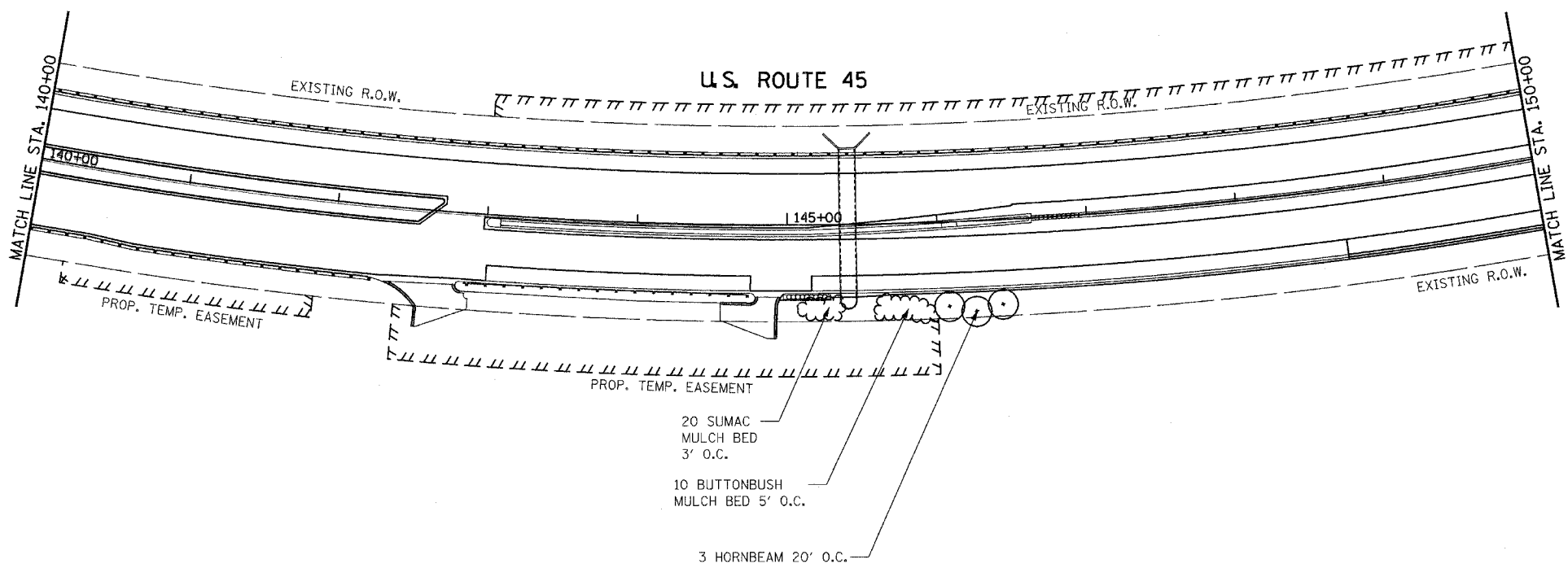

ILLINOIS DEPARTMENT OF TRANSPORTATION  
DISTRICT NO. 1 SCHAUMBURG  
**LANDSCAPING PLAN**  
**U.S. ROUTE 45**  
SCALE AS SHOWN  
DATE OCT 25, 2005  
DRAWN BY BSB  
CHECKED BY CES

F&P RTE.	SECTION	COUNTY	TOTAL SHEETS	SHEET NO.
330	(102 & 102X) LS	COOK	14	7
STA.	165+00	TO STA.	195+00	
FED. ROAD DIST. NO. 1	ILLINOIS	FED. AID PROJECT		

D-91-227-05

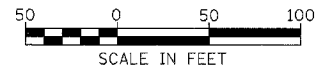
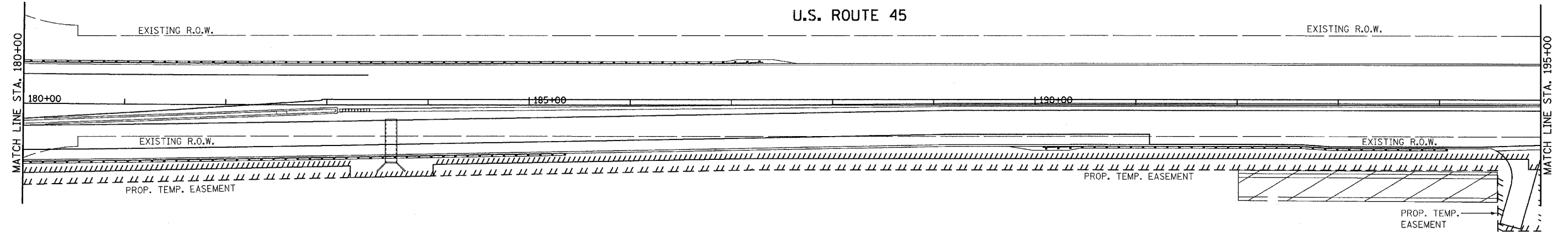
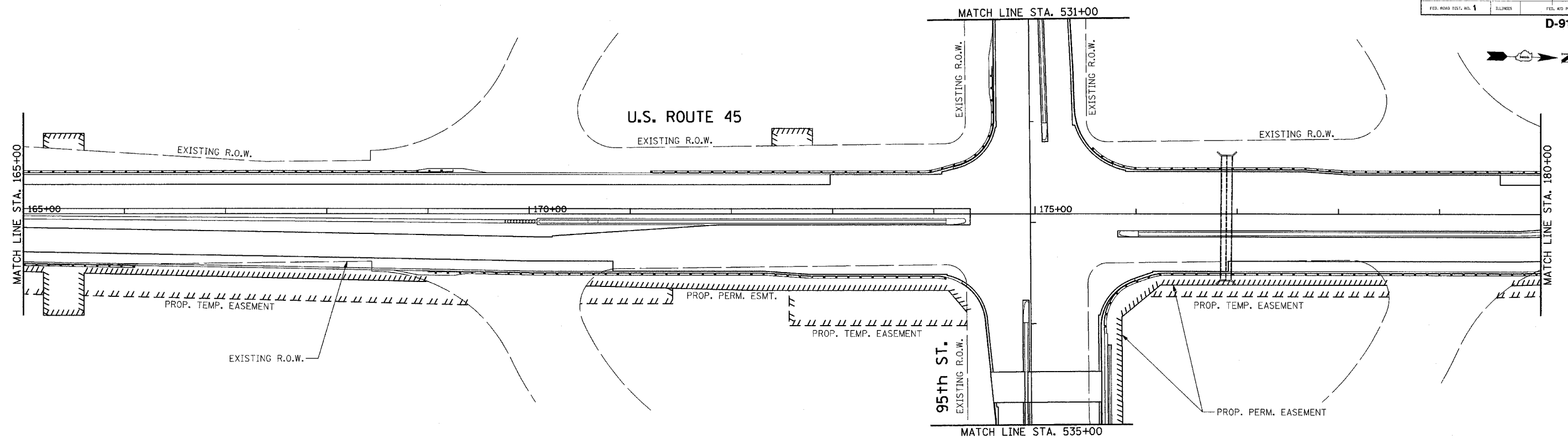

ILLINOIS DEPARTMENT OF TRANSPORTATION  
DISTRICT NO. 1 SCHAUMBURG

LANDSCAPING PLAN  
U.S. ROUTE 45

SCALE AS SHOWN  
DATE OCT 25, 2005

DRAWN BY BSB  
CHECKED BY CES

EXP. RITE.	SECTION	COUNTY	TOTAL SHEETS	SHEET NO.
330	(102 & 102X) LS	COOK	14	8
STA. 195+00	TO STA. 210+00			
FED. ROAD DIST. NO. 1	ILLINOIS	FED. AID PROJECT		

D-91-227-05

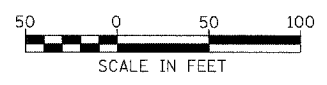
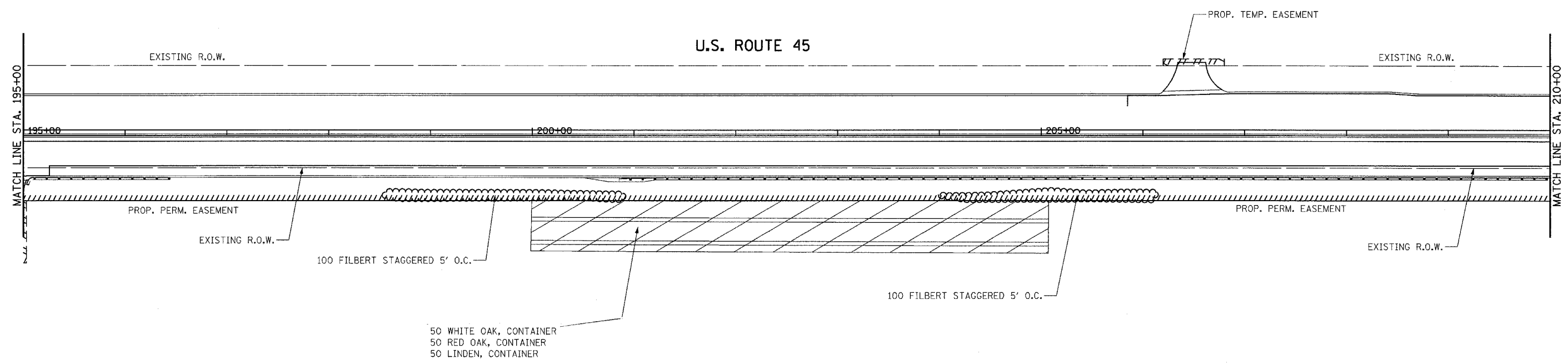

ILLINOIS DEPARTMENT OF TRANSPORTATION  
DISTRICT NO. 1 SCHAUMBURG

LANDSCAPING PLAN  
U.S. ROUTE 45

SCALE AS SHOWN  
DATE OCT 25, 2005

DRAWN BY BSB  
CHECKED BY CES



FILE NO.	SECTION	COUNTY	TOTAL SHEETS	SHEET NO.
330 (102 & 102X) LS		COOK	14	9
STA.	210+00	TO STA.	223+00	
FED. ROAD DIST. NO. 1	ILLINOIS	FED. AID PROJECT		

D-91-227-05

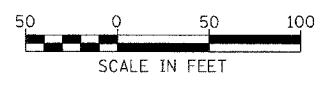
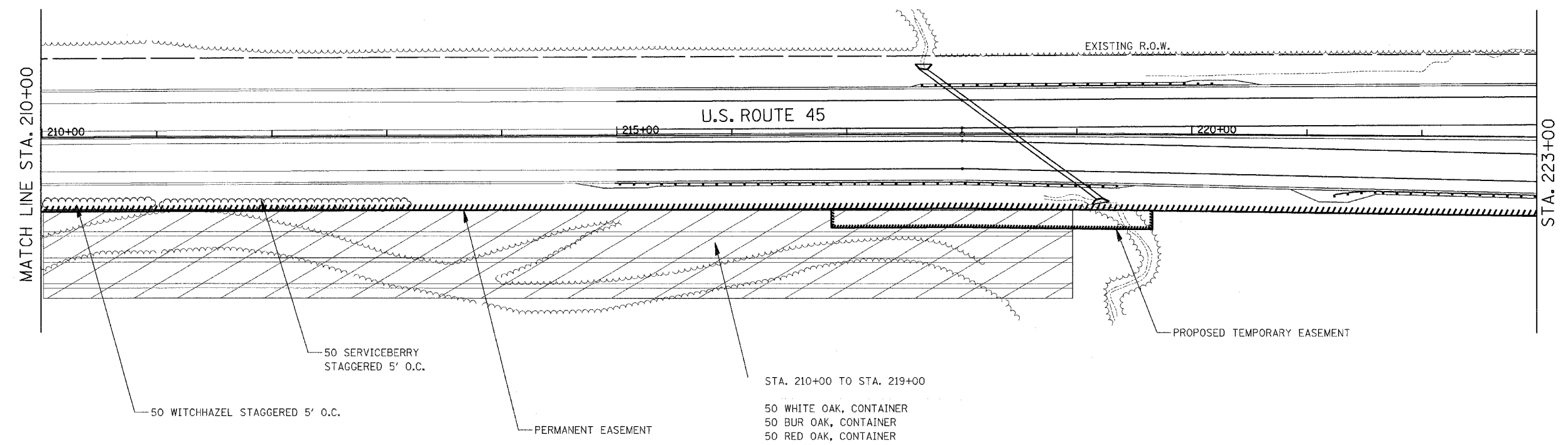
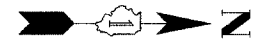

ILLINOIS DEPARTMENT OF TRANSPORTATION  
DISTRICT NO. 1 SCHAUMBURG  
**LANDSCAPING PLAN**  
**U.S. ROUTE 45**  
SCALE AS SHOWN  
DATE OCT 25, 2005  
DRAWN BY BSB  
CHECKED BY CES

F&P NO.	SECTION	COUNTY	TOTAL SHEETS	SHEET NO.
330	(102 & 102X) LS	COOK	14	10
STA. 0+00	TO STA. 16+00			
FED. ROAD DIST. NO. 1	ILLINOIS	F&P AID PROJECT		

D-91-227-05

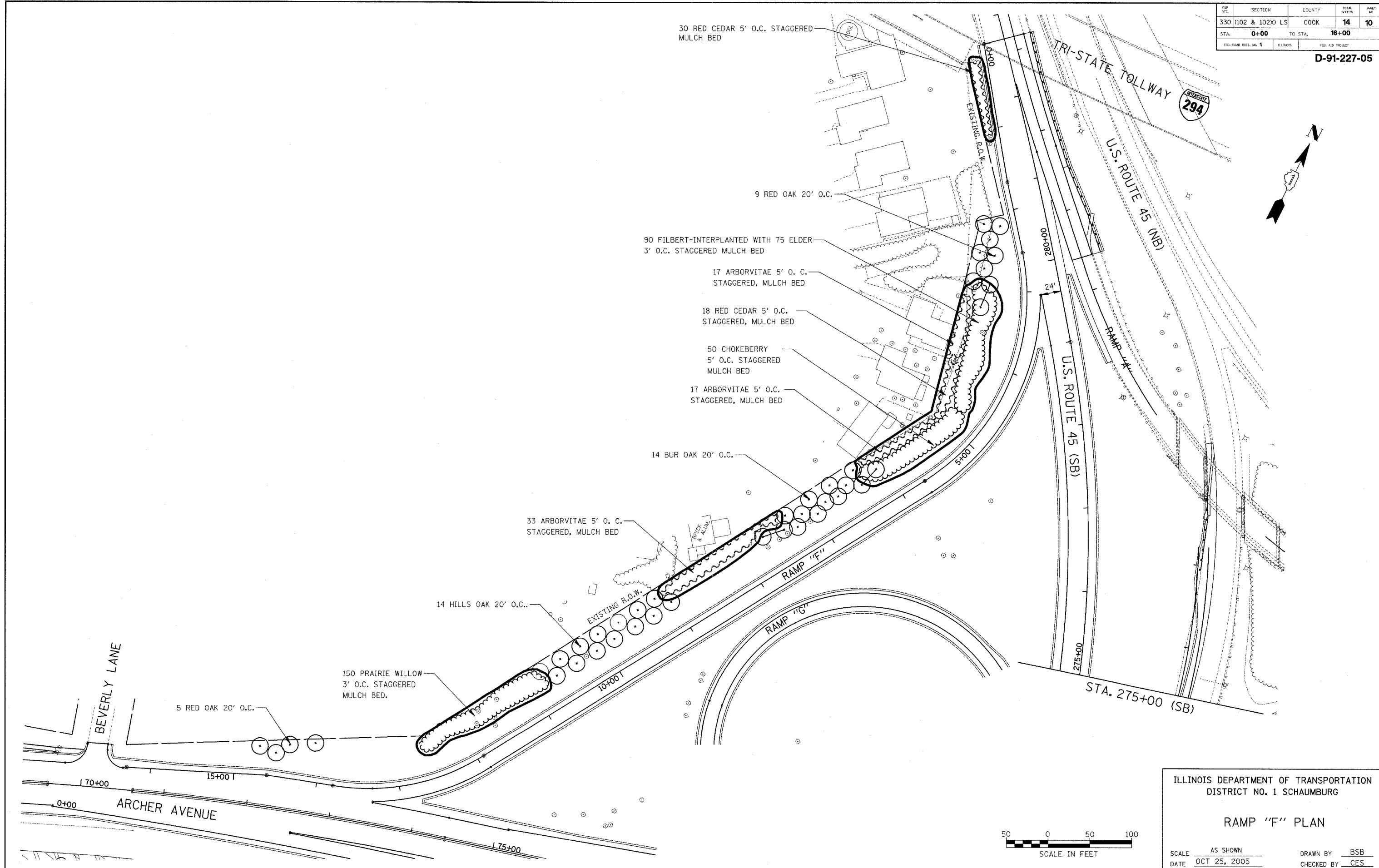
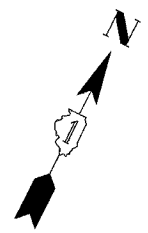

ILLINOIS DEPARTMENT OF TRANSPORTATION  
DISTRICT NO. 1 SCHAUMBURG

**RAMP "F" PLAN**

SCALE AS SHOWN  
DATE OCT 25, 2005

DRAWN BY BSB  
CHECKED BY CES



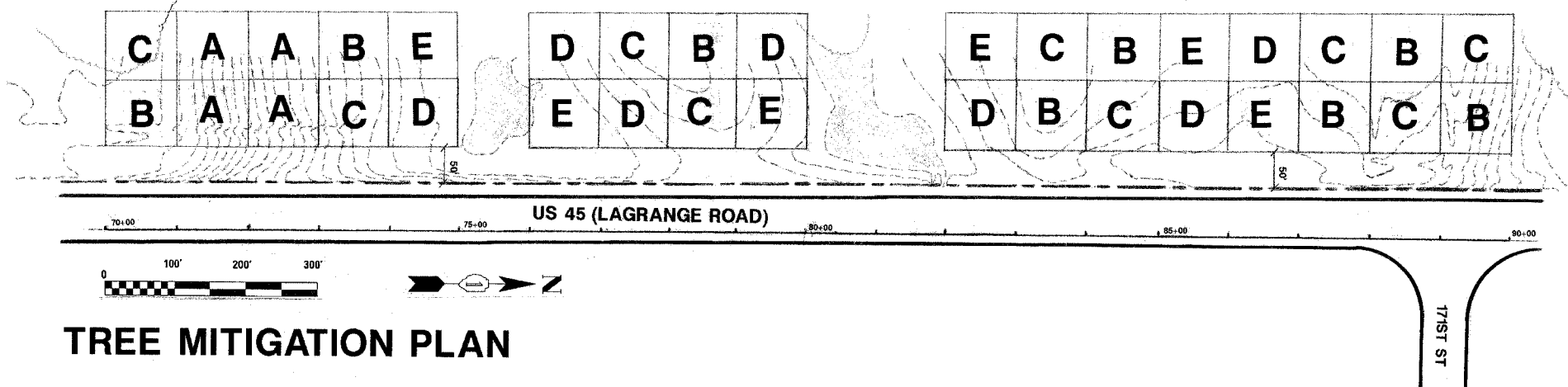

## TREE MITIGATION PLAN

NOTE: SEE SHEETS 12-14 FOR TREE GROUPING KEYS

SCHEDULE OF LANDSCAPE ITEMS (TREE MITIGATION SITE ONLY)						
ITEM	HABITAT	GROUP	QUANTITY OF GROUPS	QUANTITY PER GROUP	UNIT	TOTAL
<i>Celtis occidentalis</i> (Hackberry), CONTAINER GROWN, 3 GALLON	LOWLAND MESIC	D	7	10	EACH	70
<i>Juglans nigra</i> (Black Walnut), CONTAINER GROWN, 3 GALLON	LOWLAND MESIC	D	7	10	EACH	70
<i>Ostrya virginiana</i> (American Hophornbeam), CONTAINER GROWN, 3 GAL.	UPLAND MESIC	B	8	10	EACH	80
<i>Quercus alba</i> (White Oak), CONTAINER GROWN, 3 GALLON	UPLAND MESIC	B	8	10	EACH	80
	UPLAND MESIC	C	9	10		90
<i>Quercus imbricaria</i> (Shingle Oak), CONTAINER GROWN, 3 GALLON	LOWLAND WET	E	6	10	EACH	60
<i>Quercus ellipsoidalis</i> (Hill's Oak), CONTAINER GROWN, 3 GALLON	UPLAND DRY	A	4	10	EACH	40
<i>Quercus macrocarpa</i> (Bur Oak), CONTAINER GROWN, 3 GALLON	UPLAND DRY	A	4	10	EACH	40
	UPLAND MESIC	B	8	10		80
	LOWLAND MESIC	D	7	10		70
	LOWLAND WET	E	6	20		120
<i>Quercus rubra</i> (Red Oak), CONTAINER GROWN, 3 GALLON	UPLAND MESIC	C	9	10	EACH	90
<i>Tilia americana</i> (American Linden), CONTAINER GROWN, 3 GALLON	UPLAND MESIC	C	9	10	EACH	90
<b>TOTAL</b>					<b>EACH</b>	<b>980</b>

REVISIONS	
NAME	DATE

**ILLINOIS DEPARTMENT OF TRANSPORTATION**

**TREE MITIGATION PLAN**

**SCHEDULE OF QUANTITIES  
(TREE MITIGATION SITE)**

SCALE: VERT. \_\_\_\_\_ DRAWN BY \_\_\_\_\_  
HORIZ. \_\_\_\_\_ CHECKED BY \_\_\_\_\_  
DATE \_\_\_\_\_

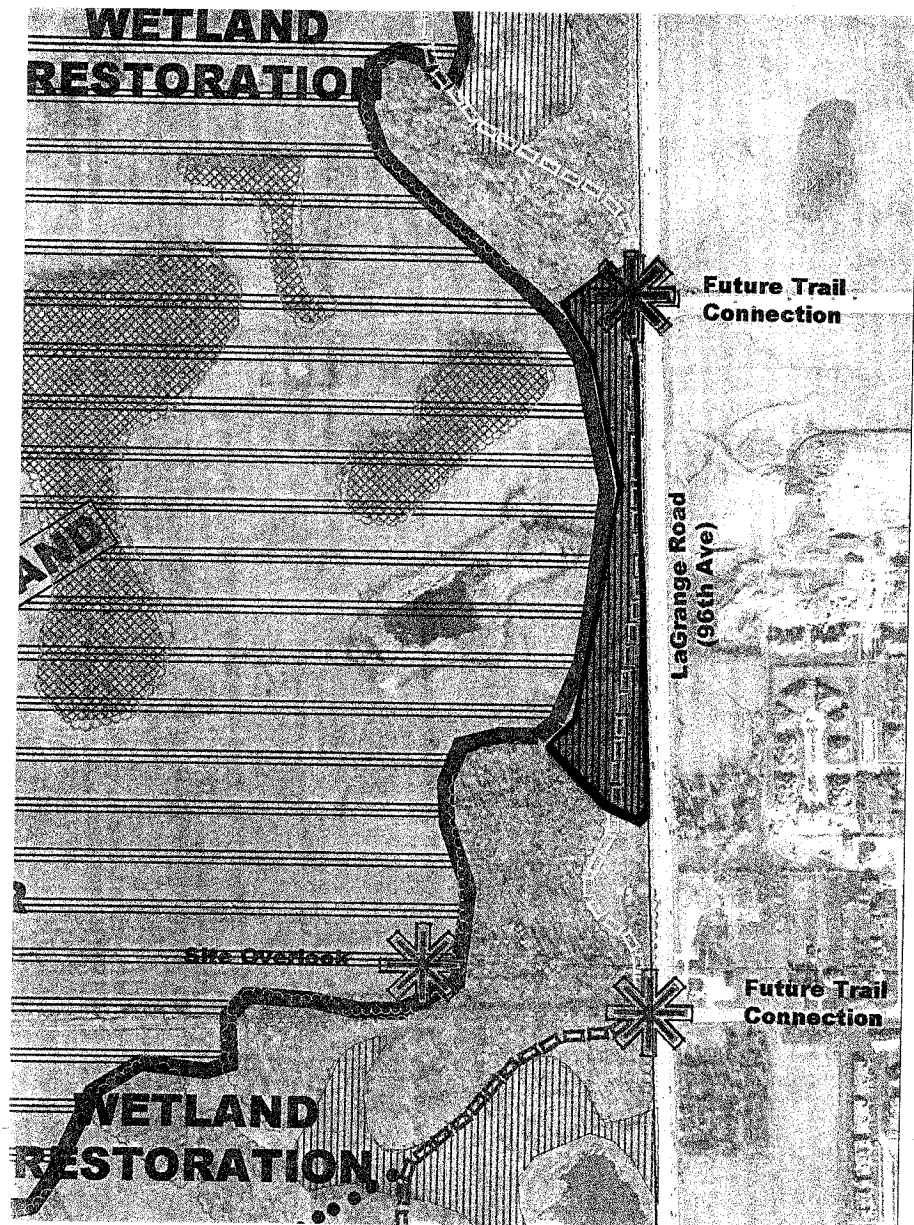

**FOREST PRESERVE DISTRICT OF COOK COUNTY**  
**ORLAND TRACT DEVELOPMENT PLAN**

 GENERAL AREA OF REFORESTATION

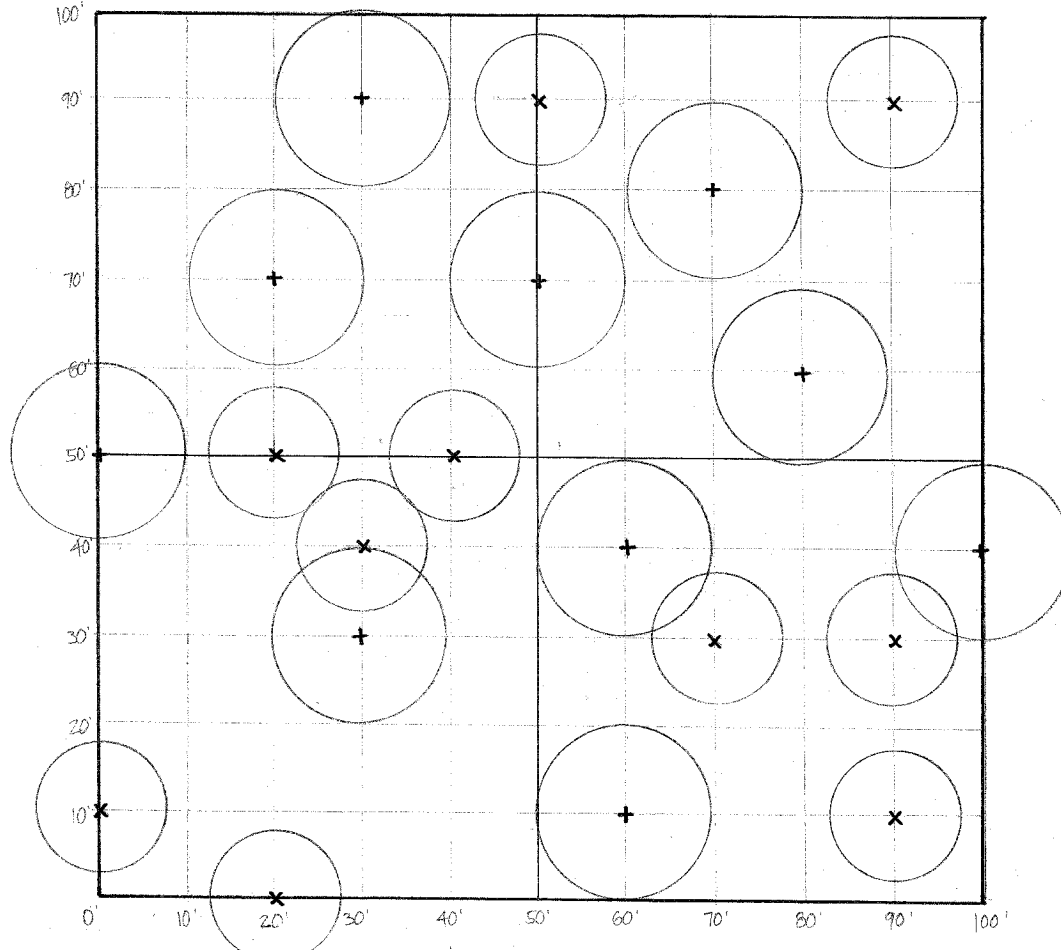

**A – UPLAND DRY**  
**BUR/HILLS OAK**

- + *Quercus macrocarpa* (Bur Oak) 10 Each
- x *Quercus ellipsoidalis* (Hills Oak) 10 Each
- Total 20 Each

REVISIONS	
NAME	DATE

ILLINOIS DEPARTMENT OF TRANSPORTATION  
**FPDCC DEVELOPMENT PLAN**  
**TREE GROUPING KEY A**

SCALE: VERT. \_\_\_\_\_  
 HORIZ. \_\_\_\_\_  
 DATE \_\_\_\_\_

DRAWN BY \_\_\_\_\_  
 CHECKED BY \_\_\_\_\_

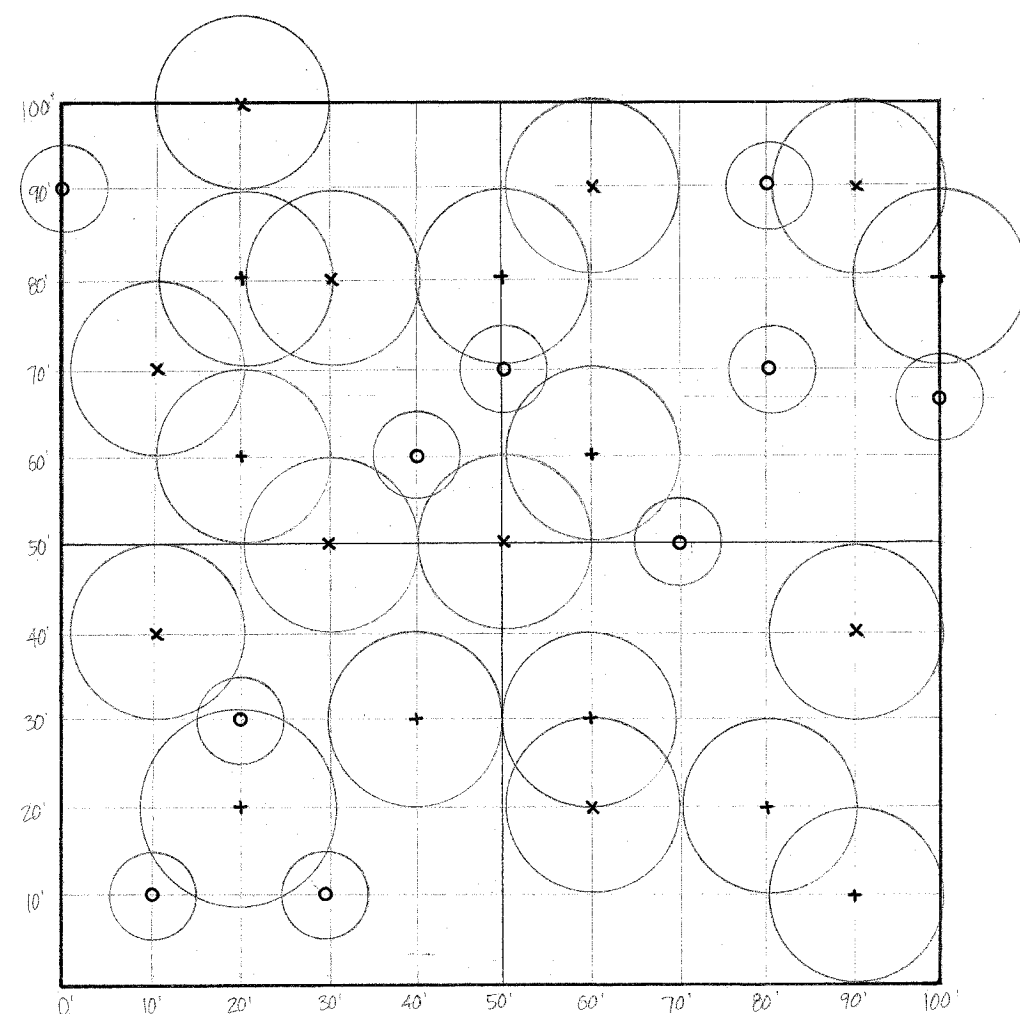

**B – UPLAND MESIC  
WHITE/BUR OAK**

- x *Quercus alba* (White Oak) 10 Each
  - + *Quercus macrocarpa* (Bur Oak) 10 Each
  - o *Ostrya virginiana* (Hophornbeam) 10 Each
- Total 30 Each

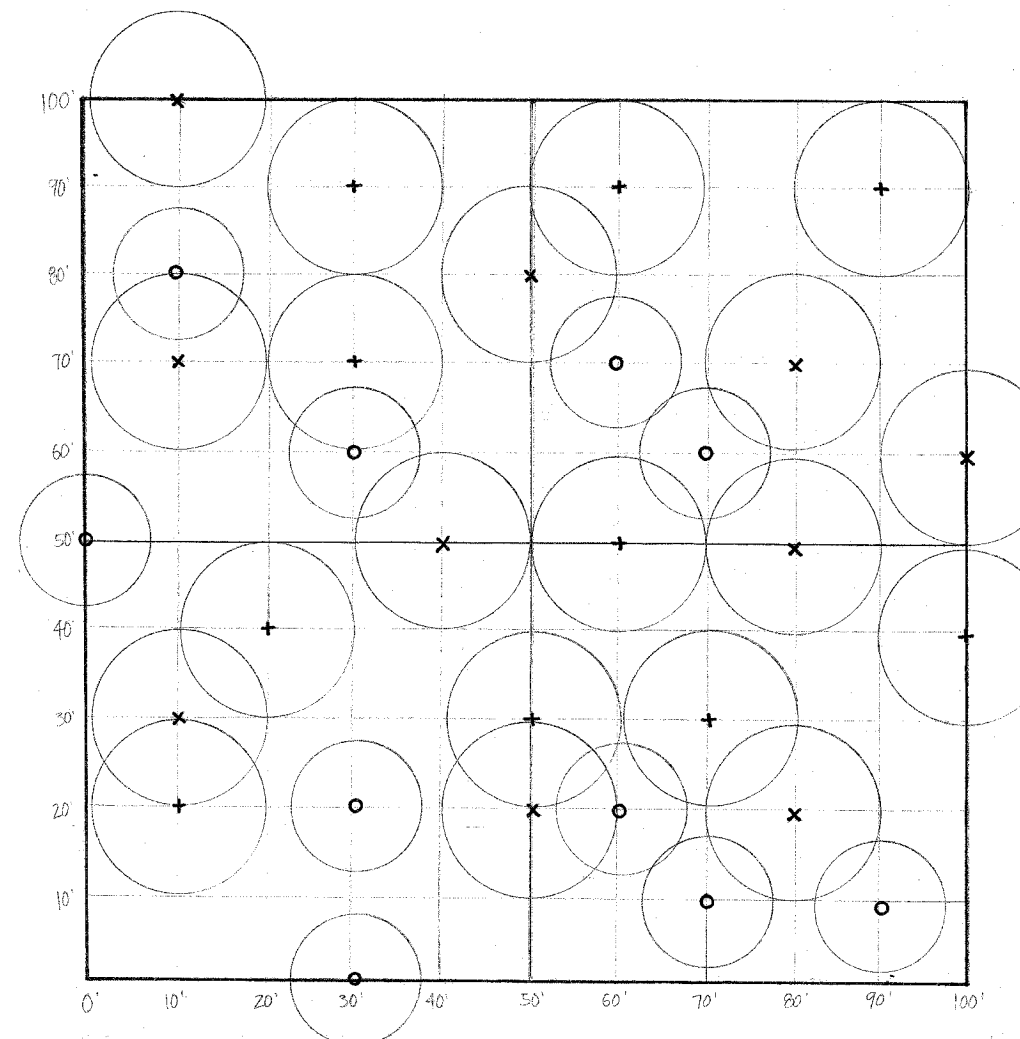

**C – UPLAND MESIC  
RED/WHITE OAK**

- + *Quercus rubra* (Red Oak) 10 Each
  - x *Quercus alba* (White Oak) 10 Each
  - o *Tilia americana* (American Linden) 10 Each
- Total 30 Each

REVISIONS	
NAME	DATE

ILLINOIS DEPARTMENT OF TRANSPORTATION

**TREE GROUPING  
KEYS B & C**

SCALE: VERT. \_\_\_\_\_  
HORIZ. \_\_\_\_\_  
DATE \_\_\_\_\_ DRAWN BY \_\_\_\_\_  
CHECKED BY \_\_\_\_\_

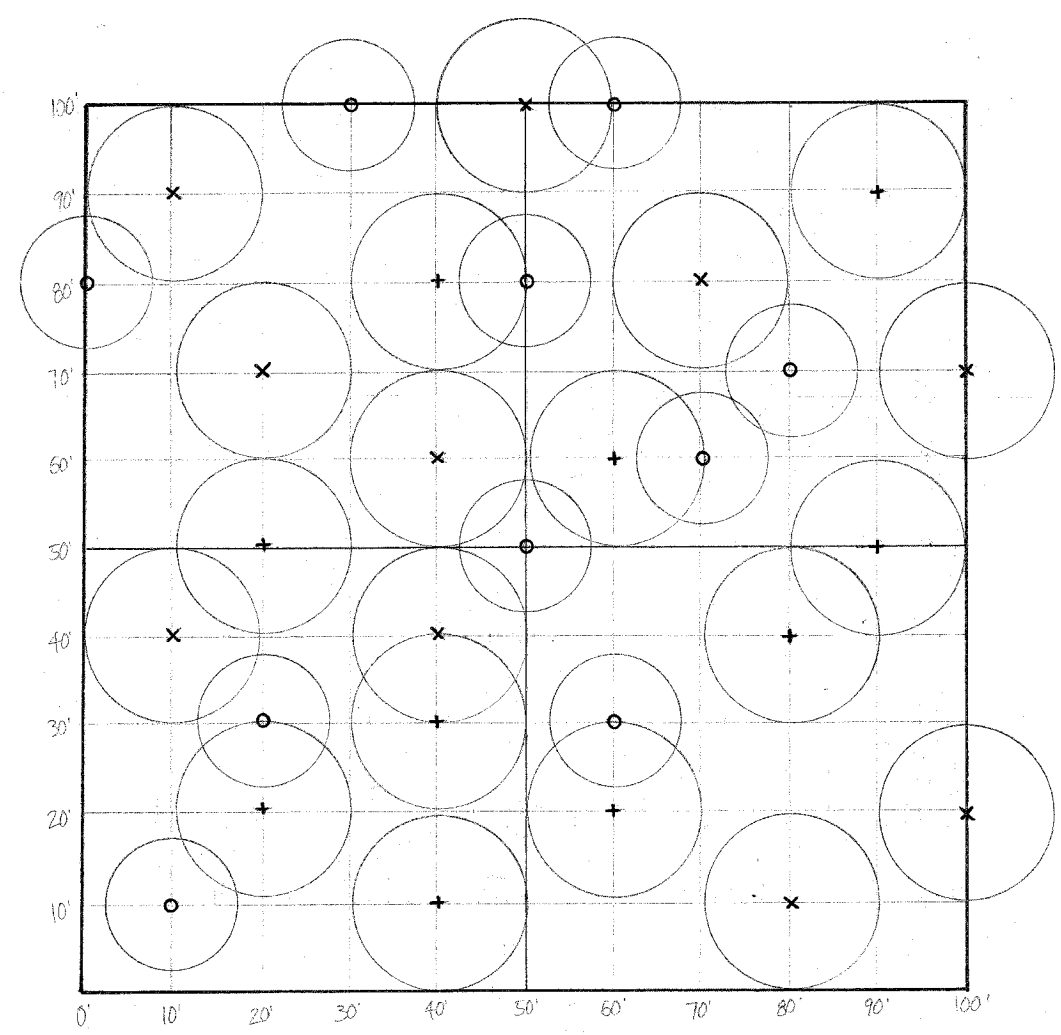

**D - LOWLAND MESIC  
WALNUT-HACKBERRY-BUR OAK**

- x *Juglans nigra* (Black Walnut) 10 Each
  - o *Celtis occidentalis* (Common Hackberry) 10 Each
  - + *Quercus macrocarpa* (Bur Oak) 10 Each
- Total 30 Each

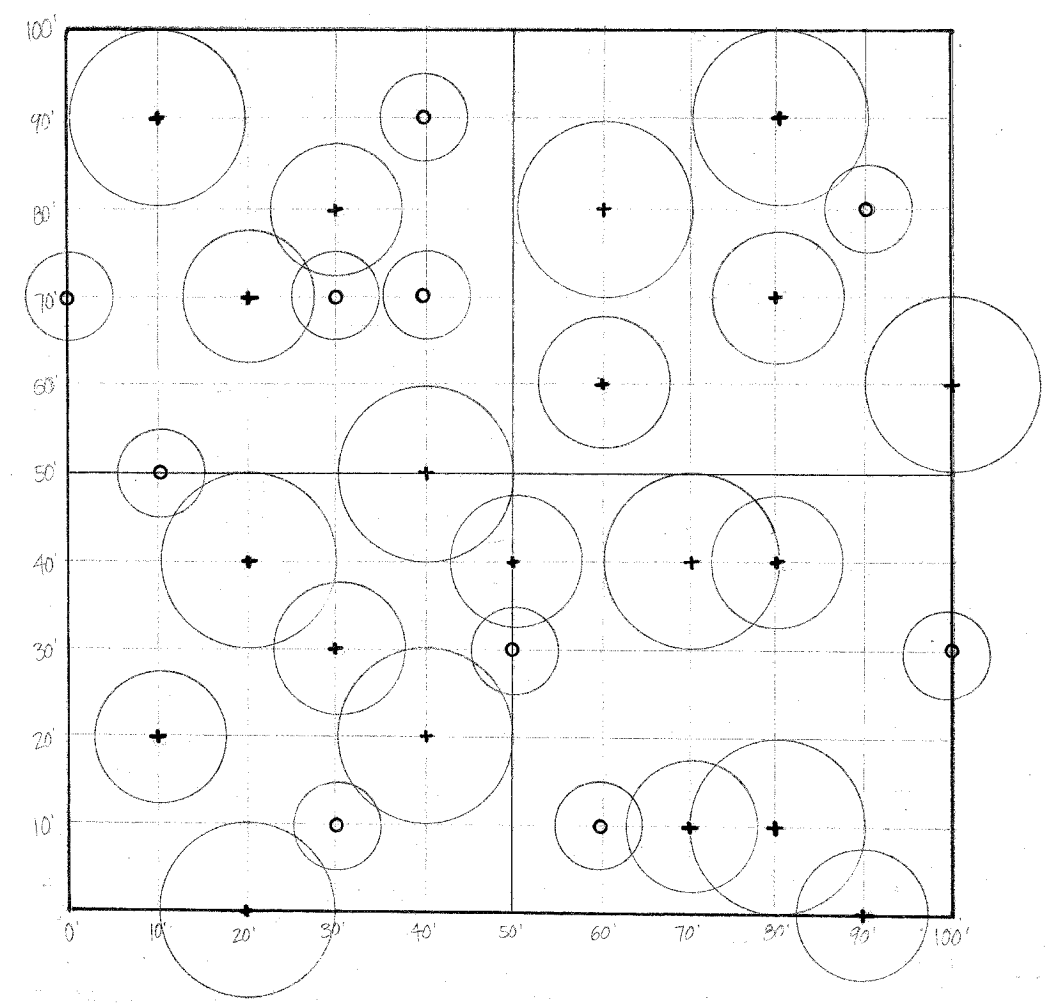

**E - LOWLAND WET  
BUR/SHINGLE OAK**

- + *Quercus macrocarpa* (Bur Oak) 20 Each
  - o *Quercus imbricaria* (Shingle Oak) 10 Each
- Total 30 Each

REVISIONS	
NAME	DATE

ILLINOIS DEPARTMENT OF TRANSPORTATION

**TREE GROUPING  
KEYS D & E**

SCALE: VERT. \_\_\_\_\_  
 HORIZ. \_\_\_\_\_

DATE \_\_\_\_\_ DRAWN BY \_\_\_\_\_  
 CHECKED BY \_\_\_\_\_