

F.A.P. RTE.	SECTION	COUNTY	TOTAL SHEETS	SHEET NO.
309	16R-2	WHITESIDE	547	61
STA.	TO STA.			
FED. ROAD DIST. NO. 2	ILLINOIS	FED. AID PROJECT		

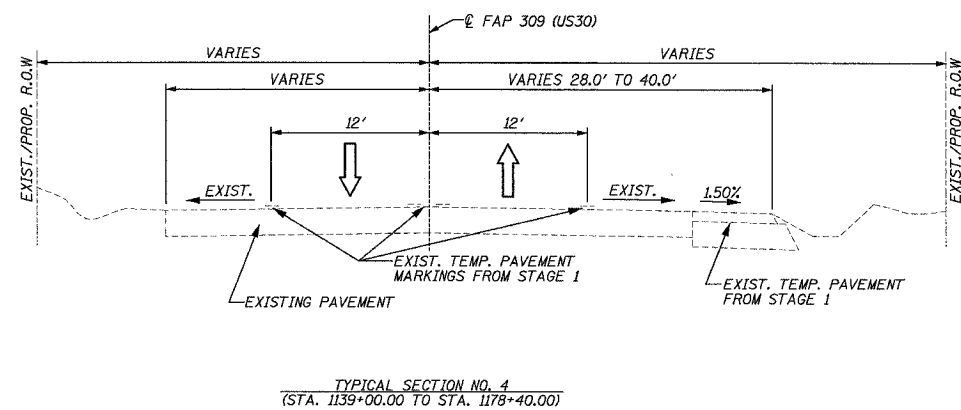
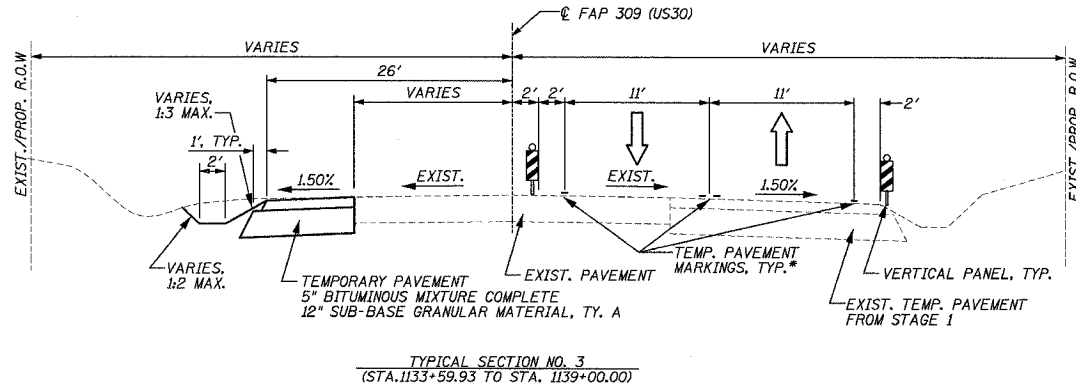
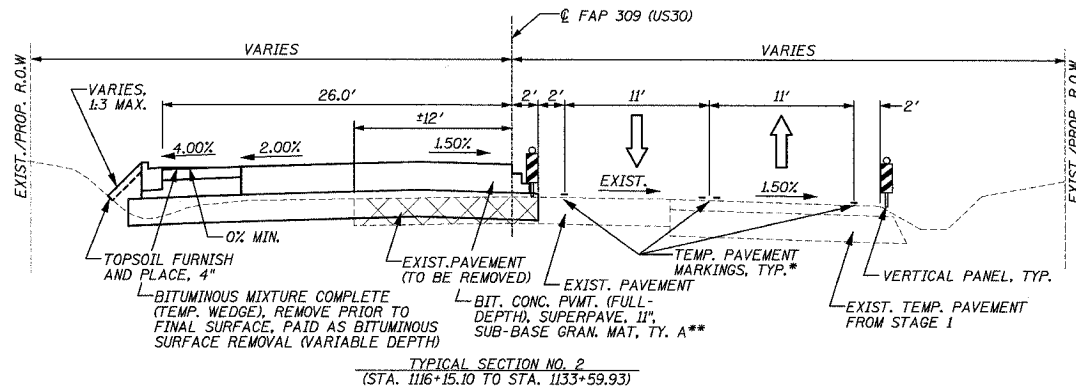
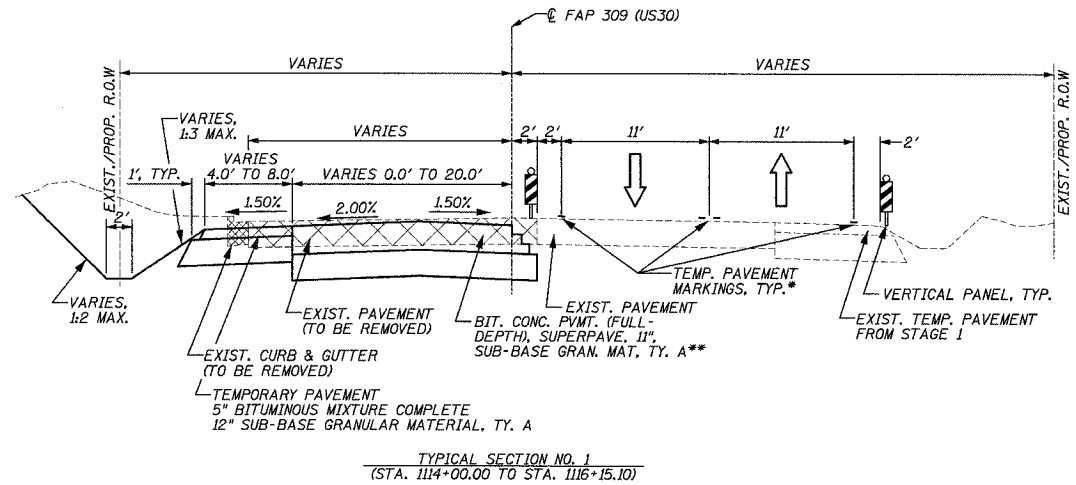

STAGE 2

GENERAL NOTES:

ALL TEMPORARY PAVEMENT MARKINGS FOR STAGES 2, 3, 4 AND 5, INCLUDING EDGE LINES, CENTER LINES, LANE LINES, TAPERS, MEDIAN DIAGONALS, STOP BARS, LETTERS & SYMBOLS, AND ANY OTHER TEMPORARY MARKINGS AS REQUIRED BY THE ENGINEER, AND THEIR REMOVAL SHALL BE INCLUDED IN THE COST OF TRAFFIC CONTROL AND PROTECTION, STANDARD 70133L. THIS WORK SHALL BE PERFORMED ACCORDING TO SECTIONS 701 AND 703 OF THE STANDARD SPECIFICATIONS AND AS DIRECTED BY THE ENGINEER.

ACCESS TO ENTRANCES AND LOCAL ROADS WITHIN THE PROJECT AREA WILL BE MAINTAINED AT ALL TIMES, UNLESS OTHERWISE SPECIFIED IN TRAFFIC NOTES.

TEMPORARY PAVEMENT TO CONSIST OF 5" BITUMINOUS MIXTURE COMPLETE AND 12" SUB-BASE GRANULAR MATERIAL, TYPE A.

TEMPORARY BITUMINOUS BUILD UPS TO BE BITUMINOUS CONCRETE BINDER COURSE, SUPERPAVE, IL 19.0, N70. TEMPORARY BITUMINOUS BUILD UPS SHALL BE CONSTRUCTED WITH SLOPES OF 1:20 MAXIMUM.

DRAINAGE TO EXISTING AND PROPOSED DRAINAGE STRUCTURES TO BE MAINTAINED AT ALL TIMES.

TRAFFIC NOTES:

SHIFT TRAFFIC AS SHOWN ON THE PLANS UTILIZING TEMPORARY PAVEMENT MARKINGS AND TRAFFIC CONTROL DEVICES SHOWN ON THE STAGING PLANS AND APPLICABLE TRAFFIC CONTROL STANDARDS.

MAINTAIN ONE (1) LANE OF TRAFFIC IN EACH DIRECTION WHILE MAINTAINING ACCESS TO ALL ENTRANCES AND EXITS AS SHOWN ON THE STAGING PLANS.

CONSTRUCT SCENIC STREET AND SYCAMORE STREET, CLOSURE WITH LOCAL ACCESS ONLY. SCENIC STREET AND SYCAMORE STREET SHALL NOT BE CLOSED AT THE SAME TIME.

UTILIZE TRAFFIC CONTROL STANDARDS AS SHOWN ON THE STAGING PLANS.

CONSTRUCTION/SEQUENCE OF STAGING NOTES:

PLACE TEMPORARY PAVEMENT MARKINGS AS SHOWN ON THE STAGING PLANS AND REMOVE ANY CONFLICTING EXISTING PAVEMENT MARKINGS.

REMOVE EXISTING CURB AND GUTTER, SHOULDERS AND OTHER ITEMS APPLICABLE AS SHOWN IN THE PLAN AND PROFILE PLANS.

CONSTRUCT THE PROPOSED RETAINING WALLS.

CONSTRUCT THE PERMANENT PAVEMENT, SHOULDERS, AND CURB AND GUTTER AS SHOWN ON THE STAGING PLANS.

CONSTRUCT GOMEZ PARKING AREA, ± LT. STA. 1128+00, PRIOR TO CLOSURE OF SCENIC STREET.

PLACE TEMPORARY WEDGE (BITUMINOUS MIXTURE COMPLETE) ALONG THE PERMANENT CURB AND GUTTER ALONG THE NORTH SIDE OF US ROUTE 30.

FINAL SURFACE COURSE ON THE PAVEMENT AND SHOULDERS TO BE INSTALLED AFTER STAGE 6.

CONSTRUCT TEMPORARY PAVEMENT NECESSARY FOR SHIFTING OF TRAFFIC AS SHOWN ON THE STAGING PLANS.

CONSTRUCT SCENIC AND SYCAMORE STREETS AND THE PROPOSED RETAINING WALLS.

CONSTRUCT DITCHING AND PERMANENT CULVERT AS SHOWN ON THE STAGE 2 CROSS SECTIONS AND STAGING PLANS.

- * SEE MAINTENANCE OF TRAFFIC PLANS FOR COLOR OF TEMPORARY PAVEMENT MARKINGS AND ADDITIONAL LOCATION INFORMATION.
- ** FINAL SURFACE CONSTRUCTED AT END OF STAGE 6.

REVISIONS	
NAME	DATE

ILLINOIS DEPARTMENT OF TRANSPORTATION
 MAINTENANCE OF TRAFFIC,
 TYPICAL SECTIONS, STAGE 2
 FAP ROUTE 309 (US 30), SECTION 16R-2
 EAST CONTRACT
 FROM 0.2 MILE EAST OF JACKSON
 ST. TO FRENCH CREEK
 WHITESIDE COUNTY

SCALE: N.T.S. DRAWN BY CAM
 DATE 08/19/04 CHECKED BY RDY