

F.A.P. SITE	SECTION	COUNTY	TOTAL SHEETS	SHEET NO.
309	16R-2	WHITESIDE	547	242
STA. 1126+50.00		TO STA. 1126+75.00		
FED. ROAD DIST. NO. 2 ILLINOIS FED. AID PROJECT				

DATE	
BY	
FINAL SURVEY	
NO. OF SHEETS	
NOTE BOOK	
NO.	
AREAS CHECKED	

DATE	
BY	
ORIGINAL SURVEY	
NO. OF SHEETS	
NOTE BOOK	
NO.	
AREAS CHECKED	

PLOT DATE = #DATE#
 FILE NAME = #FILE#
 PLOT SCALE = #SCALE#
 USER NAME = #USER#

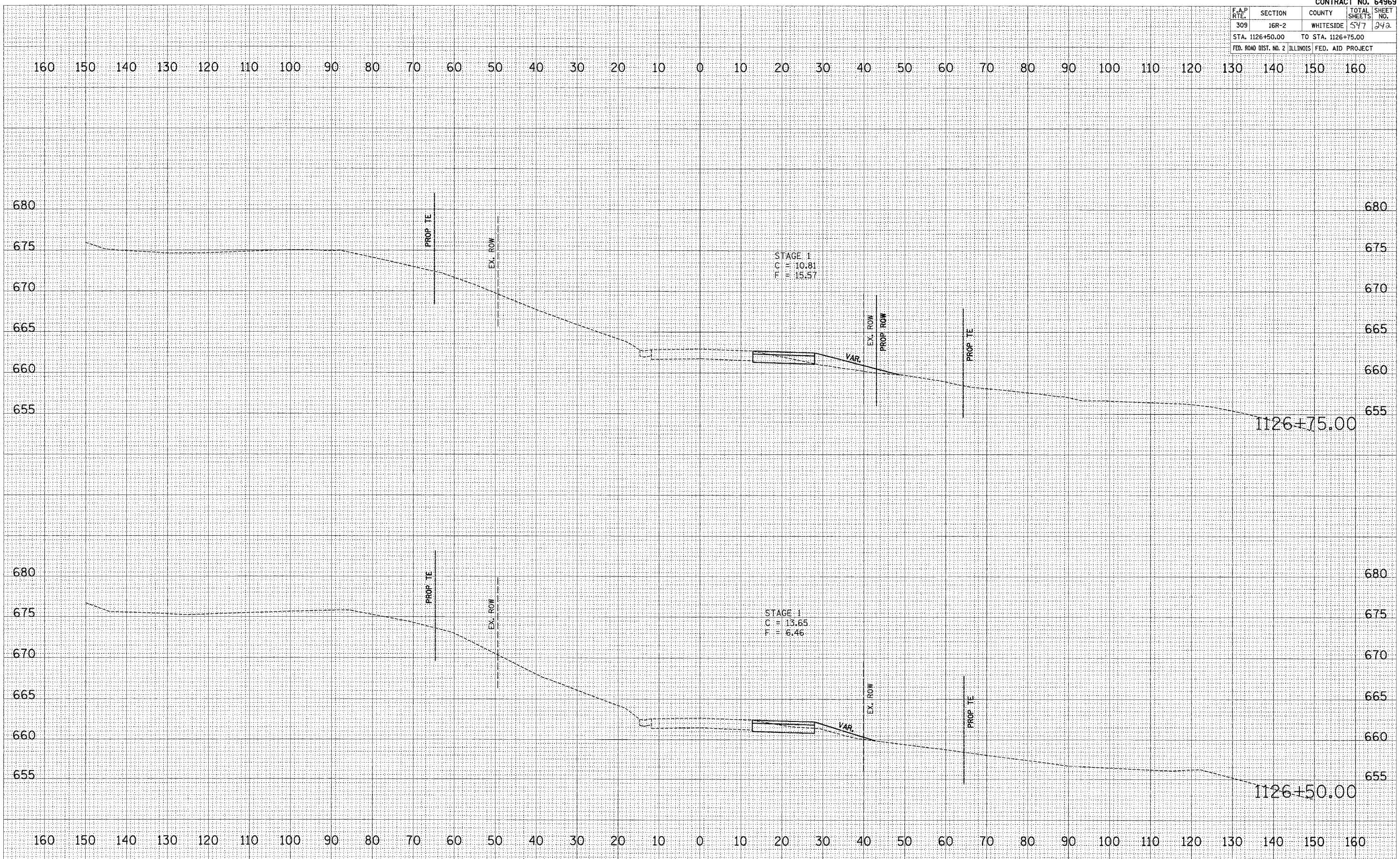

12/17/2008 8:25:33 AM