

F.A.P. RTE.	SECTION	COUNTY	TOTAL SHEETS	SHEET NO.
309	16R-2	WHITESIDE	547	418
STA. 1119+70.95 TO STA. 1119+77.30			FED. ROAD DIST. NO. 2 ILLINOIS FED. AID PROJECT	

IT SHALL BE THE CONTRACTOR'S RESPONSIBILITY TO ASCERTAIN THE LOCATIONS OF EXISTING WATER MAINS, GAS MAINS, SEWERS, ELECTRIC POWER LINES, TELEPHONE LINES AND OTHER UTILITIES FROM THE UTILITY COMPANIES AND BY FIELD INSPECTION.

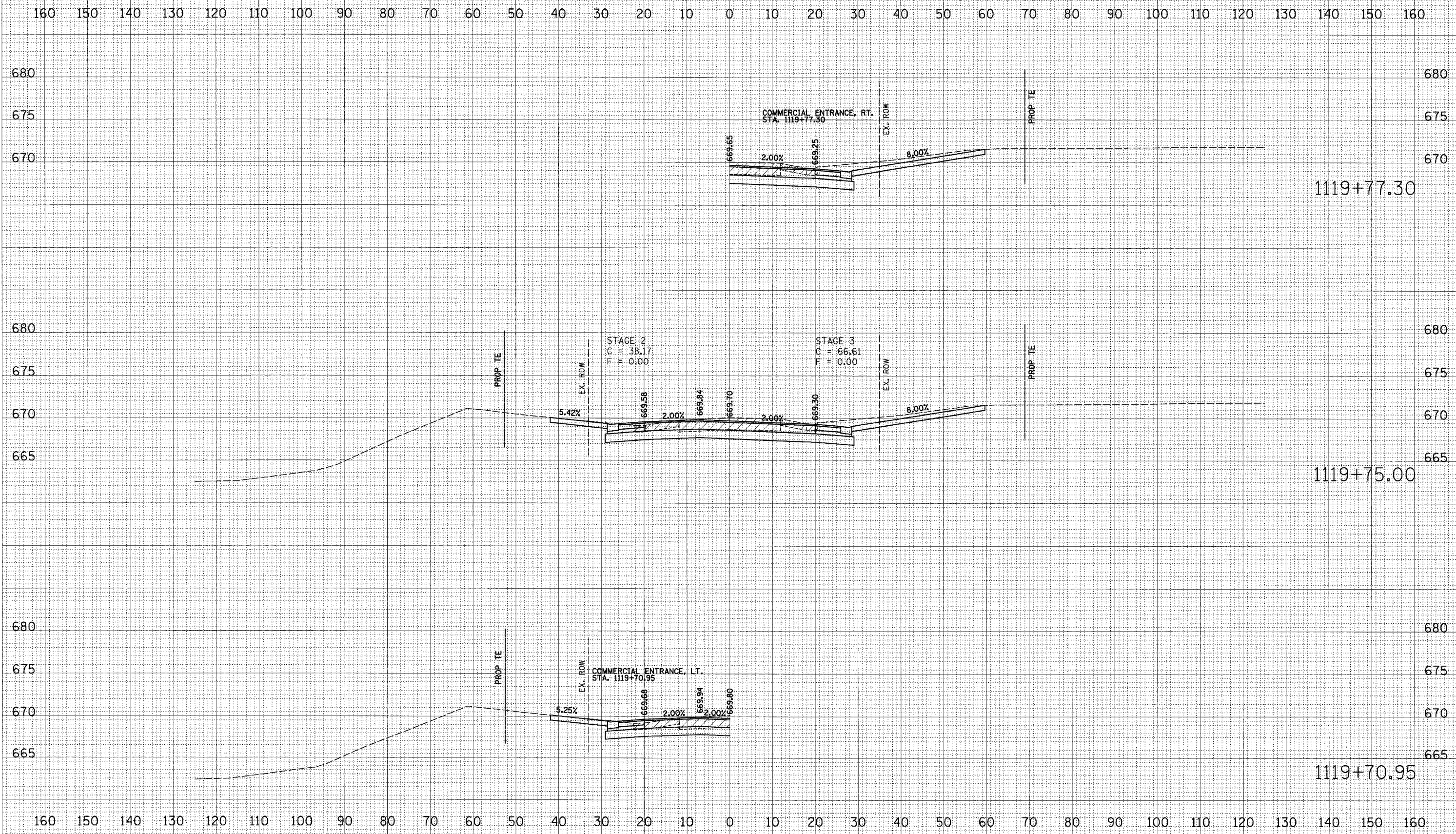

BY: _____ DATE: _____

FINAL SURVEY _____

PLOTTED _____

NOTE BOOK _____

AREAS CHECKED _____

NO. _____

BY: _____ DATE: _____

ORIGINAL SURVEY _____

PLOTTED _____

NOTE BOOK _____

AREAS CHECKED _____

NO. _____

PLOT DATE = #DATE#

FILE NAME = #FILE#

PLOT SCALE = #SCALE#

USER NAME = #USER#