

IT SHALL BE THE CONTRACTOR'S RESPONSIBILITY TO ASCERTAIN THE LOCATIONS OF EXISTING WATER MAINS, GAS MAINS, SEWERS, ELECTRIC POWER LINES, TELEPHONE LINES AND OTHER UTILITIES FROM THE UTILITY COMPANIES AND BY FIELD INSPECTION.

CONTRACT NO. 64969			
F.A.P. RTE.	SECTION	COUNTY	TOTAL SHEETS NO.
309	16R-2	WHITESIDE	547 / 469
STA. 1143+50.00		TO STA. 1143+75.00	
FED. ROAD DIST. NO. 2 ILLINOIS FED. AID PROJECT			

FINAL SURVEY	DATE
SURVEYED	
PLOTTED	
NOTE BOOK	
AREAS	
CHECKED	

ORIGINAL SURVEY	DATE
SURVEYED	
PLOTTED	
NOTE BOOK	
AREAS	
CHECKED	

PLOT DATE = #DATE#
 FILE NAME = #FILE#
 PLOT SCALE = #SCALE#
 USER NAME = #USER#

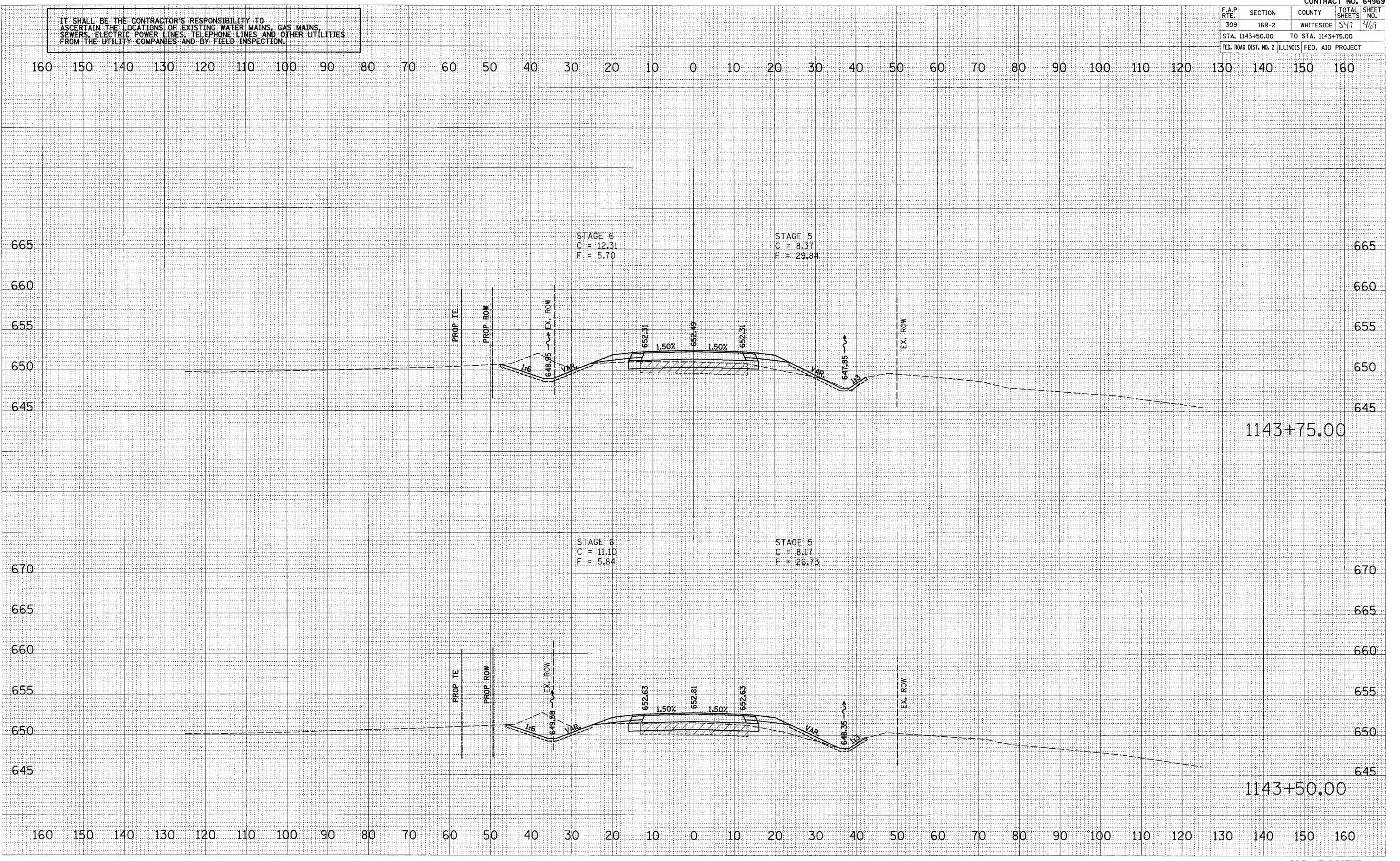

US ROUTE 30