

F.A.P. RTE.	SECTION	COUNTY	TOTAL SHEETS	SHEET NO.
309	16R-2	WHITESIDE	547	476
STA. 1147+00.00		TO STA. 1147+25.00		
FED. ROAD DIST. NO. 2		ILLINOIS FED. AID PROJECT		

IT SHALL BE THE CONTRACTOR'S RESPONSIBILITY TO ASCERTAIN THE LOCATIONS OF EXISTING WATER MAINS, GAS MAINS, SEWERS, ELECTRIC POWER LINES, TELEPHONE LINES AND OTHER UTILITIES FROM THE UTILITY COMPANIES AND BY FIELD INSPECTION.

FINAL SURVEY	DATE
NO. _____	BY _____
REVISIONS	
PLotted	
Template	
Areas	
Checked	

ORIGINAL SURVEY	DATE
NO. _____	BY _____
REVISIONS	
Plotted	
Template	
Areas	
Checked	

PLOT DATE = 8/24/85
 FILE NAME = 0476L
 PLOT SCALE = 1"=40'
 USER NAME = JWS/ERN

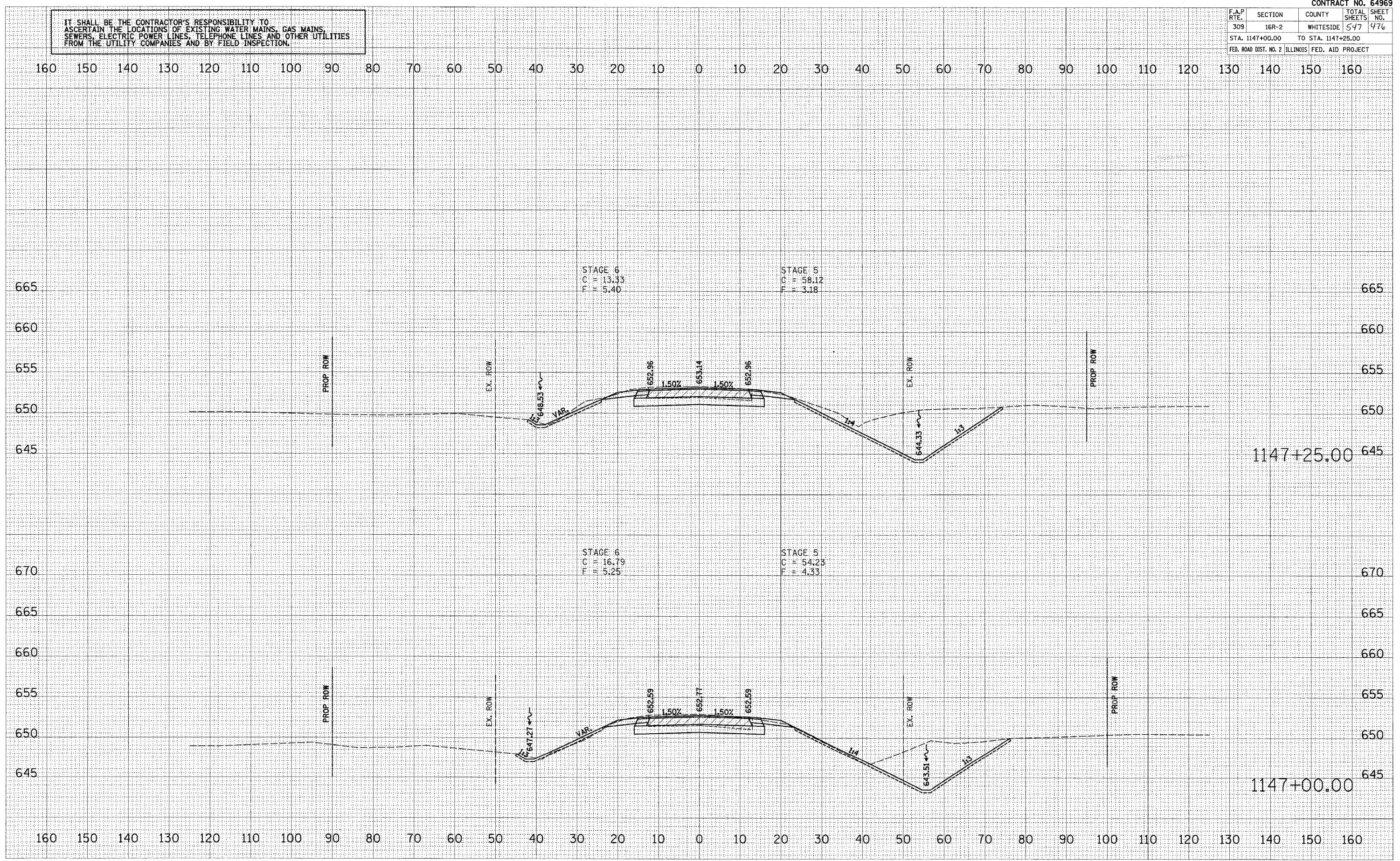

12/15/2005 10:36:35 AM
 x:\scb\bin\lwp\lwp.dgn