

Contract #64B29

TOTAL BILL OF MATERIAL

ITEM	UNIT	SUPER	SUB	TOTAL
Removal of Existing Superstructures	Each	1		1
Precast Prestressed Concrete Deck Beams (21" Depth)	Sq. Ft.	2,149		2,149
Reinforcement Bars, Epoxy Coated	Pound	3,100		3,100
Concrete Wearing Surface, 5"	Sq. Yd.	239		239
Bridge Deck Grooving	Sq. Yd.	227		227
Steel Bridge Rail, Type SM	Foot	105		105
Name Plates	Each	1		1
Formed Concrete Repair, (Depth equal to or less than 5")	Sq. Ft.		2.0	2.0
Epoxy Crack Sealing	Foot		66	66
Asbestos Bearing Pad Removal	Each	14		14
Silicone Joint Sealer, 1/2"	Foot	41		41
Furnishing & Erecting Structural Steel	Pound	694		694
Protective Coat	Sq. Yd.	239		239
Bar Splicers	Each	56		56

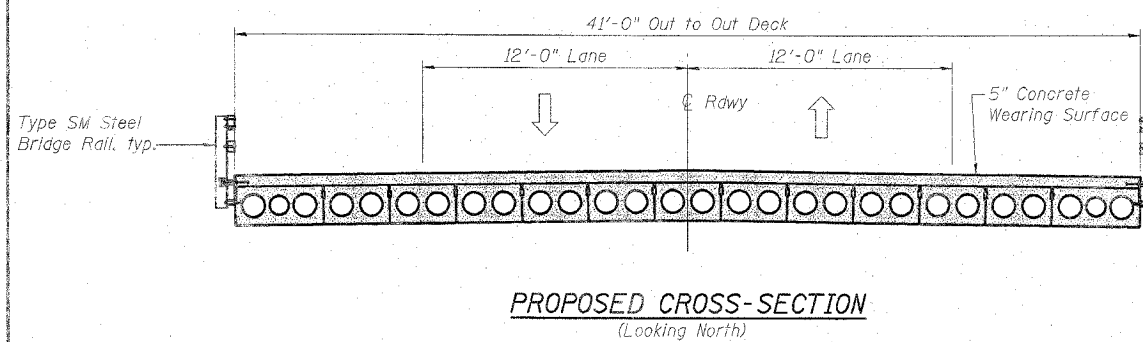
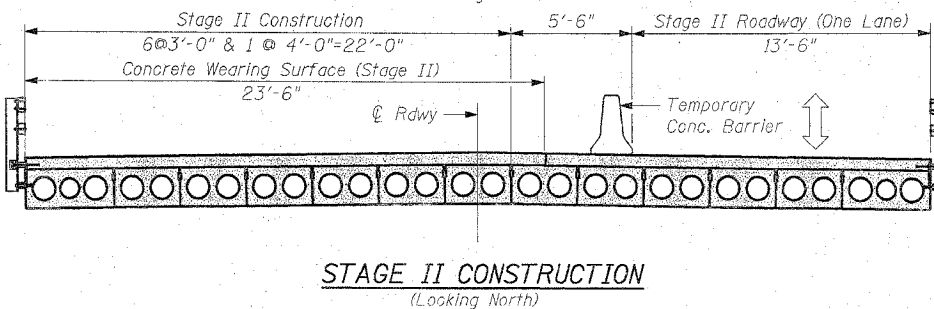
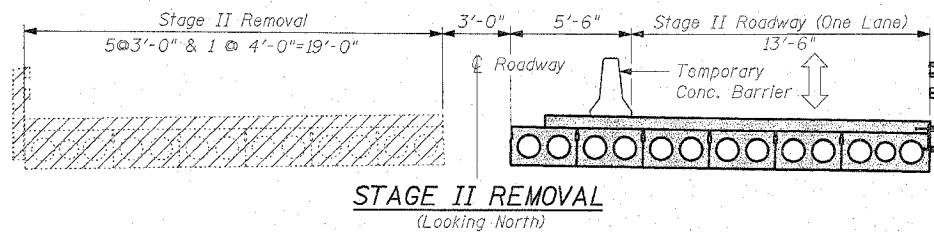
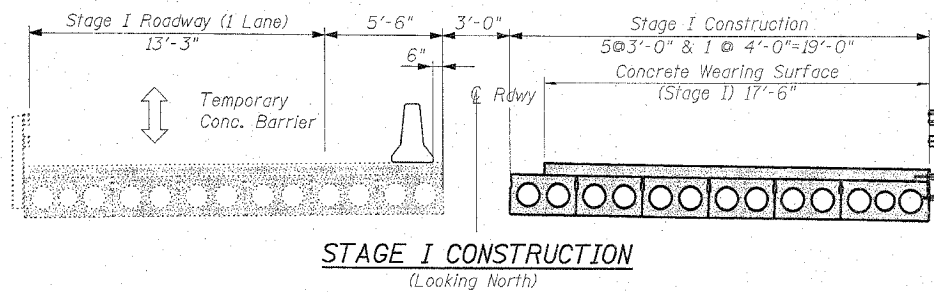
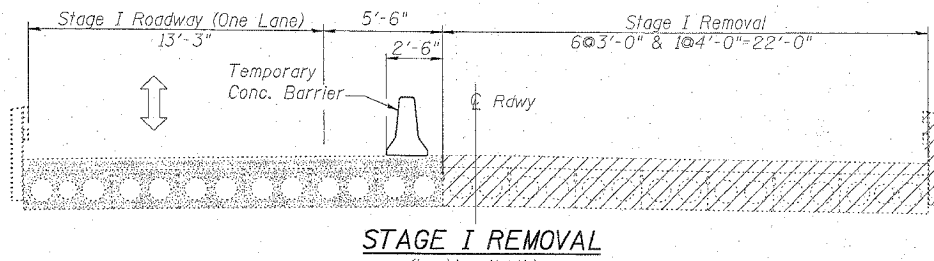
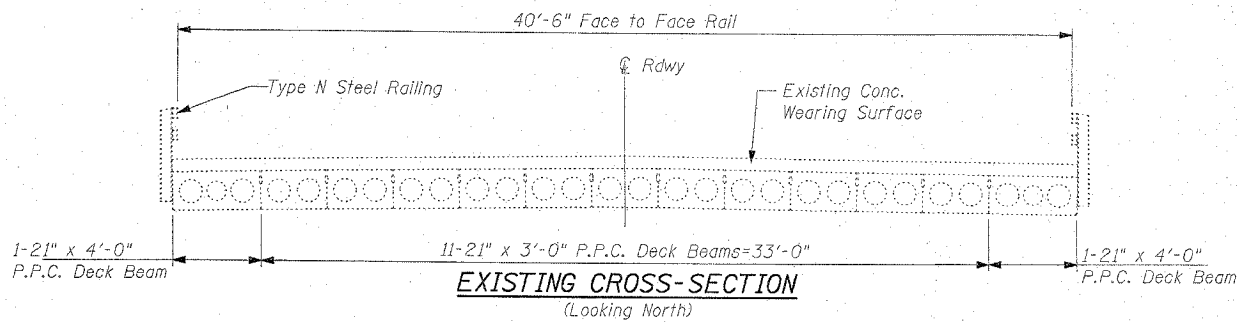

STAGE CONSTRUCTION

F.A. 308 (IL 84)
OVER SPRING CREEK
SEC. 109 BR-4
WHITESIDE COUNTY
STATION 171+60.57
STRUCTURE NO. 098-0023



REVISIONS		DATE	

NOTE: DIMENSIONAL DATA IS NOT TO BE OBTAINED BY SCALING ANY PORTION OF THIS DRAWING.

DESIGNED BY: S.L.D.	PROJECT NO: 182302
DRAWN BY: MEM	DATE: 9/85
CHECKED BY: M.M.	
APPROVED BY: M.M.	
ACTIVITY	INITIALS

DRAWING NUMBER: S-2