

F.A.U. RTE. 1	SECTION	COUNTY	TOTAL SHEETS	SHEET NO.
5952	G-BR-1	GRUNDY	50	15
STA.		TO STA.		
FED. ROAD DIST. NO. 7		ILLINOIS FED. AID PROJECT		

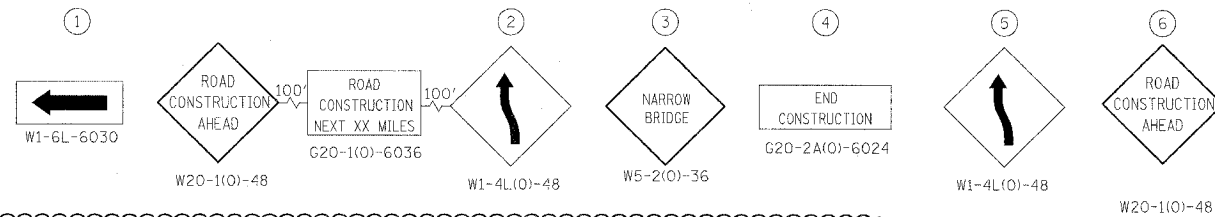

**SIGNAL LEGEND**

① MICROWAVE DETECTOR, MOUNTED 16' MIN. ABOVE ROADWAY, ON TEMPORARY WOOD POLE AND 15' BRACKET ARM. LOCATE TO DETECT VEHICLES 220' IN ADVANCE OF STOP BAR. USE AERIAL CABLE TO REACH CONTROLLER CABINET. ALL LABOR AND MATERIALS INCLUDED IN MAINTENANCE OF EXISTING TRAFFIC SIGNAL INSTALLATION PAY ITEM.

② SIGNAL CONTROLLER INPUT PHASE

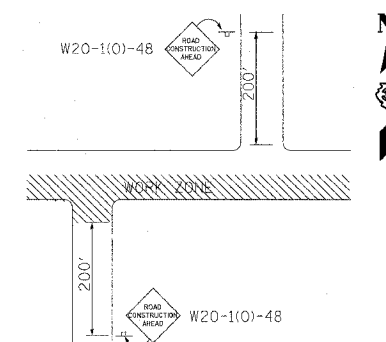
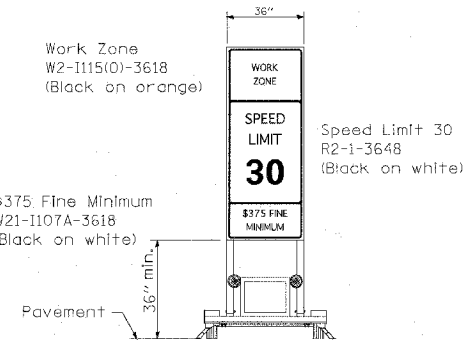

**CONSTRUCTION SPEED LIMIT SIGN**  
 ANY EXISTING CONTRADICTORY SPEED LIMIT SIGNS TO BE REMOVED. SIGNS TO APPEAR EVERY 1/2 MILE, AND AT LOCATIONS OF SPEED LIMIT CHANGES.

**SIDE ROAD ADVANCE SIGNING**

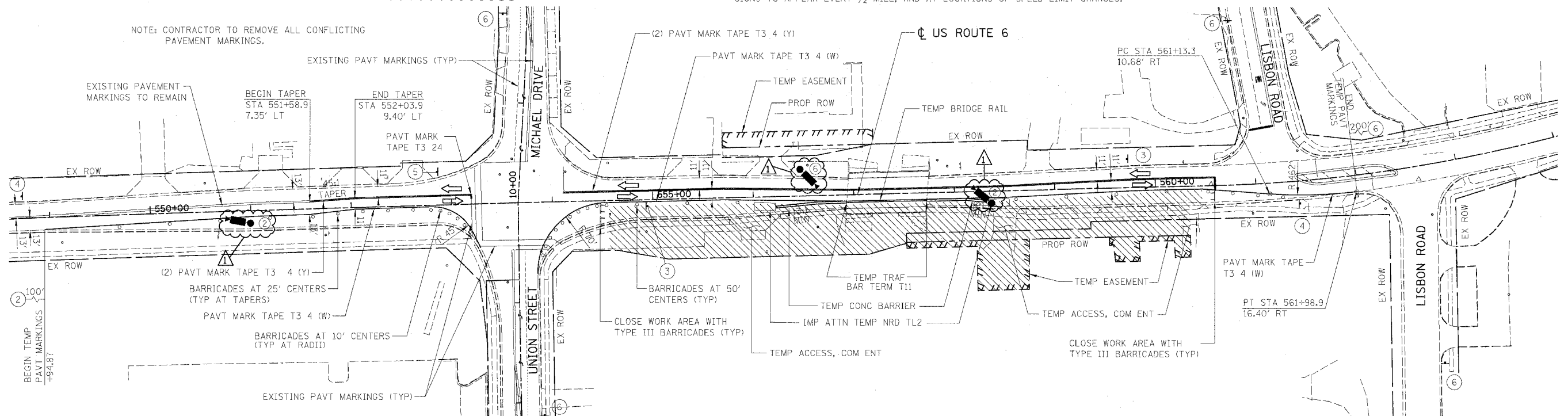

**TRAFFIC SIGNAL WORK**

- CHANGE SIGNAL SEQUENCE OF OPERATION FROM EXISTING TO PROPOSED; COMBINE PHASE 5 WITH PHASE 2 AT UNION/MICHAEL. DISABLE WESTBOUND LEFT TURN LANE DETECTOR.
- INSTALL THE TWO PROPOSED FAR LOOP DETECTORS FOR EASTBOUND TRAFFIC AT LISBON ROAD, INCLUDING HANDHOLE, CONDUIT AND CABLE; MAKE THESE LOOPS OPERATIONAL IN THE CONTROLLER (SEE SHEET 17).
- CHANGE SIGNAL SEQUENCE OF OPERATION FROM EXISTING TO PROPOSED; COMBINE PHASE 1 WITH PHASE 6 AT LISBON ROAD. MOVE THE EASTBOUND LEFT TURN LANE DETECTOR FROM THE EASTBOUND LEFT TURN PHASE (5) TO THE EASTBOUND THROUGH PHASE (2).

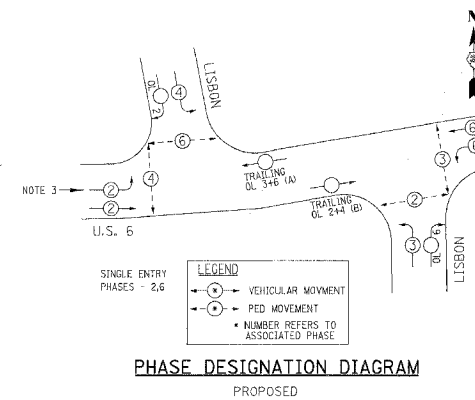
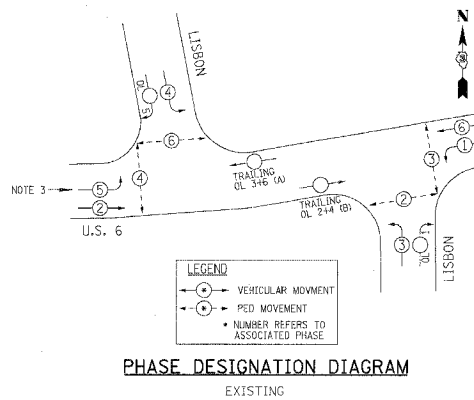
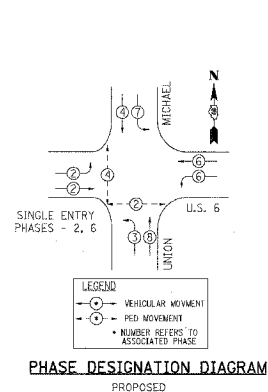
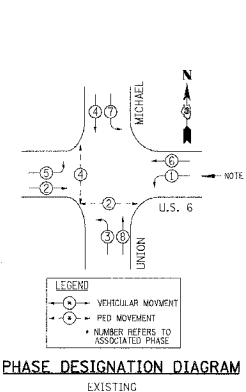

- LEGEND:**
- WORK ZONE
  - DRUM OR TYPE II BARRICADE
  - TRAFFIC SIGN
  - TRAFFIC FLOW DIRECTION
  - TYPE III BARRICADE

REVISIONS	
NAME	DATE
ADDENDUM 1	2-27-06

ILLINOIS DEPARTMENT OF TRANSPORTATION

U.S. ROUTE 6  
 MAINTENANCE OF TRAFFIC  
 STAGE 1A

SCALE: VERT. NTS  
 HORIZ. 1" = 50'  
 DATE 11/04/05

DRAWN BY JAM  
 CHECKED BY DDM

**BOWMAN, BARRETT & ASSOCIATES INC.**  
 CONSULTING ENGINEERS  
 130 E. RANDOLPH STREET  
 CHICAGO, ILLINOIS 60601  
 JOB NO. 541

