

F.A.U. RTE.	SECTION	COUNTY	TOTAL SHEETS	SHEET NO.
5952	G-BR-1	GRUNDY	50	18
STA.		TO STA.		
FED. ROAD DIST. NO. 7		ILLINOIS FED. AID PROJECT		

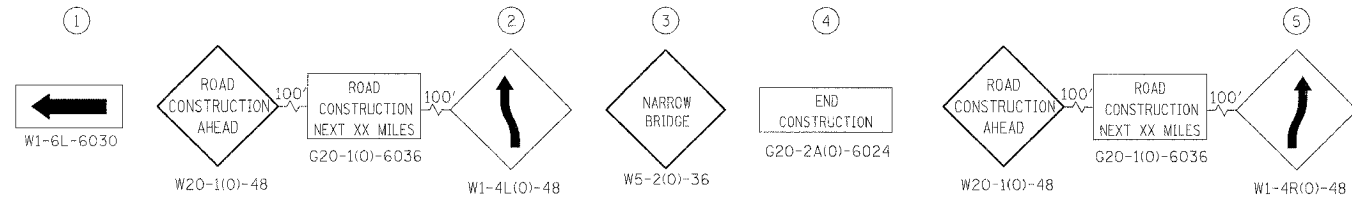

NOTE: CONTRACTOR TO REMOVE ALL CONFLICTING PAVEMENT MARKINGS.

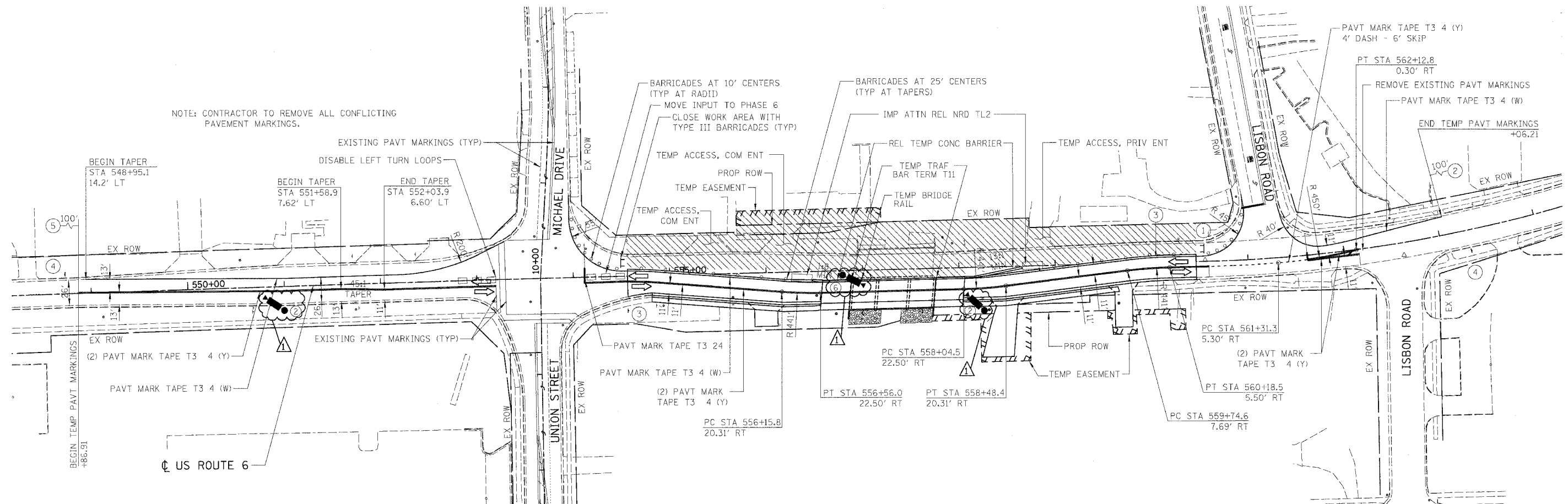

SIGNAL LEGEND

! MICROWAVE DETECTOR, MOUNTED 16' MIN. ABOVE ROADWAY, ON TEMPORARY WOOD POLE AND 15' BRACKET ARM. LOCATE TO DETECT VEHICLES 220' IN ADVANCE OF STOP BAR. USE AERIAL CABLE TO REACH CONTROLLER CABINET. ALL LABOR AND MATERIALS INCLUDED IN MAINTENANCE OF EXISTING TRAFFIC SIGNAL INSTALLATION PAY ITEM.

② SIGNAL CONTROLLER INPUT PHASE

TRAFFIC SIGNAL WORK

1. INSTALL THE TWO PROPOSED FAR LOOP DETECTORS FOR WESTBOUND TRAFFIC AT UNION/MICHAEL, INCLUDING ALL CONDUIT AND CABLE; SPLICE LOOP DETECTOR WIRE INTO EXISTING LOOP LEAD-IN CABLE TO MAKE LOOPS OPERATIONAL IN CONTROLLER (SEE SHEET 19).
2. MOVE THE WESTBOUND LEFT TURN LOOP DETECTOR INPUT (PHASE 1) TO THE WESTBOUND THROUGH PHASE (PHASE 6), AND DISABLE THE EASTBOUND LEFT TURN LANE LOOP DETECTOR AT UNION/MICHAEL.

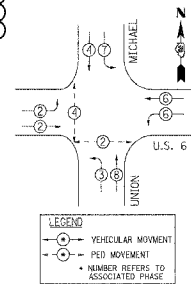

PHASE DESIGNATION DIAGRAM

EXISTING
NOTE: MOVE DETECTOR INPUT FOR PHASE 1 TO PHASE 6.

LEGEND:

- ▨ WORK ZONE
- DRUM OR TYPE II BARRICADE
- ! TRAFFIC SIGN
- ➔ TRAFFIC FLOW DIRECTION
- ⊞ TYPE III BARRICADE

REVISIONS	
NAME	DATE
ADDENDUM 1	2-27-06

ILLINOIS DEPARTMENT OF TRANSPORTATION

U.S. ROUTE 6
MAINTENANCE OF TRAFFIC
STAGE 2A

SCALE: VERT. NTS
HORIZ. 1" = 50'
DATE 11/04/05

DRAWN BY JAM
CHECKED BY DDM

BOWMAN, BARRETT & ASSOCIATES INC.
CONSULTING ENGINEERS
130 E. RANDOLPH STREET
CHICAGO, ILLINOIS 60601
JOB NO. 541



2/17/2006 2:24:19 PM
m:\541\cadda\civil\66563\East Fork\541mo12a_ef.dgn