

F.A.U. RTE.	SECTION	COUNTY	TOTAL SHEETS	SHEET NO.
5952	G-BR-1	GRUNDY	50	20
STA.	TO STA.			
FED. ROAD DIST. NO. 7	ILLINOIS		FED. AID PROJECT	

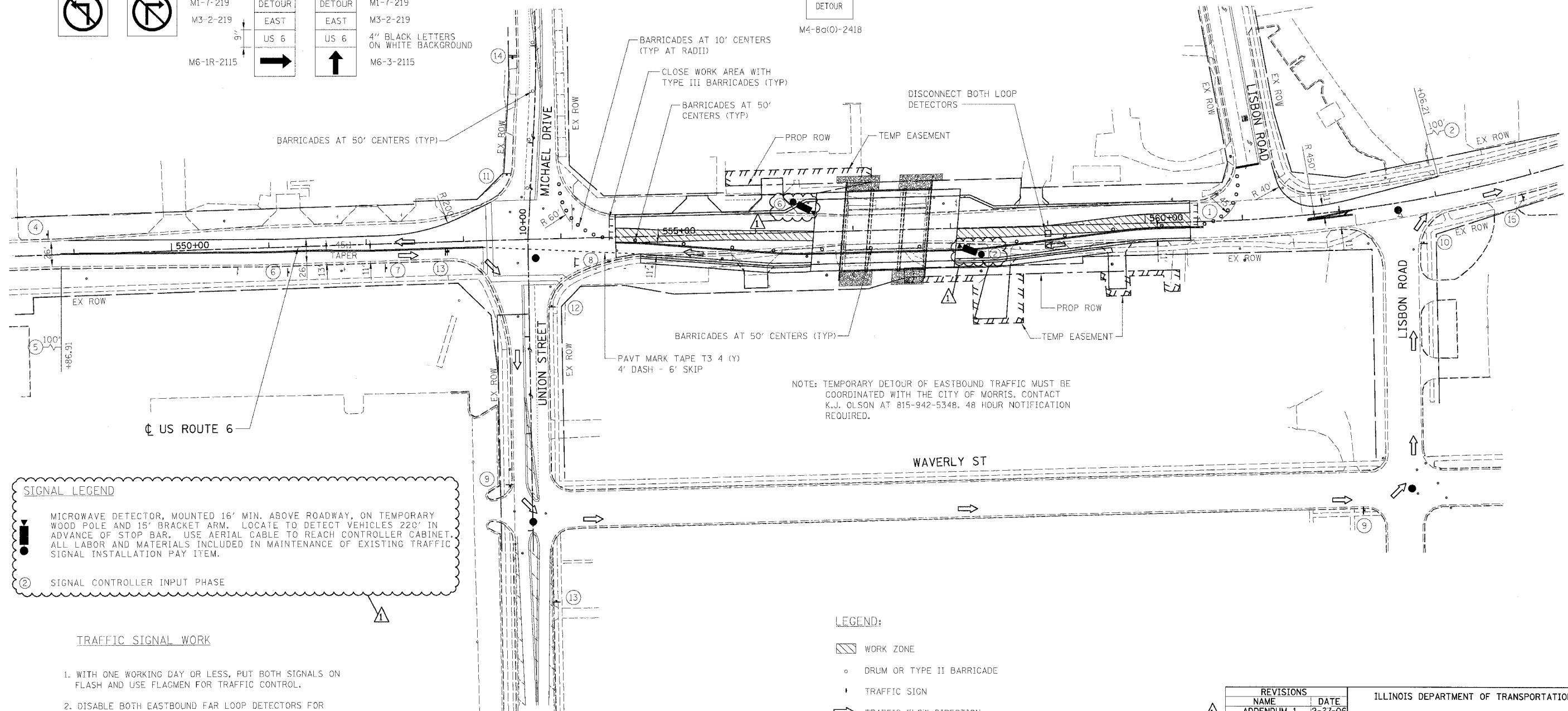
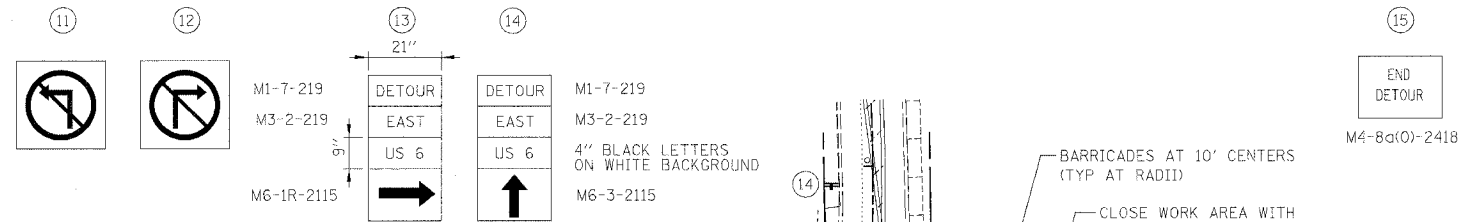
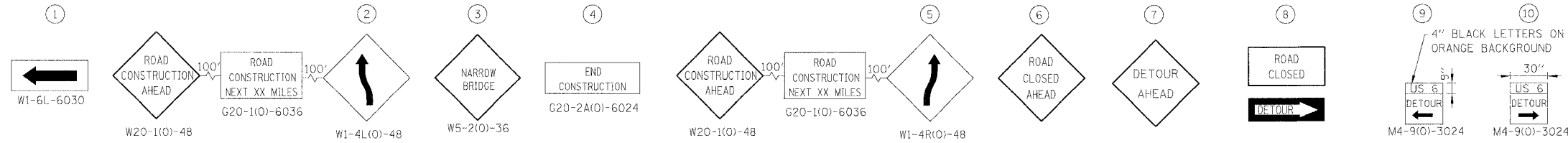

**SIGNAL LEGEND**

MICROWAVE DETECTOR, MOUNTED 16' MIN. ABOVE ROADWAY, ON TEMPORARY WOOD POLE AND 15' BRACKET ARM. LOCATE TO DETECT VEHICLES 220' IN ADVANCE OF STOP BAR. USE AERIAL CABLE TO REACH CONTROLLER CABINET. ALL LABOR AND MATERIALS INCLUDED IN MAINTENANCE OF EXISTING TRAFFIC SIGNAL INSTALLATION PAY ITEM.

② SIGNAL CONTROLLER INPUT PHASE

- TRAFFIC SIGNAL WORK**
1. WITH ONE WORKING DAY OR LESS, PUT BOTH SIGNALS ON FLASH AND USE FLAGMEN FOR TRAFFIC CONTROL.
  2. DISABLE BOTH EASTBOUND FAR LOOP DETECTORS FOR EASTBOUND TRAFFIC AT LISBON ROAD.

- LEGEND:**
- ▨ WORK ZONE
  - DRUM OR TYPE II BARRICADE
  - ↑ TRAFFIC SIGN
  - ➔ TRAFFIC FLOW DIRECTION
  - FLAGGER
  - ⌊ TYPE III BARRICADE

REVISIONS	
NAME	DATE
ADDENDUM 1	2-27-06

**BOWMAN, BARRETT & ASSOCIATES INC.**  
 CONSULTING ENGINEERS  
 130 E. RANDOLPH STREET  
 CHICAGO, ILLINOIS 60601  
 JOB NO. 541

ILLINOIS DEPARTMENT OF TRANSPORTATION

U.S. ROUTE 6  
 MAINTENANCE OF TRAFFIC  
 STAGE 2B

SCALE: VERT. NTS  
 HORIZ. 1" = 50'

DATE 11/04/05

DRAWN BY JAM  
 CHECKED BY DDM

2/17/2006 2:05:42 PM  
 P:\541\roads\66563\66563\_Enst\_Fork\Sheet28.EF.dgn