

STATE OF ILLINOIS  
DEPARTMENT OF TRANSPORTATION

ROUTE NO.	SECTION	COUNTY	TOTAL SHEETS	SHEET NO.	SHEET NO. S10
FAU 5952	①	GRUNDY	52	42	OF S14 SHEETS
FED. ROAD DIST. NO. 7	ILLINOIS	FED. AID PROJECT			

① G-BR-1 66563

PILE DATA

Type: Steel HP 10x42  
Capacity: Driven to Refusal  
Est. Length: 35'  
No. Req'd: 13

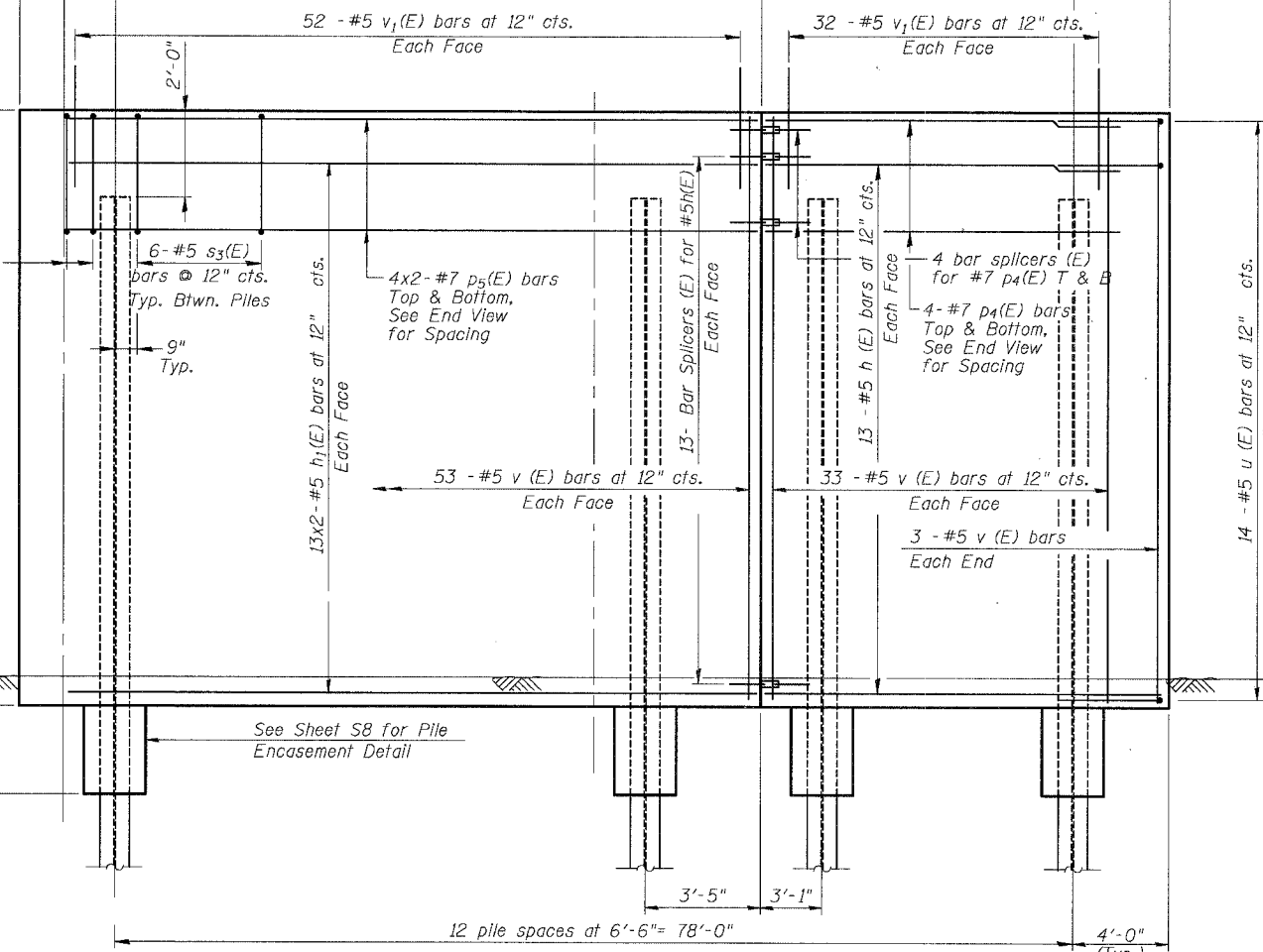
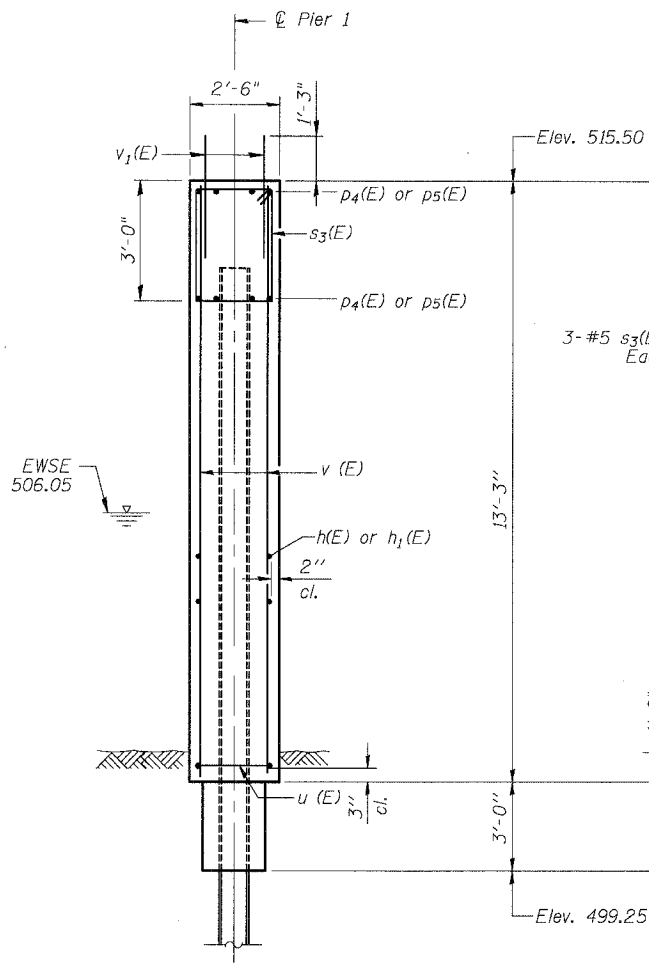
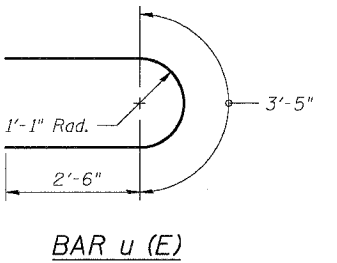
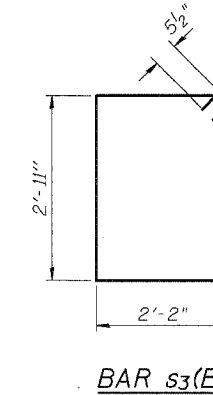
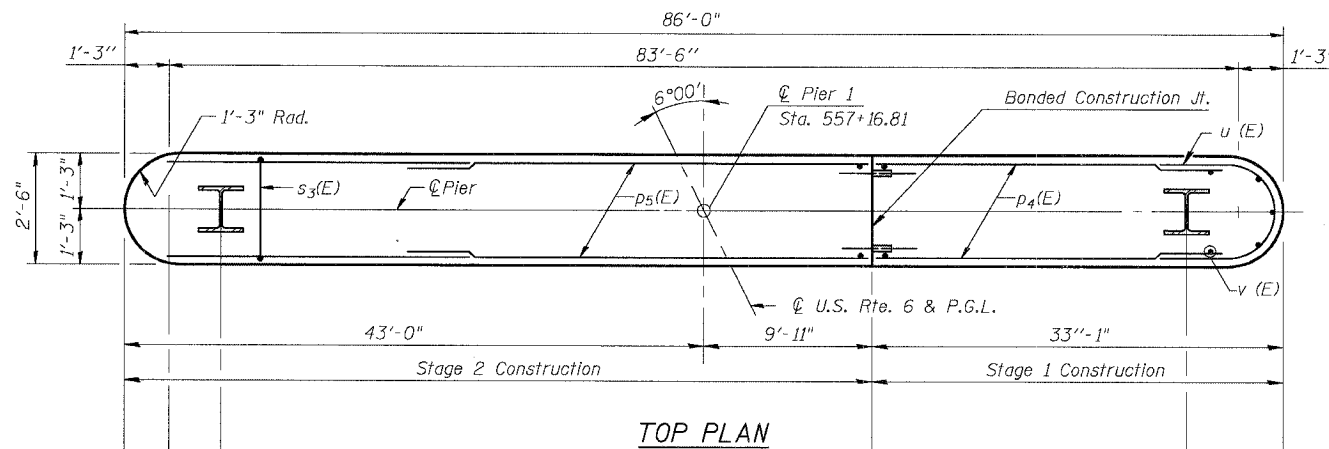
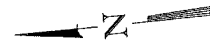

BILL OF MATERIAL

Bar	No.	Size	Length	Shape
h(E)	26	# 5	31'-7"	—
h1(E)	52	# 5	26'-11"	—
p4(E)	8	# 7	31'-7"	—
p5(E)	16	# 7	28'-2"	—
s3(E)	78	# 5	11'-1"	□
u(E)	28	# 5	8'-5"	U
v(E)	178	# 5	12'-10"	—
v1(E)	168	# 5	3'-5"	—
				Concrete Structures
				Cu. Yd. 104.9
				Reinforcement Bars, Epoxy Coated
				Pound 7890
				Furnishing Steel Piles HP10x42
				Foot 455
				Driving Steel Piles
				Foot 455
				Bar Splicers
				Each 34
				Underwater Structure Excavation Protection, Location 1
				Each 1

Notes:  
Reinforcement bars designated (E) shall be epoxy coated.  
Bars indicated thus 14 x 2-#5 etc. indicate 14 lines of bars with 2 lengths per line.  
All piles shall be encased per the Pile Encasement Detail on Sheet S8.  
Tremie concrete shall be used below the water level.

MIN. BAR LAP

#5	2'-2"
#7	4'-10"

ELEVATION  
(Looking East)

DESIGNED	UM
CHECKED	BLU
DRAWN	EBP
CHECKED	BLU

DATE: 10/25/05

PIER 1  
U.S. ROUTE 6 (BEDFORD ROAD)  
OVER EAST FORK OF NETTLE CREEK  
FAU 5952-SEC. G-BR-1  
GRUNDY COUNTY  
STATION 557+33.31  
S.N. 032-0108

BOWMAN, BARRETT  
& ASSOCIATES INC.  
CONSULTING ENGINEERS  
130 E. RANDOLPH STREET  
CHICAGO, ILLINOIS 60601  
JOB NO. 541

