

STATE OF ILLINOIS
DEPARTMENT OF TRANSPORTATION

F.A.P. R.T.E.	SECTION	COUNTY	TOTAL SHEETS	SHEET NO.
681	113BR-2	LIVINGSTON	47	32
STA.	TO STA.			
FED. ROAD DIST. NO.		ILLINOIS FED. AID PROJECT		

SHEET NO. B20

OF 31 SHEETS

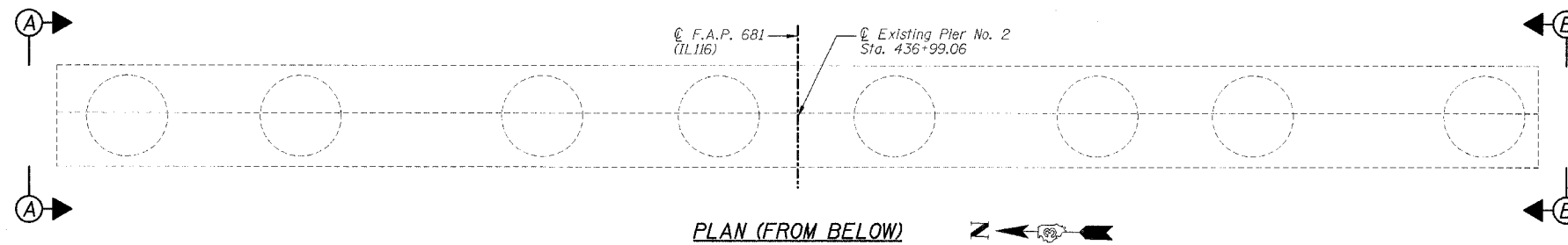

PLAN (FROM BELOW)

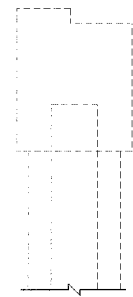

ELEVATION A-A

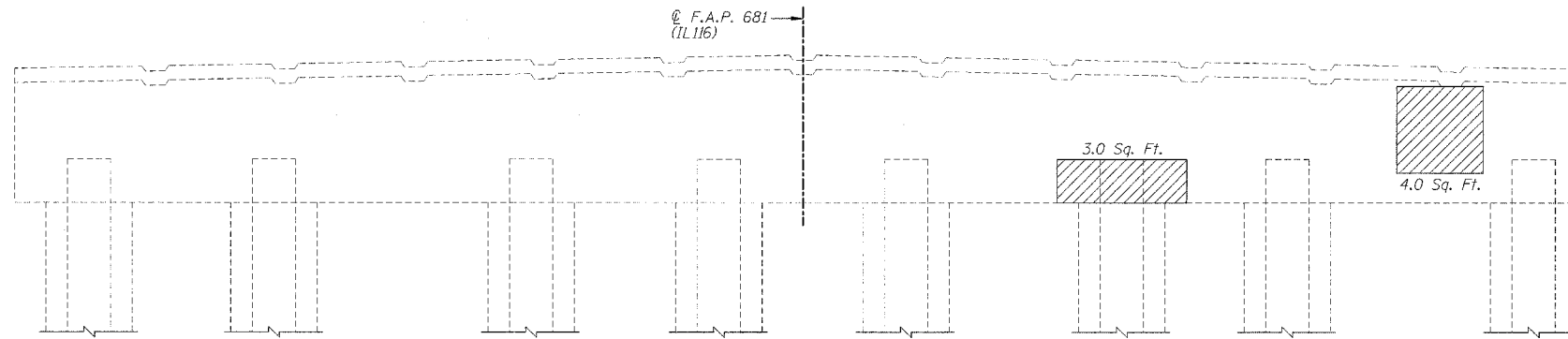

ELEVATION - LOOKING EAST

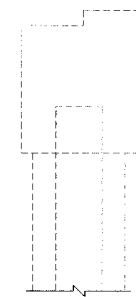

ELEVATION B-B

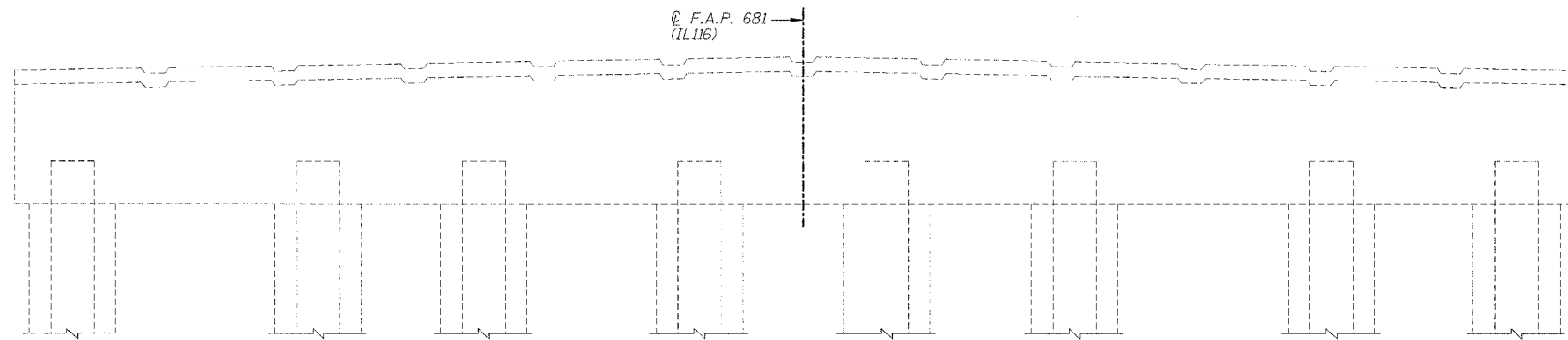

ELEVATION - LOOKING WEST

NOTES:

- 1.) Work this sheet with Sheets B21 & B22.
- 2.) The number next to the hatched areas is the square footage of each damaged area.

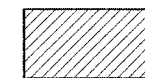

Formed Concrete Repair
(Depth Equal To Or
Less Than 5")

REVISIONS	
NAME	DATE

ILLINOIS DEPARTMENT OF TRANSPORTATION
PIER NO. 2 CONCRETE REPAIRS
F.A.P. 681 (IL116) OVER FELKY SLOUGH
SECTION 113BR-2
LIVINGSTON COUNTY
STATION 436+75.00
STRUCTURE NO. 053-0075
DESIGNED BY: JML
DATE: 12/09/05
DRAWN BY: DJM
CHECKED BY: MSW