

F.A.P. RTE.	SECTION	COUNTY	TOTAL SHEETS	SHEET NO.
693	22 BR	MC LEAN	28	1

STATE OF ILLINOIS
DEPARTMENT OF TRANSPORTATION
DIVISION OF HIGHWAYS

**PROPOSED
HIGHWAY PLANS**

FAP ROUTE 693 (IL 9)
SECTION 22 BR
PROJECT BHF-0693 (055)
Mc LEAN COUNTY

C - 93 - 090 - 05

PROJECT LOCATION
SECTION 22 BR INCLUDES:
BRIDGE SUPERSTRUCTURE
REPLACEMENT:
REPLACE SUPERSTRUCTURE
ON SN 057-0076 (STA 1917+17.38)
RESURFACING FROM
STA 1914+50 TO STA 1919+60

FOR INDEX OF SHEETS, SEE SHEET NO. 2
FOR LIST OF HIGHWAY STANDARDS, SEE SHEET NO. 2

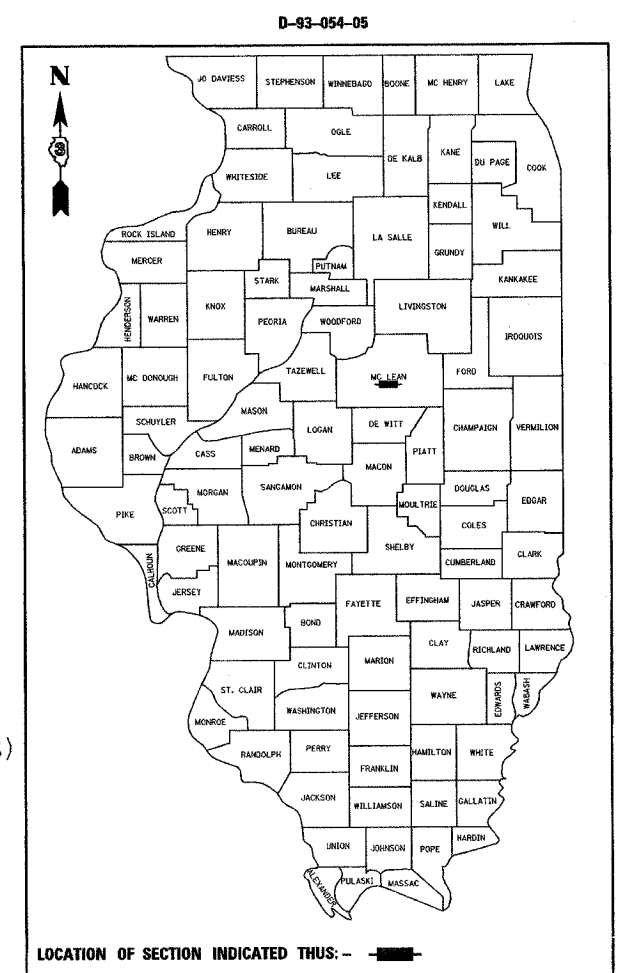

ADT (2003) = 2,750
MU = 3.3%

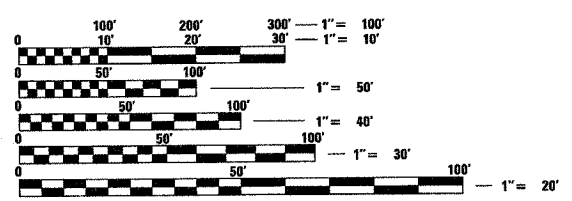

FULL SIZE PLANS HAVE BEEN PREPARED USING STANDARD ENGINEERING SCALES. REDUCED SIZED PLANS WILL NOT CONFORM TO STANDARD SCALES. IN MAKING MEASUREMENTS ON REDUCED PLANS, THE ABOVE SCALES MAY BE USED.

MICROFILMED _____
REEL NUMBER _____
AWARDED _____
RESIDENT ENGINEER _____
AS BUILT CHANGES WERE MADE
ON THE FOLLOWING SHEETS _____

J.U.L.I.E.
JOINT UTILITY LOCATION INFORMATION FOR EXCAVATION
1-800-892-0123

DISTRICT 3 NO. (815) 434-6131
PROJECT ENGINEER: DAVE BROVIK
UNIT CHIEF: MARK JONES

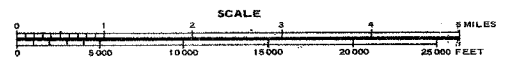
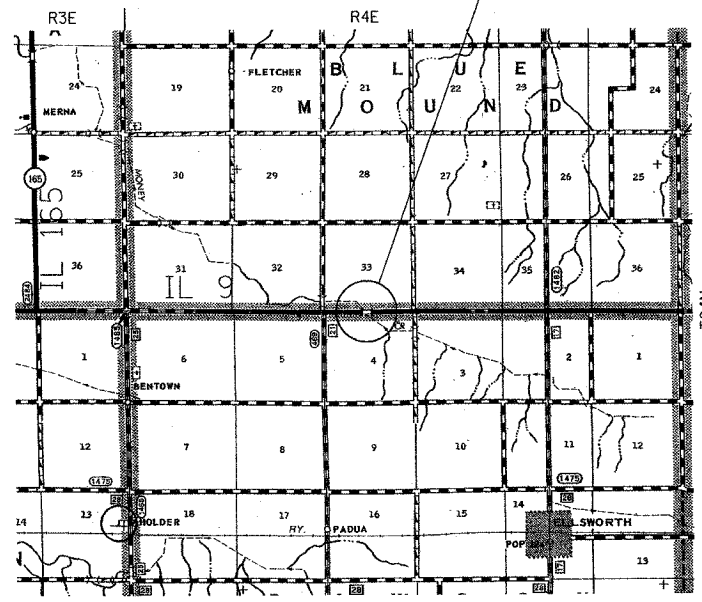

GROSS LENGTH = 510.0 FT. = 0.097 MI.
NET LENGTH = 510.0 FT. = 0.097 MI.



Mary Blodgett 12-16-05
Exp. 11-20-07

STATE OF ILLINOIS
DEPARTMENT OF TRANSPORTATION
DIVISION OF HIGHWAYS

SUBMITTED _____ 20____

George P. M...
DEPUTY DIRECTOR OF HIGHWAYS, REGION ENGINEER

February 3, 2006
Mike Lane
ENGINEER OF DESIGN AND ENVIRONMENT

February 3, 2006
Milton R. Seas, P.E.
DIRECTOR OF HIGHWAYS, CHIEF ENGINEER

**PRINTED BY THE AUTHORITY
OF THE STATE OF ILLINOIS**

PLOT DATE = 10/16/2006
 FILE NAME = I:\66583\0693\0693-1\0693cover.dgn
 PLOT SCALE = 1/8"=30' / IN.
 USER NAME = DFC