

F.A.U. RTE.	SECTION	COUNTIES	TOTAL SHEETS	SHEET NO.
6088	17N	*	18	1

STATE OF ILLINOIS
DEPARTMENT OF TRANSPORTATION
DIVISION OF HIGHWAYS
PROPOSED
HIGHWAY PLANS

FAU ROUTE 6088 (US 6)
SECTION 17N

PROJECT HS-6088(001)
LASALLE COUNTY
C-93-101-05

WIDENING, TURN LANE & RADIUS IMPROVEMENTS,
AND TRAFFIC SIGNALS AT THE INTERSECTION
OF DALZELL RD AND US RT 6

INDEX

- 1 COVER SHEET
- 2 GENERAL NOTES
- 3-4 SUMMARY OF QUANTITIES
- 5 TYPICAL SECTIONS
- 6 SCHEDULES
- 7 TIE POINTS
- 8 PLAN SHEET
- 9 GEOMETRICS SHEET
- 10 - 11 PAVEMENT MARKING SHEETS
- 12 - 16 TRAFFIC SIGNAL PLANS
- 17 - 18 DETAILS

STANDARDS

- 000001-04 STANDARD SYMBOLS, ABBREVIATIONS AND PATTERNS
- 001006 DECIMAL OF AN INCH AND OF A FOOT
- 280001-02 TEMPORARY EROSION CONTROL SYSTEMS
- 666001 RIGHT-OF-WAY MARKERS
- 667101 PERMANENT SURVEY MARKERS
- 701001-01 OFF-ROAD OPERATIONS 2L, 2W, MORE THAN 4.5 m (15') AWAY
- 701006-02 OFF-ROAD OPERATIONS 2L, 2W, 4.5 m (15') TO 600 mm (24") FROM PAVEMENT EDGE
- 701011-01 OFF-ROAD MOVING OPERATIONS 2L, 2W, DAY ONLY
- 701301-02 LANE CLOSURE, 2L, 2W, SHORT TIME OPERATIONS
- 701326-02 LANE CLOSURE, 2L, 2W, PAVEMENT WIDENING, FOR SPEEDS P 45 MPH
- 701701-04 URBAN LANE CLOSURE, MULTILANE INTERSECTION
- 702001-05 TRAFFIC CONTROL DEVICES
- 780001-01 TYPICAL PAVEMENT MARKINGS
- 781001-02 TYPICAL APPLICATIONS RAISED REFLECTIVE PAVEMENT MARKERS
- 805001 ELECTRICAL SERVICE INSTALLATION DETAILS
- 814001 CONCRETE HANDHOLES
- 814006 DOUBLE HANDHOLES
- 857001 STANDARD PHASE DESIGNATION DIAGRAMS AND PHASE SEQUENCES
- 877001-02 STEEL MAST ARM ASSEMBLY AND POLE
- 878001-03 CONCRETE FOUNDATION DETAILS
- 880006 TRAFFIC SIGNAL MOUNTING DETAILS
- 886001 DETECTOR LOOP INSTALLATIONS
- 886006 TYPICAL LAYOUT FOR DETECTION LOOPS

FULL SIZE PLANS HAVE BEEN PREPARED USING STANDARD ENGINEERING SCALES. REDUCED SIZED PLANS WILL NOT CONFORM TO STANDARD SCALES. IN MAKING MEASUREMENTS ON REDUCED PLANS, THE ABOVE SCALES MAY BE USED.

J.U.L.I.E.
 JOINT UTILITY LOCATION INFORMATION FOR EXCAVATION
 1-800-892-0123

DISTRICT 3 NO. (815) 434-6131

PROJECT ENGINEER: DAN DRAPER
 UNIT CHIEF: MICHELE LINDEMANN

CONTRACT NO. 66595

INTERSECTION OF US 6
 AND DALZELL ROAD

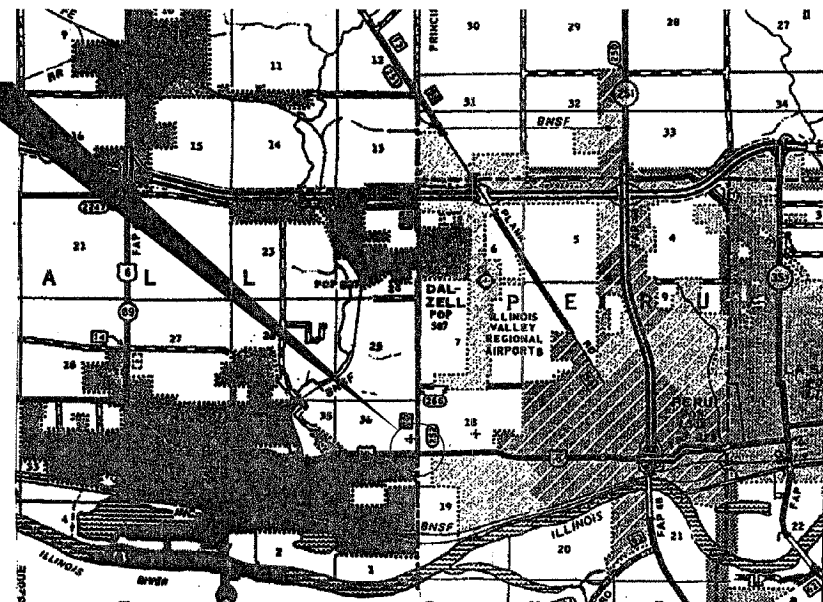

LOCATION MAP
 NOT TO SCALE

SPOT IMPROVEMENT



PRINCIPAL ARTERIAL
 2005 ADT = 14,000
 PV = 96% SU = 2.7% MU = 1.3%

STATE OF ILLINOIS
 DEPARTMENT OF TRANSPORTATION
 DIVISION OF HIGHWAYS

SUBMITTED Dec 15 20 05
Gary Mont
 DEPUTY DIRECTOR OF HIGHWAYS, REGION ENGINEER

February 3, 20 06
Mike Fine
 ENGINEER OF DESIGN AND ENVIRONMENT

February 3, 20 06
Milton R. Sess, P.E.
 DIRECTOR OF HIGHWAYS, CHIEF ENGINEER

**PRINTED BY THE AUTHORITY
 OF THE STATE OF ILLINOIS**

FED. AID DIST. NO.	SECTION	COUNTIES	TOTAL SHEETS	SHEET NO.
6088	17N	*	18	2
STA.		TO STA.		
FED. ROAD DIST. NO.	ILLINOIS	FED. AID PROJECT		

* LASALLE & BUREAU

GENERAL NOTES

THE THICKNESS OF BITUMINOUS MIXTURES SHOWN ON THE PLANS IS THE NOMINAL THICKNESS. DEVIATIONS FROM THE NOMINAL THICKNESS WILL BE PERMITTED WHEN SUCH DEVIATIONS OCCUR DUE TO IRREGULARITIES IN THE EXISTING SURFACE OR BASE ON WHICH THE BITUMINOUS MIXTURE IS PLACED.

AGGREGATE (PRIME COAT): FA 20 MAY BE USED IN ADDITION TO THE GRADATIONS LISTED IN THE 3RD PARAGRAPH OF ARTICLE 1003.03(c) OF THE STANDARD SPECIFICATIONS.

THE ENGINEER WILL BE THE SOLE JUDGE CONCERNING CURING TIME FOR THE VARIOUS BITUMINOUS LIFTS.

FOR STABILIZATION, ALL TYPE III BARRICADES SHALL REQUIRE A MINIMUM OF FOUR SAND BAGS PER BARRICADE.

WHERE SECTION OR SUBSECTION MONUMENTS ARE ENCOUNTERED, THE ENGINEER SHALL BE NOTIFIED BEFORE SUCH MONUMENTS ARE REMOVED. THE CONTRACTOR SHALL PROTECT AND CAREFULLY PRESERVE ALL MONUMENTS UNTIL AN AUTHORIZED SURVEYOR OR AGENT HAS WITNESSED OR OTHERWISE REFERENCED THEIR LOCATION. THE CONTRACTOR SHALL BE RESPONSIBLE FOR HAVING AN AUTHORIZED SURVEYOR REESTABLISH ANY SECTION OR SUBSECTION MONUMENTS DESTROYED BY HIS OPERATIONS.

SEEDING SHALL NOT BE PERMITTED AT ANY TIME WHEN THE GROUND IS FROZEN, WET, OR IN AN UNTILLABLE CONDITION. LOCATIONS TO BE SEEDED WILL BE DETERMINED BY THE ENGINEER.

THE FINISHED EARTHWORK SHALL HAVE A VEGETATION SUSTAINING SOIL COVERING THE TOP FOUR INCHES IN AREAS TO BE SEEDED OR SODDED. THE VEGETATION SUSTAINING SOIL REQUIRED WILL NOT BE PAID FOR SEPARATELY BUT SHALL BE INCLUDED IN THE COST OF FURNISHED EXCAVATION.

ON EXISTING PAVEMENT WHICH MAY BE SUPERELEVATED, THE NEW BITUMINOUS PAVEMENT SHALL BE BUILT WITH THE SAME SUPERELEVATION UNLESS NEW SUPERELEVATION RATES ARE GIVEN ON THE PLANS.

ALL ELEVATIONS REFERRING TO U.S.G.S. MEAN SEA LEVEL DATUM.

ANY REFERENCE TO A STANDARD IN THESE PLANS SHALL BE INTERPRETED TO MEAN THE EDITION AS INDICATED BY THE SUBNUMBER LISTED ON THE INDEX OF SHEETS OR THE COPY OF THE STANDARD INCLUDED IN THESE PLANS.

THE FOLLOWING RATES OF APPLICATION HAVE BEEN USED IN CALCULATING PLAN QUANTITIES:

GRANULAR MATERIALS	2.05	TONS / CU YD
BITUMINOUS MAT PRIME COAT	0.08	GAL / SQ YD OR
	0.375	GAL / SQ YD
AGGREGATE PRIME COAT	0.002	TONS / SQ YD
BITUMINOUS RESURFACING	112	LBS / SQ YD / IN
SHORT TERM PAVEMENT MARKING	10	FT / 100 FT OF APPLICATION
MIX FOR CRACKS, JTS & FLGWYS	0.0003	TONS / SQ YD
LEVEL BINDER (HAND METHOD)	0.0005	TONS / SQ YD

ALL DAMAGE TO DEPARTMENT OWNED UNDERGROUND FACILITIES, CAUSED BY THE CONTRACTOR SHALL BE REPAIRED TO THE SATISFACTION OF THE DEPARTMENT AT THE CONTRACTOR'S EXPENSE. THIS SHALL INCLUDE ALL TEMPORARY REPAIRS REQUIRED TO KEEP THE FACILITY OPERATIONAL WHILE MATERIAL IS BEING OBTAINED TO MAKE PERMANENT REPAIRS. SPLICING OF ELECTRIC CABLE SHALL NOT BE ALLOWED. ELECTRIC CABLE SHALL BE REPLACED FROM POLE TO POLE OR CONTROLLER.

MEMBERS OF JULIE KNOWN TO BE WITHIN THE LIMITS OF THE IMPROVEMENT ARE:

- AMEREN IP - ELECTRIC
- AMEREN IP - GAS
- CITY OF SPRING VALLEY
- INSIGHT COMMUNICATIONS
- SBC
- VERIZON

THERE ARE NO NON-MEMBERS OF JULIE KNOWN TO BE WITHIN THE LIMITS OF THE IMPROVEMENT.

STATE OF ILLINOIS
DEPARTMENT OF TRANSPORTATION
DISTRICT THREE

PREPARED BY: Rick Powell
DISTRICT STUDIES & PLANS ENGINEER

DATE: 12-15-2005

EXAMINED BY: [Signature]
DISTRICT CONSTRUCTION ENGINEER

[Signature]
DISTRICT MATERIALS ENGINEER

[Signature]
DISTRICT OPERATIONS ENGINEER

REVISIONS	
NAME	DATE

ILLINOIS DEPARTMENT OF TRANSPORTATION
GENERAL NOTES

F.A.U. RTE.	SECTION	COUNTIES	TOTAL SHEETS	SHEET NO.
6088	17N	*	18	3
STA. _____		TO STA. _____		
FED. ROAD DIST. NO. _____		ILLINOIS	FED. AID PROJECT	

* LASALLE & BUREAU

SUMMARY OF QUANTITIES

CODE NO.	ITEM	CONSTRUCTION CODE TYPE:		1000-1A 90% FED 10% STATE ROADWAY	Y031-1F 90% FED 10% STATE SIGNALS
		UNIT	TOTAL QUANTITY		
20200500	EARTH EXCAVATION (WIDENING)	CU YD	50	50	
20400800	FURNISHED EXCAVATION	CU YD	79	79	
25000200	SEEDING, CLASS 2	ACRE	0.1	0.1	
25000400	NITROGEN FERTILIZER NUTRIENT	POUND	9	9	
25000500	PHOSPHORUS FERTILIZER NUTRIENT	POUND	9	9	
25000600	POTASSIUM FERTILIZER NUTRIENT	POUND	9	9	
25100630	EROSION CONTROL BLANKET	SQ YD	484	484	
31100300	SUB-BASE GRANULAR MATERIAL, TYPE A 4"	SQ YD	184	184	
40600100	BITUMINOUS MATERIALS (PRIME COAT)	GALLON	187	187	
40600300	AGGREGATE (PRIME COAT)	TON	5	5	
40600400	MIXTURE FOR CRACKS, JOINTS, AND FLANGEWAYS	TON	1	1	
40600990	TEMPORARY RAMP	SQ YD	136	136	
44000006	BITUMINOUS SURFACE REMOVAL 1 1/2"	SQ YD	2340	2340	
44000100	PAVEMENT REMOVAL	SQ YD	238	238	
44002805	ISLAND REMOVAL	SQ FT	474	474	
48101200	AGGREGATE SHOULDERS, TYPE B	TON	11	11	
66700205	PERMANENT SURVEY MARKERS, TYPE I	EACH	1	1	
67100100	MOBILIZATION	L SUM	1	1	
70100500	TRAFFIC CONTROL AND PROTECTION STANDARD 701326	L SUM	1	1	
70102635	TRAFFIC CONTROL AND PROTECTION, STANDARD 701701	L SUM	1	1	
70103815	TRAFFIC CONTROL SURVEILLANCE	CAL DA	3	3	
70300100	SHORT-TERM PAVEMENT MARKING	FOOT	642	642	
70300210	TEMPORARY PAVEMENT MARKING - LETTERS AND SYMBOLS	SQ FT	83	83	
70300220	TEMPORARY PAVEMENT MARKING - LINE 4"	FOOT	1528	1528	
70300250	TEMPORARY PAVEMENT MARKING - LINE 8"	FOOT	342	342	
70300260	TEMPORARY PAVEMENT MARKING - LINE 12"	FOOT	97	97	
70300280	TEMPORARY PAVEMENT MARKING - LINE 24"	FOOT	58	58	
70301000	WORK ZONE PAVEMENT MARKING REMOVAL	SQ FT	107	107	
* 78000100	THERMOPLASTIC PAVEMENT MARKING - LETTERS AND SYMBOLS	SQ FT	270	270	
* 78000200	THERMOPLASTIC PAVEMENT MARKING - LINE 4"	FOOT	7028	7028	
* 78000500	THERMOPLASTIC PAVEMENT MARKING - LINE 8"	FOOT	1255	1255	
* 78000600	THERMOPLASTIC PAVEMENT MARKING - LINE 12"	FOOT	311	311	
* 78000650	THERMOPLASTIC PAVEMENT MARKING - LINE 24"	FOOT	106	106	
* 78100100	RAISED REFLECTIVE PAVEMENT MARKER	EACH	87	87	
78300200	RAISED REFLECTIVE PAVEMENT MARKER REMOVAL	EACH	87	87	
* SPECIALTY ITEMS					

12/13/2005
c:\projects\ep01205\summary.dgn

F.A.U. RTE.	SECTION	COUNTIES	TOTAL SHEETS	SHEET NO.
6088	17N	*	18	4
STA.		TO STA.		
FED. ROAD DIST. NO. _ ILLINOIS		FED. AID PROJECT		

* LASALLE & BUREAU

SUMMARY OF QUANTITIES

CODE NO.	ITEM	CONSTRUCTION CODE TYPE:		I000-1A 90% FED 10% STATE ROADWAY	Y031-1F 90% FED 10% STATE SIGNALS
		UNIT	TOTAL QUANTITY		
78300400	THERMOPLASTIC PAVEMENT MARKING REMOVAL	SQ FT	2756	2756	
81012300	CONDUIT IN TRENCH, 1" DIA., PVC	FOOT	563		563
81012500	CONDUIT IN TRENCH, 1 1/2" DIA., PVC	FOOT	200		200
81012600	CONDUIT IN TRENCH, 2" DIA., PVC	FOOT	25		25
81012800	CONDUIT IN TRENCH, 3" DIA., PVC	FOOT	32		32
81013000	CONDUIT IN TRENCH, 4" DIA., PVC	FOOT	32		32
81021350	CONDUIT PUSHED, 3" DIA., PVC	FOOT	113		113
81021370	CONDUIT PUSHED, 4" DIA., PVC	FOOT	107		107
81306500	REMOVE EXISTING JUNCTION BOX	EACH	2		2
81400400	CONCRETE HANDHOLE	EACH	4		4
81500200	TRENCH AND BACKFILL FOR ELECTRICAL WORK	FOOT	525		525
81702110	ELECTRIC CABLE IN CONDUIT, 600V (XLP-TYPE USE) 1/C NO. 10	FOOT	963		963
85700205	FULL-ACTUATED CONTROLLER AND TYPE IV CABINET, SPECIAL	EACH	1		1
87301245	ELECTRIC CABLE IN CONDUIT, SIGNAL NO. 14 5C	FOOT	1286		1286
87301255	ELECTRIC CABLE IN CONDUIT, SIGNAL NO. 14 7C	FOOT	1318		1318
87301305	ELECTRIC CABLE IN CONDUIT, LEAD-IN, NO. 14 1 PAIR	FOOT	3737		3737
87501200	TRAFFIC SIGNAL POST, 16 FT.	EACH	1		1
87800100	CONCRETE FOUNDATION, TYPE A	FOOT	3		3
87900200	DRILL EXISTING HANDHOLE	EACH	24		24
88200410	TRAFFIC SIGNAL BACKPLATE, LOUVERED, FORMED PLASTIC	EACH	12		12
88500100	INDUCTIVE LOOP DETECTOR	EACH	11		11
88600100	DETECTOR LOOP, TYPE I	FOOT	1500		1500
89502300	REMOVE ELECTRIC CABLE FROM CONDUIT	FOOT	5623		5623
89502380	REMOVE EXISTING HANDHOLE	EACH	2		2
X3560146	BITUMINOUS CONCRETE BASE COURSE WIDENING, SUPERPAVE 10 3/4 INCH	SQ YD	172	172	
X4066426	BITUMINOUS CONCRETE SURFACE COURSE, SUPERPAVE, MIX "D", N70	TON	197	197	
X4066740	LEVELING BINDER (HAND METHOD), SUPERPAVE N70	TON	1	1	
X8801300	SIGNAL HEAD, POLYCARBONATE, LED, 1-FACE, 3-SECTION, BRACKET MOUNTED	EACH	1		1
X8801310	SIGNAL HEAD, POLYCARBONATE, LED, 1-FACE, 3-SECTION, MAST ARM MOUNTED	EACH	5		5
X8801395	SIGNAL HEAD, POLYCARBONATE, LED, 1-FACE, 5-SECTION, BRACKET MOUNTED	EACH	3		3
X8801400	SIGNAL HEAD, POLYCARBONATE, LED, 1-FACE, 5-SECTION, MAST ARM MOUNTED	EACH	3		3
X0962500	REMOVE EXISTING TRAFFIC SIGNAL EQUIPMENT	L SUM	1		1
86200300	UNINTERRUPTIBLE POWER SUPPLY (UPS EXTENDED)	EACH	1		1

* SPECIALTY ITEMS

F.A.U. RTE.	SECTION	COUNTIES	TOTAL SHEETS	SHEET NO.
6088	17N	*	18	5

STA. _____ TO STA. _____
 FED. ROAD DIST. NO. _____ ILLINOIS FED. AID PROJECT
 * LASALLE & BUREAU

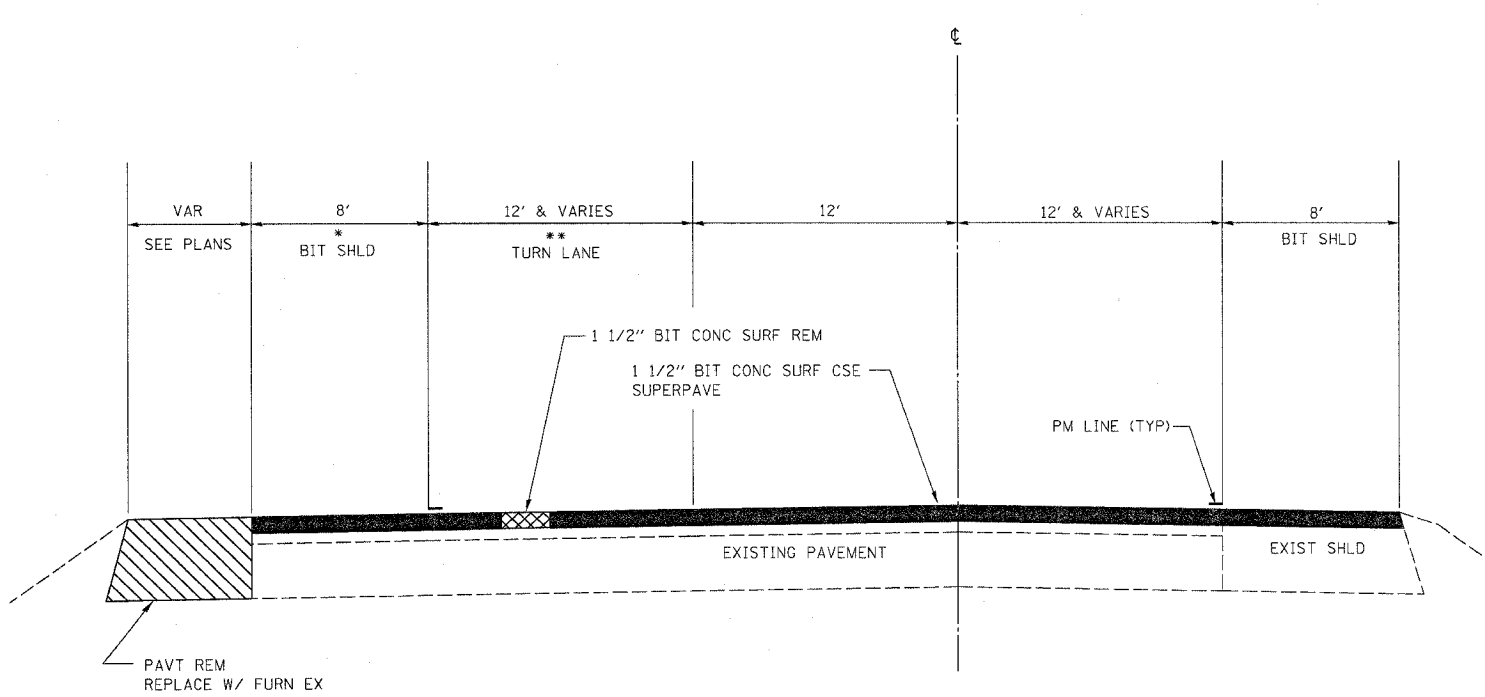

TYPICAL SECTION #1
 DALZELL ROAD
 STA 10+74.35 TO STA 11+99.59

- * VARIES FROM 8' AT STA 11+55.97 TO 6.4' AT STA 11+99.59
- ** VARIES FROM 12' AT STA 11+75.2 TO 10.8' AT STA 11+99.59

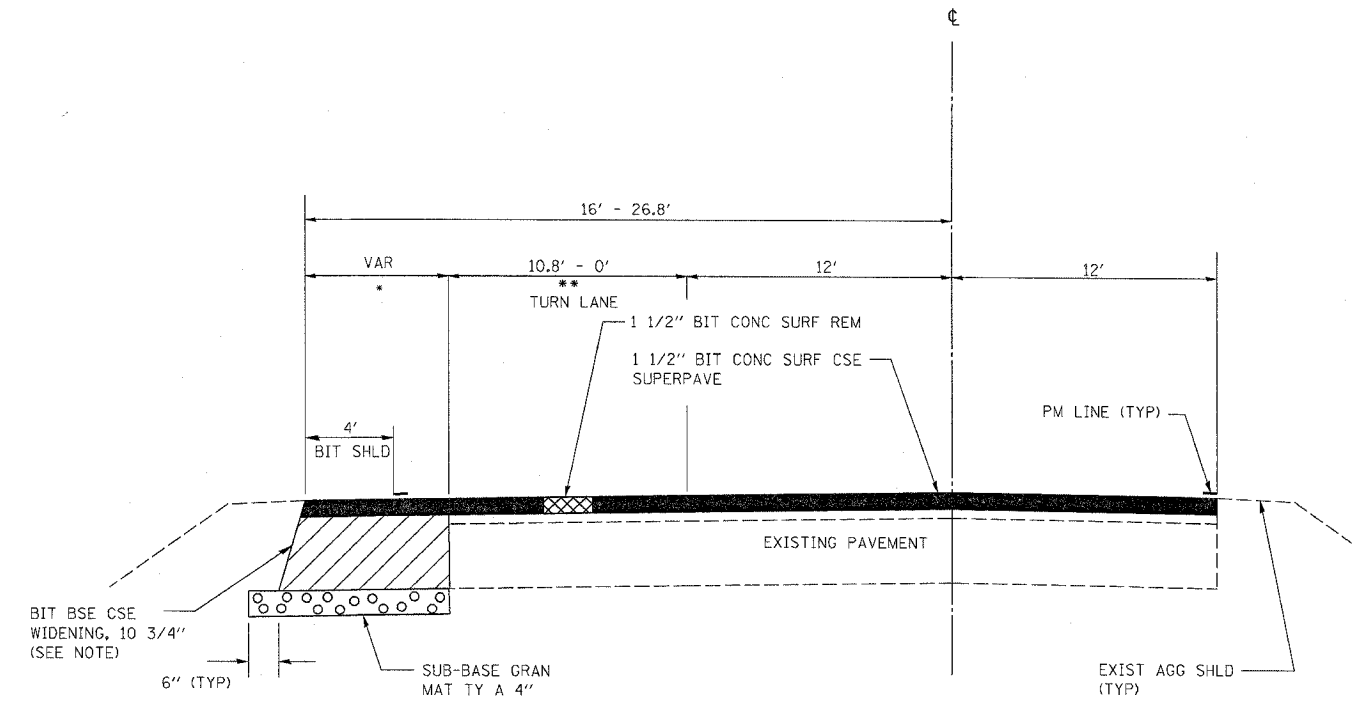

TYPICAL SECTION #2
 DALZELL ROAD
 STA 11+99.59 TO STA 14+15.2

- * WIDENING RANGES BETWEEN 4' AND 6.5'
- ** VARIES FROM 10.8' AT STA 11+99.59 TO 0' AT STA 14+15.2

NOTE: BIT BSE CSE WIDENING WILL BE MILLED AND RESURFACED WITH 1 1/2" BITUMINOUS TO GIVE A TOTAL BIT THICKNESS OF 10 3/4"

MIX DESIGN							
MIX	PG GRADE	MAX % RAP ALLOWABLE **	DESIGN AIR VOIDS	MIX COMPOSITION	FRICTION AGG	PLANT CONTROL LIMITS	DENSITY CONTROL
SUPERPAVE SURFACE	PG 64-22	10%	4.0% @N70	IL 12.5 OR IL 9.5	MIXTURE D	CLASS I	CORES / NUCLEAR
SUPERPAVE BINDER FOR BASE COURSE	PG 64-22	15%	4.0% @N70	IL 19.0		CLASS I	

- * MATERIAL SHALL BE COMPACTED TO 93-97 PERCENT OF THE MAXIMUM THEORETICAL DENSITY, EXCEPT THAT THE BOTTOM LIFT SHALL BE COMPACTED TO A MINIMUM OF 91.0 PERCENT. THE MAXIMUM THEORETICAL DENSITY SHALL BE DETERMINED FROM THE MOVING AVERAGE AS SPECIFIED IN THE QC/QA SPECIFICATION.
- ** IF RAP OPTION IS SELECTED, THE ASPHALT CEMENT GRADE MAY NEED TO BE ADJUSTED. THIS WILL BE DETERMINED BY THE ENGINEER

F.A.U. RTE.	SECTION	COUNTIES	TOTAL SHEETS	SHEET NO.
6088	17N	*	18	6
STA.		TO STA.		
FED. ROAD DIST. NO.		ILLINOIS FED. AID PROJECT		

* LASALLE & BUREAU

FURNISHED EXCAVATION AND SEEDING SCHEDULE							
LOCATION	FURN EXC	EARTH EXC WIDENING	SEEDING CL 2	EROSION CONTROL BLANKET	NIT FERT NUT	PHOS FERT NUT	POT FERT NUT
	CU YD	CU YD	ACRE	SQ YD	LB	LB	LB
PVMT REM AREA	79		0.1	484	9	9	9
DALZELL RD WIDENING		50					
TOTAL	79	50	0.1	484	9	9	9

MAINLINE SCHEDULE												
LOCATION	BIT SURF REM	BIT CONC SURF CSE SUPERPAVE	BIT CONC BSE CSE WIDENING	SUBBASE GRAN MAT	AGG SHLD TY B	TEMP RAMP	BIT MAT (PR CT)	AGG (PR CT)	MIX FOR CRACKS, JTS & FLGWYS	LEVEL BINDER (H.M.)	ISLAND REM	PVMT REM
	1 1/2" SQ YD	TON	10 3/4" SQ YD	TY A, 4" SQ YD	TON	SQ YD	GAL	TON	TON	TON	SQ FT	SQ YD
DALZELL ROAD	2340	197	172	184	11	136	187	5	1	1	474	238
TOTAL	2340	197	172	184	11	136	187	5	1	1	474	238

NOTE: AGGREGATE SHOULDER QUANTITY SHOULD ONLY BE USED IF DEEMED NECESSARY AND DIRECTED BY THE ENGINEER

THERMOPLASTIC PAVEMENT MARKING SCHEDULE									
LOCATION	THERMO PAVEMENT MARKING REMOVAL	THERMOPLASTIC PVMT MARKING		THERMO PVMT MARK	THERMO PVMT MARK	THERMO PVMT MARK	THERMO PVMT MARK	RAISED REF PVMT MARKER REMOVAL	RAISED REFLECT PVMT MARKER
		WHITE 4"	YELLOW 4"	WHITE 8"	YELLOW 12"	WHITE 24"			
		SQ FT	FOOT	FOOT	FOOT	FOOT	SQ FT		
DALZELL ROAD		800	728	342	97	58	83.2	22	22
US 6 - EAST LEG	1507	930	1760	595	107	24	140.4	35	35
US 6 - WEST LEG	1249	970	1840	318	107	24	46.8	30	30
SUB TOTAL	2756	2700	4328	1255	311	106	270	87	87
TOTAL			7028	1255	311	106	270.4	87	87

TEMPORARY PAVEMENT MARKING SCHEDULE						
LOCATION	TEMPORARY PVMT MARKING		TEMPORARY PVMT MARK	TEMPORARY PVMT MARK	TEMPORARY PVMT MARK	TEMPORARY PVMT MARK
	WHITE 4"	YELLOW 4"	WHITE 8"	YELLOW 12"	WHITE 24"	LETTERS & SYMBOLS
	FOOT	FOOT	FOOT	FOOT	FOOT	SQ FT
DALZELL ROAD	800	728	342	97	58	83.2
SUB TOTAL	800	728	342	97	58	83
TOTAL	1528		342	97	58	83

SHORT-TERM PAVEMENT MARKING SCHEDULE			
LOCATION	SHORT-TERM PAVEMENT MARKING		WORK ZONE PAV'T MARKING REMOVAL
	WHITE	YELLOW	
	FOOT	FOOT	SQ FT
DALZELL ROAD	569	73	107
SUB TOTAL	569	73	107
TOTAL	642		107

12/13/2005 c:\p\projects\6601205\summary.dgn

F.A.U. RTE.	SECTION	COUNTIES	TOTAL SHEETS	SHEET NO.
6088	17N		18	7

STA. _____ TO STA. _____

FED. ROAD DIST. NO. _____ ILLINOIS FED. AID PROJECT

• LASALLE & BUREAU

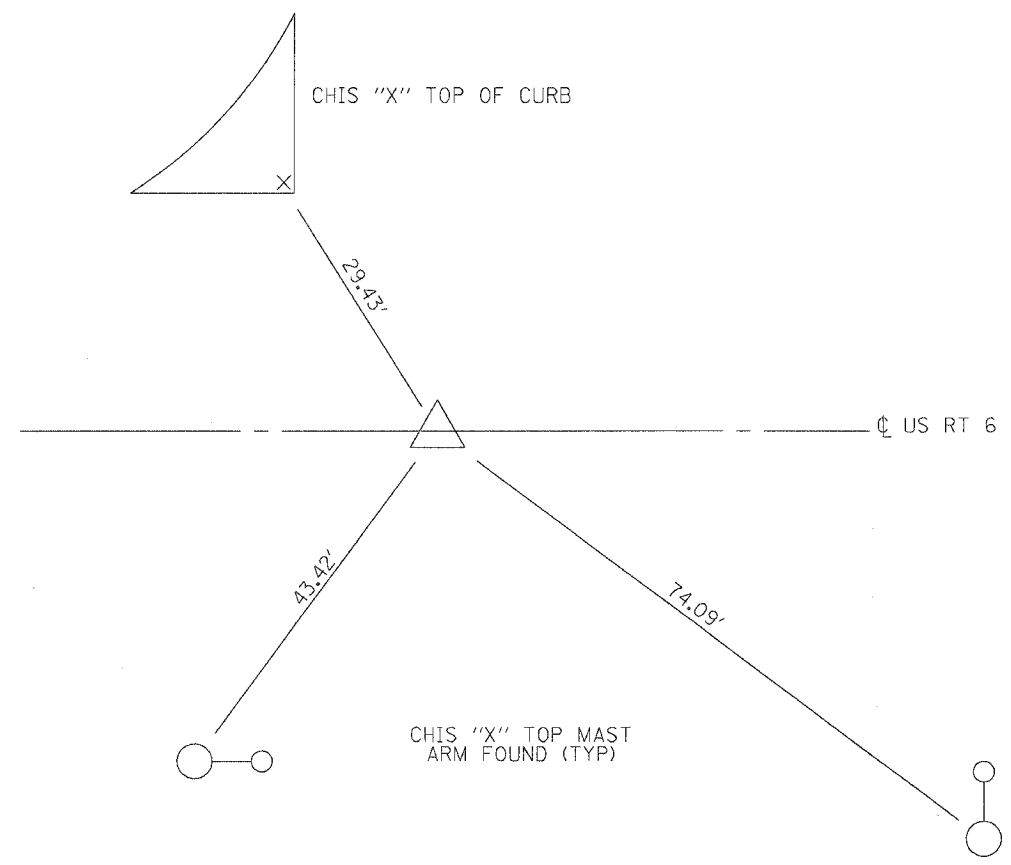



PERMANENT SURVEY MARKER
STA 95+37.00

NOTE: THIS PERMANENT SURVEY MARKER SHALL BE INSTALLED BEFORE ANY CONSTRUCTION BEGINS

F.A.U. RTE.	SECTION	COUNTIES	TOTAL SHEETS	SHEET NO.
6088	17N	*	18	8
STA. _____		TO STA. _____		
FED. ROAD DIST. NO. _____		ILLINOIS FED. AID PROJECT		

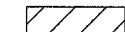
* LASALLE & BUREAU

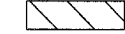
-  PAVEMENT REMOVAL
-  ISLAND REMOVAL/
REPLACE WITH BIT CONC BSE CSE WIDENING, SUPERPAVE 10 3/4"
-  BIT CONC BSE CSE WIDENING, SUPERPAVE 10 3/4 "

NOTE: BIT CONC BSE CSE WIDENING, SUPERPAVE 10 3/4"
SHALL BE MILLED AND RESURFACED WITH EXISTING
PAVEMENT

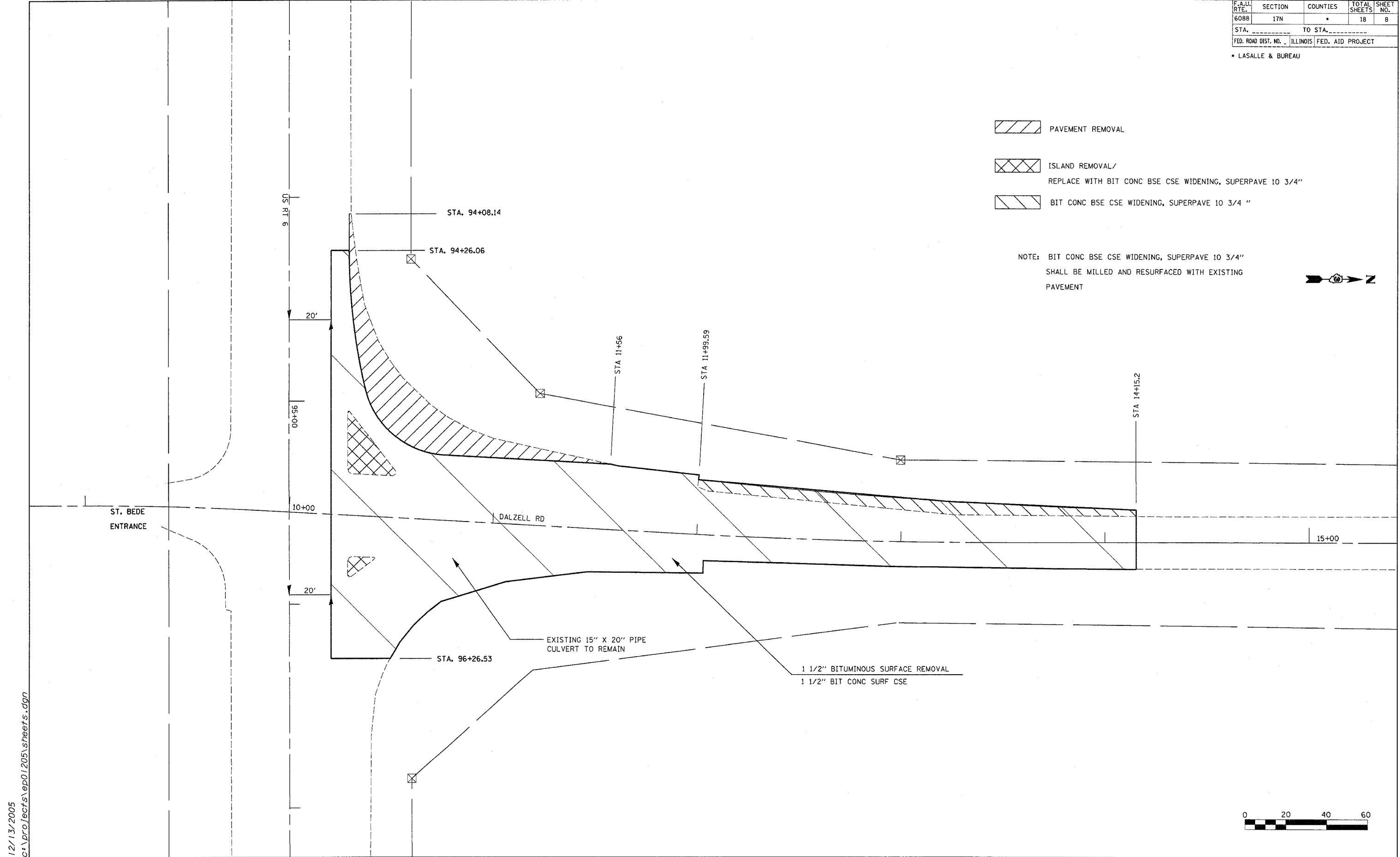
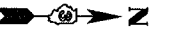

12/13/2005
 c:\projects\ep01205\sheets.dgn



66595

F.A.U. RTE.	SECTION	COUNTIES	TOTAL SHEETS	SHEET NO.
6088	17N		18	9
STA. _____ TO STA. _____				
FED. ROAD DIST. NO. _____ ILLINOIS FED. AID PROJECT				

• LASALLE & BUREAU

HORIZONTAL CURVE DATA
 PI STA. = 12+75.19
 Δ = 3° 21' 50" (LT)
 D = 2° 06' 11"
 R = 2,724.51'
 T = 80.00'
 L = 159.95'
 E = 1.17'
 P.C. STA. = 11+95.19
 P.T. STA. = 13+55.14

R1= 42'
 R2= 292'
 OFFSET= 7'

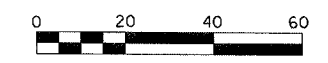
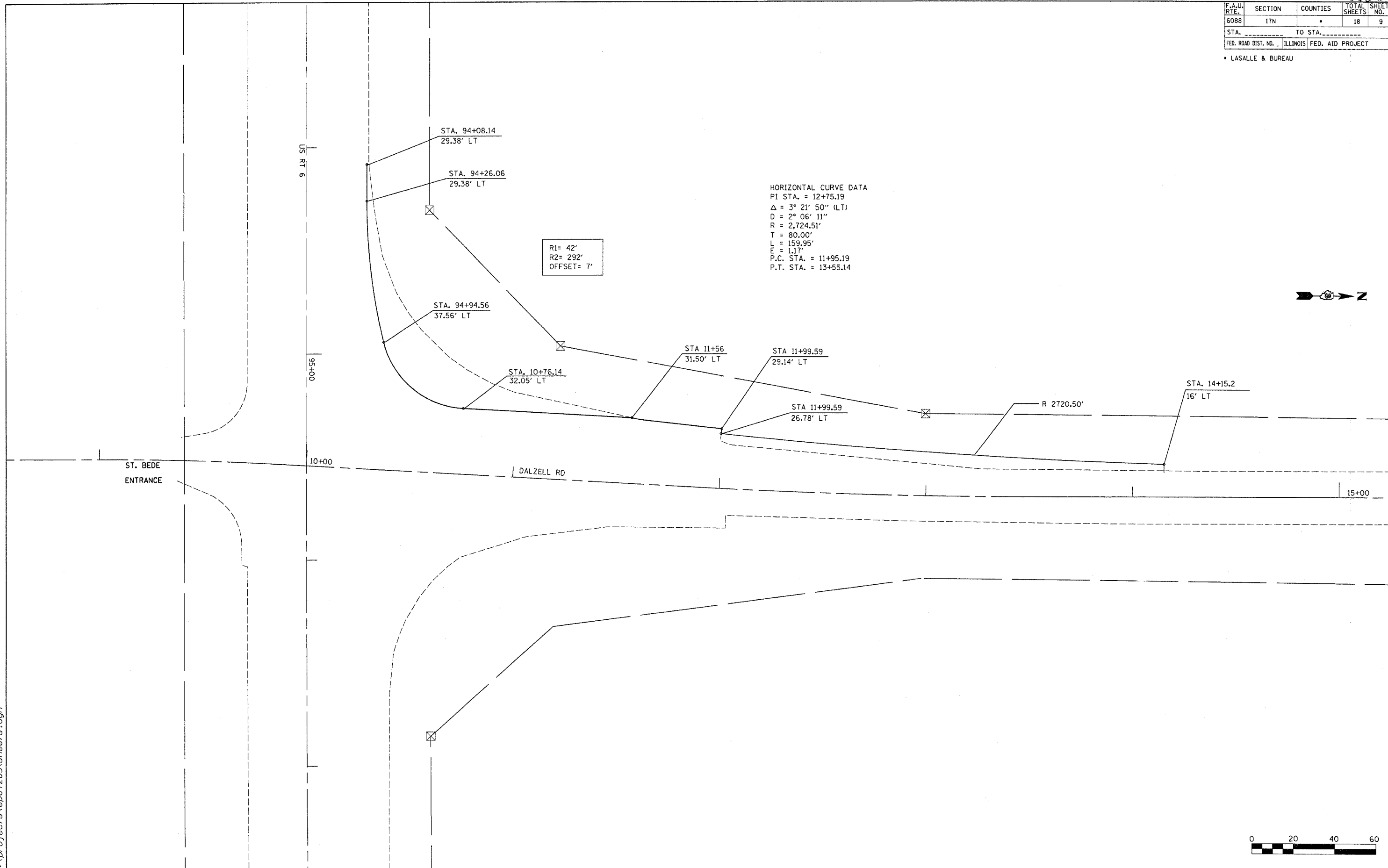

GEOMETRICS SHEET

c:\projects\ep01205\sheets.dgn

F.A.U. RTE.	SECTION	COUNTIES	TOTAL SHEETS	SHEET NO.
6088	17N	*	18	10

STA. _____ TO STA. _____
 FED. ROAD DIST. NO. _____ ILLINOIS FED. AID PROJECT

* LASALLE & BUREAU

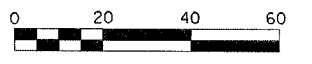
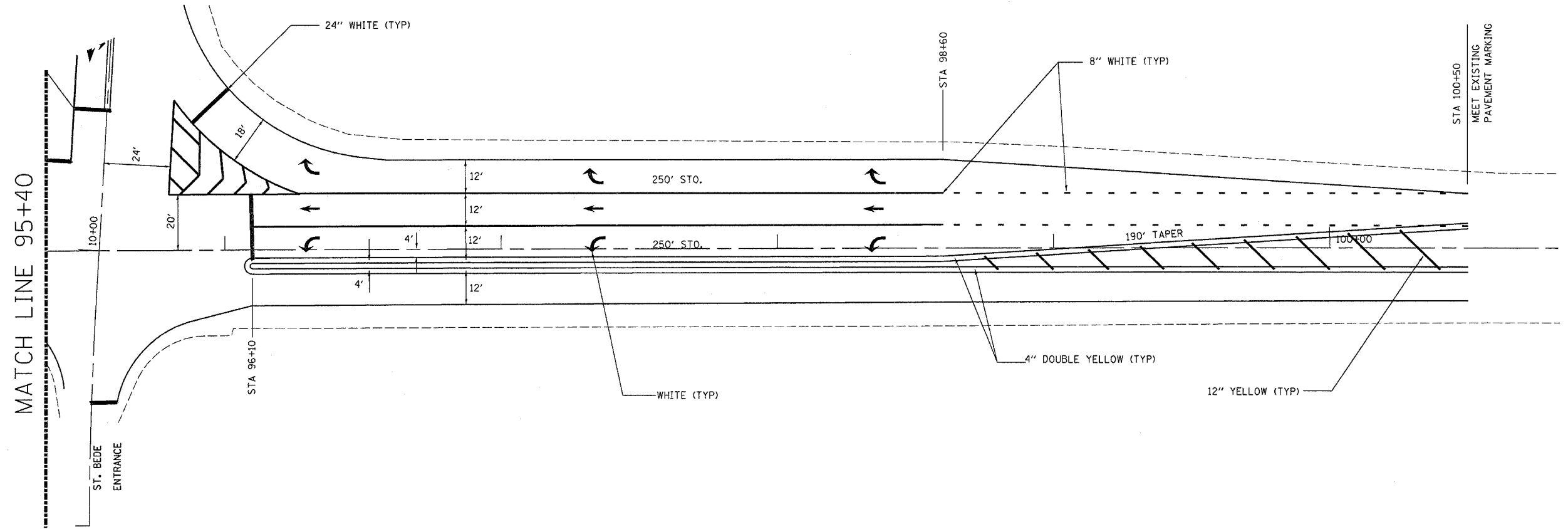
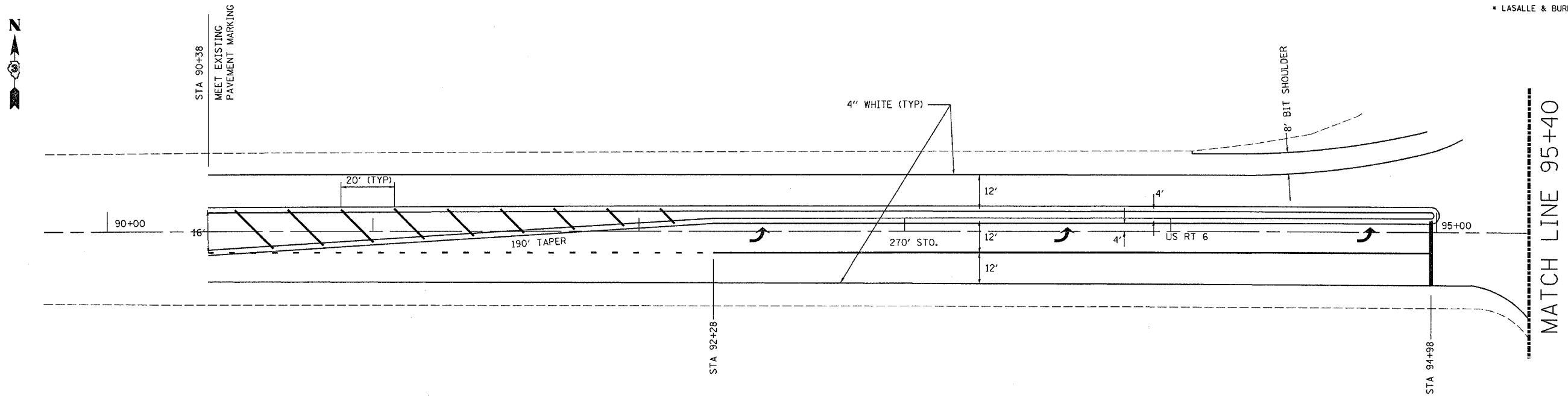

12/13/2005
 c:\projects\ep01205\sheet.s.dgn

F.A.U. RTE.	SECTION	COUNTIES	TOTAL SHEETS	SHEET NO.
6088	17N		18	11

STA. _____ TO STA. _____
 FED. ROAD DIST. NO. _____ ILLINOIS FED. AID PROJECT

• LASALLE & BUREAU

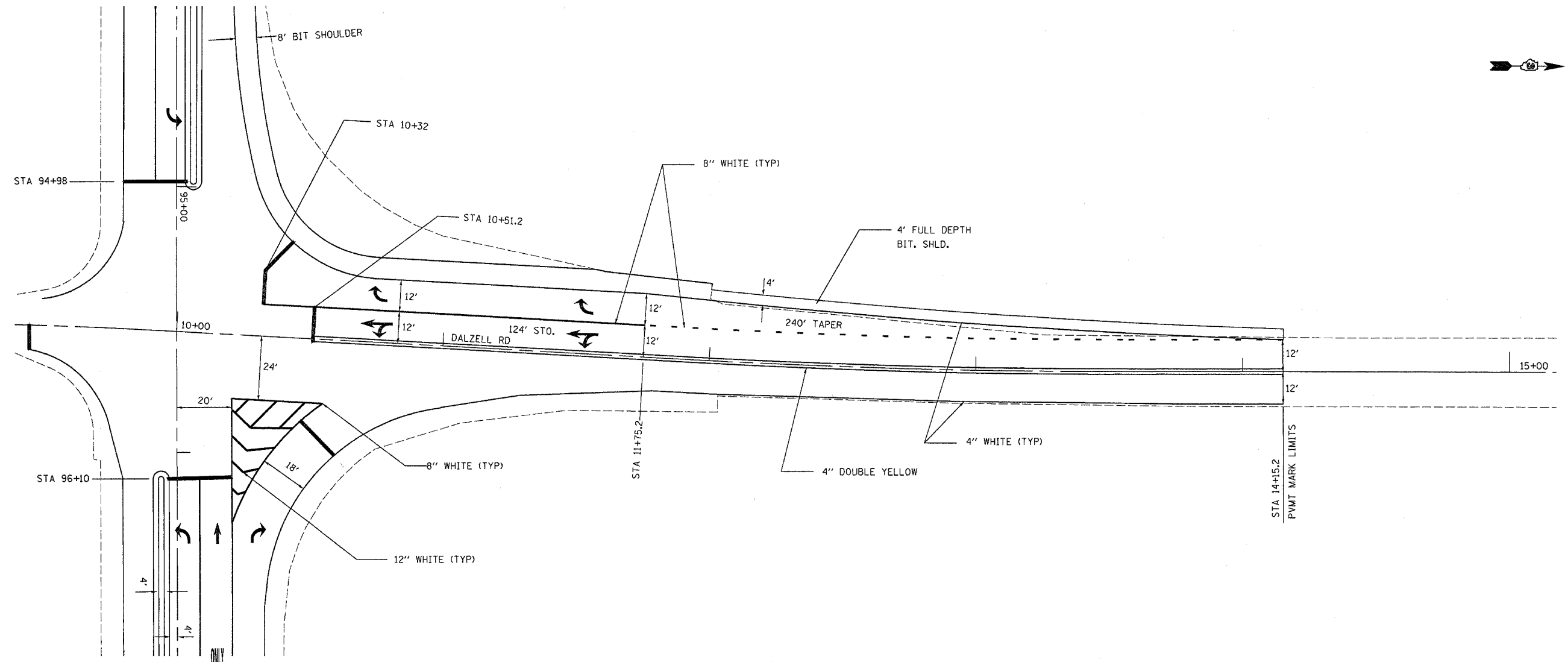

12/19/2005
 c:\projects\ep01205\sheets.dgn

F.A.U. RTE.	SECTION	COUNTY	TOTAL SHEETS	SHEET NO.
*	*	Lasalle/Bureau	18	13

FED. ROAD DIST. NO. . ILLINOIS FED. AID PROJECT

- FAU 6088 (US RTE 6)
- 17 N



CONSTRUCTION NOTES:

REMOVE AND REPLACE CONTROLLER ON EXISTING FOUNDATION. INSTALL UNINTERRUPTIBLE POWER SUPPLY.

REMOVE AND REPLACE FIVE (5) 3-SECTION, MAST ARM MOUNTED HEADS WITH 3-SECTION LED HEADS.

REMOVE AND REPLACE THREE (3) 4-SECTION, MAST ARM MOUNTED HEADS WITH 5-SECTION LED HEADS.

REMOVE AND REPLACE TWO (2) 4-SECTION, BRACKET MOUNTED HEADS WITH 5-SECTION LED HEADS IN THE SOUTHWEST CORNER.

REMOVE 4-SECTION BRACKET MOUNTED HEAD ON THE MAST ARM POLE AND REPLACE WITH 5-SECTION BRACKET MOUNTED LED HEAD ON A NEW POST IN THE NORTHEAST CORNER.

ADD A NEW 3-SECTION BRACKET MOUNTED LED HEAD ON THE MAST ARM POLE IN THE NORTHWEST CORNER.

REMOVE AND REPLACE ALL SIGNAL AND LIGHTING CABLE.

REMOVAL OF THE FOLLOWING ITEMS SHALL BE PAID FOR AS REMOVE EXISTING TRAFFIC SIGNAL EQUIPMENT.

- 1 EACH - CONTROLLER AND CABINET W/ ALL CONTENTS
- 5 EACH - SIGNAL HEAD, 1-FACE, 3-SECTION, MAST ARM MOUNTED
- 3 EACH - SIGNAL HEAD, 1-FACE, 4-SECTION, BRACKET MOUNTED
- 3 EACH - SIGNAL HEAD, 1-FACE, 4-SECTION, MAST ARM MOUNTED

TRAFFIC SIGNALS LEGEND		
EXISTING	PROPOSED	
		CONTROLLER CABINET
		CONDUIT
		SIGNAL HEAD WITH BACKPLATE
		STEEL MAST ARM
		TRAFFIC SIGNAL POST
		HANDHOLE

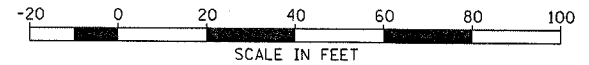
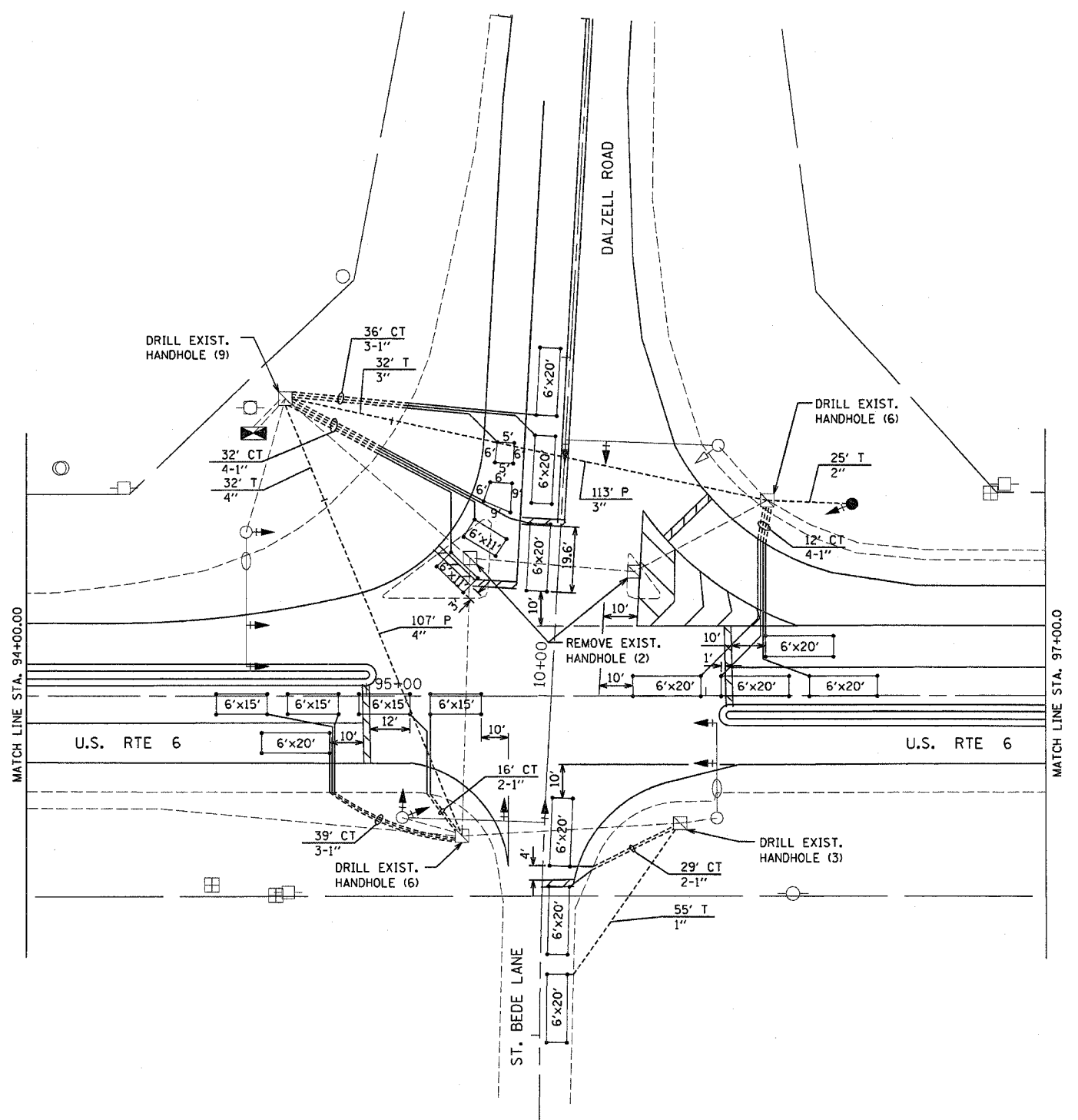

REVISIONS	
NAME	DATE

ILLINOIS DEPARTMENT OF TRANSPORTATION
TRAFFIC SIGNAL PLAN
 FAU 6088 (US RTE 6) AND
 DALZELL ROAD
 SECTION 17 N
 LASALLE & BUREAU COUNTY

SCALE: VERT. 1"=20'
 HORIZ. 1"=20'
 DATE 9/05
 DRAWN BY ARR
 CHECKED BY MVF

12/13/2005
 c:\projects\ep01205\consult\tsplan.dgn

F.A.U. RTE.	SECTION	COUNTY	TOTAL SHEETS	SHEET NO.
•	•	LaSalle/Bureau	18	14

FED. ROAD DIST. NO. - ILLINOIS FED. AID PROJECT

- FAU 6088 (US RTE 6)
- 17 N

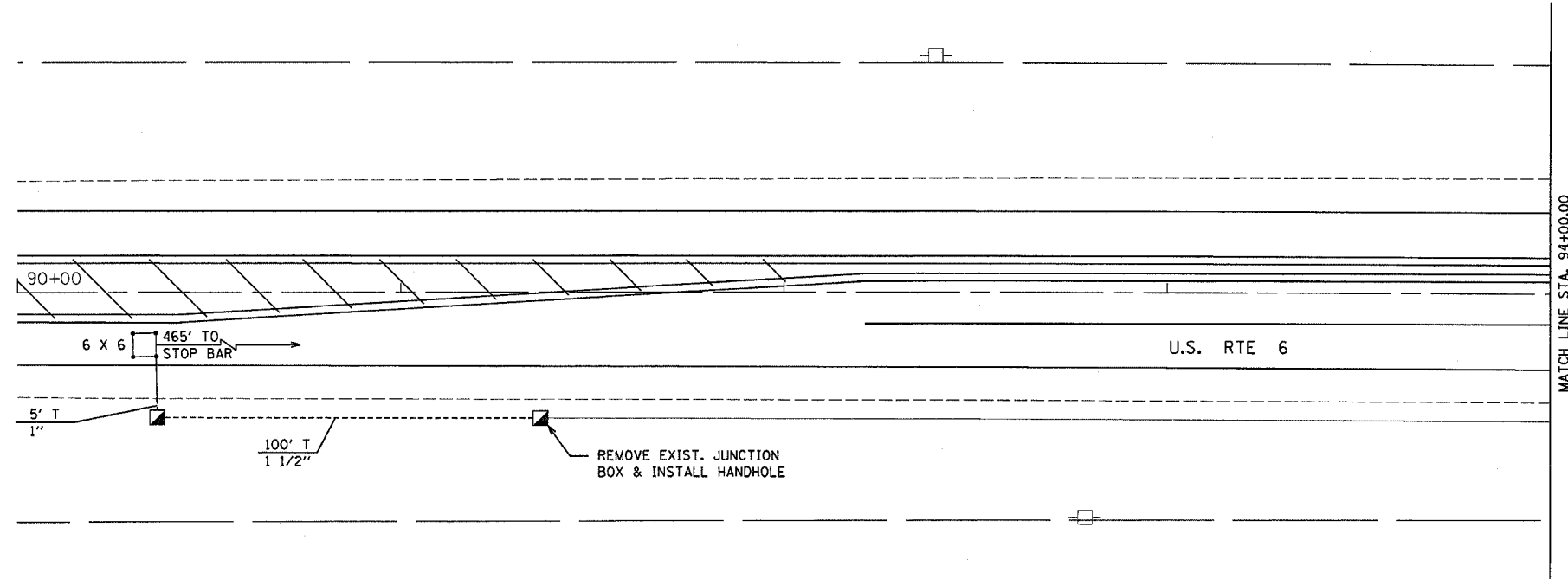

TRAFFIC SIGNALS LEGEND

EXISTING	PROPOSED	
		CONTROLLER CABINET
		CONDUIT
		SIGNAL HEAD WITH BACKPLATE
		STEEL MAST ARM
		TRAFFIC SIGNAL POST
		HANDHOLE

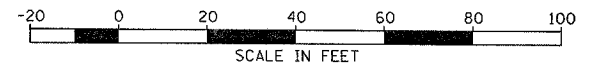
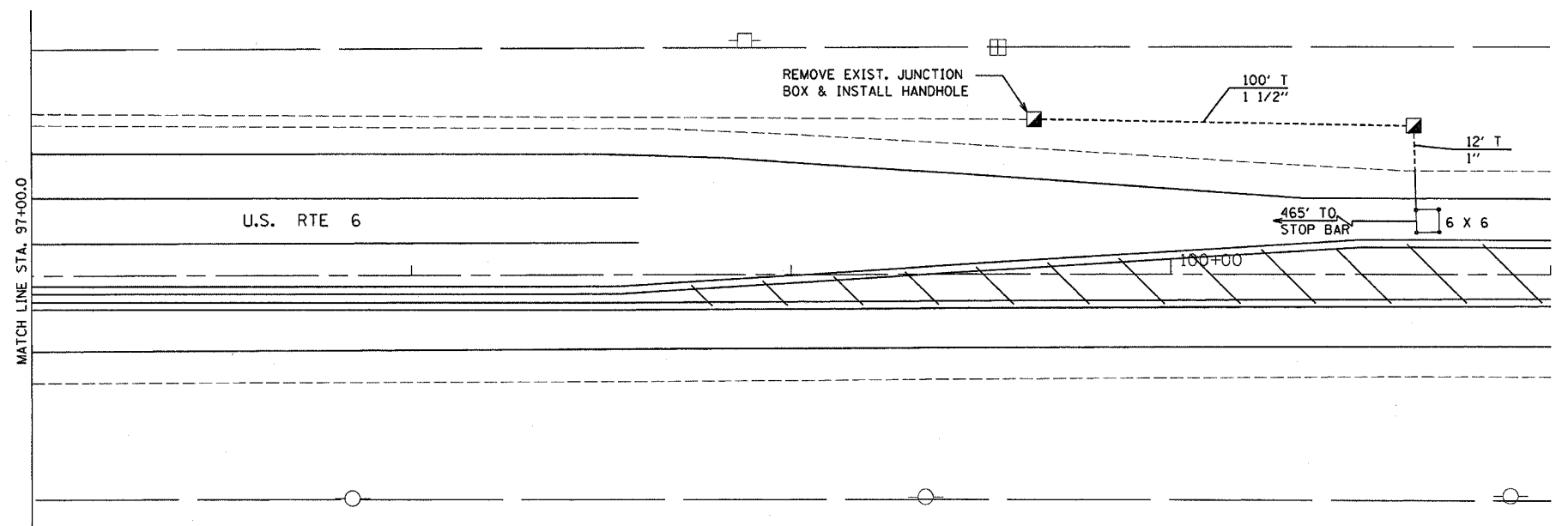

REVISIONS	
NAME	DATE

ILLINOIS DEPARTMENT OF TRANSPORTATION
TRAFFIC SIGNAL PLAN
 FAU 6088 (US RTE 6) AND
 DALZELL ROAD
 SECTION 17 N
 LASALLE & BUREAU COUNTY

SCALE: VERT. 1"=20'
 HORIZ. 1"=20'
 DATE 9/05

DRAWN BY ARR
 CHECKED BY MVF

12/13/2005
 c:\projects\ep01205\consult\tsplan.dgn

F.A.U. RTE.	SECTION	COUNTY	TOTAL SHEETS	SHEET NO.
		Lasalle/Bureau	18	15

FED. ROAD DIST. NO.	ILLINOIS	FED. AID PROJECT

- FAU 6088 (US RTE 6)
- 17 N

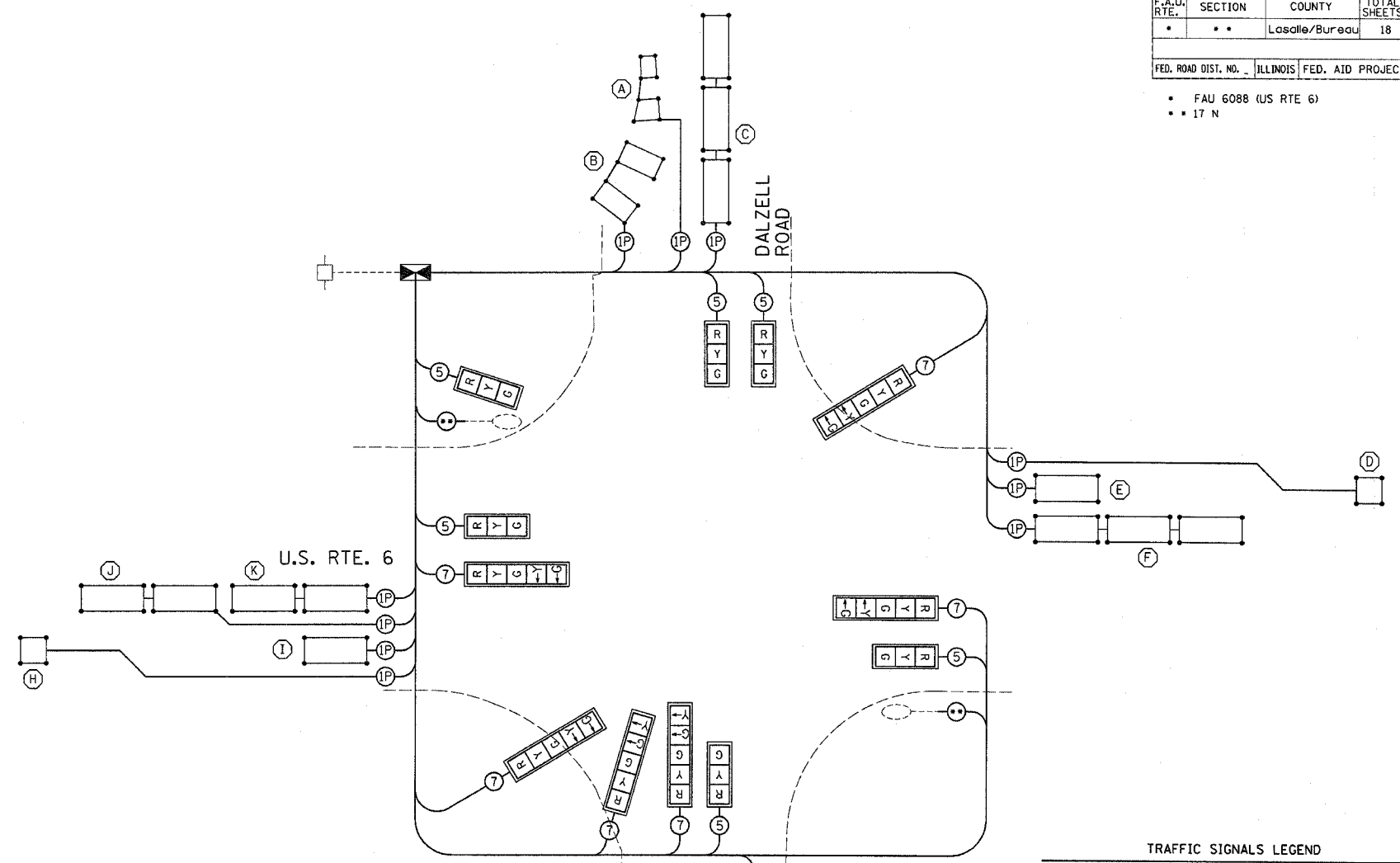
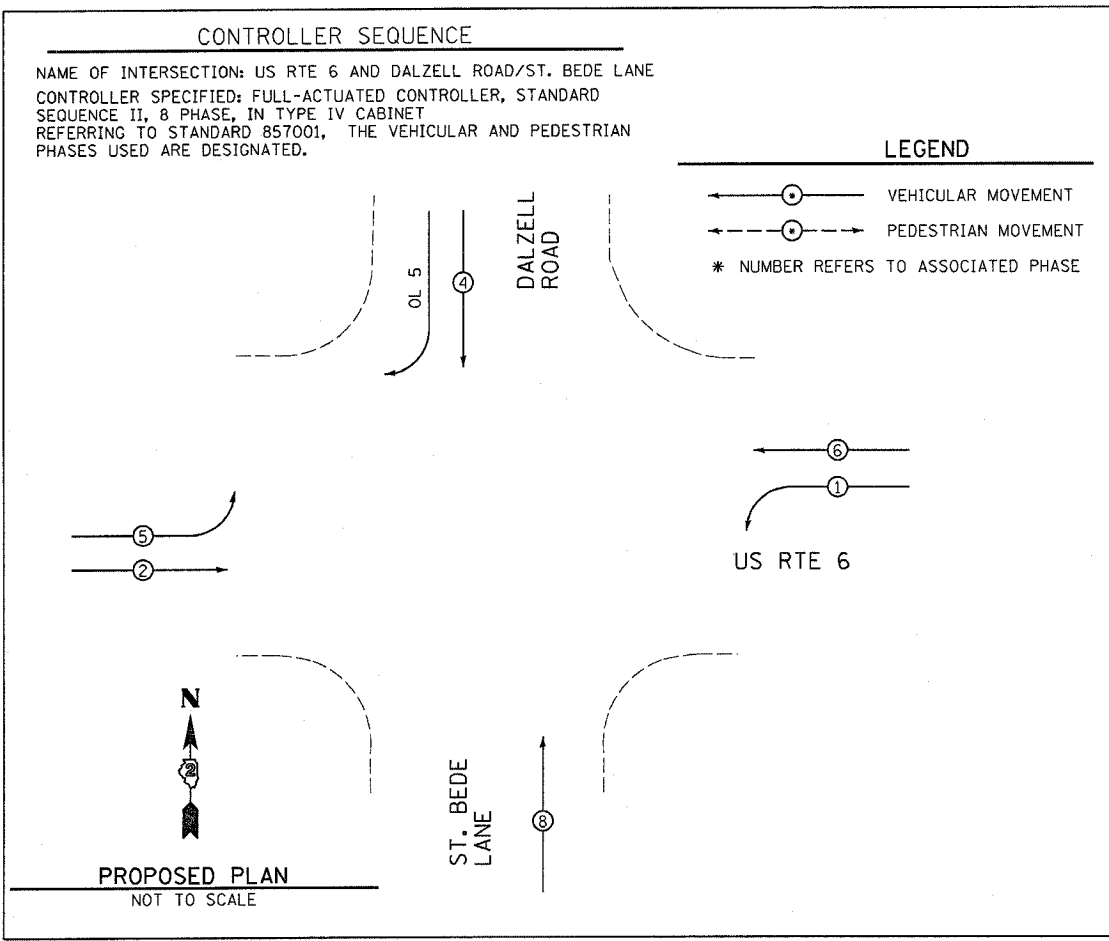

- #### TRAFFIC SIGNALS LEGEND
- DETNOTES NUMBER OF CONDUCTORS (NEW) ALL CABLE NO. 14 EXCEPT AS INDICATED
 - ⊕ DETNOTES NUMBER OF PAIR OF WIRE (NEW) ALL LOOP DETECTOR CABLE TO BE TWISTED, SHIELDED ALL CABLE NO. 14 EXCEPT AS INDICATED
 - EXISTING LUMINAIRE
 - ⊕ DETNOTES 3-1 CONDUCTORS, NO. 10 CABLE, 600V (XLP-TYPE USE)
 - DENOTES DETECTOR LOOP SYSTEM
 - ⊕ PROPOSED CONTROLLER CABINET
 - ⊕ LEFT TURN YELLOW
 - ⊕ LEFT TURN GREEN
 - ⊕ SIGNAL SECTION 12"
 - ⊕ VEHICLE DETECTOR, INDUCTION LOOP
 - ⊕ TRAFFIC SIGNAL BACKPLATE

STEP 1
 WIND ALL LOOPS CLOCKWISE. LABEL BEGINNING END OF CABLE A. LABEL ENDING END OF CABLE B. FOLLOW DETECTOR LOOP CABLE MANUFACTURER'S INSTRUCTIONS ON NUMBER OF TURNS FOR LOOP.

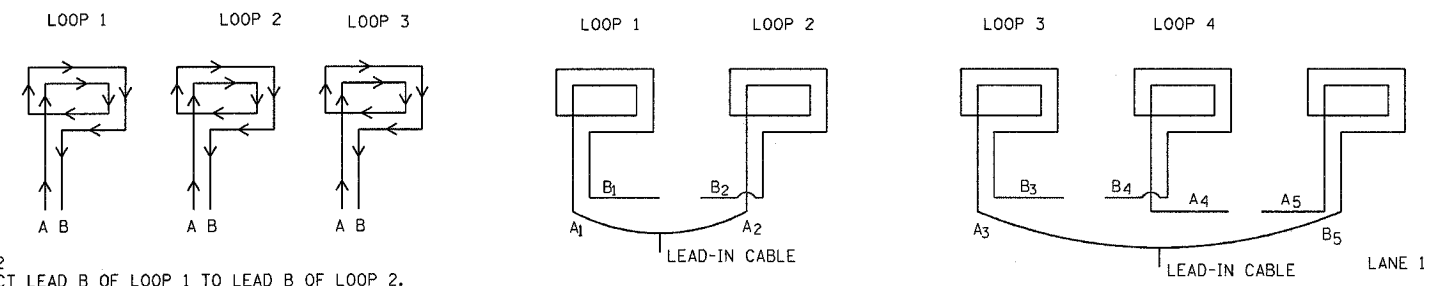

STEP 2
 CONNECT LEAD B OF LOOP 1 TO LEAD B OF LOOP 2.
 CONNECT LEAD A OF LOOP 2 TO LEAD A OF LOOP 3.

DETECTOR LOOP WINDING AND SERIES SPLICING DETAIL
 (SEE DETECTOR LOOP INDUCTANCE CHART FOR NUMBER OF TURNS)

REVISIONS	
NAME	DATE

ILLINOIS DEPARTMENT OF TRANSPORTATION
CABLE PLAN
 FAU 6088 (US RTE 6) AND
 DALZELL ROAD
 SECTION 17 N
 LASALLE & BUREAU COUNTY

SCALE: VERT. 1"=20'
 HORIZ. 1"=20'
 DATE 9/05

DRAWN BY ARR
 CHECKED BY MVF

12/13/2005 c:\projects\ep01205\consu\l\cable.dgn

F.A.U. RTE.	SECTION	COUNTY	TOTAL SHEETS	SHEET NO.
•	••	Lasalle/Bureau	18	16

FED. ROAD DIST. NO. ILLINOIS FED. AID PROJECT

- FAU 6088 (US RTE 6)
- • 17 N

DETECTOR LOOP INDUCTANCE CHART

DETECTOR LOOP SYSTEM	Ø	LOCATION	TURNS PER LOOP	INDUCTANCE READING (MICROHENRIES)	FREQUENCY (HERTZ)	J PIN STATUS
A	4	SBRT BK	5	350	32,623	ON
B	4	SBRT FR	5	531	26,486	ON
C	4	SB	4	803	21,538	ON
D	6	WB FAR	6	397	30,631	ON
E	6	WB STBR	4	308	34,777	OFF
F	1	WBLT	4	833	21,147	ON
G	8	NB	4	845	20,996	ON
H	2	EB FAR	6	406	30,290	ON
I	2	EB STBR	4	310	34,664	OFF
J	5	EBLT BK	4	476	27,974	ON
K	5	EBLT FR	4	467	28,243	ON

J PIN STATUS: "ON" MEANS STANDARD DETECTOR SETUP. "OFF" MEANS J WIRE HAS BEEN DISCONNECTED, BUT INTACT, AT THE HARNESS PANEL WITH THE NECESSARY SPADE CONNECTION ATTACHED, MARKED, AND INSULATED.

ELECTRICAL LOAD FOR INTERSECTION

STREET NAME	COMPONENT	NUMBER	WATTAGE EACH	BURNTIME %
US RTE 6	RED	7	10	53
	YELLOW	7	19	5
	GREEN	7	14	42
	YELLOW ARROW LT.	4	3,4	5
	GREEN ARROW LT.	4	3,4	17
DALZELL ROAD / ST. BEDE LANE	RED	5	10	69
	YELLOW	5	19	5
	GREEN	5	14	26
	YELLOW ARROW RT.	2	3,4	5
	GREEN ARROW RT.	2	3,4	68
TRAFFIC SIGNAL CABINET	CONTROLLER	1	6	100
	VEHICLE DETECTORS	11	4	100
	UPS	1	50	100
LIGHTING	LUMINAIRE	2	250	50

AGENCY RESPONSIBLE FOR TRAFFIC SIGNAL ENERGY CHARGES: ILLINOIS DEPARTMENT OF TRANSPORTATION

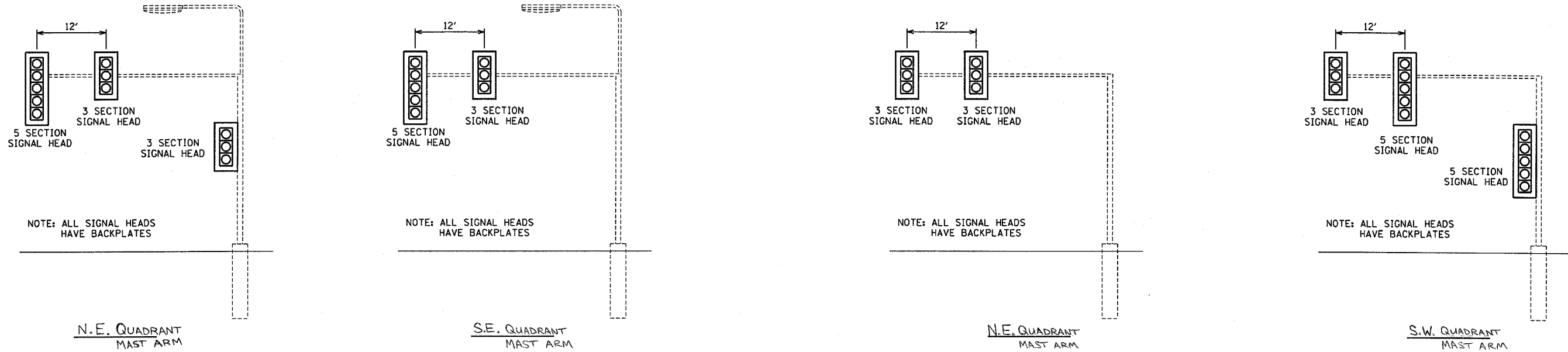

US RTE 6 / DALZELL ROAD/ST. BEDE LANE

12/13/2005 c:\projects\ep01205\consult\tsdet.dgn

REVISIONS	
NAME	DATE

ILLINOIS DEPARTMENT OF TRANSPORTATION
 TRAFFIC SIGNAL DETAILS
 FAU 6088 (US RTE 6) AND
 DALZELL ROAD
 SECTION 17 N
 LASALLE & BUREAU COUNTY
 SCALE: VERT. 1"=20'
 HORIZ. 1"=20'
 DATE 9/05
 DRAWN BY ARR
 CHECKED BY MVF

F.A.U. RTE.	SECTION	COUNTIES	TOTAL SHEETS	SHEET NO.
6088	17N	*	18	17
STA. _____		TO STA. _____		
FED. ROAD DIST. NO. - ILLINOIS FED. AID PROJECT				
* LASALLE & BUREAU				

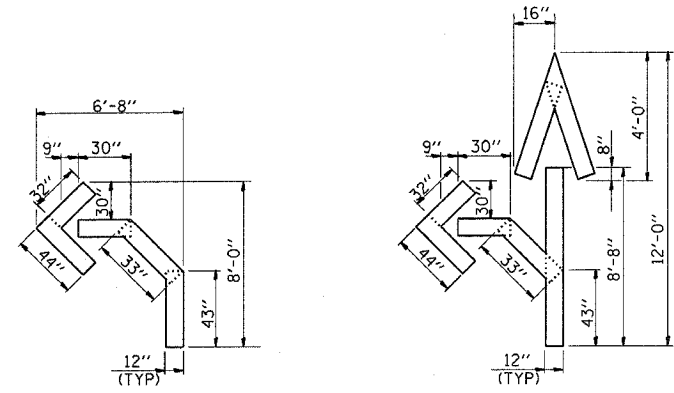

QUANTITY
12" LINE = 16 LIN. FT.
OR 4" LINE = 48 LIN. FT.

QUANTITY
12" LINE = 29 LIN. FT.
OR 4" LINE = 87 LIN. FT.

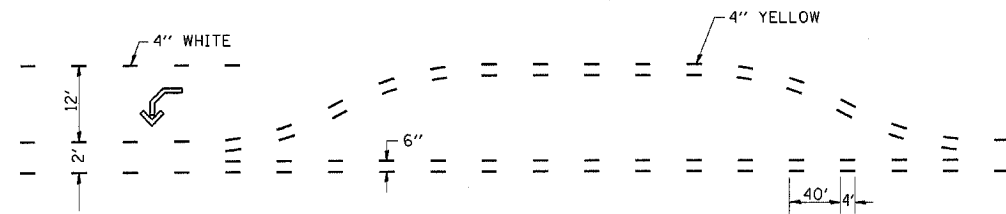

SHORT-TERM PAVEMENT MARKING FOR MEDIANS AND ARROWS

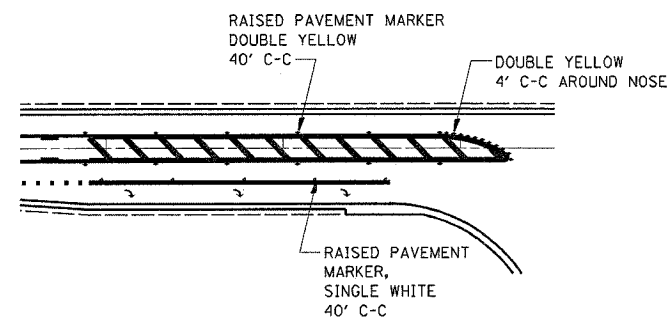

**RAISED REFLECTIVE PAVEMENT MARKERS
@ RIGHT TURN LANE**

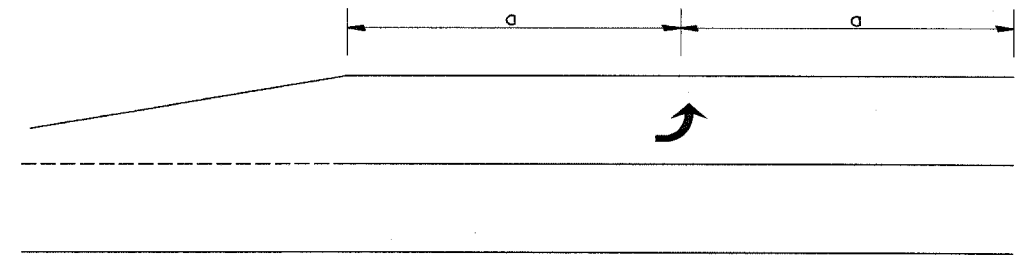

99' AND UNDER

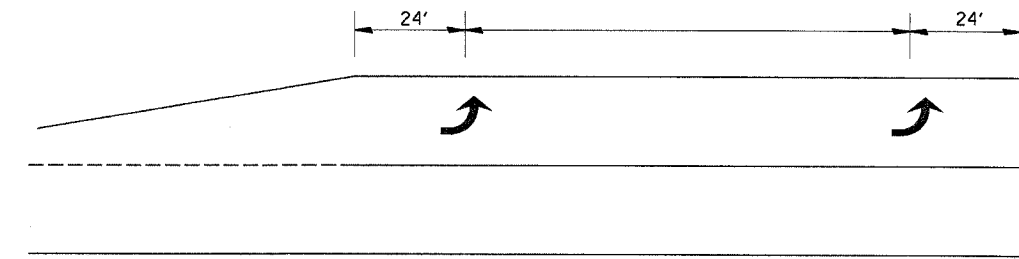

100' TO 149'

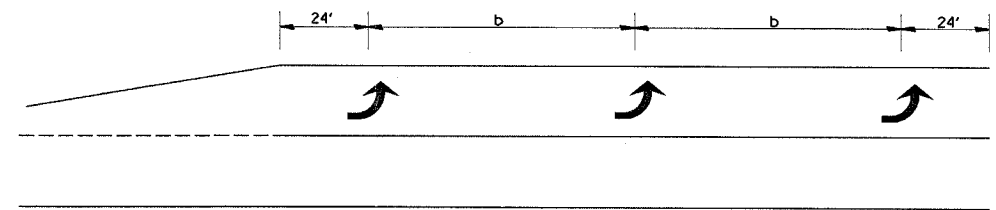

150' AND LONGER

**TYPICAL PLACEMENT OF ARROWS
IN TURN LANES**

F.A.U. RTE.	SECTION	COUNTIES	TOTAL SHEETS	SHEET NO.
6088	17N	•	18	18
STA. _____ TO STA. _____				
FED. ROAD DIST. NO. _____ ILLINOIS FED. AID PROJECT				

• LASALLE & BUREAU

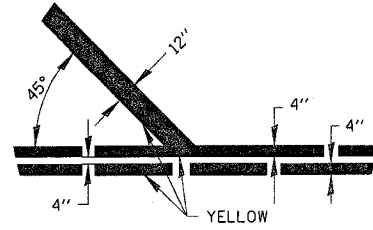

MEDIAN DIAGONALS

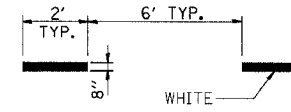

TURN LANE SKIP DASH

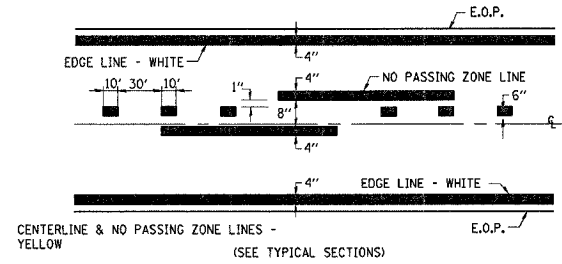

PAVEMENT MARKING

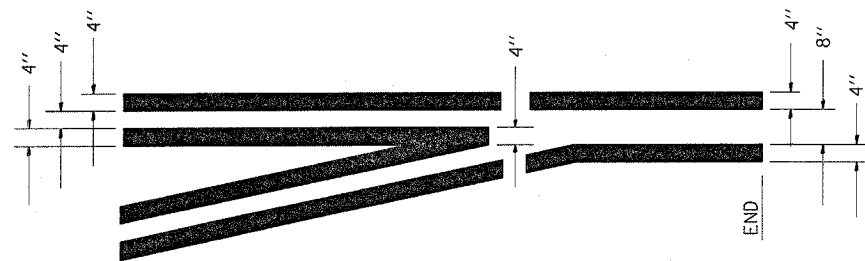

**TYPICAL APPLICATION
@ LEFT TURN LANES**

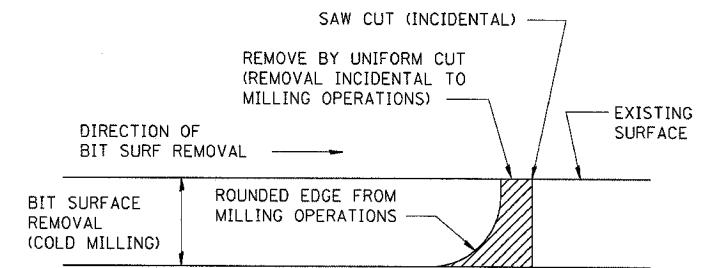

NOTE: WHEN MILLING OPERATIONS PRODUCE A ROUNDED EDGE, THEN A SAW CUT SHALL BE USED TO MANUFACTURE A PERPENDICULAR EDGE AS SHOWN IN THE DETAIL. THE ENGINEER SHALL BE THE SOLE JUDGE CONCERNING THE USE OF THIS DETAIL.

BITUMINOUS DETAIL AT BUTT JOINTS