

F.A. RTE.	SECTION	COUNTY	TOTAL SHEETS	SHEET NO.
VAR.	*	**	24	4

- D5 CRACK & JOINT SEAL 2006-1
- ** CHAMPAIGN, EDGAR & VERMILION

LOCATION MAP #3 IL 49, FROM KANSAS TO CHAMPAIGN COUNTY LINE

EDGAR COUNTY /RURAL 2-LANE

SECTION D5 CRACK & JOINT SEAL 2006-1
ENDS @ STATION 320+46.00

STATION EQUATION:
STATION 124+86.86 (BK.) =
STATION 125+00.00 (AH.)

STATION EQUATION:
STATION 873+45.00 (BK.) =
STATION 0+00.00 (AH.)

STATION EQUATION:
STATION 543+01.58 (BK.) =
STATION 543+01.65 (AH.)

STATION EQUATION:
STATION 58+75.66 (BK.) =
STATION 352+07.00 (AH.)

STATION EQUATION:
STATION 324+50.00 (BK.) =
STATION 31+19.00 (AH.)

STATION EQUATION:
STATION 248+84.56 (BK.) =
STATION 246+78.52 (AH.)

STATION EQUATION:
STATION 191+14.30 (BK.) =
STATION 191+11.74 (AH.)

SECTION D5 CRACK & JOINT SEAL 2006-1
BEGINS @ STATION 3+35.00

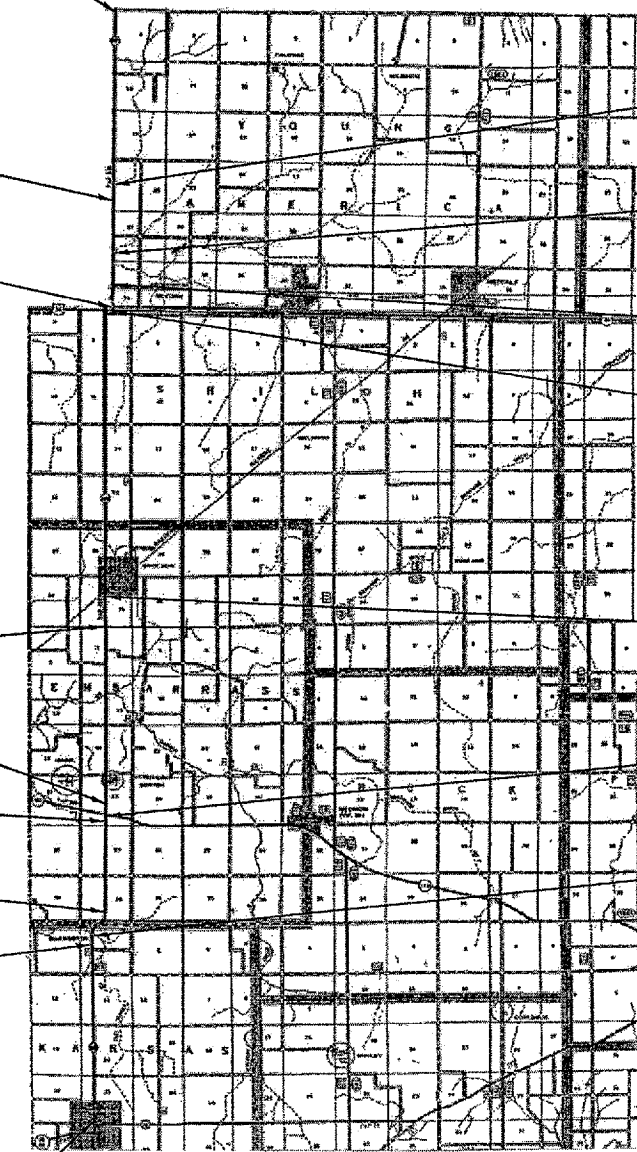

OMISSION FROM RESURFACING:
STATION 135+02.17 TO
STATION 135+75.83

BRIDGE OMISSION:
S. N. 023-0022
STATION 69+65.35 TO
STATION 69+94.66

RAILROAD OMISSION:
STATION 26+05.00 TO
STATION 26+14.00

OMISSION FROM RESURFACING:
STATION 868+80.00 TO
STATION 4+30.00

RAILROAD OMISSION:
STATION 575+86.95 TO
STATION 576+15.70

OMISSION FROM RESURFACING:
STATION 31+19.00 TO
STATION 58+75.66

BRIDGE OMISSION:
S. N. 023-0026
STATION 208+35.70 TO
STATION 209+44.05

TOTAL LENGTH OF SECTION = 119,251.05 FT. = 22.585 MILES
NET LENGTH OF SECTION = 115,350.32 FT. = 21.847 MILES

LOCATION MAP #4 F.A.I. 74, FROM WEST OF OGDEN TO U.S. 150

CHAMPAIGN & VERMILION COUNTIES /RURAL LANE, URBAN LANE

OMISSIONS FROM RESURFACING:
STATION 900+32.00 TO STATION 902+26.00
STATION 999+85.10 TO STATION 1001+79.10
STATION 1106+33.18 TO STATION 1108+27.18
STATION 1159+13.70 TO STATION 1161+07.70
STATION 1240+24.59 TO STATION 1242+18.59
STATION 1319+72.33 TO STATION 1321+66.33
STATION 1412+61.00 TO STATION 1414+67.00
STATION 1627+88.22 TO STATION 1632+12.11

SECTION D5 CRACK & JOINT SEAL 2006-1
BEGINS @ STATION 880+00.00

SECTION D5 CRACK & JOINT SEAL 2006-1
ENDS @ STATION 1720+00.00

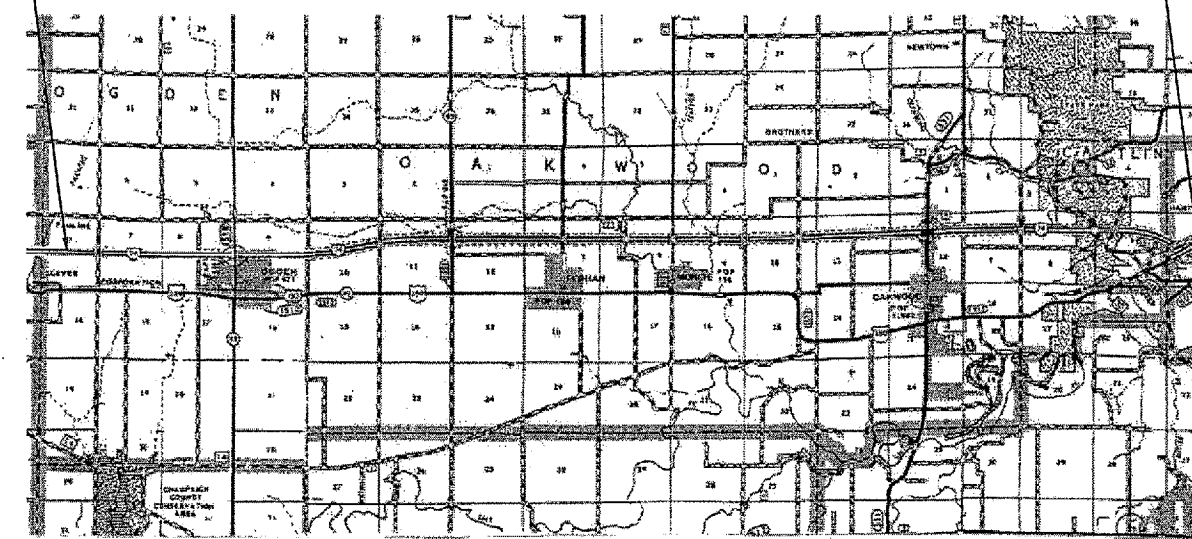

TOTAL LENGTH OF SECTION = 84,000.00 FT. = 15.909 MILES
NET LENGTH OF SECTION = 82,206.11 FT. = 15.569 MILES

REVISED
2-24-06

PLT DATE : 12/15/2005
PLT NAME : G:\projects\70492\70492.dgn
PLT SCALE : 40:2395 / IN.
USER NAME : piercenr

F.A. RTE.	SECTION	COUNTY	TOTAL SHEETS	SHEET NO.
VAR.	*	**	24	5

- D5 CRACK & JOINT SEAL 2006-1
- CHAMPAIGN, EDGAR & VERMILION

LOCATION MAP #5 F.A.I. 74, FROM HIGH CROSS ROAD TO EAST OF ST. JOSEPH

CHAMPAIGN COUNTY /RURAL  LANE, URBAN  LANE

OMISSIONS FROM RESURFACING:
 STATION 482+86.00 TO STATION 484+80.00
 STATION 536+00.00 TO STATION 537+94.00
 STATION 591+61.00 TO STATION 593+55.00
 STATION 644+83.00 TO STATION 646+77.00
 STATION 688+79.00 TO STATION 690+97.50
 STATION 738+19.75 TO STATION 740+24.25
 STATION 760+58.00 TO STATION 762+86.00
 STATION 831+34.00 TO STATION 833+29.00
 STATION 856+97.60 TO STATION 859+19.80

SECTION D5 CRACK & JOINT SEAL 2006-1
 BEGINS @ STATION 429+00.00

SECTION D5 CRACK & JOINT SEAL 2006-1
 ENDS @ STATION 880+00.00

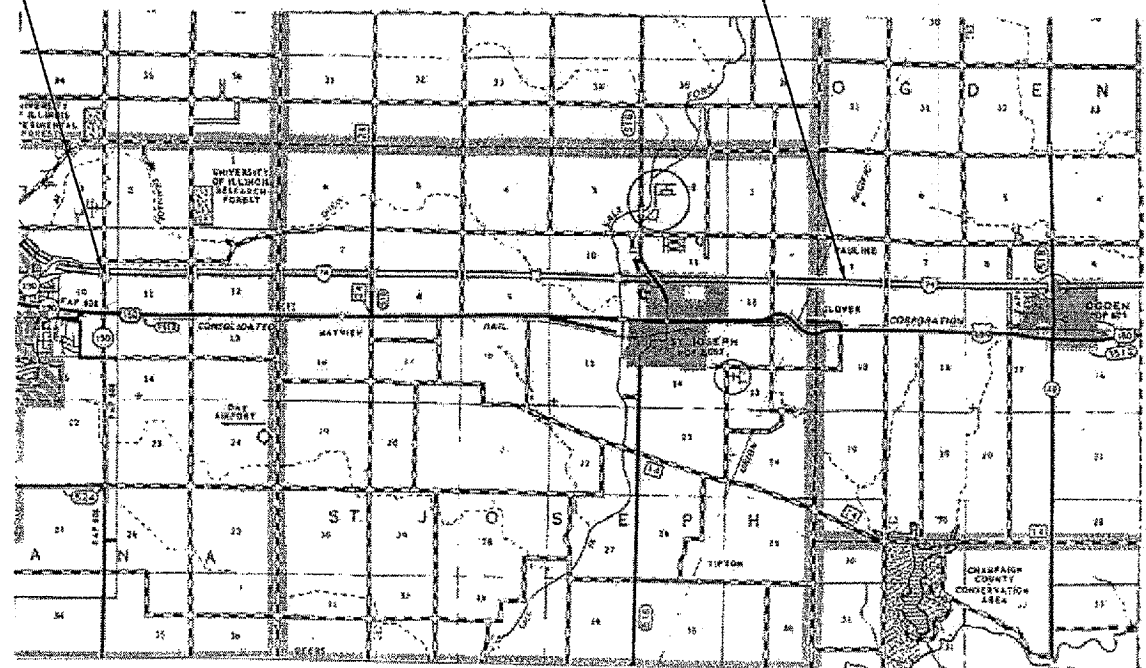

TOTAL LENGTH OF SECTION = 45,100.00 FT. = 8.542 MILES
 NET LENGTH OF SECTION = 43,255.80 FT. = 8.192 MILES

LOCATION MAP #6 F.A.I. 74, FROM U.S. 150 TO INDIANA STATE LINE

VERMILION COUNTY /URBAN  LANE

OMISSIONS FROM RESURFACING:
 STATION 1750+93.83 TO STATION 1758+43.50
 STATION 1875+57.43 TO STATION 1879+22.43
 STATION 1889+74.81 TO STATION 1902+59.98
 STATION 1989+14.75 TO STATION 1996+30.02
 STATION 2032+80.78 TO STATION 2034+52.28
 STATION 2035+94.00 TO STATION 2039+51.00
 STATION 2201+70.83 TO STATION 2205+41.83
 STATION 2212+42.15 TO STATION 2214+99.10

SECTION D5 CRACK & JOINT SEAL 2006-1
 BEGINS @ STATION 1720+00.00

SECTION D5 CRACK & JOINT SEAL 2006-1
 ENDS @ STATION 2231+13.24

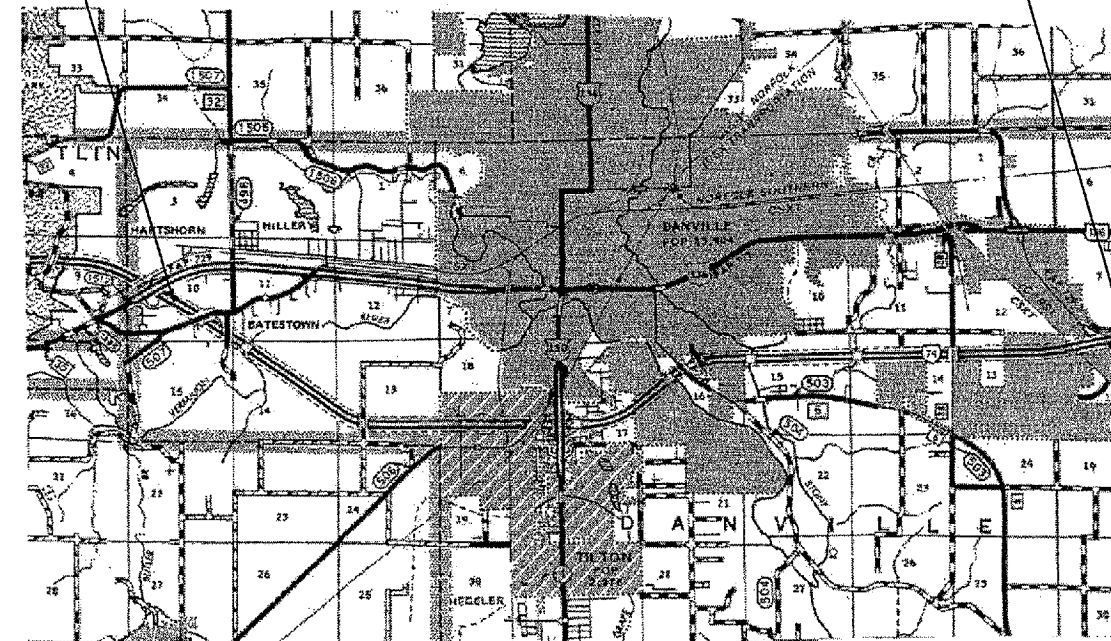

TOTAL LENGTH OF SECTION = 51,113.24 FT. = 9.681 MILES
 NET LENGTH OF SECTION = 46,841.68 FT. = 8.872 MILES

 **REVISED**
 2-24-06

