

F.A.U. RTE.	SECTION	COUNTY	TOTAL SHEETS	SHEET NO.
2582	03-00084-00-BT	COOK	29	9
STA. 27+00 TO STA. 33+00		FED. ROAD DIST. NO. 1 ILLINOIS FED. AID PROJECT		

CONTRACT NO. 83831

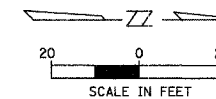

DESIGNED BY	DATE
CHECKED BY	
IN CHARGE	
NOTE BOOK NO.	
FILE NAME	

MATCHLINE STA. 27+00
SHEET NO. 8

MATCHLINE STA. 33+00
SEE SHEET NO. 10

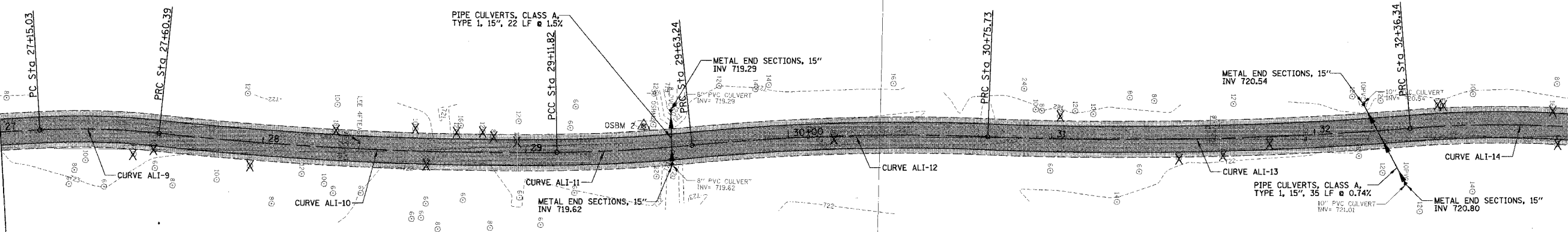

PROP. CURVE ALI-9
 PI STA. = 27+37.76
 $\Delta = 9^\circ 16' 54''$ (RT)
 $D = 20^\circ 27' 46''$
 $R = 280.00'$
 $T = 22.73'$
 $L = 45.36'$
 $E = 0.92'$
 P.C. STA = 27+15.03
 P.R.C. STA = 27+60.39

PROP. CURVE ALI-10
 PI STA. = 28+36.19
 $\Delta = 6^\circ 49' 54''$ (LT)
 $D = 4^\circ 30' 41''$
 $R = 1,270.00'$
 $T = 75.80'$
 $L = 151.43'$
 $E = 2.26'$
 P.R.C. STA = 27+60.39
 P.R.C. STA = 29+11.82

PROP. CURVE ALI-11
 PI STA. = 29+37.54
 $\Delta = 4^\circ 54' 38''$ (LT)
 $D = 9^\circ 32' 57''$
 $R = 600.00'$
 $T = 25.73'$
 $L = 51.42'$
 $E = 0.55'$
 P.R.C. STA = 29+11.82
 P.R.C. STA = 29+63.24

PROP. CURVE ALI-12
 PI STA. = 30+19.58
 $\Delta = 8^\circ 03' 23''$ (RT)
 $D = 7^\circ 09' 43''$
 $R = 800.00'$
 $T = 56.34'$
 $L = 112.49'$
 $E = 1.98'$
 P.R.C. STA = 29+63.24
 P.R.C. STA = 30+75.73

PROP. CURVE ALI-13
 PI STA. = 31+56.13
 $\Delta = 6^\circ 48' 59''$ (LT)
 $D = 4^\circ 14' 39''$
 $R = 1,350.00'$
 $T = 80.40'$
 $L = 160.61'$
 $E = 2.39'$
 P.R.C. STA = 30+75.73
 P.R.C. STA = 32+36.34

PROP. CURVE ALI-14
 PI STA. = 32+67.76
 $\Delta = 8^\circ 33' 28''$ (RT)
 $D = 13^\circ 38' 31''$
 $R = 420.00'$
 $T = 31.42'$
 $L = 62.73'$
 $E = 1.17'$
 P.C.C. STA = 32+36.34
 P.C.C. STA = 32+99.07

- LEGEND:**
- X TREE REMOVAL
 - BITUMINOUS BIKE PATH
 - BITUMINOUS CONCRETE SURFACE COURSE, SUPERPAVE, MIX C, N50 (NON QC/QA), 3"
 - AGGREGATE BASE COURSE, TYPE B, 8"

DESIGNED BY	DATE
CHECKED BY	
IN CHARGE	
NOTE BOOK NO.	
FILE NAME	

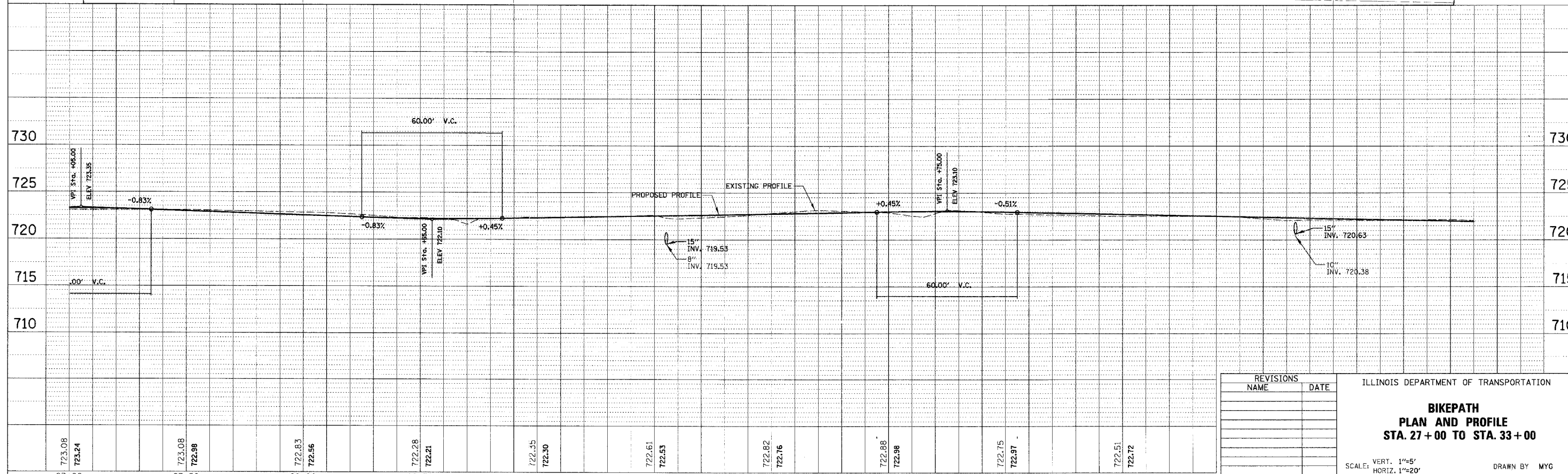

REVISIONS	
NAME	DATE

ILLINOIS DEPARTMENT OF TRANSPORTATION

**BIKEPATH
PLAN AND PROFILE
STA. 27+00 TO STA. 33+00**

SCALE: VERT. 1"=5'
 HORIZ. 1"=20'
 DATE 11/1/2005

DRAWN BY MYG
 CHECKED BY LMF