

FAU RTE	SECTION	COUNTY	TOTAL SHEETS	SHEET NO.
1447	03-00159-00-RS	COOK	24	1
F. HW. A. REG.	ILLINOIS	PROJECT STPM-8003(581)		

CONTRACT NO. 83835

STATE OF ILLINOIS DEPARTMENT OF TRANSPORTATION DIVISION OF HIGHWAYS PLANS FOR PROPOSED FEDERAL AID URBAN PROJECT

F.A.U. RTE. 1447 (16TH STREET)
FROM HARLEM AVENUE (F.A.P. 348) TO
LOMBARD AVENUE (F.A.U. 3794)
FEDERAL PROJECT M-8003(581)
SECTION NO. 03-00159-00-RS
CITY OF BERWYN
COOK COUNTY
JOB NO. C-91-124-06



16TH STREET ADT = 14,000
POSTED SPEED LIMIT = 25 MPH
DESIGN SPEED LIMIT = 30 MPH

- INDEX TO SHEETS**
- 1) COVER SHEET, INDEX TO SHEETS, LOCATION MAP, INDEX OF STATE STANDARDS
 - 2) CONSTRUCTION NOTES, M.W.R.D. NOTES, PROJECT NOTES
 - 3) SUMMARY OF QUANTITIES
 - 4) TYPICAL CROSS SECTIONS, COMPOSITE PAVEMENT DESIGN, BITUMINOUS MIX REQUIREMENT
 - 5-9) PAVING PLAN (16th STREET)
 - 10-14) DRAINAGE PLAN (16th STREET)
 - 15) EMERGENCY VEHICLE DETECTION SYSTEM
 - 16) EMERGENCY VEHICLE TRAFFIC CONTROL SIGNALS
 - 17-18) STRIPING PLAN
 - 19) CONSTRUCTION STANDARDS
 - 20) DISTRICT 1-TYPICAL PAVEMENT MARKINGS
 - 21) DISTRICT 1-TEMPORARY PAVEMENT MARKING LETTERS AND SYMBOLS
 - 22) DISTRICT 1-TRAFFIC CONTROL AND PROTECTION FOR SIDEROADS, INTERSECTIONS, AND DRIVEWAYS
 - 23) DISTRICT 1-FRAMES AND LIDS ADJUSTMENTS WITH MILLING
 - 24) DISTRICT 1-BUTT JOINT AND BITUMINOUS TAPER DETAILS

STATE STANDARDS

00001-04	STANDARD SYMBOLS, ABBREVIATIONS AND PATTERNS
42401-04	CURB RAMP FOR SIDEWALKS
60601-02	CONCRETE CURB AND COMBINATION CONCRETE CURB & GUTTER
701301-02	LANE CLOSURE, 2L, 2W, SHORT TIME OPERATIONS
701311-02	LANE CLOSURE, 2L, 2W, MOVING OPERATIONS - DAY ONLY
701501-03	URBAN LANE CLOSURE, 2L, 2W, UNDIVIDED
701606-04	URBAN LANE CLOSURE, MULTILANE 2W WITH MOUNTABLE MEDIAN
701701-04	URBAN LANE CLOSURE, MULTILANE INTERSECTION
701801-03	LANE CLOSURE, MULTILANE 1W OR 2W CROSSWALK OR SIDEWALK CLOSURE
702001-05	TRAFFIC CONTROL DEVICES
780001-01	TYPICAL PAVEMENT MARKINGS
781001-02	TYPICAL APPLICATIONS RAISED REFLECTIVE PAVEMENT MARKERS
886001	DETECTOR LOOP INSTALLATIONS
886006	TYPICAL LAYOUTS FOR DETECTOR LOOPS

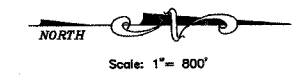

PROJECT BEGINS
STA. 0+19

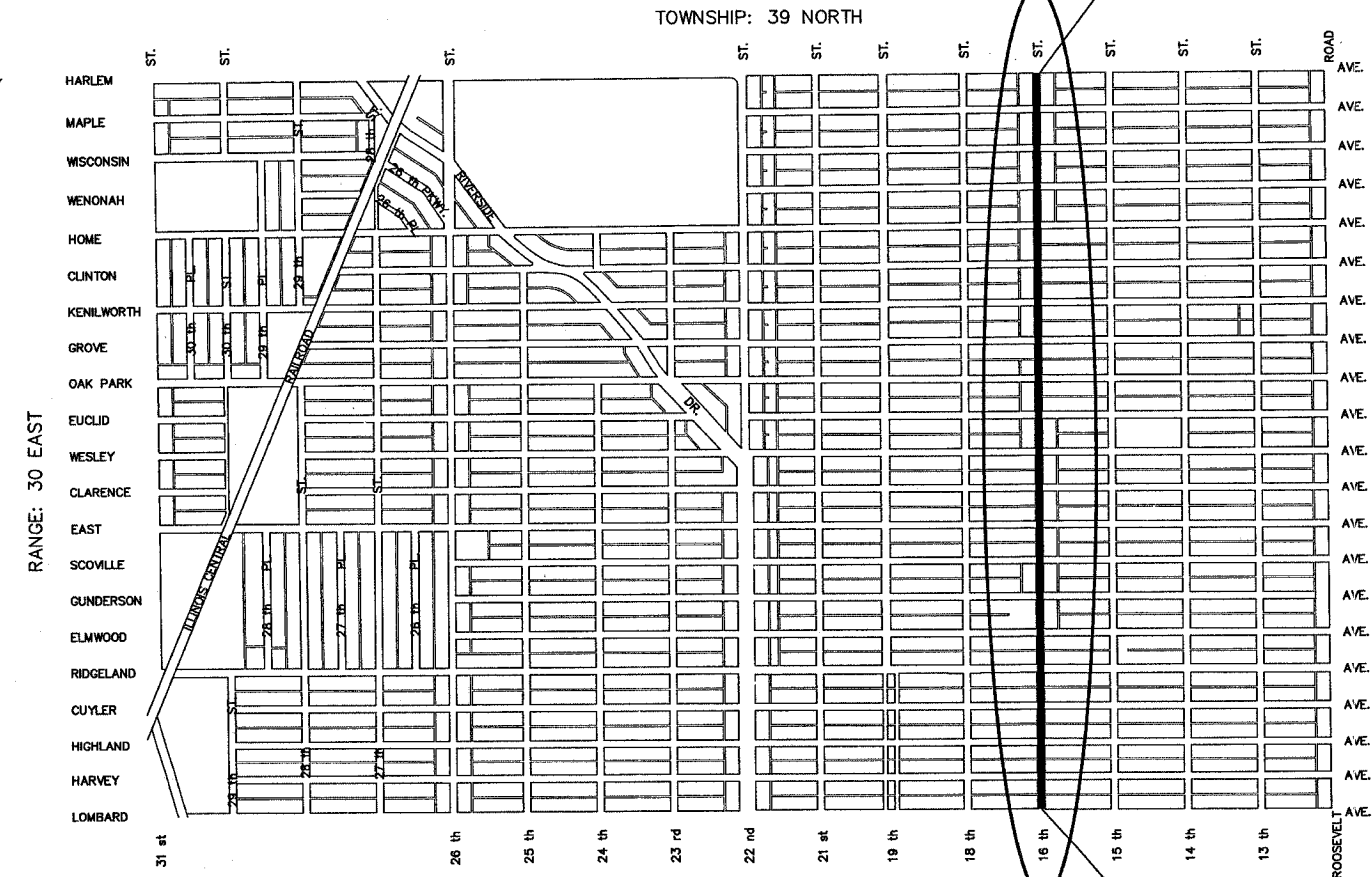

LOCATION MAP

PROJECT ENDS
STA. 68+47

DENOTES PROJECT LOCATION

LENGTH OF PROJECT
GROSS LENGTH = 6,828 FT. (1.293 miles)
NET LENGTH = 6,828 FT. (1.293 miles)

PROJECT LOCATED IN THE
CITY OF BERWYN

CONTRACT NO. 83835

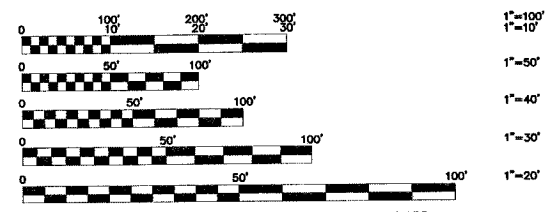

FULL SIZE PLANS HAVE BEEN PREPARED USING STANDARD ENGINEERING SCALES. REDUCED SIZED PLANS WILL NOT CONFORM TO STANDARD SCALES. IN MAKING MEASUREMENTS ON REDUCED PLANS, THE ABOVE SCALES MAY BE USED.

FEDERAL-AID DESIGN ENGINEER: ABIGAIL BRINKS (847)705-4233
CONSULTANT: FRANK NOVOTNY AND ASSOCIATES, INC. (630)887-8640

REVISIONS				
NO.	BY	DATE	DESCRIPTION	
1	THK	11/30/05	PER IDOT DIST. 1 B.L.R. COMMENTS	
2	THK	12/14/05	PER IDOT DIST. 1 B.L.R. COMMENTS	
3	THK	12/16/05	PER IDOT DIST. 1 B.L.R. COMMENTS	

STATE OF ILLINOIS
DEPARTMENT OF TRANSPORTATION

APPROVED 12/16 2005
Michael Kloman Mayor LOCAL AGENCY OFFICIAL

PASSED DECEMBER 29 2005
[Signature] ENGINEER OF LOCAL ROADS & STREETS

APPROVED Jan. 12 2006
Diane M. O'Keefe DEPUTY DIRECTOR OF HIGHWAYS, REGION ENGINEER

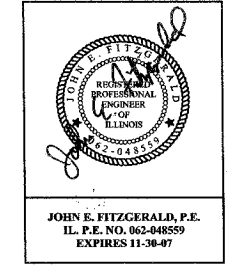
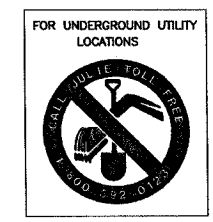

PRINTED BY THE AUTHORITY
OF THE STATE OF ILLINOIS

FNA JOB # 02260