

SCHEDULE OF STRUCTURES

FAU RTE	SECTION	COUNTY	TOTAL SHEETS	SHEET NO.
1447	03-00159-00-RS	COOK	24	12
F. HW. A. REC.	ILLINOIS	PROJECT STPM-8003(581)	CONTRACT NO. 83835	

- | | | | | | | |
|---|---|--|--|---|---|--|
| <p>81. STA. 31+29, 18.5' R INLET, TYPE A (SPECIAL) PROP. INVERT = 614.59 PROP. RIM = 616.85</p> <p>82. STA. 31+33, 26' R CATCH BASIN TO BE RECONSTRUCTED PROP. RIM = 617.40</p> <p>83. STA. 31+35, 18.5' L CATCH BASIN TO BE ADJUSTED PROP. RIM = 616.85</p> <p>84. STA. 31+45, 16' L VALVE VAULT TO BE ADJUSTED, SPECIAL PROP. RIM = 617.00</p> <p>85. STA. 31+58, 29' L VALVE VAULT TO BE ADJUSTED, SPECIAL PROP. RIM = 616.95</p> <p>86. STA. 31+57, 44.5' L CATCH BASIN TO BE ADJUSTED PROP. RIM = 616.70</p> <p>87. STA. 31+72, 39' L MANHOLE TO BE ADJUSTED, SPECIAL PROP. RIM = 616.90</p> | <p>88. STA. 31+82, 44.5' L CATCH BASIN TO BE ADJUSTED PROP. RIM = 616.70</p> <p>89. STA. 32+26, 24.5' L MANHOLE TO BE ADJUSTED PROP. RIM = 617.35</p> <p>90. STA. 32+09, 18.5' R INLET, TYPE A (SPECIAL) PROP. INVERT = 614.59 PROP. RIM = 616.85</p> <p>91. STA. 32+10, 18.5' L CATCH BASIN TO BE ADJUSTED PROP. RIM = 616.70</p> <p>92. STA. 32+13, 25' R CATCH BASIN TO BE ADJUSTED PROP. RIM = 616.80</p> <p>93. STA. 33+67, 24' L MANHOLE TO BE ADJUSTED PROP. RIM = 617.35</p> <p>94. STA. 34+65, 18.5' L CATCH BASIN TO BE ADJUSTED PROP. RIM = 616.50</p> <p>95. STA. 34+73, 18.5' L VALVE VAULT TO BE RECONSTRUCTED PROP. RIM = 616.20</p> | <p>96. STA. 34+95, 35' L VALVE VAULT TO BE RECONSTRUCTED PROP. RIM =</p> <p>97. STA. 35+03, 27' L MANHOLE TO BE ADJUSTED, SPECIAL PROP. RIM = 616.90</p> <p>98. STA. 34+65, 25' R CATCH BASIN TO BE ADJUSTED PROP. RIM = 617.10</p> <p>99. STA. 34+64, 18.5' R INLET, TYPE A (SPECIAL) PROP. INVERT = 614.90 PROP. RIM = 616.50</p> <p>100. STA. 34+79, 38' R VALVE VAULT TO BE ADJUSTED PROP. RIM = 617.50</p> <p>101. STA. 34+91, 32' R VALVE VAULT TO BE ADJUSTED, SPECIAL PROP. RIM = 617.00</p> <p>102. STA. 35+41, 25' R CATCH BASIN TO BE ADJUSTED PROP. RIM = 617.10</p> <p>103. STA. 35+40, 20' R INLET TO BE ADJUSTED PROP. RIM = 616.50</p> | <p>104. STA. 35+49, 19' L CATCH BASIN TO BE ADJUSTED PROP. RIM = 616.50</p> <p>105. STA. 36+13, 11' L VALVE VAULT TO BE RECONSTRUCTED PROP. RIM = 616.90</p> <p>106. STA. 36+21, 24' L MANHOLE TO BE ADJUSTED PROP. RIM = 617.35</p> <p>107. STA. 36+55, 18' L MANHOLE TO BE ADJUSTED, SPECIAL PROP. RIM = 617.20</p> <p>108. STA. 37+95, 18.5' L CATCH BASIN TO BE ADJUSTED PROP. FRAME AND GRATE (SPECIAL) PROP. RIM = 616.65</p> <p>109. STA. 38+02, 18' L MANHOLE, TYPE A, 4' DIA., TYPE 1 FRAME AND CLOSED LID PROP. INVERT (W-E) = 610.43 PROP. INVERT (SW) = 611.58 PROP. INVERT (NW) = 612.88 PROP. RIM = 616.68</p> | <p>110. STA. 38+26, 32.5' L VALVE VAULT TO BE ADJUSTED, SPECIAL PROP. RIM = 616.80</p> <p>111. STA. 37+91, 18.5' R CATCH BASIN TO BE RECONSTRUCTED PROP. FRAME AND GRATE (SPECIAL) PROP. RIM = 616.65</p> <p>112. STA. 38+26, 31.5' R VALVE VAULT TO BE ADJUSTED, SPECIAL PROP. RIM = 617.10</p> <p>113. STA. 38+60, 9' L MANHOLE, TYPE A, 4' DIA., TYPE 1 FRAME AND CLOSED LID PROP. INVERT (SE) = 613.32 PROP. INVERT (NE) = 613.04 PROP. INVERT (NW) = 613.40 PROP. INVERT (W-E) = 612.78 PROP. RIM = 617.00</p> <p>114. STA. 38+85, 18.5' L CATCH BASIN TO BE ADJUSTED PROP. RIM = 616.50</p> | <p>115. STA. 38+72, 18.5' R INLET, TYPE A (SPECIAL) PROP. INVERT = 614.50 PROP. RIM = 616.50</p> <p>116. STA. 38+74, 24.5' R CATCH BASIN TO BE ADJUSTED PROP. RIM = 617.10</p> <p>117. STA. 39+67, 15' L VALVE VAULT TO BE RECONSTRUCTED PROP. RIM = 617.10</p> <p>118. STA. 40+02, 9' L MANHOLE TO BE RECONSTRUCTED PROP. RIM = 617.35</p> <p>119. STA. 41+31, 11' L VALVE VAULT TO BE RECONSTRUCTED PROP. RIM = 617.60</p> <p>120. STA. 41+63, 33' L VALVE VAULT TO BE RECONSTRUCTED PROP. RIM = 617.30</p> <p>121. STA. 41+53, 62' L CATCH BASIN TO BE ADJUSTED PROP. RIM = 616.94</p> | <p>122. STA. 41+63, 32' R VALVE VAULT TO BE RECONSTRUCTED PROP. RIM = 617.75</p> <p>123. STA. 41+72, 29' L MANHOLE TO BE RECONSTRUCTED PROP. RIM = 617.30</p> <p>124. STA. 41+87, 42' L CATCH BASIN TO BE ADJUSTED PROP. RIM = 616.82</p> <p>125. STA. 43+37, 12' L MANHOLE TO BE RECONSTRUCTED PROP. RIM = 617.35</p> |
|---|---|--|--|---|---|--|

ALL BUFFALO BOXES ON THIS PROJECT LOCATED BETWEEN THE CURB AND THE SIDEWALK ARE TO BE ADJUSTED TO GRADE. BROKEN OR OTHERWISE UNUSABLE BUFFALO BOXES SHALL BE REPAIRED AND BE PAID FOR AS DOMESTIC WATER SERVICE BOXES TO BE ADJUSTED, SPECIAL.

IMPORTANT!
FULL SIZE PLANS HAVE BEEN PREPARED USING STANDARD ENGINEERING SCALES. REDUCED SIZED PLANS WILL NOT CONFORM TO STANDARD SCALES INDICATED IN TITLE BLOCK.

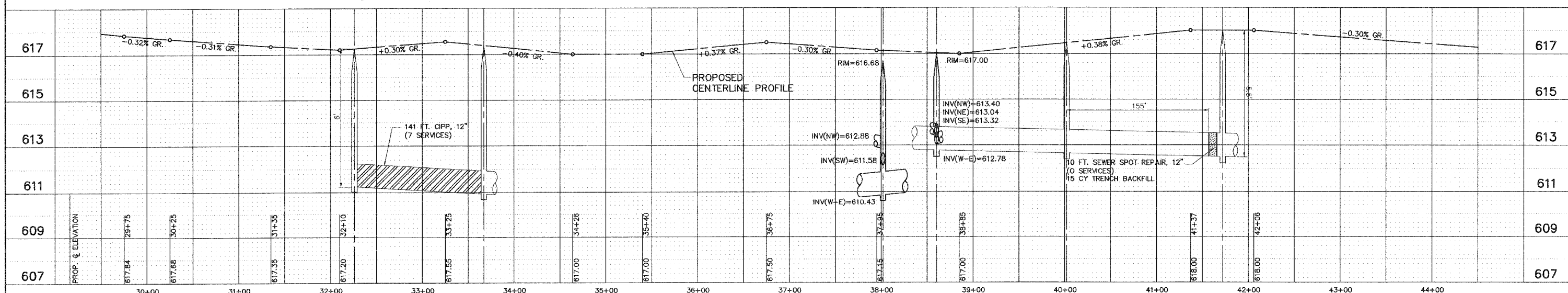
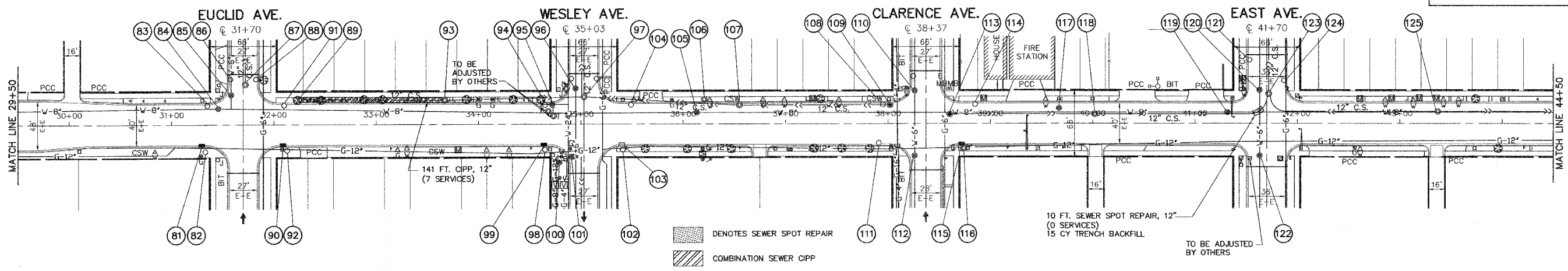

Frank Novotny & Associates, Inc.
 Civil Engineers/Municipal Consultants
 825 Midway Drive • Willowbrook, IL • 60527 • Telephone: (630) 887-8640 • Fax: (630) 887-0132
 Illinois Professional Design Firm No. 184-000928

PROJECT: CITY OF BERWYN, ILLINOIS
 16TH STREET RESURFACING
 SECTION NO. 03-000159-00-RS

REVISIONS		
NO.	BY	DATE
1	THK	11/30/05
2	THK	12/14/05
3	THK	12/16/05

DRAINAGE PLAN
 16TH STREET
 STA. 29+50 TO STA. 44+50

PROJECT NO. 02260	SCALE H:1"=50'; V:1"=1'	SHEET 12
DRAWN/DESIGNED JEP-RAW/THK	DATE OCT., 2005	OF 24
CHECKED/APPROVED JEF	FIELD BOOK NO. FILE	SHEETS

M:\Berwyn\2002\02260 - 16th St - L.A.P\02260_SHT_05-09_PavePlan-10-14_DrainPlan-17-18_18_Striping.dwg, 12/30/2005 11:03:37 PM