

STATE OF ILLINOIS
DEPARTMENT OF TRANSPORTATION
**PLANS FOR
PROPOSED LOCAL AGENCY IMPROVEMENT
FEDERAL-AID BRRP PROJECT**

SUMMARY OF QUANTITIES
CONSTRUCTION TYPE CODE: X081-2A

INDEX OF SHEETS

- 1 COVER SHEET
- 2-5 GENERAL NOTES AND SCHEDULES
- 6 TYPICAL SECTIONS
- 7-9 STORM WATER POLLUTION PREVENTION PLAN
- 10-12 ROCKYFORD PLAN AND PROFILE SHEETS
- 13 RIVER VIEW PLAN AND PROFILE SHEET
- 14 NEWMAN ROAD PLAN AND PROFILE SHEET
- 15 GENERAL PLAN AND ELEVATION
- 16 TOP OF SLAB ELEVATIONS
- 17 SUPERSTRUCTURE
- 18 SUPERSTRUCTURE DETAILS @ SOUTH ABUTMENT
- 19 SUPERSTRUCTURE DETAILS @ NORTH ABUTMENT
- 20 FRAMING PLAN
- 21 PRECAST PRESTRESSED CONCRETE BULB T-BEAM, 63" DETAILS
- 22 TYPE I ELASOMERIC BEARING DETAILS
- 23 STEEL BRIDGE RAIL, TYPE SM
- 24 SOUTH ABUTMENT
- 25 SOUTH ABUTMENT DETAILS
- 26 NORTH ABUTMENT
- 27 NORTH ABUTMENT DETAILS
- 28 ANCHOR BOLT DETAILS
- 29 BAR SPLICER ASSEMBLY DETAILS
- 30-46 ROCKYFORD ROAD CROSS SECTIONS
- 47 RIVER VIEW ROAD CROSS SECTIONS
- 48-49 NEWMAN ROAD CROSS SECTIONS
- 50-51 STANDARD 93.1 ET-2000 TERMINAL

STANDARDS

- 000001-4 STANDARD SYMBOLS, ABBREVIATIONS, AND PATTERNS
- 280001-02 TEMPORARY EROSION CONTROL SYSTEMS
- 406201 MAILBOX TURNOUT
- 420401-05 BRIDGE APPROACH PAVEMENT
- 515001-02 NAME PLATE FOR BRIDGES
- 542301 PRECAST REINFORCED CONCRETE FLARED END SECTION
- 542306 PRECAST REINFORCED CONCRETE ELLIPTICAL FLARED END SECTION
- 630001-05 STEEL PLATE BEAM GUARD RAIL
- 630301-03 SHOULDER WIDENING FOR TYPE 1(SPECIAL) GUARDRAIL TERMINALS
- 631032-01 TRAFFIC BARRIER TERMINAL TYPE 6A
- 635006-02 REFLECTOR AND TERMINAL MARKER PLACEMENT
- 635011-01 REFLECTOR MARKER AND MOUNTING DETAILS
- 666001 RIGHT OF WAY MARKERS
- 701001-01 OFF-ROAD OPERATIONS, 2L 2W, 4.5 m (15') MIN. AWAY, FOR SPEEDS > 45 MPH
- 701006-02 OFF-ROAD OPERATIONS, 2L 2W, 4.5 m (15') TO 600 m (24') AWAY FOR SPEEDS > 45 MPH
- 701301-02 LANE CLOSURE, 2L 2W, SHORT TIME OPERATIONS
- 701306-01 LANE CLOSURE, 2L 2W, SLOW MOVING DAY ONLY OPERATIONS, FOR SPEEDS > 45 MPH
- 701311-02 LANE CLOSURE, 2L 2W, MOVING DAY ONLY OPERATIONS
- 702601-05 TRAFFIC CONTROL DEVICES
- 780001-01 TYPICAL PAVEMENT MARKINGS
- BLR 21-6 TYPICAL APPLICATION OF TRAFFIC CONTROL DEVICES FOR CONSTRUCTION ON RURAL LOCAL HIGHWAYS
- BLR 22-4 TYPICAL APPLICATION OF TRAFFIC CONTROL DEVICES FOR CONSTRUCTION ON RURAL LOCAL HIGHWAYS

NAME AND ADDRESS OF UTILITIES	TYPE
COMED 919 West First Street Dixon, IL 61021 (815) 284-5857	ELECTRIC
NICOR GAS 4651 Linden Road Rockford, IL 61109 (815) 965-5416	GAS
VERIZON 112 West Elm Sycamore, IL 60178 (815) 895-1115	TELEPHONE
INSIGHT COMMUNICATIONS 115 Galena Avenue Dixon, IL 61021 (815) 284-3389	CABLE

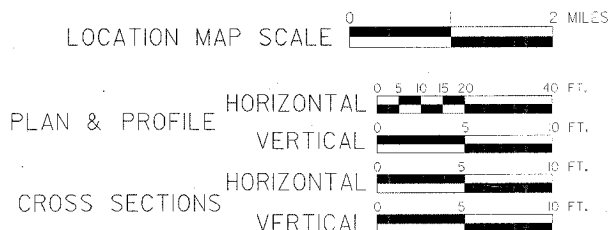

**BRIDGE REPLACEMENT &
REHABILITATION PROGRAM**

**C.H. 33, FAS 1184
SECTION 01-00282-00-BR
ROCKYFORD ROAD
LEE COUNTY
PROJECT BR-OS-103(135)
JOB NO. C-92-067-05
CONTRACT NO. 85369
2005**

NET LENGTH 3,681.00 FEET = 0.697 MILES

NEWMAN ROAD
ENDS AT STA. 199+88.12

NEWMAN ROAD
BEGINS AT STA. 196+89.24

RIVER VIEW ROAD
BEGINS AT STA. 99+65.79

RIVER VIEW ROAD
ENDS AT STA. 101+69.91

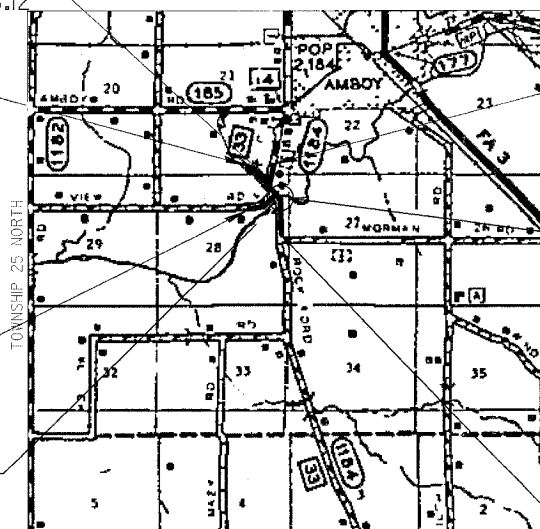

LOCATION MAP

CODE NO.	ITEM	UNIT	QUANTITY
20100110	TREE REMOVAL (6 TO 15 UNITS DIAMETER)	UNITS	53
20100210	TREE REMOVAL (OVER 15 UNITS DIAMETER)	UNITS	419
20200100	EARTH EXCAVATION	CU YD	8,912
20201200	REMOVE AND DISPOSAL OF UNSUITABLE MATERIAL	CU YD	908
20400800	FURNISHED EXCAVATION	CU YD	741
20900110	POROUS GRANULAR BACKFILL	CU YD	102
25000350	SEEDING, CLASS 7	ACRE	5.30
25000400	NITROGEN FERTILIZER NUTRIENT	POUND	477
25000500	PHOSPHOROUS FERTILIZER NUTRIENT	POUND	477
25000600	POTASSIUM FERTILIZER NUTRIENT	POUND	477
25001000	SEEDING, CLASS 2 (SPECIAL)	ACRE	5.30
25100115	MULCH METHOD 2	ACRE	5.30
25100630	EROSION CONTROL BLANKET	SO YD	1,785
28000300	TEMPORARY DITCH CHECKS	EACH	15
28000400	PERIMETER EROSION BARRIER	FOOT	600
28000500	INLET AND PIPE PROTECTION	EACH	3
28100105	STONE CUMBED RIPRAP, CLASS A3	SO YD	37
31101000	SUB-BASE GRANULAR MATERIAL, TYPE B	TON	4,684
35100100	AGGREGATE BASE COURSE, TYPE A	TON	2,945
40500500	BITUMINOUS MIXTURE COMPLETE	TON	344
40600100	BITUMINOUS MATERIALS (PRIME COAT)	GALLON	4,974
40600300	AGGREGATE PRIME COAT	TON	15
42001165	BRIDGE APPROACH PAVEMENT	SO YD	240
48100100	AGGREGATE SHOULDERS, TYPE A	TON	1,282
50100100	REMOVAL OF EXISTING STRUCTURES	EACH	1
50200100	STRUCTURE EXCAVATION	CU YD	433
50200400	ROCK EXCAVATION FOR STRUCTURES	CU YD	83
50300225	CONCRETE STRUCTURES	CU YD	267.5
50300255	CONCRETE SUPERSTRUCTURES	CU YD	158.5
50300260	BRIDGE DECK GROOVING	SO YD	411
50300310	ELASTOMERIC BEARING ASSEMBLY, TYPE I	EACH	6
50400735	F & E PPC BULB T BEAMS, 63"	FOOT	647
50800205	REINFORCEMENT BARS, EPOXY COATED	POUND	56,750
50901005	STEEL BRIDGE RAIL, TYPE SM	FOOT	206
51500100	NAME PLATES	EACH	1
542A0223	PIPE CULVERTS, CLASS A, TYPE 1 18"	FOOT	68
542A0473	PIPE CULVERTS, CLASS A, TYPE 1, EQUIVALENT ROUND-SIZE 18"	FOOT	36
542D0270	PIPE CULVERTS, CLASS 2, TYPE 1 15"	FOOT	236
54213663	PRECAST REINFORCED CONCRETE FLARED END SECTIONS 18"	EACH	5
54214503	PRECAST REINFORCED CONCRETE FLARED END SECTIONS, EQUIVALENT ROUND-SIZE 18"	EACH	2
63000000	STEEL PLATE BEAM GUARD RAIL, TYPE A	FOOT	225
63100087	TRAFFIC BARRIER TERMINAL, TYPE 6A	EACH	4
63100167	TRAFFIC BARRIER TERMINAL TYPE 1, SPECIAL (TANGENT)	EACH	4
63200310	GUARDRAIL REMOVAL	FOOT	581
66600105	FURNISHING AND ERECTING RIGHT-OF-WAY MARKERS	EACH	30
66700205	PERMANENT SURVEY MARKERS, TYPE I	EACH	1
67100100	MOBILIZATION	L SUM	1
70101700	TRAFFIC CONTROL AND PROTECTION	L SUM	1
70300100	SHORT-TERM PAVEMENT MARKING	FOOT	1,042
70301000	WORK ZONE PAVEMENT MARKING REMOVAL	SO FT	347
78000200	THERMOPLASTIC PAVEMENT MARKING LINE - 4"	FOOT	41,440
78200455	BIDIRECTIONAL GUARD RAIL REFLECTORS	EACH	12
78201000	TERMINAL MARKER DIRECT APPLIED	EACH	4
X40C6414	BITUMINOUS CONCRETE SURFACE COURSE, SUPERPAVE, MIX "C", N50	TON	1,710
Z0002600	BAR SPLICERS	EACH	74
Z0005400	BREAKER-RUN CRUSHED STONE	TON	1,861

* SPECIALTY ITEM

SECTION 01-00282-00-BR
ENDS AT STA. 42+00

SECTION 01-00282-00-BR

REMOVE EXISTING TWO-SPAN (2 @ 51'-9")
REINFORCED CONCRETE DECK ON STEEL
STRINGERS AT STATION 20+00. NO SALVAGE,
AND REPLACE WITH A SINGLE SPAN (1 @ 106'-6")
REINFORCED CONCRETE DECK ON 63" P.P.C.
BULB T-BEAMS SUPPORTED BY CLOSED
ABUTMENT AT STATION 20+00.

SECTION 01-00282-00-BR
BEGINS AT STA. 10+22

APPROVED October 21, 2005 20 05
Kevin A. ...
LOCAL AGENCY OFFICIAL

PASSED November 15, 2005 20 05
John C. ...
DISTRICT ENGINEER OF LOCAL ROADS & STREETS

APPROVED November 15, 2005 20 05
John C. ...
FOR BIDDING DISTRICT ENGINEER

STATE OF ILLINOIS
DEPARTMENT OF TRANSPORTATION

33382
REGISTERED
PROFESSIONAL
ENGINEER
OF
ILLINOIS
John C. ...
10/15/05

FUNCTIONAL CLASSIFICATION	3R GUIDELINES		
	HIGHWAY	ADT/YEAR	%TRUCKS
MAJOR COLLECTOR (RURAL)	ROCKYFORD ROAD	950/2024	4%
LOCAL	RIVER VIEW ROAD	120/2024	1%
LOCAL	NEWMAN ROAD	< 50/2024	< 1%



PREPARED BY
**WILLET
HOFMANN &
ASSOCIATES, INC.**
CONSULTING ENGINEERS
Land Surveying - Transportation - Structural
Environmental - Architecture
809 East Second Street
Dixon, Illinois 61021
Phone: 815-284-3381