

ROUTE NO.	SECTION	COUNTY	TOTAL SHEETS	SHEET NO.
01-00282-00-BR	LEE	51	24	
FED. ROAD DIST. NO. 7		ILLINOIS	FED. AID PROJECT	

STRUCTURAL SHEET 10 OF 15

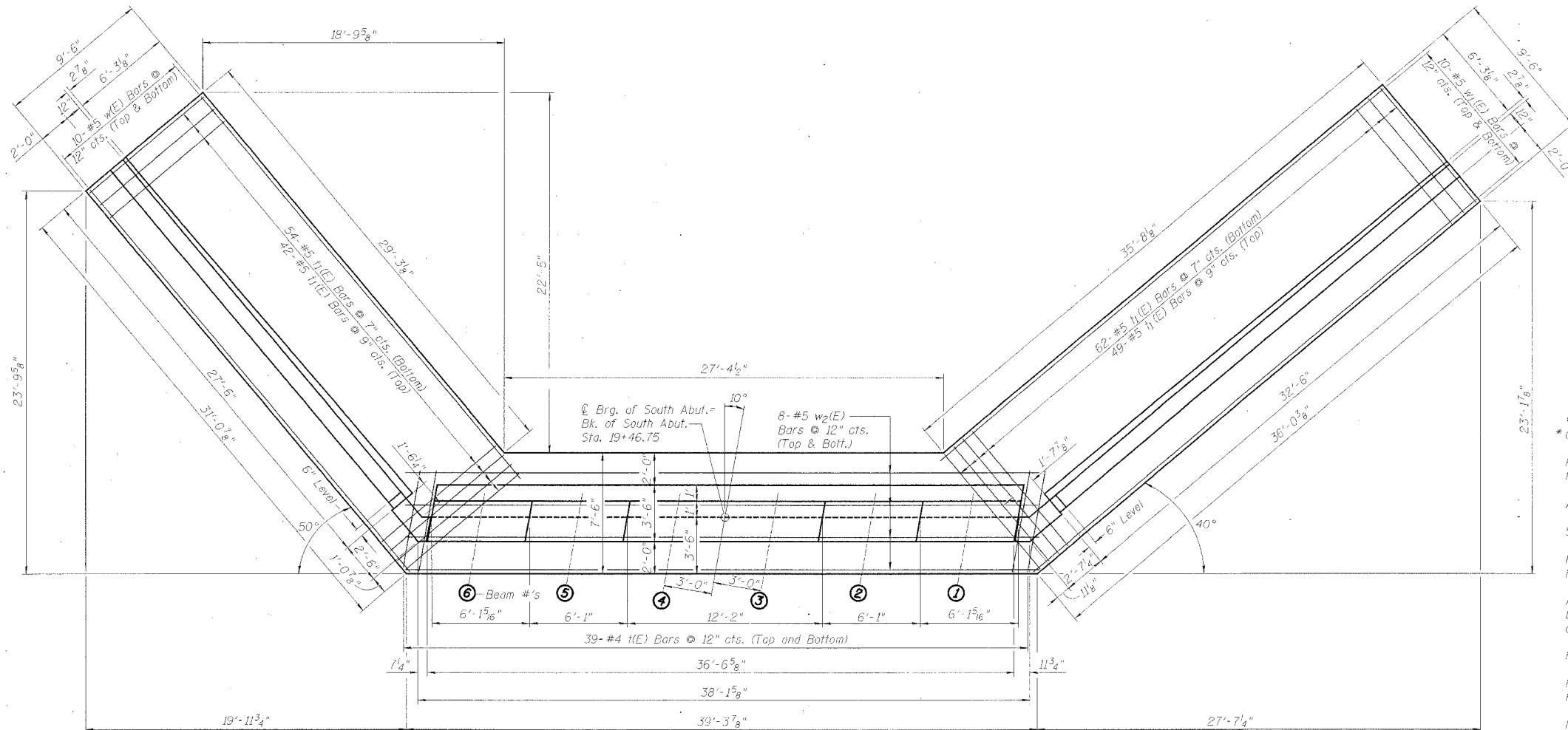

PLAN

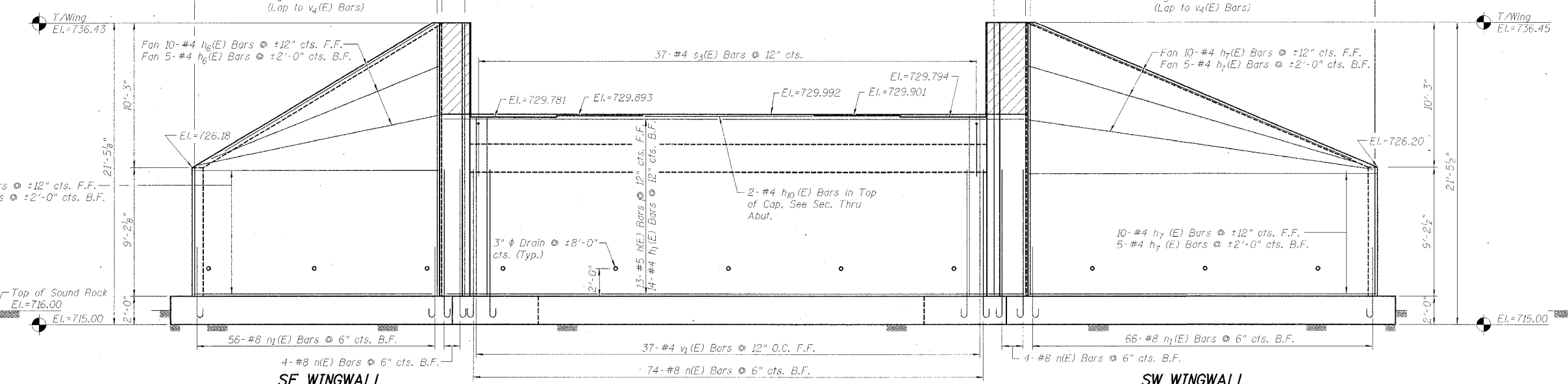

ELEVATION  
(Looking South)

**NOTES:**

- \* Cut in Field to Fit. If Necessary
- Footings for Abutment and Wingwalls shall be Poured Monolithically.
- All Corners shall Have a 3/4" Chamfer Unless Otherwise Noted.
- Space Reinforcement in Abutment to Miss Anchor Bolts.
- Portion of Footing in Rock shall be Poured Against in Place Rock. No Forming will be Allowed.
- A Deposit of Clean Stone Wrapped in Geotechnical Fabric of Least 2 Feet in Each Direction shall be Placed at the Back of Each Drain Hole in the Abutment and Wingwall.
- For Bill of Materials See Structural Sheet 11 of 15.
- Payment of Porous Granular Backfill shall be Limited to Two Feet Measured Horizontally Behind the Abutment Only.
- Hatched Area of Wings shall be Poured After Beams are in Place and Deck and Diaphragm have been Poured. Quantities Billed with Superstructure on Structural Sheet 3 of 15.

**NOTATIONS**

F.F.	- FRONT FACE
B.F.	- BACK FACE

**MIN. LAP**

#4	1'-4"
#5	1'-8"
#6	2'-0"
#7	3'-5"
#8	4'-6"

**SOUTH ABUTMENT**  
SECTION 01-00282-00-BR  
ROCKYFORD ROAD over GREEN RIVER  
STA. 20+00 (S.N. 032-3512)  
LEE COUNTY  
WHA # 1154D03