

F.A.U. RTE.	SECTION	COUNTY	TOTAL SHEETS	SHEET NO.
*	**	McLEAN	34	31
STA. 98+73.25 TO STA. 100+64.98				
FED. ROAD DIST. NO.	ILLINOIS	FED. AID PROJECT		
* 6352	COLLEGE AVENUE			
* 6385	WHITE OAK ROAD (C.H. 70)			
* 03-00182-00-RS				

FINAL	DATE	BY
SURVEY		
NOTE BOOK		
EXPLANATION		
AREAS CHECKED		

ORIGINAL	DATE	BY
SURVEY		
NOTE BOOK		
EXPLANATION		
AREAS CHECKED		

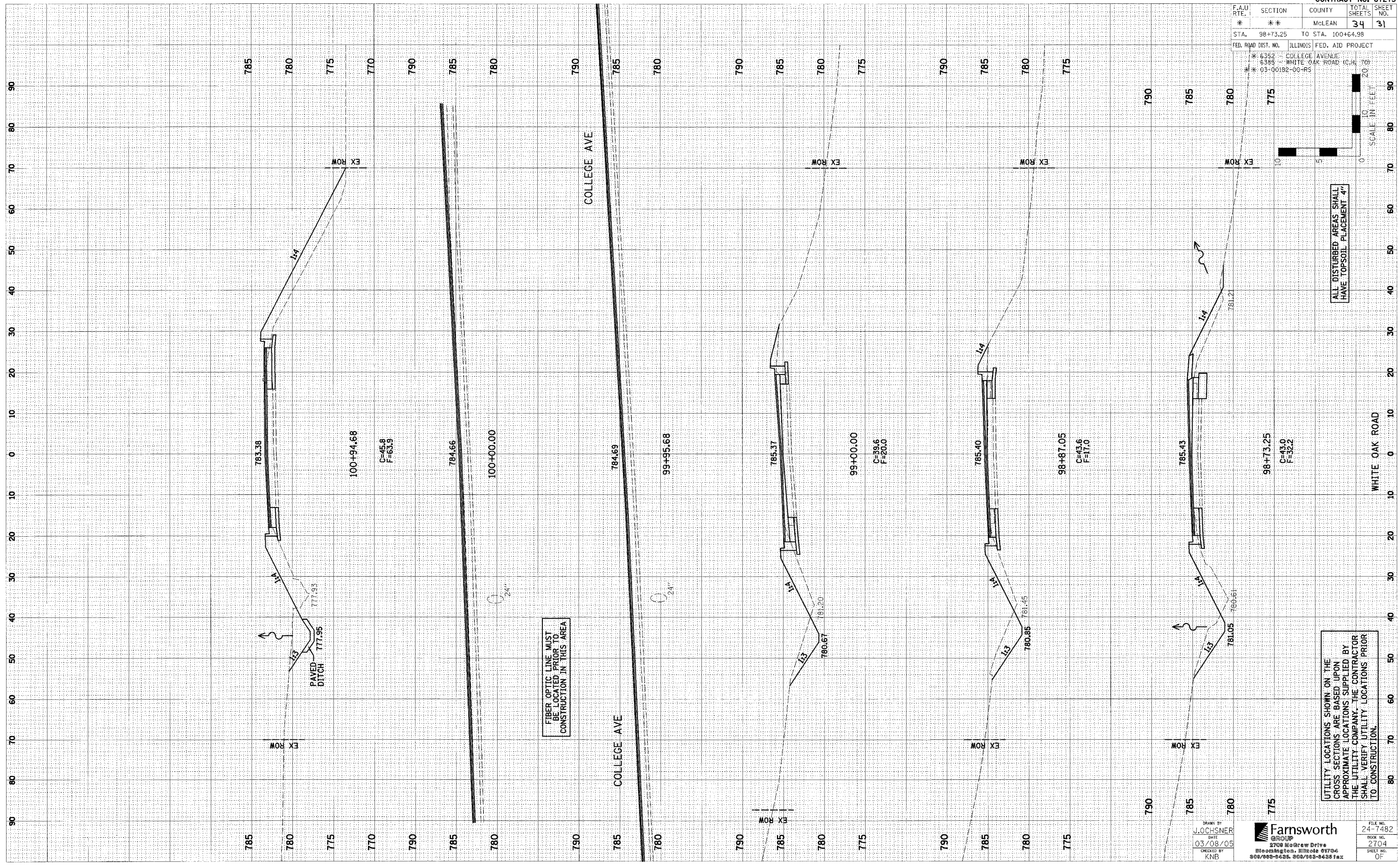

ALL DISTURBED AREAS SHALL HAVE TOPSOIL PLACEMENT 4"

UTILITY LOCATIONS SHOWN ON THE CROSS SECTIONS ARE BASED UPON APPROXIMATE LOCATIONS SUPPLIED BY THE UTILITY COMPANY. THE CONTRACTOR SHALL VERIFY UTILITY LOCATIONS PRIOR TO CONSTRUCTION.

DRAWN BY
J. JOCHSNER
DATE
03/08/05
CHECKED BY
KNB

Farnsworth GROUP
2708 NewBrew Drive
Bloomington, Illinois 61704
309/999-9435, 800/763-9438 fax

FILE NO.
24-7482
BOOK NO.
2704
SHEET NO.
OF