

ROUTE NO.	SECTION	COUNTY	TOTAL SHEETS	SHEET NO.
C.H. 20	04-00153-00-BR	STARK	13	1

ILLINOIS
CONTRACT NO. 89364

STATE OF ILLINOIS DEPARTMENT OF TRANSPORTATION DIVISION OF HIGHWAYS PLANS FOR PROPOSED BRIDGE REPLACEMENT AND REHABILITATION PROGRAM

**SECTION 04-00153-00-BR
STARK COUNTY
PROJECT NO. BRS-208(102)
COUNTY HIGHWAY 20 (FAS. RTE. 208)
JOB NO. C-94-065-05**

INDEX OF SHEETS

SHEET NO.	TITLE
1.	COVER SHEET
2.	SUMMARY OF QUANTITIES, GENERAL NOTES & TYPICAL SECTIONS
3.	PLAN AND PROFILE SHEET
4.-9.	BRIDGE PLANS
10.-13.	STATION CROSS SECTIONS

STANDARDS:

- 280001-02
- 515001-02
- 630001-05
- 631026-02
- 635006-02
- 701201-02
- 701301-02
- 702001-05
- BLR 21-6
- BLR 23-1

QC/QA BITUMINOUS SUPERPAVE PROJECT

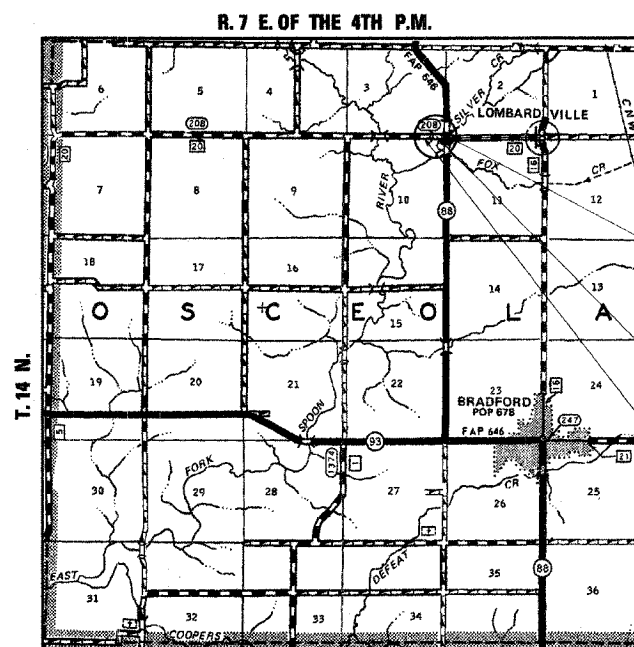

LOCATION PLAN

GROSS LENGTH OF SECTION = 538.58 FEET = 0.102 MILES
NET LENGTH OF SECTION = 538.58 FEET = 0.102 MILES

SCALE IN MILES

SCALES



**IMPROVEMENT ENDS
STA. 16+88.58**

**STA. 15+00 SPECIAL BRIDGE DESIGN
PRECAST PRESTRESSED DECK BEAM
BRIDGE, THREE SPANS @ 33'-0", 44'-0",
33'-0", 28'-0" ROADWAY, 20° LT. SKEW
EXIST. S.N. 088-3308
PROP. S.N. 088-3408**

**IMPROVEMENT BEGINS
STA. 11+50**

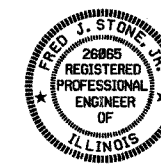

Fred J. Stone, Jr. (11.02.05)
ILLINOIS PROFESSIONAL NO. 26065
EXPIRES 11-30-07

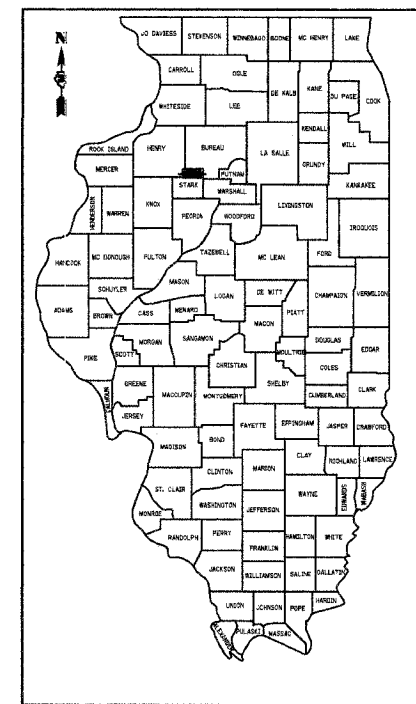

LOCATION OF SECTION INDICATED THUS:

**CLASSIFICATION: RURAL TWO-LANE COLLECTOR
DESIGN VOLUME: ADT UNDER 400
CURRENT ADT: 186 (2005)
DESIGN SPEED: 40 MPH**

TOLL FREE JOINT UTILITY LOCATING
INFORMATION FOR EXCAVATORS (J.U.L.I.E.)
TELEPHONE NUMBER 1-800-892-0123

APPROVED *Dec 8* *2005*
Donald P. Fitzgerald
COUNTY ENGINEER

PASSED *December 14* *2005*
John H. Haldell
DISTRICT FOUR ENGINEER OF LOCAL ROADS & STREETS

RELEASING FOR BID
BASED ON LIMITED
REVIEW *December 15, 2005*
John H. Haldell
DEPUTY DIRECTOR OF HIGHWAYS, REGION THREE ENGINEER

STATE OF ILLINOIS
DEPARTMENT OF TRANSPORTATION

CONTRACT NO. 89364

4440 ASH GROVE
SPRINGFIELD, IL 62711
(217) 793-8600
oasinc@famvid.com

OZYURT AND STONE, INC.
CONSULTING ENGINEERS