

ROUTE NO.	SECTION	CITY	TOTAL SHEETS	SHEET NO.
KOESTER-COMMERCE PL	04-00006-00-RP	FORSYTH	21	1
FED. ROAD DIST. NO.		ILLINOIS	PROJECT NCPD-0115 (053)	

STATE OF ILLINOIS
DEPARTMENT OF TRANSPORTATION
PLANS FOR
PROPOSED LOCAL AGENCY IMPROVEMENT
FEDERAL AID URBAN PROJECT

PLAN 1" = 20'
PROFILE HOR. 1" = 20'
PROFILE VERT. 1" = 2'
CROSS SECTIONS HOR. 1" = 5'
VERT. 1" = 2'

VILLAGE OF FORSYTH, ILLINOIS

COMMERCE PLACE EXTENSION

SECTION 04-00006-00-RP
PROJECT NCPD-0115 (053)
C - 95-301-05
MACON COUNTY, ILLINOIS

DOT STANDARDS

- 280001-02 Temporary Erosion Control Systems
- 420001-06 Pavement Joints
- 420101-03 24' Jointed PCC Pavement
- 420106-03 36' Jointed PCC Pavement
- 420111-01 PCC Pavement Roundouts
- 424001-04 Curb Ramps for Sidewalks
- 542806 Reinforced Concrete Pipe Tee
- 602301 Inlet, Type A
- 602401 Manhole, Type A
- 602801 Precast Reinforced Concrete Flat Slab Top
- 604001-02 Frames and lids, Type 1
- 606001-02 Concrete Curb and Combination Concrete Curb and Gutter
- 606306-01 Corrugated PC Concrete Medians
- 702001-05 Traffic Control Devices
- 780001-01 Typical Pavement Markings
- BLR22-4 Typical Application of Traffic Control Devices for Construction on Rural Local Highways

UTILITIES

AMEREN IP 500 S. 27TH STREET DECATUR, IL 62521	GAS AND ELECTRIC	800-892-7715
SBC 990 SOUTHSIDE DRIVE DECATUR, IL 62521	TELEPHONE POLES, BOXES AND CABLES	217-429-8596
INSIGHT COMMUNICATIONS 1275 N. WATER STREET DECATUR, IL 62521	POLES, BOXES AND CABLES	217-424-8474
VILLAGE OF FORSYTH 301 S. US ROUTE 51 FORSYTH, IL 62535	SEWERS AND WATER MAINS	217-877-9445

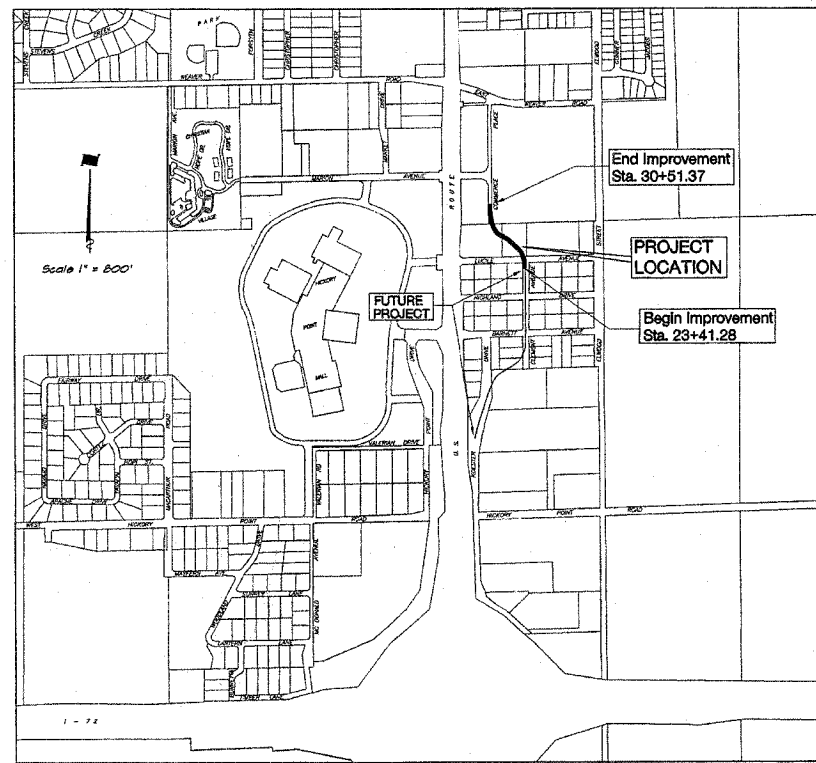

LOCATION MAP
TOTAL LENGTH OF PROJECT = 710.09 FEET = 0.134 MILES
NET LENGTH OF PROJECT = 710.09 FEET = 0.134 MILES

DESIGN DESIGNATION
463 (24) COLLECTOR 0.34 (PCC-20)

INDEX TO SHEETS
SEE SHEET NO. 2

CONTRACT NUMBER 91326



by *Michael A. Price*
date 06/02/2005
expires NOV.30, 2005

APPROVED	June 8 2005	200_5
	<i>Chuck Jones</i> VILLAGE ADMINISTRATOR	
PASSED	12/20 2005	200_5
	<i>D. A. S.</i> DISTRICT ENGINEER OF LOCAL ROADS & STREETS	
Submittal For 60% Based on Limited Review	<i>J. E. Crowe</i> 200_5	
	JOSEPH E. CROWE, PE DEPUTY DIRECTOR OF HIGHWAYS, REGION 3 ENGINEER STATE OF ILLINOIS DEPARTMENT OF TRANSPORTATION	

NOTE

Underground facilities, structures and utilities have been plotted from available surveys and records and their locations must be considered approximate only. There may be others, the existence of which is presently not known. The depth of utilities is assumed to be normal and customary. Contractor shall verify location and depth of all utilities prior to construction.

IT'S THE LAW IN ILLINOIS

PRIOR TO COMMENCING ANY CONSTRUCTION OR EXCAVATION, THE CONTRACTOR SHALL VERIFY THE LOCATION OF ALL UTILITIES BY CALLING:
J.U.L.I.E. * 1 - 8 0 0 - 8 9 2 - 0 1 2 3

* Joint Utilities Locating Information for Excavators.

