

PERMANENT PAVEMENT MARKING SUMMARY

| CODE NO. | ITEM | UNIT | QUANTITY |
|----------|------------------------------------|------|----------|
| 70300520 | PAVEMENT MARKING TAPE, TYPE III 4" | FOOT | 334 |
| 78001110 | PAINT PAVEMENT MARKING - LINE 4" | FOOT | 1582 |
| 78001180 | PAINT PAVEMENT MARKING - LINE 24" | FOOT | 25 |

LEGEND

- PR. DOUBLE VERTICAL PANEL (BY OTHERS)
- PR. SIGN ON PERMANENT SUPPORT (BY OTHERS)
- PR. POLE & TRAFFIC SIGNAL HEAD (BY OTHERS)

ALL PAVEMENT MARKINGS ARE PAINT UNLESS OTHERWISE NOTED

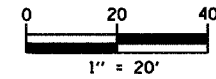

| F.A.I.D. RTE. | SECTION | COUNTY | TOTAL SHEETS | SHEET NO. |
|------------------------------|----------------|-------------------|--------------|-----------|
| 6998 | 99-00209-02-PV | VERMILION | 72 | 30 |
| STA. 97+00 | | TO STA. 109+00 | | |
| FED. ROAD DIST. NO. ILLINOIS | | FED. AID PROJECT- | | |

CONTRACT NO.: 91356

| DATE | BY |
|------|----|
| | |
| | |
| | |

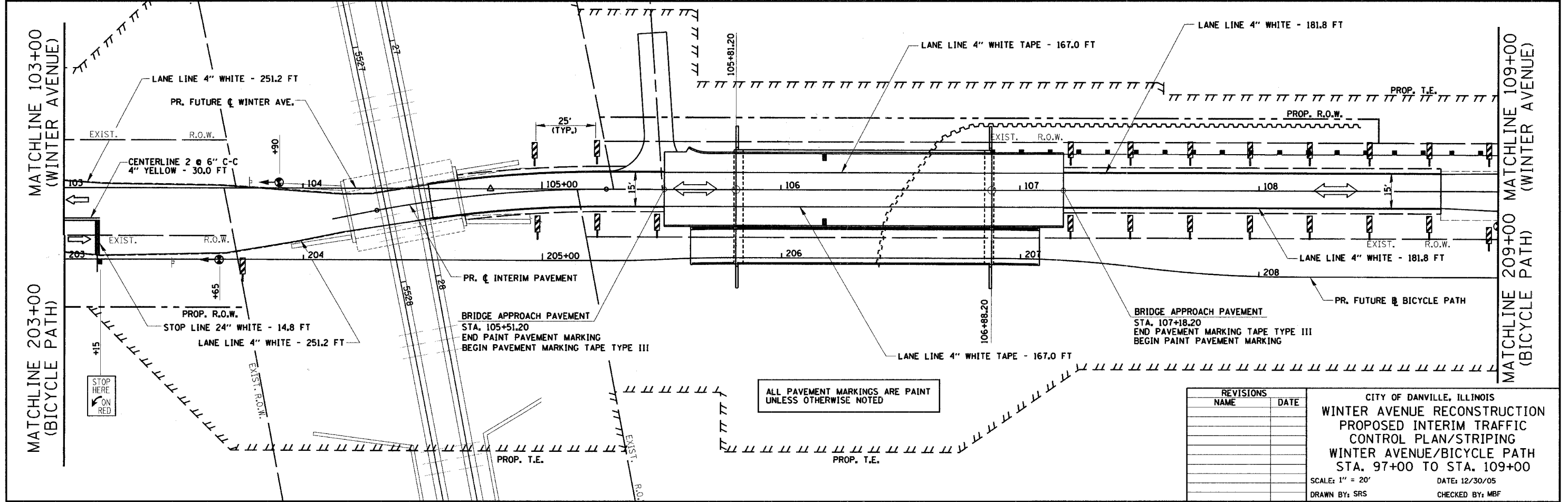
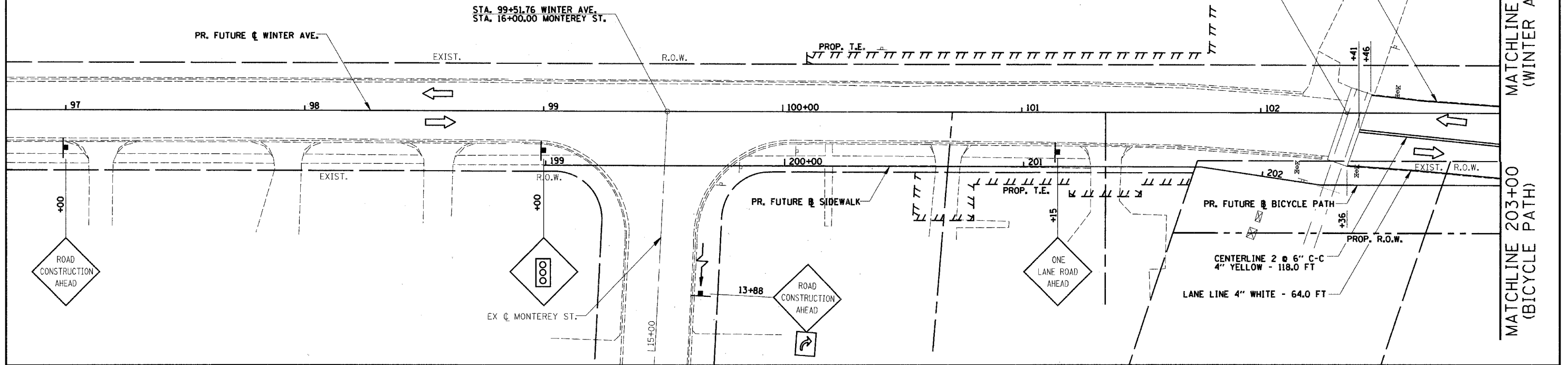

ALL PAVEMENT MARKINGS ARE PAINT UNLESS OTHERWISE NOTED

| REVISIONS | |
|-----------|------|
| NAME | DATE |
| | |
| | |
| | |
| | |

CITY OF DANVILLE, ILLINOIS
WINTER AVENUE RECONSTRUCTION
PROPOSED INTERIM TRAFFIC CONTROL PLAN/STRIPING
WINTER AVENUE/BICYCLE PATH
STA. 97+00 TO STA. 109+00
 SCALE: 1" = 20'
 DATE: 12/30/05
 DRAWN BY: SRS
 CHECKED BY: MBF