

PLAN	DATE
SURVEYED	BY
ALIGNED	BY
CHECKED	BY
RT. OF WAY	CHECKED
NO.	DATE
NO.	DATE
NO.	DATE
NO.	DATE

LEGEND

- PR. DOUBLE VERTICAL PANEL (BY OTHERS)
- PR. SIGN ON PERMANENT SUPPORT (BY OTHERS)
- PR. POLE & TRAFFIC SIGNAL HEAD (BY OTHERS)

ALL PAVEMENT MARKINGS ARE PAINT UNLESS OTHERWISE NOTED

F.A.D. RTE.	SECTION	COUNTY	TOTAL SHEETS	SHEET NO.
6998	99-00209-02-PV	VERMILION	72	31
STA. 109+00		TO STA. 121+00		
FED. ROAD DIST. NO. ILLINOIS		FED. AID PROJECT-		
CONTRACT NO.: 91356				

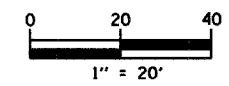

MATCHLINE 109+00 (WINTER AVENUE)

MATCHLINE 209+00 (BICYCLE PATH)

MATCHLINE 115+00 (WINTER AVENUE)

MATCHLINE 215+00 (BICYCLE PATH)

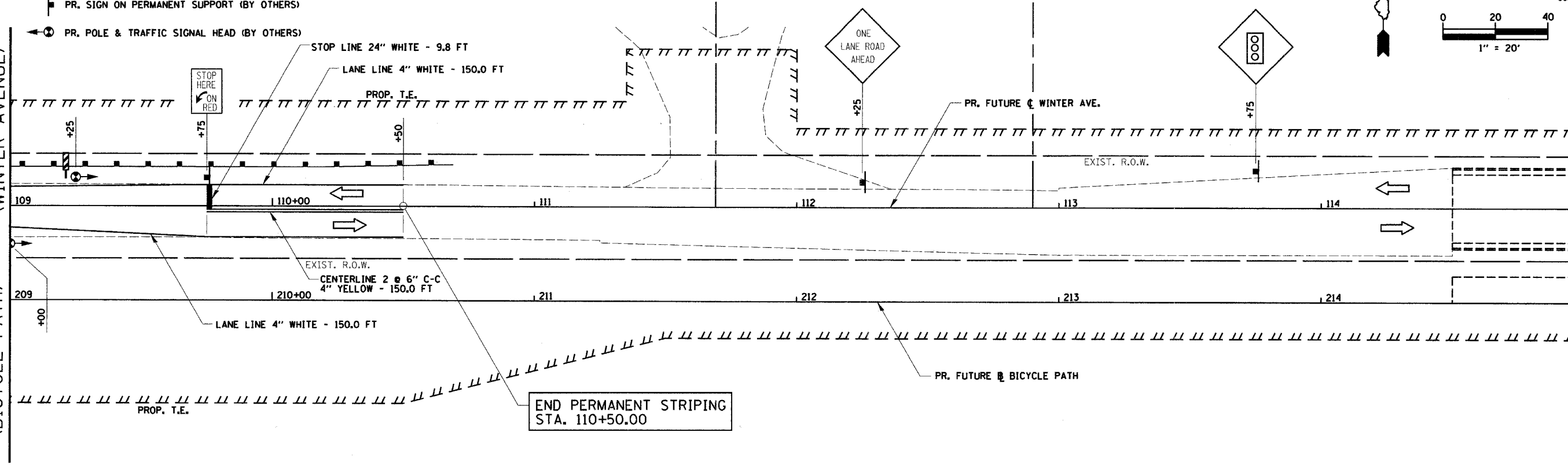

MATCHLINE 115+00 (WINTER AVENUE)

MATCHLINE 215+00 (BICYCLE PATH)

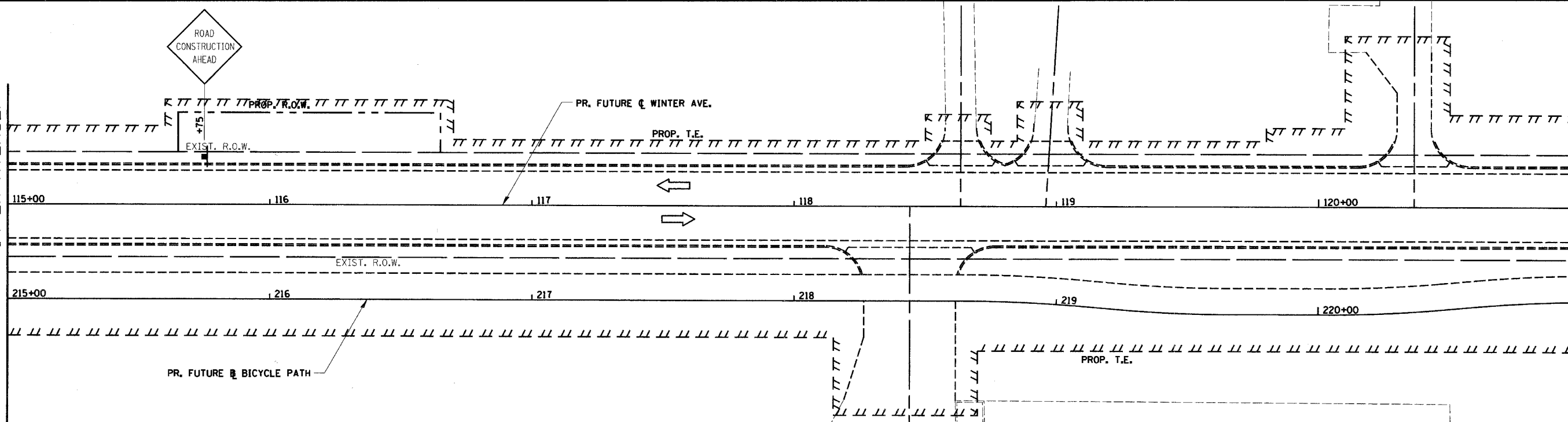

REVISIONS	
NAME	DATE

CITY OF DANVILLE, ILLINOIS
**WINTER AVENUE RECONSTRUCTION
 PROPOSED INTERIM TRAFFIC
 CONTROL PLAN/STRIPING
 WINTER AVENUE/BICYCLE PATH
 STA. 109+00 TO STA. 121+00**
 SCALE: 1" = 20' DATE: 12/30/05
 DRAWN BY: SRS CHECKED BY: MBF