

F.A.P. RTE.	SECTION	COUNTY	TOTAL SHEETS	SHEET NO.
6998	99-00209-02-PV	VERMILION	72	69
STA.		TO STA.		
FED. ROAD DIST. NO.		ILLINOIS FED. AID PROJECT		
CONTRACT NO.: 91356				
SCALE				
HORZ. 1"=10'				
VERT. 1"=5'				

DATE	BY
FINAL SURVEY	
NOTE BOOK	
NO.	
SURVEYED	
TEMPLATE	
AREAS CHECKED	

DATE	BY
ORIGINAL SURVEY	
NOTE BOOK	
NO.	
SURVEYED	
TEMPLATE	
AREAS CHECKED	

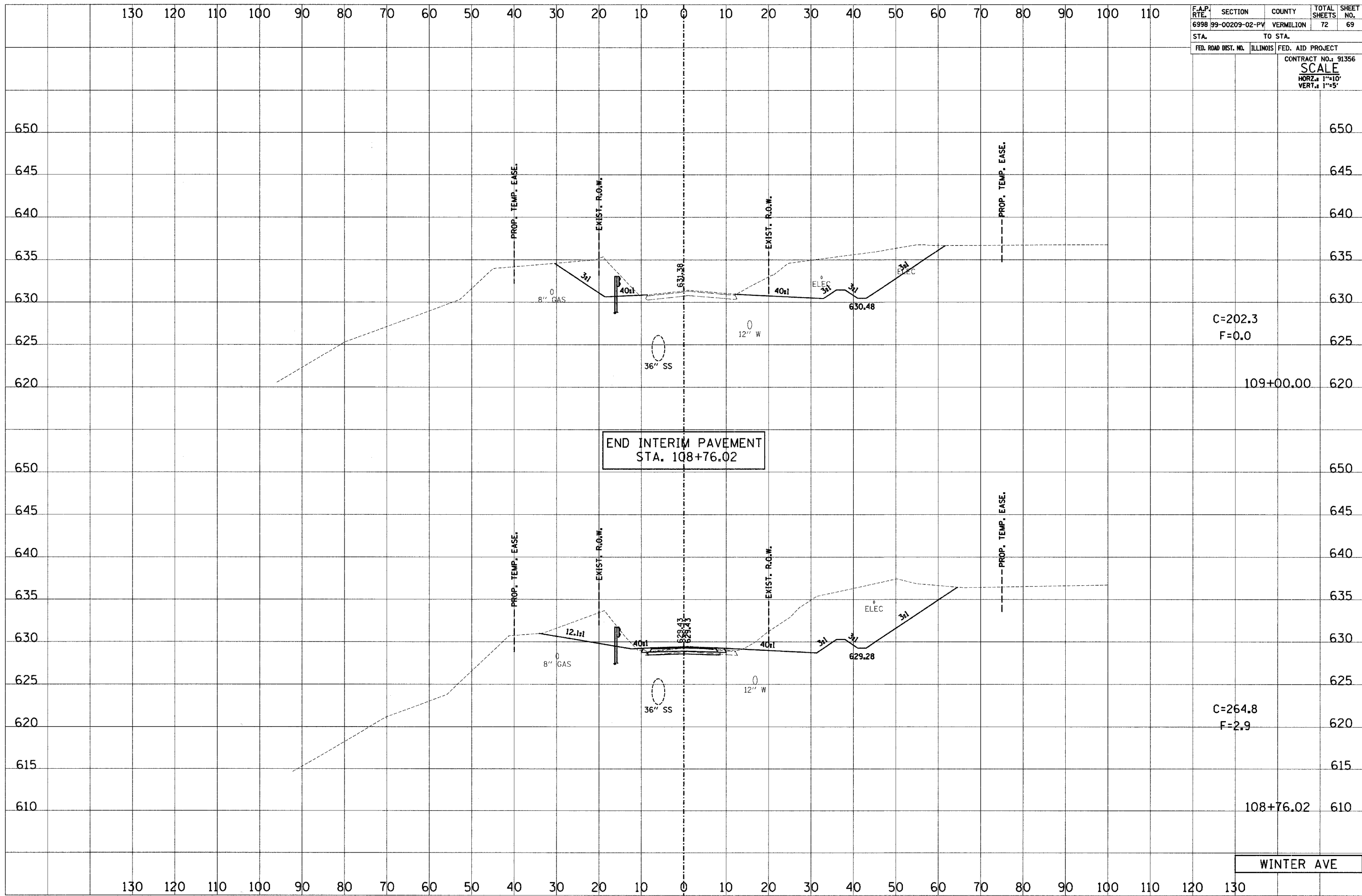

END INTERIM PAVEMENT
STA. 108+76.02

C=202.3
F=0.0

C=264.8
F=2.9

WINTER AVE