

F.A.P. RTE.	SECTION	COUNTY	TOTAL SHEETS	SHEET NO.
777	10(B-1, BR-2)	MONTGOMERY	104	76
STA.		TO STA.		
FED. ROAD DIST. NO.		ILLINOIS FED. AID PROJECT		

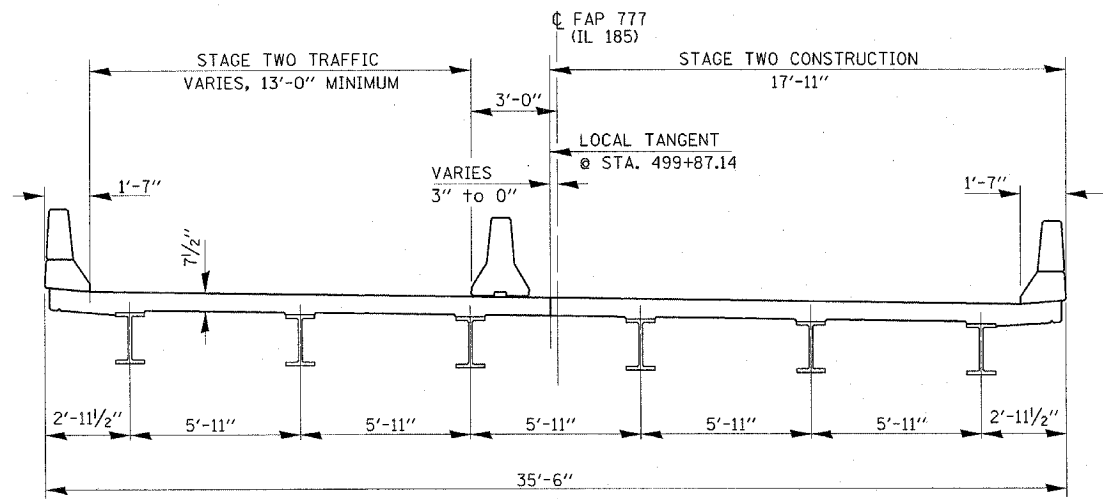
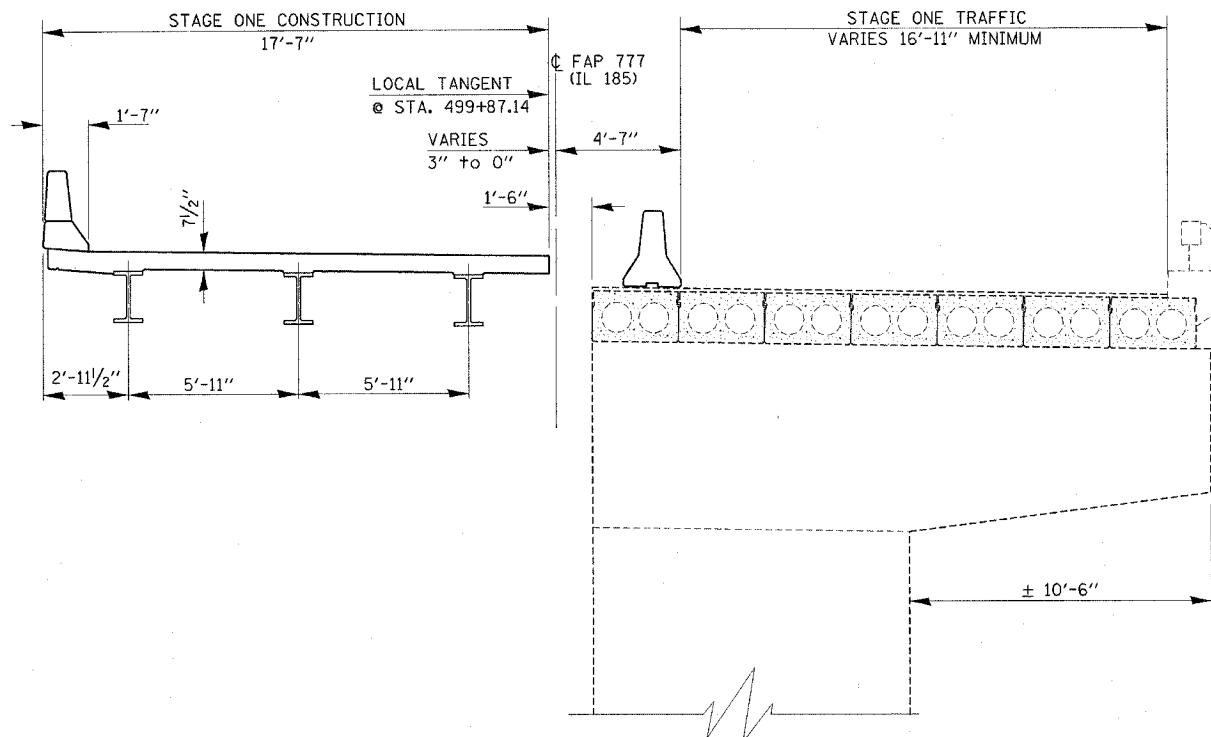
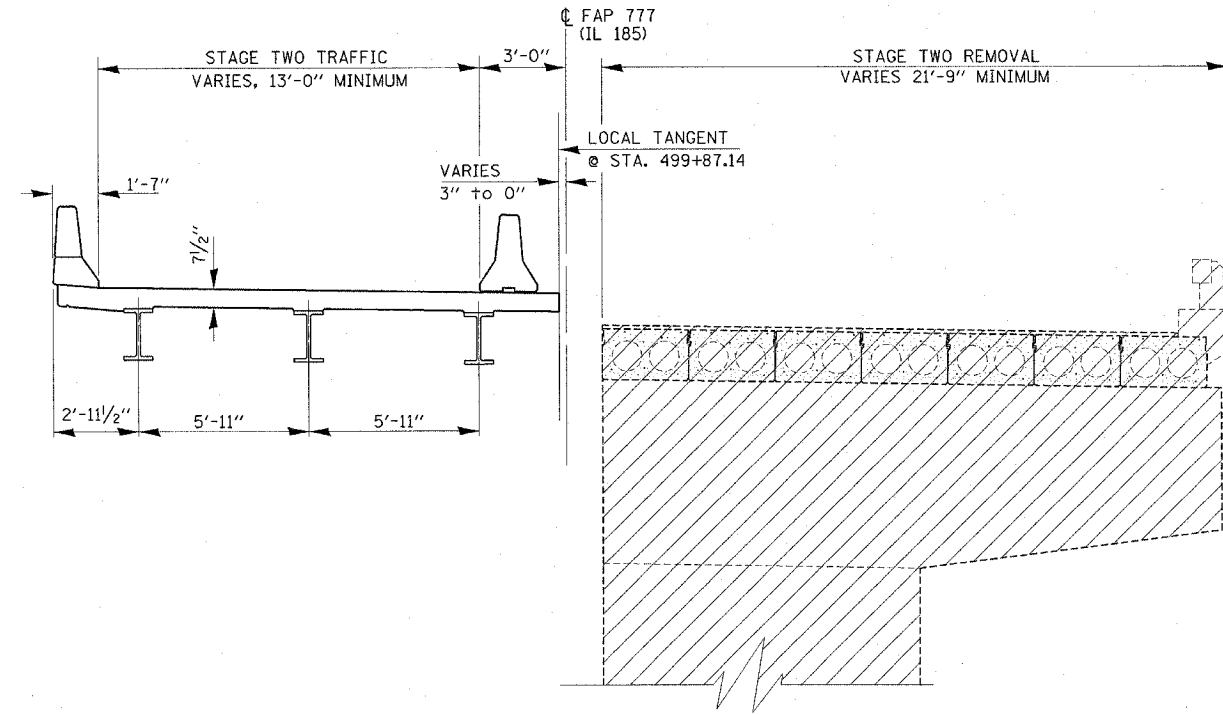
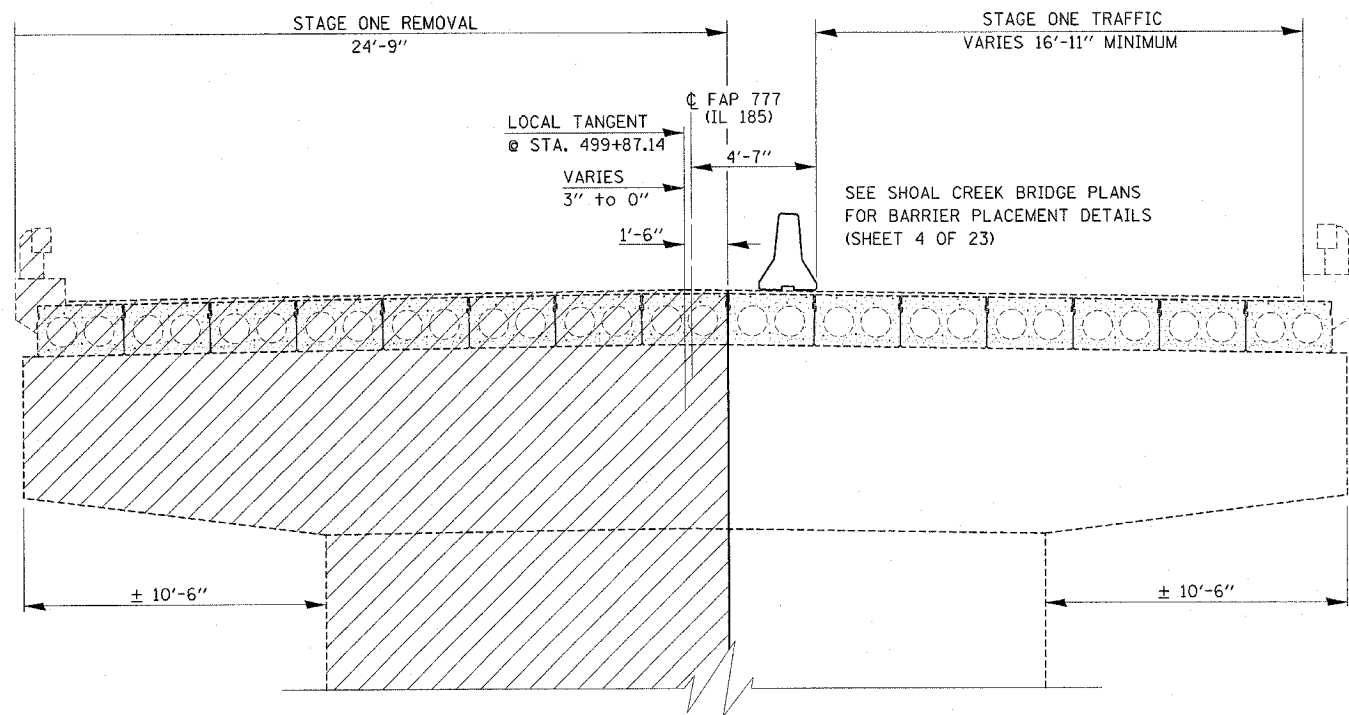

PLOT DATE = 2/6/2006  
 PLOT SCALE = 20.0000 / IN.  
 USER NAME = slegland

REVISIONS	
NAME	DATE

ILLINOIS DEPARTMENT OF TRANSPORTATION  
**STAGE CONSTRUCTION FOR SHOAL CREEK**  
 FAP 777 (IL RTE. 185)  
 EAST FORK SHOAL CREEK  
 SECTION 10 B-1  
 MONTGOMERY COUNTY  
 SCALE: VERT. DATE:      HORIZ. DATE:      DRAWN BY R.T.S.  
 CHECKED BY