

teas:leuck
 12/23/2005
 c:\projects\94964\d03502pa.dgn

CONTRACT NO. 94964

F.A.P. RTE.	SECTION	COUNTY	TOTAL SHEETS	SHEET NO.
327	13B-1&13B-2	MARION	78	9
STA.		TO STA.		
FED. ROAD DIST. NO.		ILLINOIS FED. AID PROJECT		

PAVING SCHEDULE

STATION TO STATION	LENGTH	EXISTING PAVEMENT WIDTH	AREA	PAVING SCHEDULE							MARKING					TEMPORARY RAMP	BITUMINOUS SURFACE REMOVAL - BUTT JOINT
				BITUMINOUS MATERIALS (PRIME COAT)	AGGREGATE (PRIME COAT)	BITUMINOUS CONCRETE BINDER COURSE, SUPERPAVE, 1L-19.0, N70	BITUMINOUS CONCRETE SURFACE COURSE, SUPERPAVE, MIX "C", N90	BITUMINOUS SHOULDERS SUPERPAVE	AGGREGATE SHOULDERS, TYPE B	PAINT PAVEMENT MARKING - LINE 4"	RAISED REFLECTIVE PAVEMENT MARKER REMOVAL	RAISED REFLECTIVE PAVEMENT MARKER	RAISED REFLECTIVE PAVEMENT MARKER (BRIDGE)	EACH	EACH		
DUMS CREEK 331+00.00 TO 335+19.50 335+19.50 TO 337+46.50 337+46.50 TO 338+00.00 338+00.00 TO 338+50.00 DUMS CREEK TOTALS	419.5 APPROACH 53.50 50.00 523.00	24 PAVEMENT AND 24 28	10068 BRIDGE 1284 1400	261 31 34 326	5 1 1 7	575 28 20 623	94 12 14 120	246 44 88 378	38 0 0 38	2918 908 214 1520 5560	6 2 1 1 10	6 1 1 8	2 2 1 2	31.5 18 13.5 63	80		
SKILLET FORK CREEK 372+80.00 TO 373+25.00 373+25.00 TO 374+17.00 374+17.00 TO 376+89.00 376+89.00 TO 378+50.00 378+50.00 TO 379+10.00 SKILLET FORK CREEK TOTALS	45.00 92.00 APPROACH 161.00 60.00 358.00	28 24 PAVEMENT AND 24 28	1260 2208 BRIDGE 3864 1680	31 54 96 42 223	1 1 2 1 5	0 24 134 0 158	12 21 36 16 85	55 66 120 14 255	0 0 3 10 13	1089 299 884 523 1138 3933	1 1 3 2 1 8	1 1 1 2 1 5	3 3	13.5 18 18 13.5 63	107 133 240		
TOTAL QUANTITIES	881.00			549	12	781	205	633	51	9493	18	13	5	126	400		

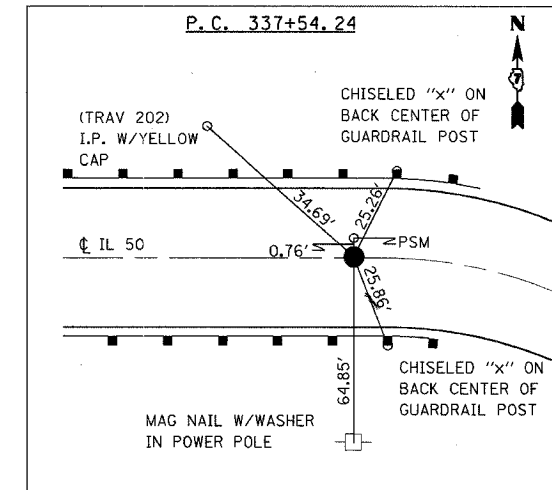

STATION TO STATION	EARTH EXCAVATION		EMBANKMENT	EARTHWORK BALANCE WASTE (+) SHORTAGE (-)
	CU YD	CU YD ADJUSTED (0.75)		
DUMS CREEK STA 331+00 TO 338+50 EXCAV FROM EX BRIDGE STRUCTURE EXCAVATION DUMS CREEK TOTALS	97 293 374	74 220 281	1635	-1561 220 281 -1060
SKILLET FORK CREEK STA 372+80 TO 379+10 EXCAV FROM EX BRIDGE STRUCTURE EXCAVATION SKILLET FORK CREEK TOTALS	155 295 194	115 221 146	977	-862 221 146 -495
TOTAL QUANTITIES				-1555

SEEDING, CLASS 2 (SPECIAL)

STATION TO STATION	TOTAL
DUMS CREEK STA 331+00 TO 335+50 STA 337+21 TO 340+00	0.4 ACRE 0.2 ACRE
SKILLET FORK CREEK STA 372+00 TO 374+50 STA 376+63 TO 379+25	0.2 ACRE 0.2 ACRE
PROJECT TOTAL	1.0 ACRE

PLOT DATE = 12/23/2005
 PLOT SCALE = 20.0000 IN.
 USER NAME = teas:leuck

REVISIONS	
NAME	DATE

ILLINOIS DEPARTMENT OF TRANSPORTATION
SCHEDULES & ALIGNMENT TIES
 SCALE: VERT. DATE
 HORIZ. DATE
 DRAWN BY
 CHECKED BY