

STATE OF ILLINOIS
DEPARTMENT OF TRANSPORTATION

ROUTE NO.	SECTION	COUNTY	TOTAL SHEETS	SHEET NO.	SHEET NO. 15
FAP Rte. 327	13B-2	Marion	78	32	17 SHEETS
FED. ROAD DIST. NO. 7	ILLINOIS	FED. AID PROJECT-			

Contract #94964

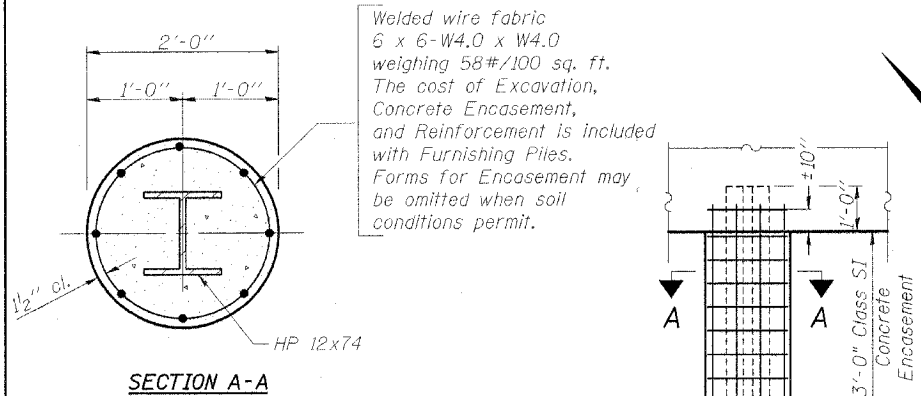

PILE ENCASEMENT DETAIL

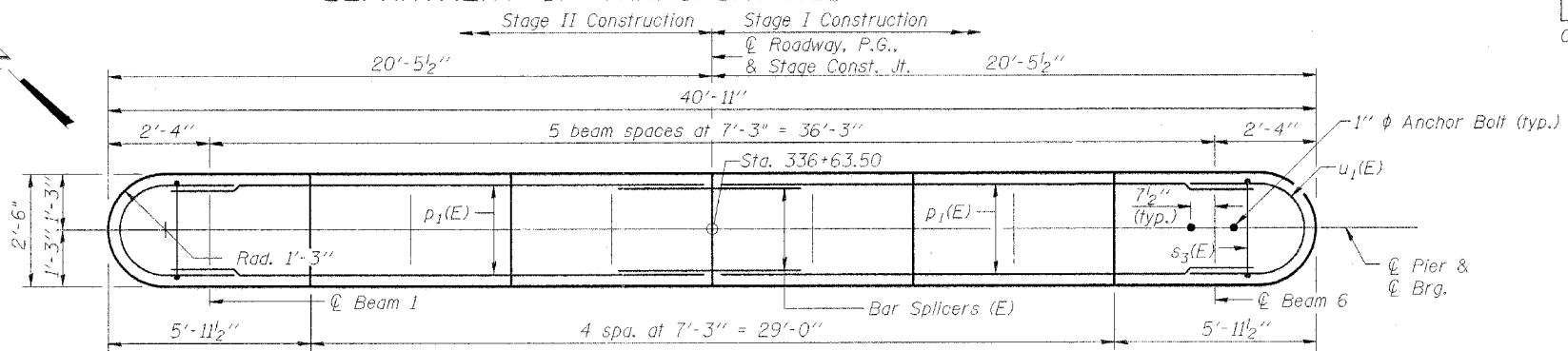

TOP PLAN

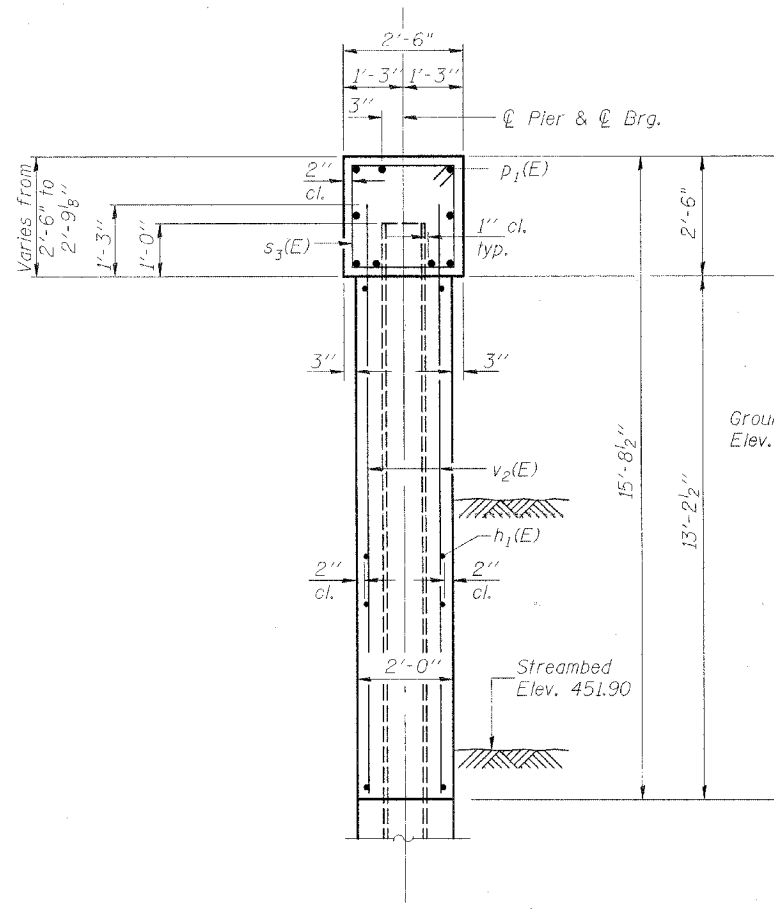

END VIEW

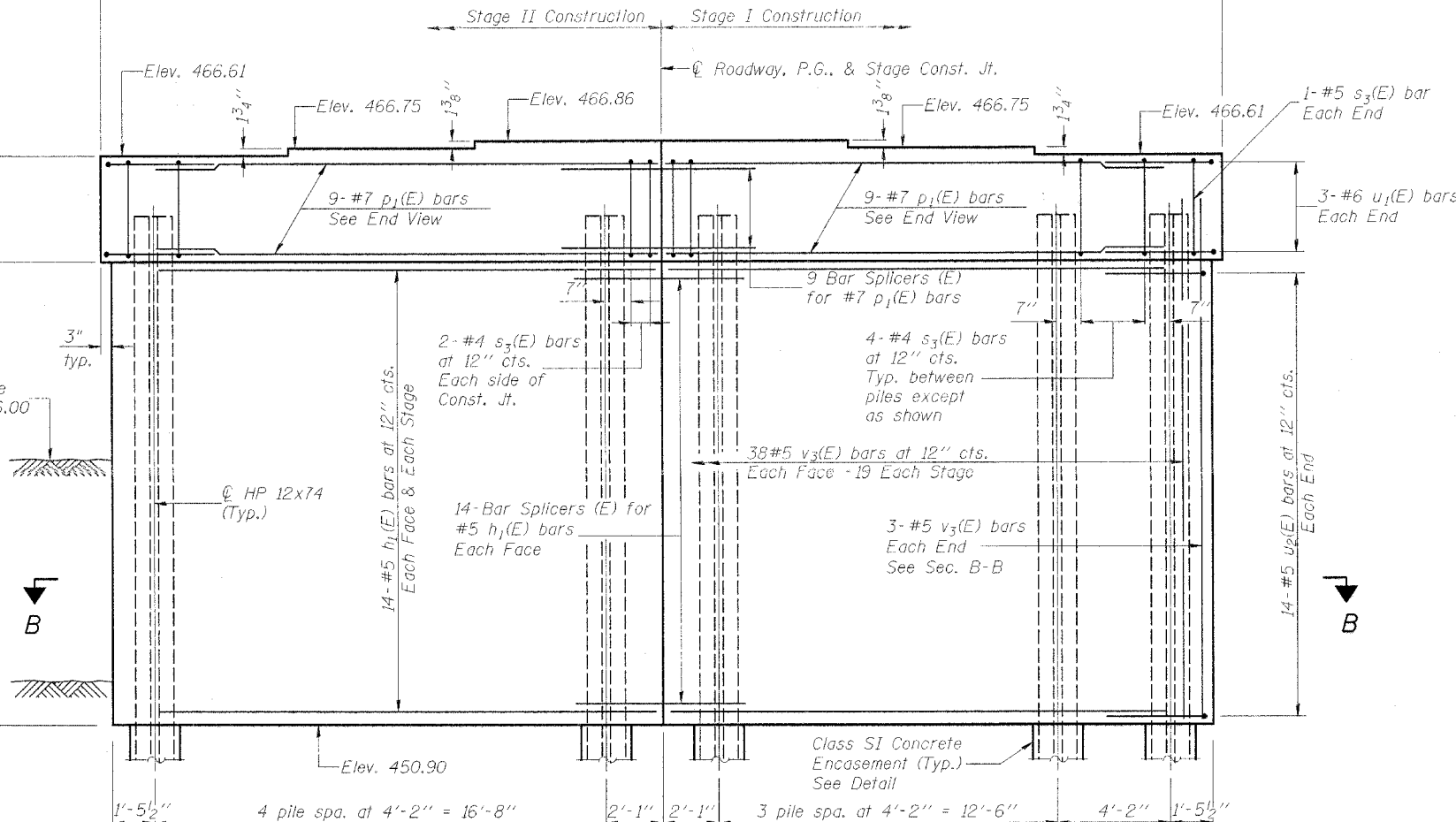

ELEVATION
(Looking East)

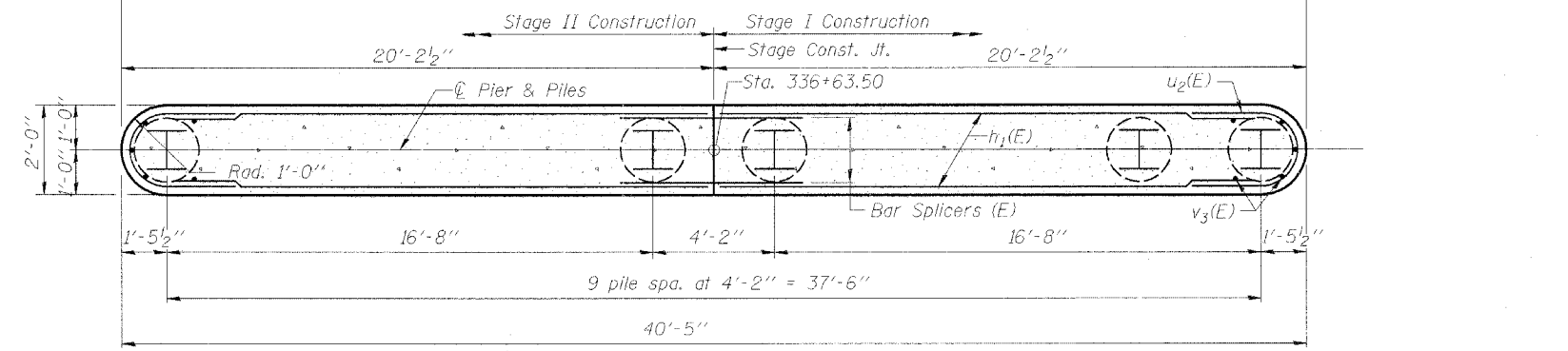

SECTION B-B

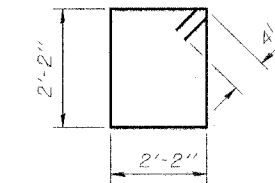

BAR s3(E)

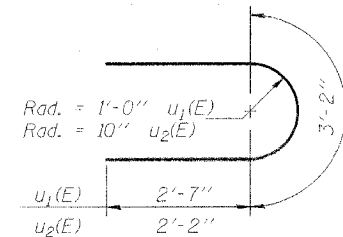

BARS u1(E) & u2(E)

BILL OF MATERIAL

Bar	No.	Size	Length	Shape
h1(E)	56	#5	19'-1"	—
p1(E)	18	#7	19'-1"	—
s3(E)	38	#4	9'-5"	□
u1(E)	6	#6	8'-4"	U
u2(E)	28	#5	7'-0"	U
v3(E)	82	#5	14'-5"	—
Concrete Structures Cu. Yd. 49.4				
Reinforcement Bars, Epoxy Coated Pound 3570				
Structure Excavation Cu. Yd. 92				
Test Pile Steel HP12x74 Each 1				
Furnishing Steel Piles HP12x74 Foot 369				
Driving Steel Piles Foot 369				
Underwater Structure Excavation Protection-Location 2 Each 1				

Reinforcement Bars designated (E) shall be epoxy coated.

Notes:
Space reinforcement in cap to miss anchor bolts.
Pour steps monolithically with cap.
For anchor bolt installation details, see sheet 11 of 17.
For bar splicer details see sheet 16 of 17.

PILE DATA

Type: HP 12x74
Nominal Required Bearing: 290 tons
Nominal Design Capacity: 181 tons
Est. Length: 41'
No. Req'd: 9+1 test pile

DESIGNED	MAB
CHECKED	PRT
DRAWN	PRT
CHECKED	MAB

HORNER & SHIFRIN, INC.
ENGINEERS ■ ARCHITECTS ■ PLANNERS

PIER 2
F.A.P. ROUTE 327 - SEC. 13B-2
MARION COUNTY
STATION 336+33.00
STRUCTURE NO. 061-0090