

STATE OF ILLINOIS
DEPARTMENT OF TRANSPORTATION
DIVISION OF HIGHWAYS
PLANS FOR PROPOSED
FEDERAL-AID S.T.R. PROGRAM
COUNTY HIGHWAY 8
WAYNE COUNTY
SECTION 02-00110-00-BR
STRUCTURE NO. 096-3439
PROJECT NO. ACRS-191(48)
JOB NO. C-97-025-05

INDEX OF SHEETS

- 1 COVER SHEET
- 2 PLAN & PROFILE
- 3 CROSS SECTIONS
- 4-11 BRIDGE PLANS

STANDARDS: 280001-02 - EROSION CONTROL
(SEE PROPOSAL) 702001-05 - TRAFFIC
BLR 21-6 - TRAFFIC
BLR 22-4 - TRAFFIC

SCALES

- PLAN 1 INCH = 50 FEET
- PROFILE HORZ. 1 INCH = 50 FEET
- PROFILE VERT. 1 INCH = 10 FEET
- CROSS SECTION 1 INCH = 5 FEET

QUANTITY	UNIT	ITEM	Y080-2A CODE NO.
96	CU.YD.	EARTH EXCAVATION	20200100
139	CU.YD.	CHANNEL EXCAVATION	20300100
2,252	CU.YD.	FURNISHED EXCAVATION	20400800
0.6	ACRE	SEEDING, CLASS 2 (SPECIAL)	25001000
6	EACH	TEMPORARY DITCH CHECKS	28000300
60	FOOT	PERIMETER EROSION BARRIER	28000400
144	TON	STONE DUMPED RIPRAP, CLASS A4	28100807
20	TON	STONE RIPRAP DITCH	28102600
451	TON	AGGREGATE BASE COURSE, TYPE B	35101400
40	TON	AGGREGATE SURFACE COURSE, TYPE B	40200800
1	EACH	REMOVAL OF EXISTING STRUCTURES	50100100
33.2	CU.YD.	CONCRETE STRUCTURES	50300225
2,240	SQ.FT.	PRECAST PRESTRESSED CONCRETE DECK BEAMS (17" DEPTH)	50400305
3,200	POUND	REINFORCEMENT BARS	50800105
160	FOOT	STEEL RAILING, TYPE S1	50900205
1,080	FOOT	FURNISHING STEEL PILES HP10X42	51201400
1,080	FOOT	DRIVING STEEL PILES	51202700
2	EACH	TEST PILE STEEL HP10X42	51203400
13.8	CU.YD.	CONCRETE ENCASEMENT	51204315
1	EACH	NAME PLATES	51500100
340	FOOT	PIPE CULVERTS, CLASS D, TYPE 1 24"	542D0229
2	EACH	AUTOMATIC FLAP GATE 24"	60802024
1	L SUM	TRAFFIC CONTROL AND PROTECTION	70101700
1	EACH	UNDERWATER STRUCTURE EXCAVATION PROTECTION - LOCATION 1	X5020501
1	EACH	UNDERWATER STRUCTURE EXCAVATION PROTECTION - LOCATION 2	X5020502
1	L SUM	MOBILIZATION	67100100
34	FOOT	PIPE CULVERTS, CLASS D, TYPE 1 12"	542D0217

FUNCTIONAL CLASS: LOCAL ROAD
ADT = 75

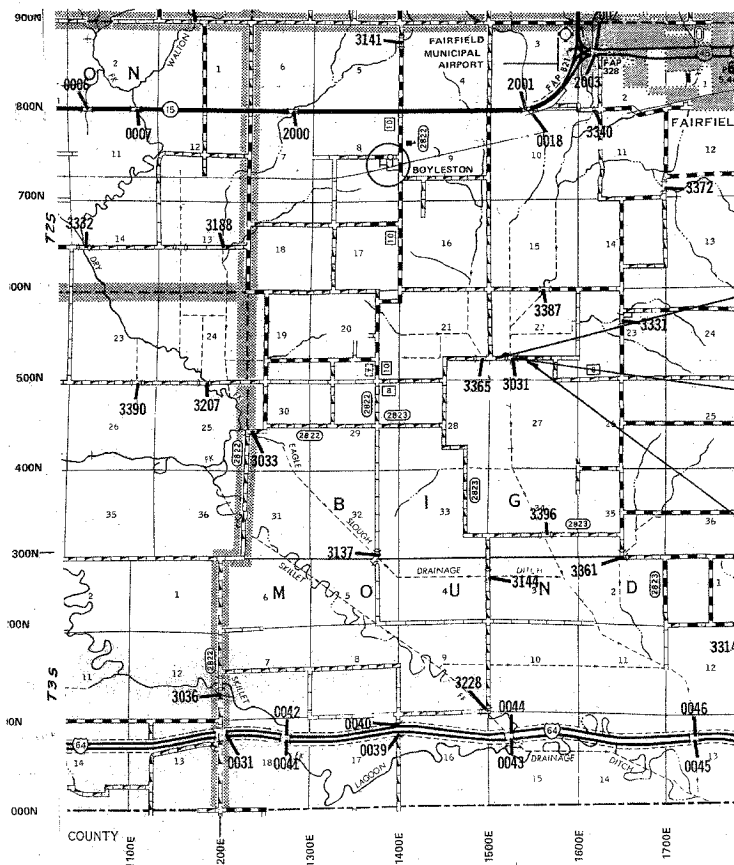

LOCATION MAP

APPROXIMATE SCALE: 1 INCH = 1 MILE
NET LENGTH = 525 L.F. = 0.099 MILES

SECTION 02-00110-00-BR
BEGINS STA. 2+00

STA. 4+78 - STD. BRIDGE DESIGN
PROPOSED PRECAST PRESTRESSED
CONCRETE DECK BEAM BRIDGE.
3 SPANS @ 25', 30', 25' 28' RDWY. SKEW = 0°
PROP. STR. NO. 096-3439
EXIST. STR. NO. 096-3031

SECTION 02-00110-00-BR
ENDS STA. 7+25

TOLL FREE JOINT UTILITY LOCATING
INFORMATION FOR EXCAVATORS (J.U.L.I.E.)
TELEPHONE NO. 1-800-892-0123

CONTRACT NO. 95424

PROFESSIONAL DESIGN FIRM #184-000832

Michael J. ... 4-07-05
ILLINOIS REGISTERED PROFESSIONAL ENGINEER # 31350
LICENSE EXPIRES NOVEMBER 30, 2005

APPROVED APRIL 7, 2005

Arthur J. ...
LOCAL AGENCY REPRESENTATIVE

PASSED 8-26, 2005

Maurice ...
DISTRICT SEVEN ENGINEER
OF LOCAL ROADS & STREETS

RELEASING FOR BID BASED ON LIMITED REVIEW

8-26, 2005

Christina ...
DEPUTY DIRECTOR OF HIGHWAYS
REGION FOUR ENGINEER
STATE OF ILLINOIS
DEPARTMENT OF TRANSPORTATION