

**INDEX OF SHEETS**

- 1 COVER SHEET
- 2 PLAN & PROFILE
- 3 CROSS SECTIONS
- 4-10 BRIDGE PLANS

STANDARDS: 280001-02 - EROSION CONTROL  
702001-05 - TRAFFIC  
BLR 21-6 - TRAFFIC  
BLR 22-4 - TRAFFIC

STATE OF ILLINOIS  
DEPARTMENT OF TRANSPORTATION  
DIVISION OF HIGHWAYS  
PLANS FOR PROPOSED  
FEDERAL-AID B.R.R. PROGRAM

LAWRENCE COUNTY  
SECTION 05-08132-00-BR  
PETTY ROAD DISTRICT  
STRUCTURE NO. 051-3277  
PROJECT NO. BROS-101(22)  
JOB NO. C-97-025-06

TR 31

SCALES

PLAN 1 INCH = 50 FEET  
PROFILE HORZ. 1 INCH = 50 FEET  
PROFILE VERT. 1 INCH = 10 FEET  
CROSS SECTION 1 INCH = 5 FEET

SUMMARY OF QUANTITIES

QTY	UNIT	ITEM	CODE NO
200	TON	AGGREGATE SURFACE COURSE, TYPE B (CA-6)	XX003658
85	TON	AGGREGATE SURFACE COURSE, TYPE B (CA-9)	XX003659
89	UNIT	TREE REMOVAL (4 TO 15 INCHS DIAMETER)	20100110
117	CU YD	EARTH EXCAVATION	20200100
76	CU YD	CHANNEL EXCAVATION	20300100
83	CU YD	FURNISHED EXCAVATION	20400800
3	CU YD	TRENCH BACKFILL	20800150
0.35	ACRE	SEEDING, CLASS 2 (SPECIAL)	25001000
6	EACH	TEMPORARY DITCH CHECKS	28000300
80	FOOT	PERIMETER EROSION BARRIER	28000400
101	TON	STONE DUMPED RIPRAP, CLASS A4	28100807
21	TON	STONE RIPRAP DITCH	28102600
1	EACH	REMOVAL OF EXISTING STRUCTURES	50100100
23.0	CU YD	CONCRETE STRUCTURES	50300225
1400	SQ FT	PRECAST PRESTRESSED CONCRETE DECK BEAMS (21" DEPTH)	50400405
2480	POUND	REINFORCEMENT BARS	50800105
100	FOOT	STEEL RAILING, TYPE S1	50900205
540	FOOT	FURNISHING METAL PILE SHELLS 12"	51201000
540	FOOT	DRIVING AND FILLING SHELLS	51202600
1	EACH	TEST PILE METAL SHELLS	51203200
2.6	CU YD	CONCRETE ENCASUREMENT	51204315
1	EACH	NAME PLATES	51500100
120	FOOT	PIPE CULVERTS, CLASS D, TYPE 1 15"	542D0220
40	FOOT	PIPE CULVERTS, CLASS D, TYPE 1 18"	542D0223
1	L. SUM	MOBILIZATION	67100100
1	L. SUM	TRAFFIC CONTROL AND PROTECTION	70101700

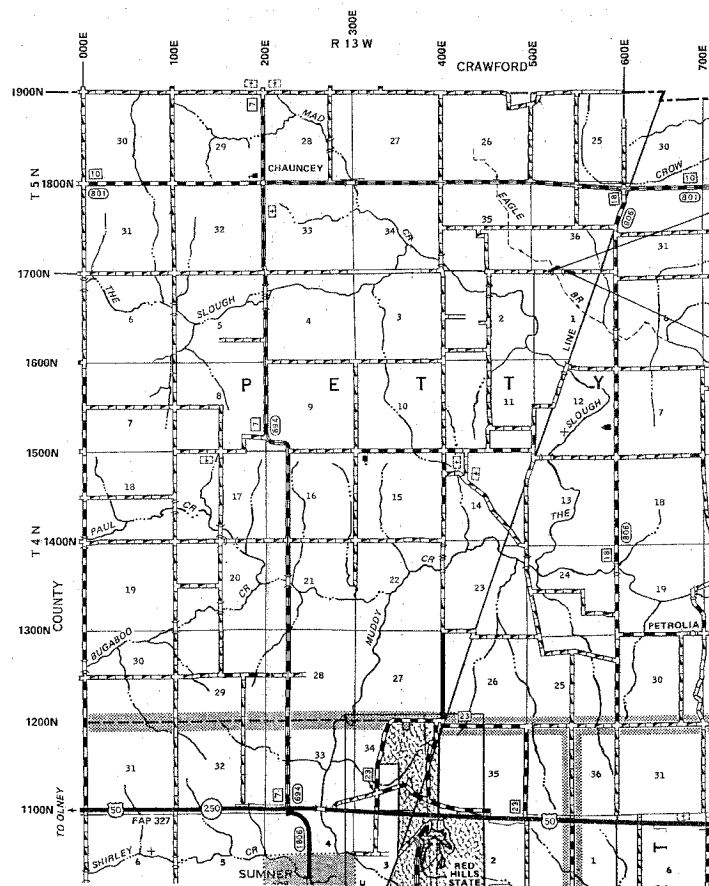

LOCATION MAP

APPROXIMATE SCALE: 1 INCH = 1 MILE  
NET LENGTH = 475 L.F. = 0.090MILES

SECTION 05-08132-00-BR  
BEGINS STA. 1+50

STA. 3+92 - STANDARD BRIDGE DESIGN  
PROPOSED PRECAST PRESTRESSED CONCRETE DECK  
BEAM BRIDGE. 1 SPAN @ 50'. 28' RDWY., SKEW = 30' RF  
EXISTING STR. NO. 051-3051  
PROPOSED STR. NO. 051-3277

SECTION 05-08132-00-BR  
ENDS STA. 6+25

FUNCTIONAL CLASS: RURAL LOCAL ROAD  
ADT = 75  
DESIGN SPEED = 30 MPH

CONTRACT NO. 95453

TOLL FREE JOINT UTILITY LOCATING  
INFORMATION FOR EXCAVATORS (J.U.L.I.E.)  
TELEPHONE NO. 1-800-892-0123

PROFESSIONAL DESIGN FIRM #184-000832

*Michael Connor* 10/20/2005  
ILLINOIS REGISTERED PROFESSIONAL ENGINEER # 31350  
LICENSE EXPIRES NOVEMBER 30, 2007

APPROVED 10/27, 2005

*[Signature]*  
LOCAL AGENCY REPRESENTATIVE

PASSED 12-23, 2005

*Michael E. Kestel*  
DISTRICT SEVEN ENGINEER  
OF LOCAL ROADS & STREETS

RELEASING FOR BID BASED ON LIMITED REVIEW

12/23, 2005

*Christina M. Reading*  
DEPUTY DIRECTOR OF HIGHWAYS  
REGION FOUR ENGINEER  
STATE OF ILLINOIS  
DEPARTMENT OF TRANSPORTATION