

ROUTE	SECTION	COUNTY	TOTAL SHEETS	SHEET NO.
F.A.S. 709	05-00085-00-BR	EFFINGHAM	13	1
CONTRACT NO. 95458		ILLINOIS	PROJECT BRS-709(103)	

STATE OF ILLINOIS
DEPARTMENT OF TRANSPORTATION
DIVISION OF HIGHWAYS

Joint Utility Locating Information for Excavators
JULIE 1-800-892-0123

PLANS FOR PROPOSED
BRIDGE REPLACEMENT & REHABILITATION PROGRAM

SECTION 05-00085-00-BR EFFINGHAM COUNTY

PROJECT BRS-709(103)
JOB NO. C-97-047-06

F.A.S. 709

INDEX OF SHEETS

SHEET	ITEM
1	COVER SHEET
2	SUMMARY OF QUANTITIES
3	ROADWAY PLAN AND PROFILE
4	GENERAL PLAN AND ELEVATION
5	STANDARD CS-3033-75L
6	STANDARD CB-3033-36
7	STANDARD CA-3033-10
8	STANDARD CR-TS1
9	STANDARD CN
10	STANDARD CX-1
11-13	CROSS SECTIONS

- STANDARD DRAWINGS
- STANDARD 000001-04
 - STANDARD 280001-02
 - STANDARD 542306
 - STANDARD 630001-05
 - STANDARD 631026-02
 - STANDARD 666001
 - STANDARD 702001-05
 - STANDARD BLR 21-6
 - STANDARD BLR 22-4
 - STANDARD BLR 23-1

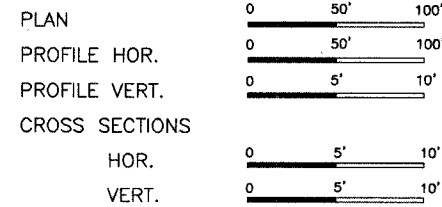

SECTION 05-00085-00-BR BEGINS STA. 3+84.00

SINGLE SPAN PRECAST PRESTRESSED CONCRETE DECK BEAM BRIDGE
 78'-6" BK.-BK. ABUTMENTS
 STEEL PILE SPILLTHROUGH ABUTMENTS
 30' DECK
 10' SKEW LT. FORWARD
 EXISTING STRUCTURE NO. 025-3009
 PROPOSED STRUCTURE NO. 025-3221

ELLIOTTSTOWN

SECTION 05-00085-00-BR ENDS STA. 6+16.00

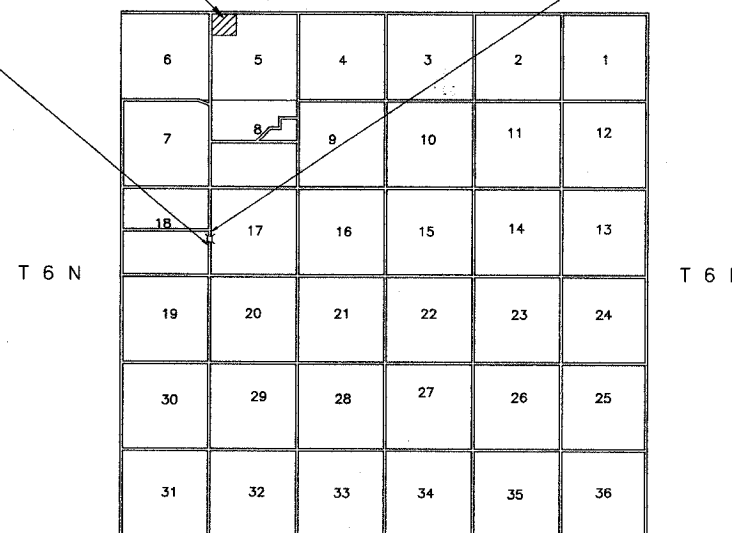

CONTRACT NO. 95458

RURAL MAJOR COLLECTOR
ADT = 550
DESIGN SPEED = 40 M.P.H.

NET LENGTH SECTION 05-00085-00-BR = 232.00 Ft. = 0.044 Mi.

Roger A. Charleston
 Ill. Reg. Prof. Eng. #29185
 12/14/05
 Lic. Expires 11/30/06

CHARLESTON ENGINEERING INC.
 105 N. KITCHELL
 P.O. BOX 397
 OLNEY, ILLINOIS 62450
 PH. 618-392-0736



APPROVED December 15 2005
[Signature]
 COUNTY ENGINEER

PASSED Jan 4 2006
[Signature]
 DISTRICT SEVEN ENGINEER OF
 LOCAL ROADS AND STREETS

Releasing For
 Bid Based on
 Limited Review
Jan 4 2006
[Signature]
 DEPUTY DIRECTOR OF HIGHWAYS
 REGION FOUR ENGINEER

STATE OF ILLINOIS
DEPARTMENT OF TRANSPORTATION