

CLOSED RUNWAY MARKER DETAIL
 N.T.S.

NOTES

1. MARKERS SHALL BE SOLID YELLOW.
2. MARKERS SHALL BE PAINTED BURLAP, PLYWOOD OR OTHER APPROVED SOLID MATERIALS.
3. CONTRACTOR SHALL MAINTAIN MARKERS.
4. COST OF FURNISHING, INSTALLING, MAINTAINING, RELOCATING AND REMOVING MARKERS SHALL BE INCIDENTAL TO THE CONTRACT.
5. MARKERS SHALL BE PLACED OVER EXISTING RUNWAY NUMERALS. HOWEVER, WHEN WORK IS NECESSARY FOR THAT AREA OR PAVEMENT IS OPEN TO TAXIING AIRCRAFT, THE MARKERS SHALL BE RELOCATED OFF THE PAVEMENT AS SHOWN ON THE DETAIL.

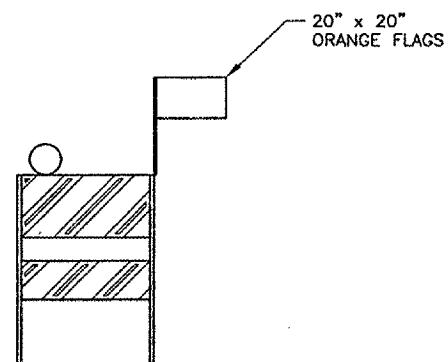

FLASHER BARRICADE DETAIL
 N.T.S.

FLASHER BARRICADE NOTES

1. FLASHERS TO BE BATTERY OPERATED. LENS TO BE RED AND BE ABLE TO ROTATE 90 DEGREES.
2. SANDBAGS TO BE PLACED ON EACH SUPPORT BRACE AS REQUIRED TO PREVENT DISPLACEMENT BY WIND, JET OR PROP BLAST.
3. NO SEPARATE PAYMENT WILL BE MADE FOR THIS ITEM. COSTS SHALL BE CONSIDERED INCIDENTAL TO THE PROJECT.
4. PLACE AT 20' INTERVALS.

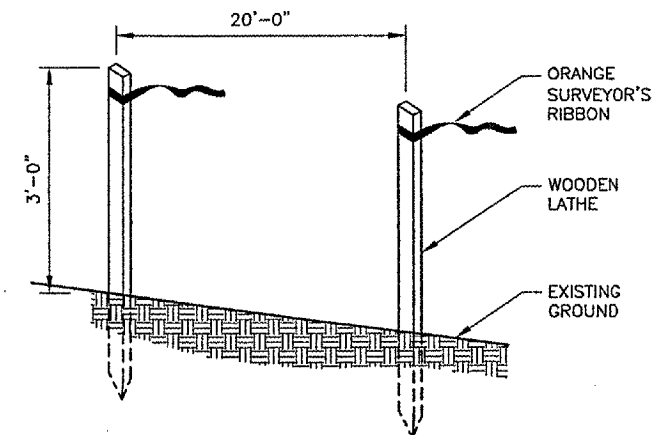

CONSTRUCTION SETBACK LINE DETAIL
 N.T.S.

CONTRACTOR ACCESS ROUTE NOTES

1. THE PROPOSED CONTRACTOR'S ACCESS ROUTE (EXISTING NORTHEAST PERIMETER ROAD) PAVEMENT STRUCTURE IS:
 - 3" BITUMINOUS SURFACE COURSE (PLACED 2005) - EXCELLENT CONDITION
 - 3" BITUMINOUS SURFACE COURSE (PLACED 1988)
 - 6" CRUSHED AGGREGATE BASE COURSE (PLACED 1988)
2. THE CONTRACTOR MAY USE THE EXISTING NORTHEAST PERIMETER ROAD FOR ACCESS IF HE FEELS THE PAVEMENT STRUCTURE IS SUFFICIENT TO SUPPORT HIS OPERATIONS WITHOUT DAMAGE OR DISTRESS.
3. IF THE CONTRACTOR ELECTS NOT TO USE THE EXISTING PERIMETER ROAD PAVEMENT, HE SHALL CONSTRUCT AN ACCESS ROUTE SUFFICIENT TO SUPPORT HIS OPERATIONS ON THE OUTSIDE (ROUTE 29 SIDE) OF THE EXISTING PERIMETER ROAD.
4. ALL PAVEMENTS OR TURF AREAS UTILIZED BY THE CONTRACTOR FOR AN ACCESS ROUTE, STAGING, OR STORAGE SHALL BE REPAIRED AND RESTORED TO THEIR ORIGINAL CONDITION TO THE SATISFACTION OF THE AIRPORT. NO ADDITIONAL COMPENSATION TO PROTECT, REPAIR, OR RESTORE THESE AREAS SHALL BE MADE.

REVISIONS		
NUMBER	BY	DATE

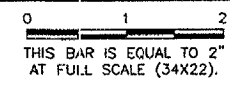

SPRINGFIELD AIRPORT AUTHORITY
ABRAHAM LINCOLN CAPITAL AIRPORT
SPRINGFIELD, ILLINOIS

WIDEN TAXIWAY A - CONSTRUCT PERIMETER ROAD
CONSTRUCTION ACTIVITY PLAN DETAILS

© Copyright CMT, Inc.
CMT
 CRAMFORD, MURPHY & TILLY, INC.
 CONSULTING ENGINEERS
 License No. 184-000518

DESIGN BY:	RLV
DRAWN BY:	DPA
CHECKED BY:	RLV
APPROVED BY:	RLV
DATE:	1/23/06
JOB No:	0503507
IL. PROJ. NO.	SPI-3555
AIP PROJ. NO.	3-17-0096-44
SHEET	07 OF 83 SHEETS