

KEYMAP

CA002

THIS SHEET

K:\SpringfieldAp\0503507\Draw\Sheets
 FILE: 18_PRJ0PIMP02.dwg
 UPDATE BY: Dave Allen
 PLOT DATE: 2/7/2006 9:23 AM
 BASE_PROGEO
 BASE_EXISTTOPO
 CAPDESIGNBASE
 KEY
 tbinfo

REVISIONS		
NUMBER	BY	DATE

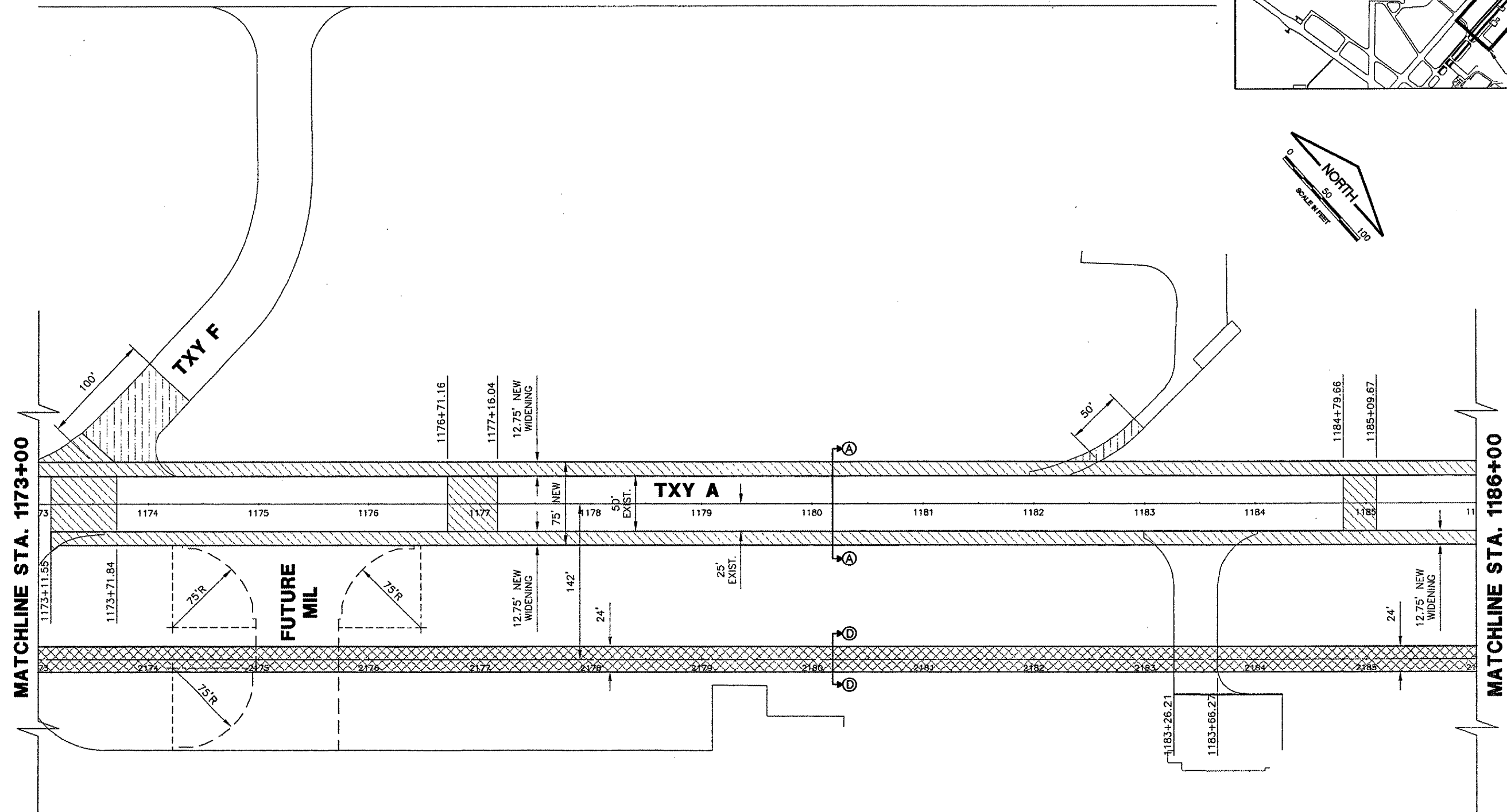
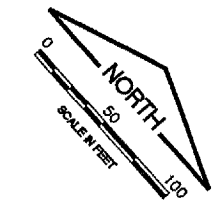
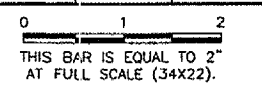

MATCHLINE STA. 1173+00

MATCHLINE STA. 1186+00

- LEGEND**
- NEW 13" PCC PAVEMENT (501)
4" CRUSHED AGGREGATE BASE COURSE (209)
 - NEW 1-1/2" BITUMINOUS SURFACE COURSE (401)
2-1/2" BITUMINOUS BASE COURSE (201)
6" CRUSHED AGGREGATE BASE COURSE (209)
 - NEW 1-1/2" BITUMINOUS TRANSITION (401)
 - FUTURE PAVEMENT

SPRINGFIELD AIRPORT AUTHORITY
 ABRAHAM LINCOLN CAPITAL AIRPORT
 SPRINGFIELD, ILLINOIS

**WIDEN TAXIWAY A - CONSTRUCT PERIMETER ROAD
 PROPOSED IMPROVEMENTS 2**

© Copyright CMT, Inc.
CMT
 CRAWFORD, MURPHY & TILLY, INC.
 CONSULTING ENGINEERS
 License No. 84-00683

DESIGN BY: RLV
 DRAWN BY: DPA
 CHECKED BY: *RLV*
 APPROVED BY: *RLV*
 DATE: 1/23/06
 JOB No: 0503507

IL PROJ. NO. SPI-3555
 AIP PROJ. NO. 3-17-0096-44
 SHEET 18 OF 83 SHEETS