

**LEGEND**

- EXISTING STAKE MOUNTED TAXIWAY LIGHT
- ◻ EXISTING BASE MOUNTED RUNWAY LIGHT
- ◻ EXISTING BASE MOUNTED TAXIWAY LIGHT
- ◻ NEW BASE MOUNTED TAXIWAY LIGHT
- ⊙ EXISTING FLUSH MOUNTED RUNWAY EDGE LIGHT
- RP ◻ EXISTING AIRFIELD SIGN (SIGN PANELS TO BE REPLACED)
- ◻ NEW AIRFIELD SIGN
- ⊙ NEW SPLICE CAN
- ▬ EXISTING DUCT BANK
- ▬ NEW DUCT BANK
- ▬ NEW 4" SPLIT DUCT
- - - EXISTING CABLE
- - - NEW CIRCUIT 5
- - - NEW RWY. 4/22 CIRCUIT
- R REMOVE

SIGN	STATION
22	72' RT.
23	NO CHANGE
24	NO CHANGE
25	NO CHANGE
26	24+86.30
27	NO CHANGE
28	NO CHANGE
29	NO CHANGE
30	NO CHANGE

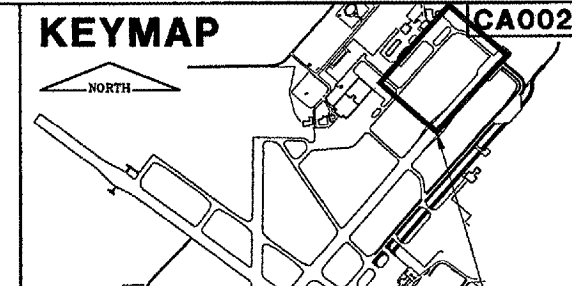

K:\SpringfieldAp\0503507\Draw\Sheets  
 FILE: 54\_ELEC04.dwg  
 UPDATE BY: Dave Allen  
 PLOT DATE: 2/6/2006 4:40 PM  
 thinfo  
 BASE\_PROJGEO  
 KEY  
 BASE\_PROPELEC  
 BASE\_EXISTTOPO  
 Capital\_Base

REVISIONS		
NUMBER	BY	DATE

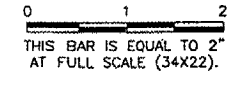

  
**SPRINGFIELD AIRPORT AUTHORITY**  
**ABRAHAM LINCOLN CAPITAL AIRPORT**  
**SPRINGFIELD, ILLINOIS**

**WIDEN TAXIWAY A - CONSTRUCT PERIMETER ROAD**  
**ELECTRICAL & LIGHTING PLAN 4**

© Copyright CMT, Inc.  
**CMT**  
 CRAWFORD, MURPHY & TILLY, INC.  
 CONSULTING ENGINEERS  
 License No. 184-000613

DESIGN BY: MB/KLB  
 DRAWN BY: DPA  
 CHECKED BY: *RW*  
 APPROVED BY: *RW*  
 DATE: 1/23/06  
 JOB No: 0503507  
 I.L. PROJ. NO. SPI-3555  
 AIP PROJ. NO. 3-17-0096-44  
 SHEET 54 OF 83 SHEETS

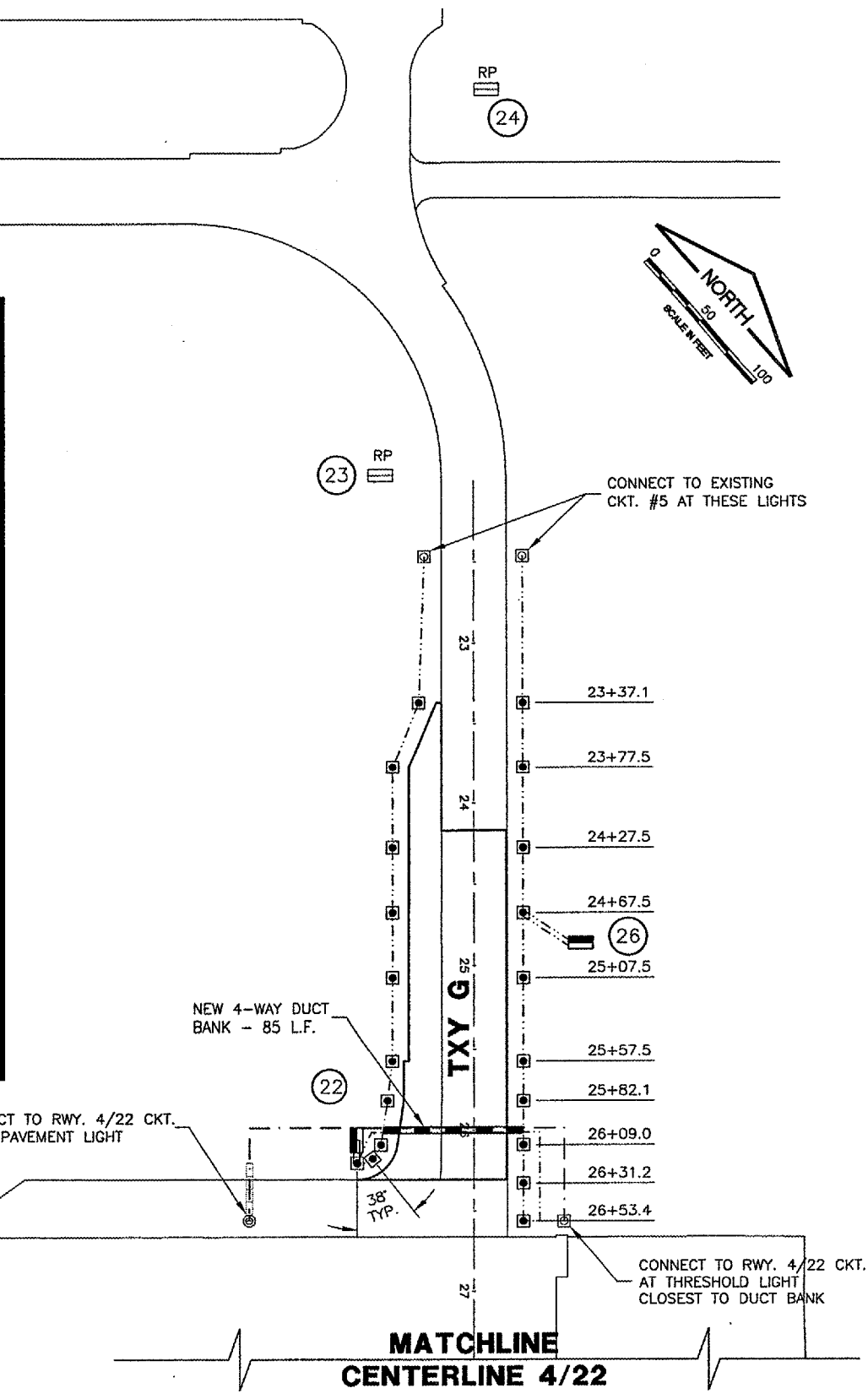
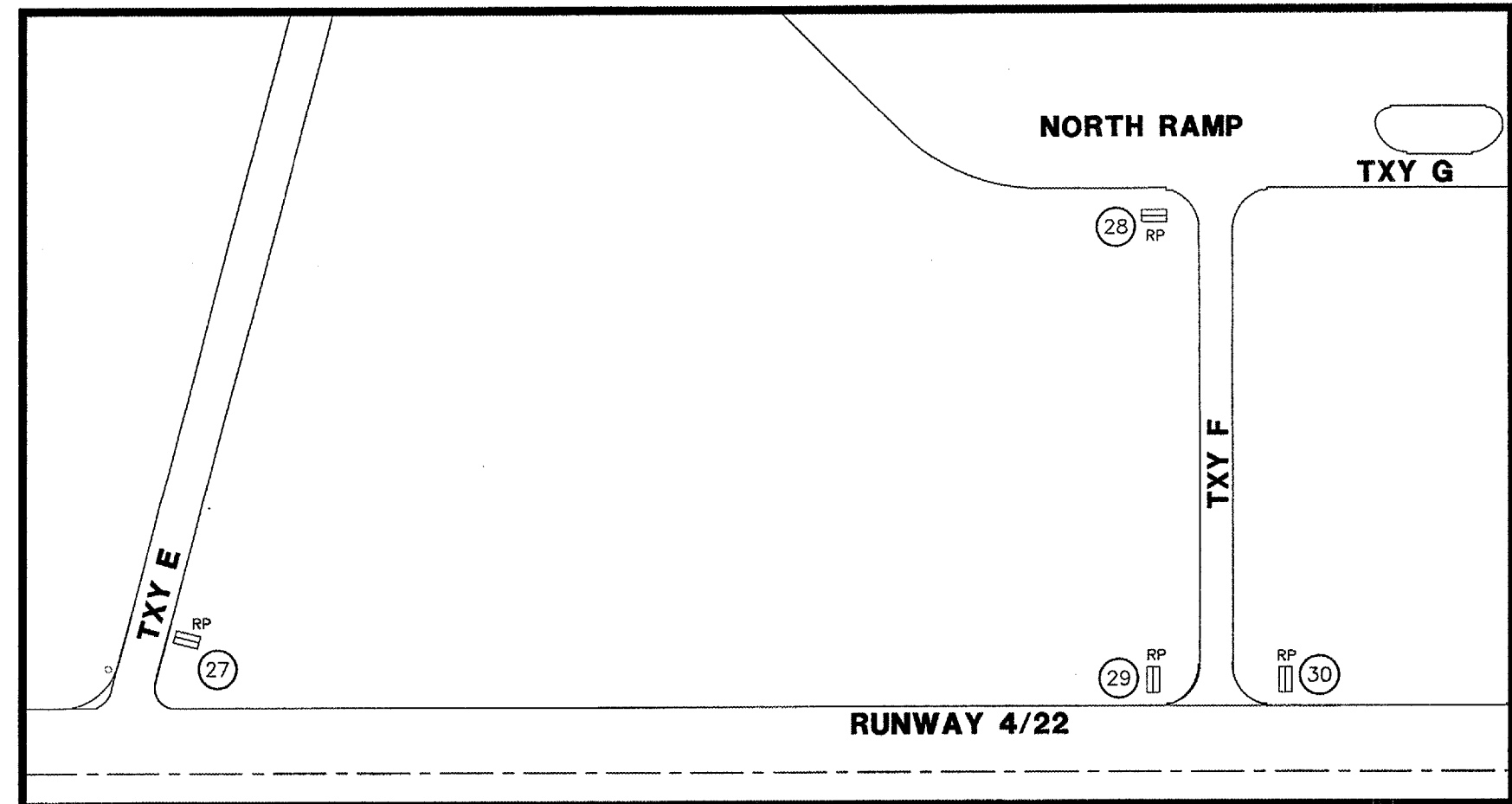

**MATCHLINE**  
**CENTERLINE 4/22**