

CA002

K:\Springfield\0503507\Draw\Sheets
FILE: 78_XSEC12.dwg
UPDATE BY: Dave Allen
PLOT DATE: 2/6/2006 5:42 PM
tbinfo
rc003002

REVISIONS		
NUMBER	BY	DATE

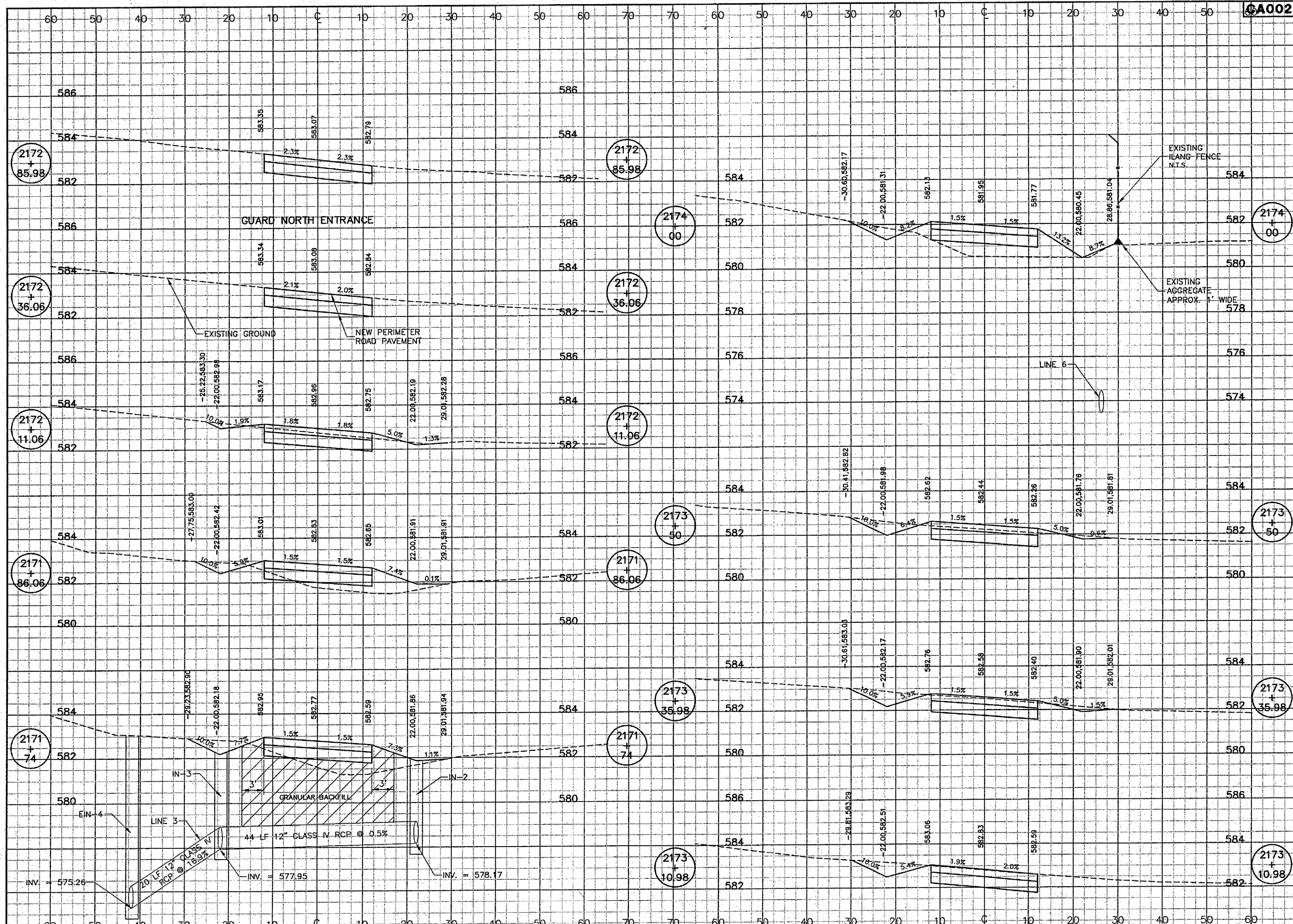
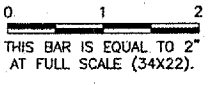

SPRINGFIELD AIRPORT AUTHORITY
ABRAHAM LINCOLN CAPITAL AIRPORT
SPRINGFIELD, ILLINOIS

WIDEN TAXIWAY A - CONSTRUCT PERIMETER ROAD
PERIMETER RD CROSS SECTIONS 3
STA. 2171+74 TO STA. 2174+00

© Copyright CMT, Inc.
CMT
CRAWFORD, MERRY & TILLY, INC.
CONSULTING ENGINEERS
License No. 184-000613

DESIGN BY: CBG
DRAWN BY: DPA
CHECKED BY: *RUN*
APPROVED BY: *RUN*
DATE: 1/23/06
JOB No: 0503507

IL PROJ. NO. SPI-3555
AIP PROJ. NO. 3-17-0095-44
SHEET 78 OF 83 SHEETS