

DU071

PATH: K:\DupageAp\0425704-Apron_
FILE: apron-econd2.dwg
UPDATE BY: johse
SURVEY BOOK #
XREF DWG:
XREF DWG:
DATE: Fri 12/10/04 9:51am

REVISIONS		
NUMBER	BY	DATE

0 1 2
THIS BAR IS EQUAL TO 2'
AT FULL SCALE (34X22).

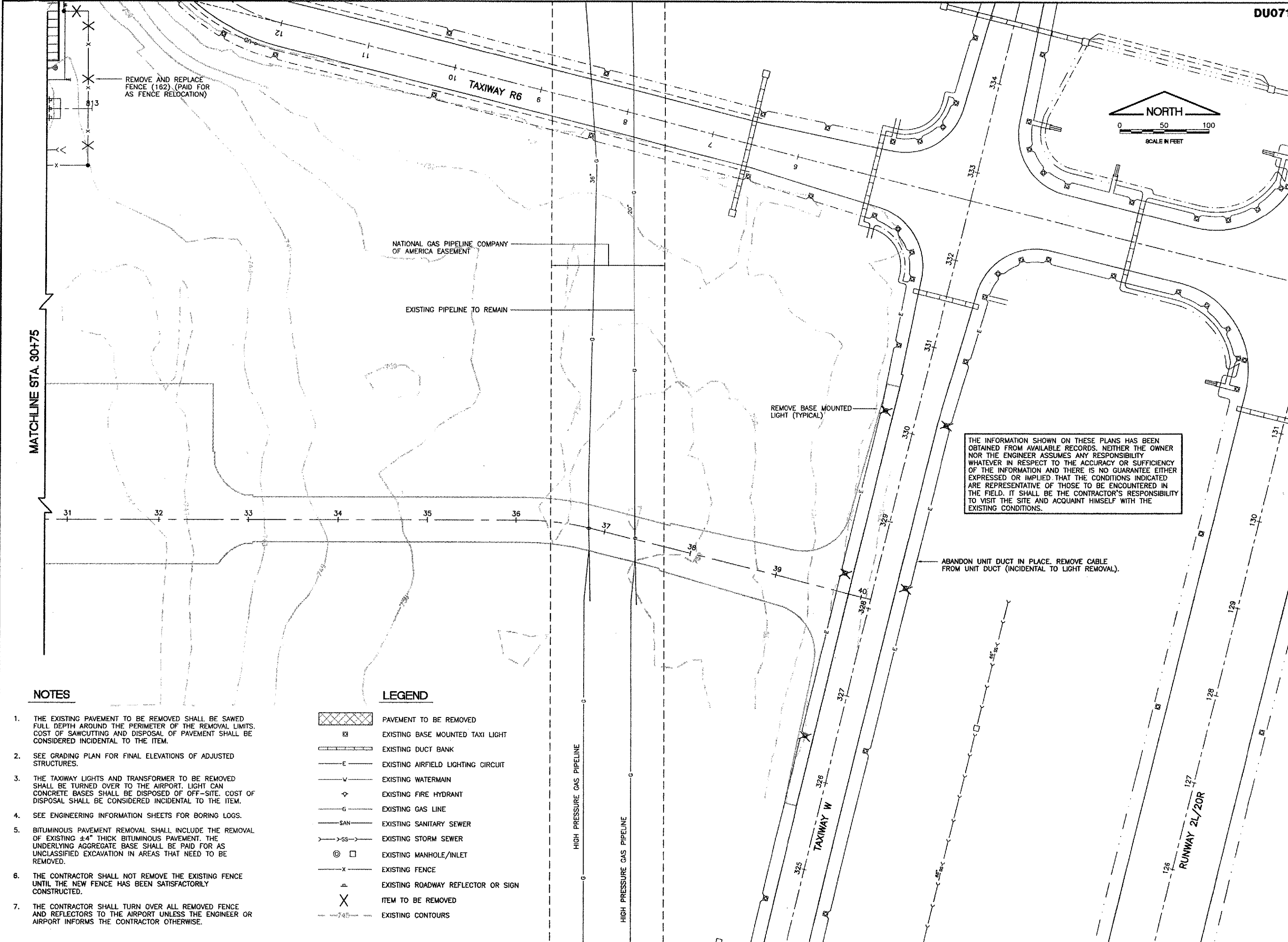
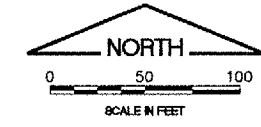

REMOVE AND REPLACE FENCE (182) (PAID FOR AS FENCE RELOCATION)

NATIONAL GAS PIPELINE COMPANY OF AMERICA EASEMENT

EXISTING PIPELINE TO REMAIN

REMOVE BASE MOUNTED LIGHT (TYPICAL)

THE INFORMATION SHOWN ON THESE PLANS HAS BEEN OBTAINED FROM AVAILABLE RECORDS. NEITHER THE OWNER NOR THE ENGINEER ASSUMES ANY RESPONSIBILITY WHATSOEVER IN RESPECT TO THE ACCURACY OR SUFFICIENCY OF THE INFORMATION AND THERE IS NO GUARANTEE EITHER EXPRESSED OR IMPLIED THAT THE CONDITIONS INDICATED ARE REPRESENTATIVE OF THOSE TO BE ENCOUNTERED IN THE FIELD. IT SHALL BE THE CONTRACTOR'S RESPONSIBILITY TO VISIT THE SITE AND ACQUAINT HIMSELF WITH THE EXISTING CONDITIONS.

ABANDON UNIT DUCT IN PLACE. REMOVE CABLE FROM UNIT DUCT (INCIDENTAL TO LIGHT REMOVAL).

MATCHLINE STA. 30+75

NOTES

1. THE EXISTING PAVEMENT TO BE REMOVED SHALL BE SAWED FULL DEPTH AROUND THE PERIMETER OF THE REMOVAL LIMITS. COST OF SAWCUTTING AND DISPOSAL OF PAVEMENT SHALL BE CONSIDERED INCIDENTAL TO THE ITEM.
2. SEE GRADING PLAN FOR FINAL ELEVATIONS OF ADJUSTED STRUCTURES.
3. THE TAXIWAY LIGHTS AND TRANSFORMER TO BE REMOVED SHALL BE TURNED OVER TO THE AIRPORT. LIGHT CAN CONCRETE BASES SHALL BE DISPOSED OF OFF-SITE. COST OF DISPOSAL SHALL BE CONSIDERED INCIDENTAL TO THE ITEM.
4. SEE ENGINEERING INFORMATION SHEETS FOR BORING LOGS.
5. BITUMINOUS PAVEMENT REMOVAL SHALL INCLUDE THE REMOVAL OF EXISTING ±4" THICK BITUMINOUS PAVEMENT. THE UNDERLYING AGGREGATE BASE SHALL BE PAID FOR AS UNCLASSIFIED EXCAVATION IN AREAS THAT NEED TO BE REMOVED.
6. THE CONTRACTOR SHALL NOT REMOVE THE EXISTING FENCE UNTIL THE NEW FENCE HAS BEEN SATISFACTORILY CONSTRUCTED.
7. THE CONTRACTOR SHALL TURN OVER ALL REMOVED FENCE AND REFLECTORS TO THE AIRPORT UNLESS THE ENGINEER OR AIRPORT INFORMS THE CONTRACTOR OTHERWISE.

LEGEND

- PAVEMENT TO BE REMOVED
- EXISTING BASE MOUNTED TAXI LIGHT
- EXISTING DUCT BANK
- EXISTING AIRFIELD LIGHTING CIRCUIT
- EXISTING WATERMAIN
- EXISTING FIRE HYDRANT
- EXISTING GAS LINE
- EXISTING SANITARY SEWER
- EXISTING STORM SEWER
- EXISTING MANHOLE/INLET
- EXISTING FENCE
- EXISTING ROADWAY REFLECTOR OR SIGN
- ITEM TO BE REMOVED
- EXISTING CONTOURS

**DUPAGE AIRPORT
WEST CHICAGO, ILLINOIS
SOUTH FLIGHT CENTER APRON - PHASE 4
EXISTING CONDITIONS/PROPOSED REMOVALS
SHEET 2**

© Copyright CMT, Inc.
CMT
CRAWFORD, MURPHY & TILLY, INC.
CONSULTING ENGINEERS
License No. 94-000613

DESIGN BY:	MJS/JRL
DRAWN BY:	JRO
CHECKED BY:	MJS / DKP
APPROVED BY:	MJS
DATE:	01/13/06
JOB No:	04257-04-00-00
A.I.P. PROJECT:	3-17-0017-B18
ILLINOIS PROJECT:	DPA-3391
SHEET 10 OF 36 SHEETS	