

VE044

K:\Danville\0504203\Draw\Sheets\
 FILE: 06_PROPIMP.dwg
 LAYOUT: PROPIMP
 UPDATE BY: adraughan
 SURVEY BOOK #
 DATE: Thu 1/12/06 2:54pm
 XREF DWG: C:\info.dwg
 DNV-EXISTBASE.DWG
 BASE_PROPGE0.dwg



REVISIONS		
NUMBER	BY	DATE

0 1 2
 THIS BAR IS EQUAL TO 2"
 AT FULL SCALE (34X22).

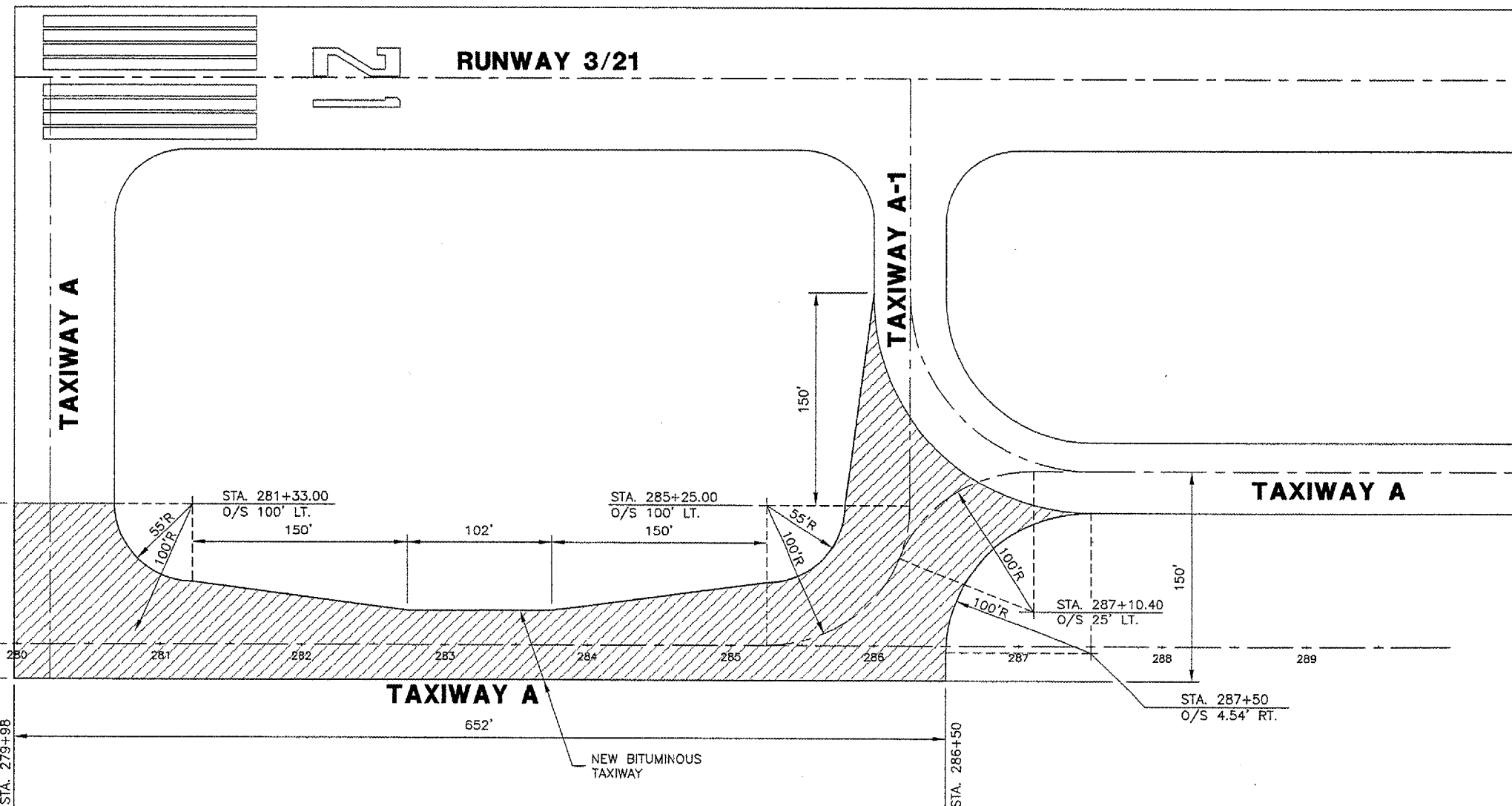

**VERMILION COUNTY AIRPORT
 DANVILLE, ILLINOIS**

**EXTEND PARALLEL TAXIWAY 600 FEET
 PROPOSED IMPROVEMENTS**

© Copyright CMT, Inc.

CMT
 CRAWFORD, MURPHY & TILLY, INC.
 CONSULTING ENGINEERS
 License No. 184-000613

DESIGN BY:	JEF
DRAWN BY:	DPA
CHECKED BY:	SMH
APPROVED BY:	JEF
DATE:	01/13/2006
JOB No:	05042-0300
ILLINOIS PROJECT DNV-3537	
A.I.P. PROJECT 3-17-0032-B10	
SHEET	06 OF 29 SHEETS