

F.A.P. RTE.	SECTION	COUNTY	TOTAL SHEETS	SHEET NO.
*	**	LEE	5	1

\*AMBOY MAINT YD  
\*\*D2 MAINT YARD 2023-02

D-92-054-23



LOCATION OF SECTION INDICATED THIS: - [shaded rectangle]

STATE OF ILLINOIS  
DEPARTMENT OF TRANSPORTATION  
DIVISION OF HIGHWAYS

**PROPOSED  
HIGHWAY PLANS**  
AMBOY MAINT YD  
SECTION D2 MAINT YD 2023-02  
LEE ISLAND COUNTY  
C-92-025-23

03-10-2023 LETTING ITEM 007

INDEX OF SHEETS

- 1 COVER SHEET /INDEX
- 2 GENERAL NOTES
- 3 SOQ
- 4 TYPICAL SECTION
- 5 PLAN SHEET

STATE STANDARDS

701901-08 TRAFFIC CONTROL DEVICES

PROJECT ENGINEER: SCOTT KULLERSTRAND

SQUAD LEADER: LANCE NICKLAUS 815-284-5407

PROJECT LOCATION  
AMBOY MAINTENANCE YARD

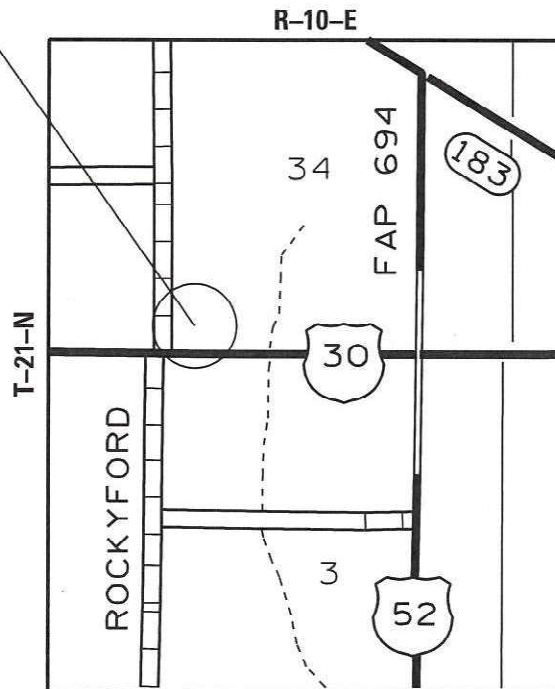

TOWNSHIP (SECTION):  
FRANKLIN GROVE (34)

J.U.L.I.E.  
JOINT UTILITY LOCATION INFORMATION FOR EXCAVATION  
1-800-892-0123

GROSS LENGTH OF PROJECT = 0 FOOT = 0.0 MILES  
NET LENGTH OF PROJECT = 0 FOOT = 0.0 MILES

CONTRACT NO. 64S22

STATE OF ILLINOIS  
DEPARTMENT OF TRANSPORTATION  
DIVISION OF HIGHWAYS

SUBMITTED November 21, 20 22

[Signature]  
REGION ENGINEER

February 3, 2023  
[Signature]  
ENGINEER OF DESIGN AND ENVIRONMENT

February 3, 2023  
[Signature]  
DIRECTOR OF HIGHWAYS PROJECT IMPLEMENTATION

# GENERAL NOTES

The following Mixture Requirements are applicable for this project:

Location and Mixture Use(s):	Surface		
PG:	PG 58-28		
Design Air Voids:	4.0 @ N50		
Mixture Composition:	IL 9.5 FG		
Friction Aggregate:	C		
Mixture Weight:	112 lbs / sy / in		
Quality Management Program:	QC / QA		
Sublot Size:			
Material Transfer Device			

IDOT is not a member of JULIE. If you are near any overhead lighting, intersection lighting or traffic signals, contact the IDOT Traffic Office at 815/284-5469 at least 48 hours prior to work.

The contractor shall have the option to either keep the millings or leave the millings at the yards. If the contractor chooses to keep the millings, they shall be hauled off site by the contractor. If the contractor chooses to leave the millings at the yard, IDOT shall provide the trucking for the millings. If the contractor is going to leave the millings at the yard, the contractor shall contact the OS1 or field engineer for the area one week prior to the milling operations begin.

Before work starts at the Amboy yard, the contractor shall contact the OS1 or field engineer for Lee County two weeks before work shall begin to give the Amboy yard time to prep areas to be surfaced.

The contractor shall place temporary ramps at locations as directed by the engineer. The millings shall be used to form the temporary ramps. Temporary ramps shall not be paid for separately but shall be included in the cost of HOT-MIX ASPHALT SURFACE REMOVAL of the thickness specified.

FILE NAME = 64S22.GN.DOCX	USER NAME =	DESIGNED - Engineering Systems	REVISED -	<b>STATE OF ILLINOIS DEPARTMENT OF TRANSPORTATION</b>	<b>GENERAL NOTES</b>	ROUTE	SECTION	COUNTY	TOTAL SHEETS	SHEET NO.	
	PLOT SCALE =	DRAWN -	REVISED -			Amboy Maint Yd	Section D2 Maint Yd 2023-02	Lee County			1
	PLOT DATE = 11/21/2022 3:23 PM	CHECKED -	REVISED -			SCALE:      SHEET NO.    OF    SHEETS    STA.            TO STA.		ILLINOIS	CONTRACT NO. 64S22		FED. AID PROJECT
	DATE - 11/15/2022 8:21 AM	REVISED -									

**SUMMARY OF QUANTITIES**

Amboy Maint Yd  
SECTION D2 Maint Yd 2023-02  
Lee COUNTY  
CONTRACT # 64S22  
SHEET 3 OF 5

100% State  
0005

CODE NO.	ITEM	UNIT	TOTAL QUANTITY
40600290	BITUMINOUS MATERIALS (TACK COAT)	POUND	8198
40603415	HOT-MIX ASPHALT SURFACE COURSE, IL 9.5 FG, N50	TON	2040
44000161	HOT-MIX ASPHALT SURFACE REMOVAL 3"	SQ YD	8092
67100100	MOBILIZATION	L SUM	1

# AMBOY YARD

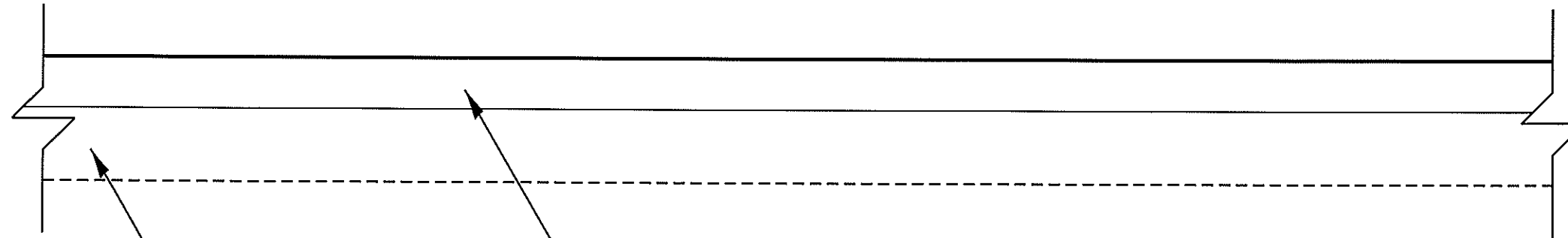

EXISTING HMA (1.5-3.5 INCH THICKNESS)

EXISTING AGGREGATE SUB-BASE  
(12-13 INCH THICKNESS)

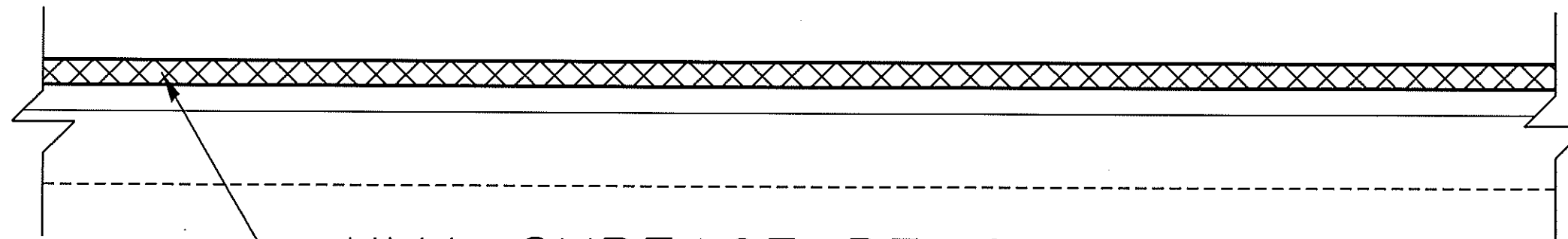

HMA SURFACE REMOVAL 3"  
3" HMA SURFACE COURSE, IL 9.5 FG ,N50  
(PLACED IN TWO LIFTS)

MODEL: Default  
 FILE: C:\Users\lance.nicklaus\FY 23\Main\Amboy Yard\00172-5.dwg

USER NAME = Lance.Nicklaus	DESIGNED - _____	REVISED - _____
PLOT SCALE = 102.9963' / in.	DRAWN - _____	REVISED - _____
PLOT DATE = Nov-22-2022 07:04:30 AM	CHECKED - _____	REVISED - _____
	DATE - _____	REVISED - _____

STATE OF ILLINOIS  
DEPARTMENT OF TRANSPORTATION

SCALE _____	SHEET _____	OF _____	SHEETS _____	STA. _____	TO STA. _____
-------------	-------------	----------	--------------	------------	---------------

AMBOY MAINT YD					
RTE.	SECTION	COUNTY	TOTAL SHEETS	SHEET NO.	
*	D2 MAINT YD 2023-02	LEE	5	4	
			CONTRACT NO. 64522		
ILLINOIS FED. AID PROJECT					

# AMBOY YARD

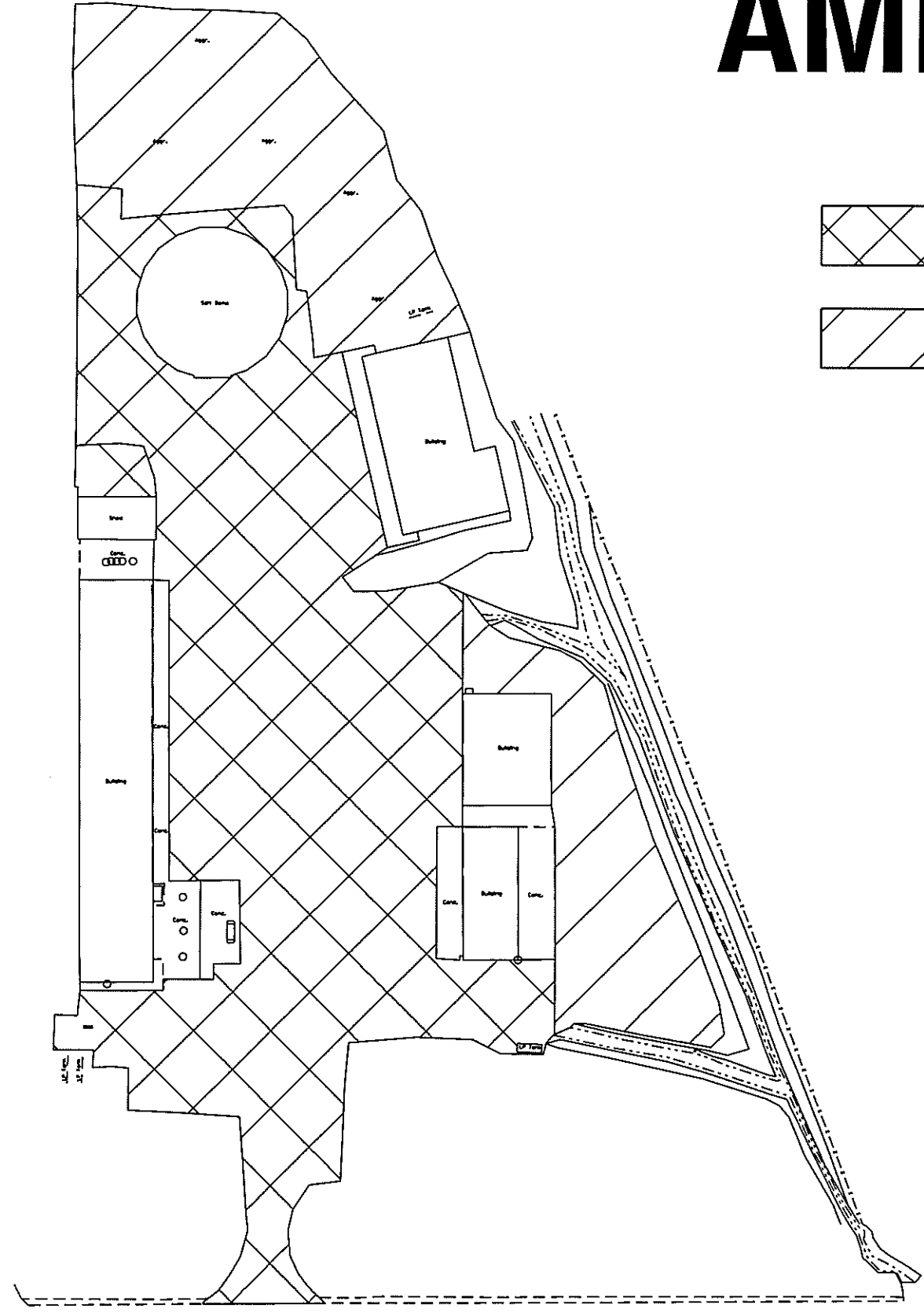

AREA TO BE MILLED AND RESURFACED

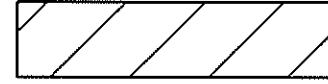

AREA TO BE RESURFACED NO MILLING  
PREP WORK TO BE DONE BY THE YARD

US30

MODEL: Default  
FILE NAME: S:\Projects\231\Amboy\Amboy\_231\Amboy.dwg  
PLOT DATE: 10/18/2022 07:33:04 AM

USER NAME = Lance Nicklaus PLOT SCALE = 109.9963' / in. PLOT DATE = Oct-18-2022 07:33:04 AM		DESIGNED - _____ DRAWN - _____ CHECKED - _____ DATE - _____		REVISED - _____ REVISED - _____ REVISED - _____ REVISED - _____		<b>STATE OF ILLINOIS DEPARTMENT OF TRANSPORTATION</b>		SCALE: _____ SHEET _____ OF _____ SHEETS STA. _____ TO STA. _____		<b>AMBOY MAINT YD</b>	
RTE.	SECTION	COUNTY	TOTAL SHEETS	SHEET NO.							
*	D2 MAINT YARD 2023-02	LEE	5	5							
			CONTRACT NO. 64S22								
ILLINOIS FED. AID PROJECT											