

STATE OF ILLINOIS
DEPARTMENT OF TRANSPORTATION

F.A.I. RTE.	SECTION	COUNTY	TOTAL SHEETS	SHEET NO.
64	82-(5,6,7)PP-1	ST. CLAIR	14	1
		ILLINOIS	CONTRACT NO. 76R48	

FOR INDEX OF SHEETS, SEE SHEET NO. 2

PROPOSED HIGHWAY PLANS

FAI ROUTE 64 (I-64)
SECTION 82-(5,6,7)PP-1
PROJECT
PAVEMENT PATCHING
ST. CLAIR COUNTY

C-98-123-22

D-98-091-22



FAI 64 ADT
IL 157 TO IL 159
2023 = 89,000 (ESTIMATED)
SU = 2.4% MU = 10.2%

FAI 64 ADT
IL 159 TO WEST HWY 50
2023 = 79,700 (ESTIMATED)
SU = 2.4% MU = 11.3%

FAI 64 ADT
WEST HWY 50 TO GREENMOUNT RD
2023 = 64,900 (ESTIMATED)
SU = 2.4% MU = 13.6%

FAI 64 ADT
GREENMOUNT RD TO IL 158
2023 = 58,200 (ESTIMATED)
SU = 2.5% MU = 15.1%

FUNCTIONAL CLASSIFICATION:
INTERSTATE

BEGIN PROJECT
0.5 MILES WEST OF IL 159
STA. 510+00
LAT: 38.59998° N
LONG: 89.99418° W

BRIDGE OMISSION
SN 082-0308 (EB) &
SN 082-0309 (WB)
STA 589+97 TO
STA 591+49

STATION EQUATION
STA. 618+20.65 (BK) =
STA. 643+85.18 (AH)

END PROJECT
0.5 MILES EAST OF GREENMOUNT RD
STA. 782+27
LAT: 38.57478° N
LONG: 89.92013° W

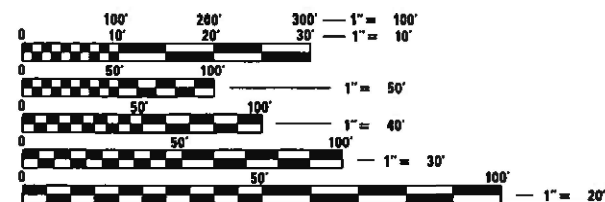

FULL SIZE PLANS HAVE BEEN PREPARED USING STANDARD ENGINEERING SCALES. REDUCED SIZED PLANS WILL NOT CONFORM TO STANDARD SCALES. IN MAKING MEASUREMENTS ON REDUCED PLANS, THE ABOVE SCALES MAY BE USED.

J.U.L.I.E.
JOINT UTILITY LOCATION INFORMATION FOR EXCAVATORS
1-800-892-0123
OR 811

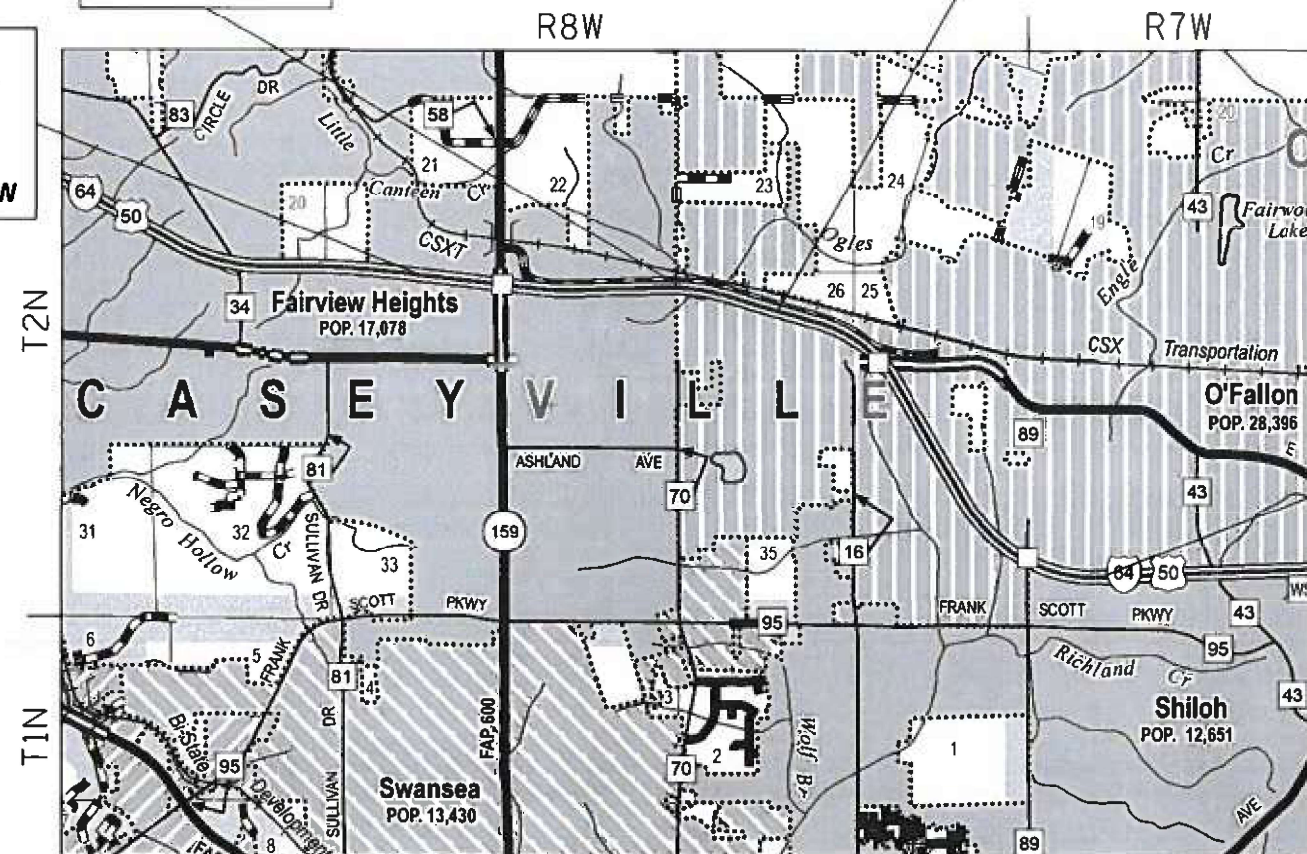

LOCATION MAP
NOT TO SCALE

GROSS LENGTH = 24,662 FT. = 4.671 MILE
NET LENGTH = 24,662 FT. = 4.671 MILE

PROJECT ENGINEER: BILLIE OWEN
PROJECT MANAGER: BRANDON HUMPHREYS

CONTRACT NO. 76R48

STATE OF ILLINOIS
DEPARTMENT OF TRANSPORTATION

SUBMITTED *[Signature]* 20 *[Signature]*
[Signature] REGIONAL ENGINEER
February 3, 2023
[Signature]
ENGINEER OF DESIGN AND ENVIRONMENT
February 3, 2023
[Signature]
DIRECTOR OF HIGHWAYS PROJECT IMPLEMENTATION

PRINTED BY THE AUTHORITY
OF THE STATE OF ILLINOIS

INDEX OF SHEETS

1. COVER SHEET
2. INDEX OF SHEETS, HIGHWAY STANDARDS, GENERAL NOTES, & COMMITMENTS
3. SUMMARY OF QUANTITIES
- 4-11. TYPICAL SECTIONS
12. LOCATION MAP SHEET
- 13-14. CLASS A PATCHES, SPECIAL

HIGHWAY STANDARDS

000001-08	STANDARD SYMBOLS, ABBREVIATIONS AND PATTERNS
001001-02	AREAS OF REINFORCEMENT BARS
001006	DECIMAL OF AN INCH AND OF A FOOT
420001-10	PAVEMENT JOINTS
442001-04	CLASS A PATCHES
701400-11	APPROACH TO LANE CLOSURE, FREEWAY/EXPRESSWAY
701401-13	LANE CLOSURE, FREEWAY/EXPRESSWAY
701411-09	LANE CLOSURE, MULTILANE, AT ENTRANCE OR EXIT RAMP, FOR SPEEDS \geq 45 MPH
701426-09	LANE CLOSURE, MULTILANE, INTERMITTENT OR MOVING OPER., FOR SPEEDS \geq 45 MPH
701428-01	TRAFFIC CONTROL SETUP AND REMOVAL FREEWAY/EXPRESSWAY
701446-11	TWO LANE CLOSURE, FREEWAY/EXPRESSWAY
701901-08	TRAFFIC CONTROL DEVICES
780001-05	TYPICAL PAVEMENT MARKINGS
781001-04	TYPICAL APPLICATIONS RAISED REFLECTIVE PAVEMENT MARKERS

GENERAL NOTES

1. THE UTILITIES KNOWN TO HAVE FACILITIES WITHIN THE PROJECT AREA ARE AS FOLLOWS:
 - AMEREN ILLINOIS
 - AT&T ILLINOIS
 - BUCKEYE PARTNERS L.P. -- WOOD RIVER PIPELINE
 - VILLAGE OF CASEYVILLE
 - CHARTER COMMUNICATIONS, INC.
 - CLEARWAVE FIBER LLC
 - EVERSTREAM GLC HOLDING COMPANY LLC
 - EXTENET SYSTEMS, INC.
 - CITY OF FAIRVIEW HEIGHTS
 - FIDELITY COMMUNICATIONS III, INC.
 - VERIZON BUSINESS
 - CITY OF O'FALLON
 - VILLAGE OF SHILOH
 - ST. CLAIR COUNTY
 - WINDSTREAM KDL, INC.
2. NO SURVEY WAS PERFORMED FOR THIS PROJECT AND THE PLANS WERE CREATED USING MICROFILM AND FIELD MEASUREMENTS.
3. THE RESIDENT ENGINEER SHALL VERIFY THE EXISTENCE OF HIGHWAY LIGHTING, INTELLIGENT TRANSPORTATION SYSTEMS (I.T.S.) UTILITIES, AND/OR ELECTRICAL CABLES ASSOCIATED WITH TRAFFIC SIGNALS WITHIN THE PROJECT LIMITS. IF ANY OF THESE EXIST WITHIN THE PROJECT LIMITS, AND IF THESE ITEMS REQUIRE LOCATING, THE CONTRACTOR SHALL BE DIRECTED TO DO SO ACCORDING TO SECTION 803 OF THE STANDARD SPECIFICATIONS. THIS WORK SHALL BE PAID FOR ACCORDING TO ARTICLE 109.04 OF THE STANDARD SPECIFICATIONS.
4. EIGHT CHANGEABLE MESSAGE SIGNS SHALL BE REQUIRED FOR THIS PROJECT. THEY WILL BE REQUIRED TWO WEEKS PRIOR TO ANY LANE CLOSURE. LOCATIONS SHALL BE AT THE DIRECTION OF THE RESIDENT ENGINEER.
5. THE DEPARTMENT STRONGLY ENCOURAGES THE PRIME CONTRACTOR AND THEIR APPROVED SUB-CONTRACTORS TO HIRE MINORITY, WOMEN AND DISADVANTAGED INDIVIDUALS FROM ITS FEDERALLY FUNDED HIGHWAY CONSTRUCTION CAREERS TRAINING PROGRAM (HCCTP) TO HELP MEET WORKFORCE AND TRAINEE GOALS. THIS PROGRAM IS TRAINING MINORITIES, WOMEN AND DISADVANTAGED INDIVIDUALS IN HIGHWAY CONSTRUCTION-RELATED SKILLS, E.G., MATH FOR THE TRADES, JOB READINESS, TECHNICAL SKILLS COURSEWORK (CARPENTRY, CONCRETE FLATWORK, BLUEPRINT READING, SITE PLANS, SITE WORK, TOOLS USE, ETC.) AND OSHA 10 HOUR CERTIFICATION, TO PREPARE THEM FOR A CAREER IN THE HIGHWAY CONSTRUCTION TRADES. GRADUATES ARE WELL-TRAINED AND READY TO BECOME PRODUCTIVE ENTRY-LEVEL CONSTRUCTION WORKERS. CONTACT THE DISTRICT 8 EEO OFFICE AT 618-346-3360 AND/OR THE HCCTP COORDINATOR AT 618-874-6528 TO LEARN MORE ABOUT THE PROGRAM AND ASSISTANCE IN MEETING WORKFORCE AND TRAINEE GOALS.
6. THE FOLLOWING MIXTURE REQUIREMENTS ARE APPLICABLE FOR THIS PROJECT:

MIXTURE USE	PARTIAL DEPTH PATCH
AC/PG	PG 64-22
DESIGN AIR VOIDS	4.0% @ Ndes=90
MIX COMPOSITION (GRADATION)	IL 9.5
FRICITION AGG	MIXTURE "E"
QUALITY MGMT PROGRAM	QC/QA
MATERIAL TRANSFER DEVICE REQUIRED	NO

PLAN QUANTITIES FOR HOT-MIX ASPHALT ITEMS ARE CALCULATED USING A UNIT WEIGHT OF 112 LBS/SQ YD/IN

COMMITMENTS

NONE

REV. - MS

MODEL: Default
 FILE NAME: P:\Project-24\benley.com\PI\DOT\Documents\DOT Offices\Dir\c. E\Project\087648\CAD\DATA\CAD\Sheet\087648-ht-generate.dgn

USER NAME = Brandon.Humphreys	DESIGNED -	REVISED -	STATE OF ILLINOIS DEPARTMENT OF TRANSPORTATION	INDEX OF SHEETS, HIGHWAY STANDARDS, GENERAL NOTES, AND COMMITMENTS	F.A.I. RTE.	SECTION	COUNTY	TOTAL SHEETS	SHEET NO.
DRAWN -	REVISIED -	64			82-(5,6,7)PP-1	ST. CLAIR	14	2	
PLOT SCALE = 40.0000 ' / in.	CHECKED -	REVISIED -			CONTRACT NO. 76R48				
PLOT DATE = 12/22/2022	DATE -	REVISIED -			SCALE: SHEET OF SHEETS STA. TO STA.				
					ILLINOIS FED. AID PROJECT				

CODE NO.	ITEM	UNIT	TOTAL QUANTITY	CONSTR. CODE
				100% STATE ROADWAY
				0006 URBAN
44213000	PATCHING REINFORCEMENT	SQ YD	760	760
44213200	SAW CUTS	FOOT	2384	2384
44213204	TIE BARS 3/4"	EACH	140	140
67100100	MOBILIZATION	L SUM	1	1
70100420	TRAFFIC CONTROL AND PROTECTION, STANDARD 701411	EACH	14	14
70100800	TRAFFIC CONTROL AND PROTECTION, STANDARD 701401	L SUM	1	1
70100815	TRAFFIC CONTROL AND PROTECTION, STANDARD 701446	L SUM	1	1
70107025	CHANGEABLE MESSAGE SIGN	CAL DA	336	336
70200100	NIGHTTIME WORK ZONE LIGHTING	L SUM	1	1
70300100	SHORT TERM PAVEMENT MARKING	FOOT	4656	4656
70300150	SHORT TERM PAVEMENT MARKING REMOVAL	SQ FT	1552	1552
* 78001130	PAINT PAVEMENT MARKING - LINE 6"	FOOT	12800	12800
* 78100100	RAISED REFLECTIVE PAVEMENT MARKER	EACH	1280	1280
78300200	RAISED REFLECTIVE PAVEMENT MARKER REMOVAL	EACH	1280	1280
Ø Z0076604	TRAINEES TRAINING PROGRAM GRADUATE	HOUR	500	500

CODE NO.	ITEM	UNIT	TOTAL QUANTITY	CONSTR. CODE
				100% STATE ROADWAY
				0006 URBAN
X1700051	CLASS A PATCHES, TYPE IV, 15 INCH (SPECIAL)	SQ YD	120	120
X1700052	CLASS A PATCHES, TYPE II, 12 INCH (SPECIAL)	SQ YD	22	22
X1700055	CLASS A PATCHES, TYPE II, 13 INCH (SPECIAL)	SQ YD	22	22
X1700056	CLASS A PATCHES, TYPE III, 13 INCH (SPECIAL)	SQ YD	48	48
X1700057	CLASS A PATCHES, TYPE IV, 13 INCH (SPECIAL)	SQ YD	120	120
X1700079	CLASS A PATCHES, TYPE III, 12 INCH (SPECIAL)	SQ YD	48	48
X4405020	LONGITUDINAL PARTIAL DEPTH REMOVAL 2"	FOOT	50630	50630
X4420579	CLASS A PATCHES, TYPE IV, 12 INCH (SPECIAL)	SQ YD	120	120
X4420621	CLASS A PATCHES, TYPE II, 14 INCH (SPECIAL)	SQ YD	22	22
X4420624	CLASS A PATCHES, TYPE III, 14 INCH (SPECIAL)	SQ YD	48	48
X4420628	CLASS A PATCHES, TYPE IV, 14 INCH (SPECIAL)	SQ YD	120	120
X4420630	CLASS A PATCHES, TYPE II, 15 INCH (SPECIAL)	SQ YD	22	22
X4420632	CLASS A PATCHES, TYPE III, 15 INCH (SPECIAL)	SQ YD	48	48
X4420900	LONGITUDINAL PARTIAL DEPTH PATCHING	TON	1261	1261

* SPECIALTY ITEM

Ø 0042

REV. - MS

MODEL: D:\default...
 FILE: M:\...
 PROJECT: ...

USER NAME = Brandon.Humphreys	DESIGNED -	REVISED -
	DRAWN -	REVISED -
PLOT SCALE = 40.0000' / in.	CHECKED -	REVISED -
PLOT DATE = 12/21/2022	DATE -	REVISED -

**STATE OF ILLINOIS
DEPARTMENT OF TRANSPORTATION**

SUMMARY OF QUANTITIES

SCALE: SHEET 1 OF 1 SHEETS STA. TO STA.

F.A.I. RTE.	SECTION	COUNTY	TOTAL SHEETS	SHEET NO.
64	82-(5,6,7)PP-1	ST. CLAIR	14	3
ILLINOIS FED. AID PROJECT			CONTRACT NO. 76R48	

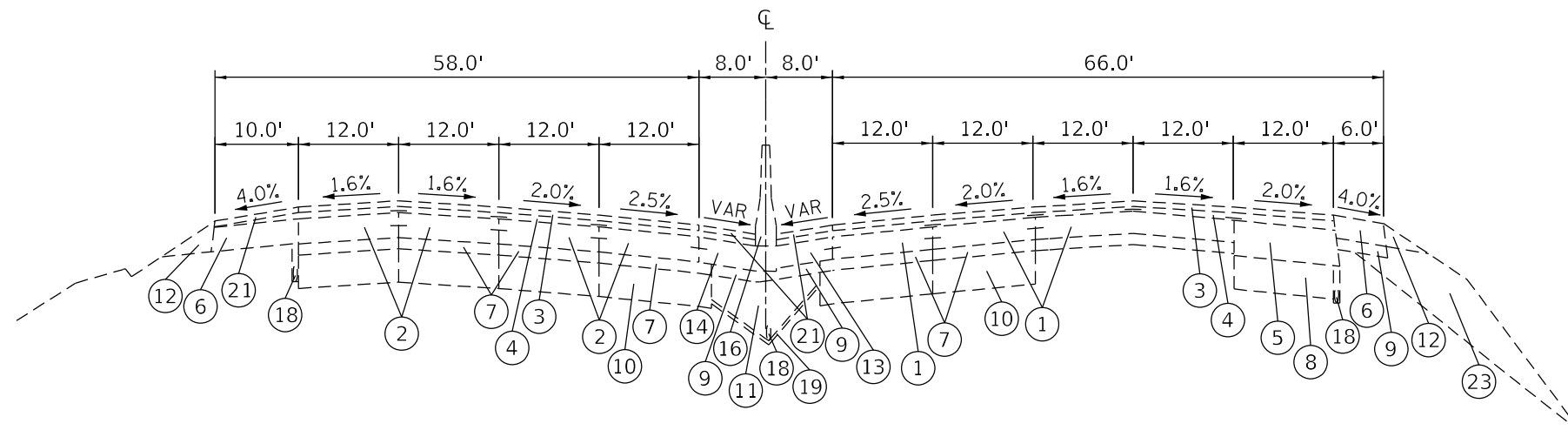

**EXISTING TYPICAL SECTION
FAI 64 (I-64)**

STA 510+00.00 TO STA 510+34.00 (WB) STA 510+00.00 TO STA 521+38.92 (EB)

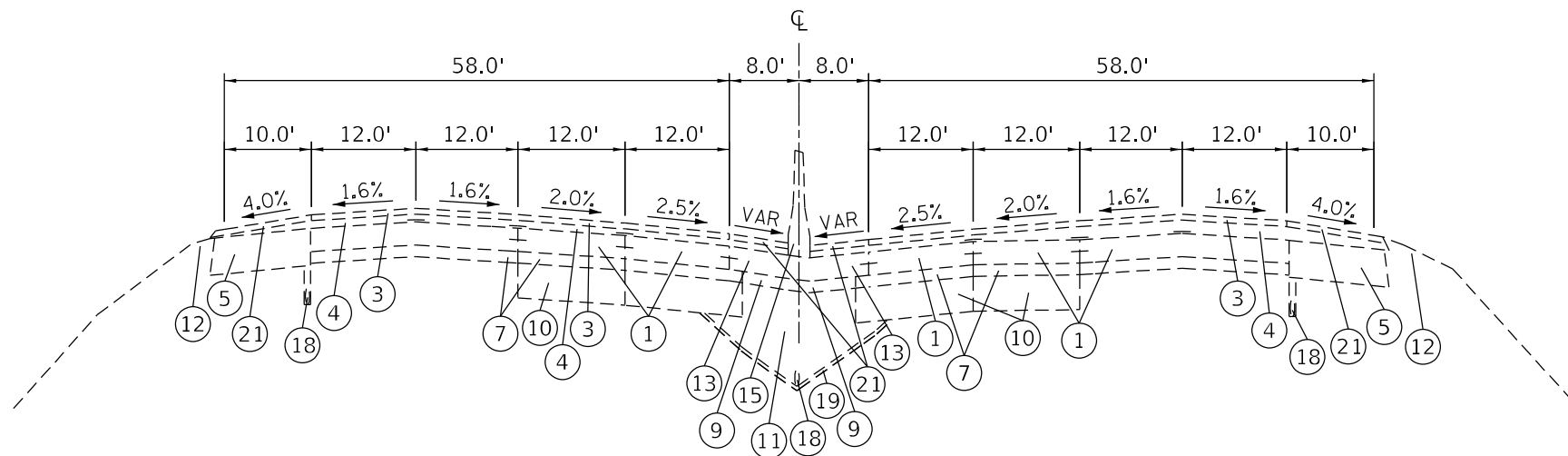

**EXISTING TYPICAL SECTION
FAI 64 (I-64)**

STA 510+34.00 TO STA 547+70.40 (WB) STA 521+38.92 TO STA 548+60.20 (EB)

LEGEND

- | | | | |
|---|--|------------------------------|--|
| ① CONTINUOUSLY REINFORCED P.C.C. PAVEMENT, 8" | ⑥ HOT-MIX ASPHALT SHOULDER, 8" | ⑫ AGGREGATE SHOULDER, TYPE B | ⑱ PIPE UNDERDRAINS, 6" |
| ② CONTINUOUSLY REINFORCED P.C.C. PAVEMENT, 9" | ⑦ STABILIZED SUB-BASE, 4" | ⑬ P.C.C. SHOULDER, 8" | ⑲ FILTER FABRIC |
| ③ POLYMERIZED BITUMINOUS SURFACE COURSE, STONE MATRIX ASPHALT, CLASS I, VARIES 1 1/2" TO 2" | ⑧ GRANULAR MATERIAL, TYPE B, 12" | ⑭ P.C.C. SHOULDER, 9" | ⑳ NOISE ABATEMENT WALL |
| ④ POLYMERIZED BITUMINOUS BINDER COURSE, SUPERPAVE, VARIES 2" TO 2 1/2" | ⑨ GRANULAR MATERIAL, TYPE A, 4" | ⑮ CONCRETE BARRIER | ㉑ BITUMINOUS SURFACE COURSE, SUPERPAVE, 2" |
| ⑤ HOT-MIX ASPHALT SHOULDER, 13" | ⑩ AGGREGATE SUBGRADE, 12" | ⑯ STEEL PLATE BEAM GUARDRAIL | ㉒ BITUMINOUS SHOULDER, SUPERPAVE, 3 3/4" |
| | ⑪ POROUS GRANULAR EMBANKMENT, SUBGRADE | ⑰ BITUMINOUS SHOULDER CURB | ㉓ EMBANKMENT |

MODEL: Default
 FILE: MainE_PlanSubsect-pw_bentley.com\FWIDOT\Documents\DOT_Offices\Director_E\Projects\I64\CAD\Drawings\CAD\Sheets\I64\64-shs-typical.dgn

USER NAME = Brandon.Humphreys	DESIGNED -	REVISED -
	DRAWN -	REVISED -
PLOT SCALE = 40,0000 */ in.	CHECKED -	REVISED -
PLOT DATE = 12/21/2022	DATE -	REVISED -

**STATE OF ILLINOIS
DEPARTMENT OF TRANSPORTATION**

EXISTING TYPICAL SECTIONS

SCALE: N/A SHEET 1 OF 8 SHEETS STA. TO STA.

F.A.I. RTE.	SECTION	COUNTY	TOTAL SHEETS	SHEET NO.
64	82-(5,6,7)PP-1	ST. CLAIR	14	4
CONTRACT NO. 76R48			ILLINOIS FED. AID PROJECT	

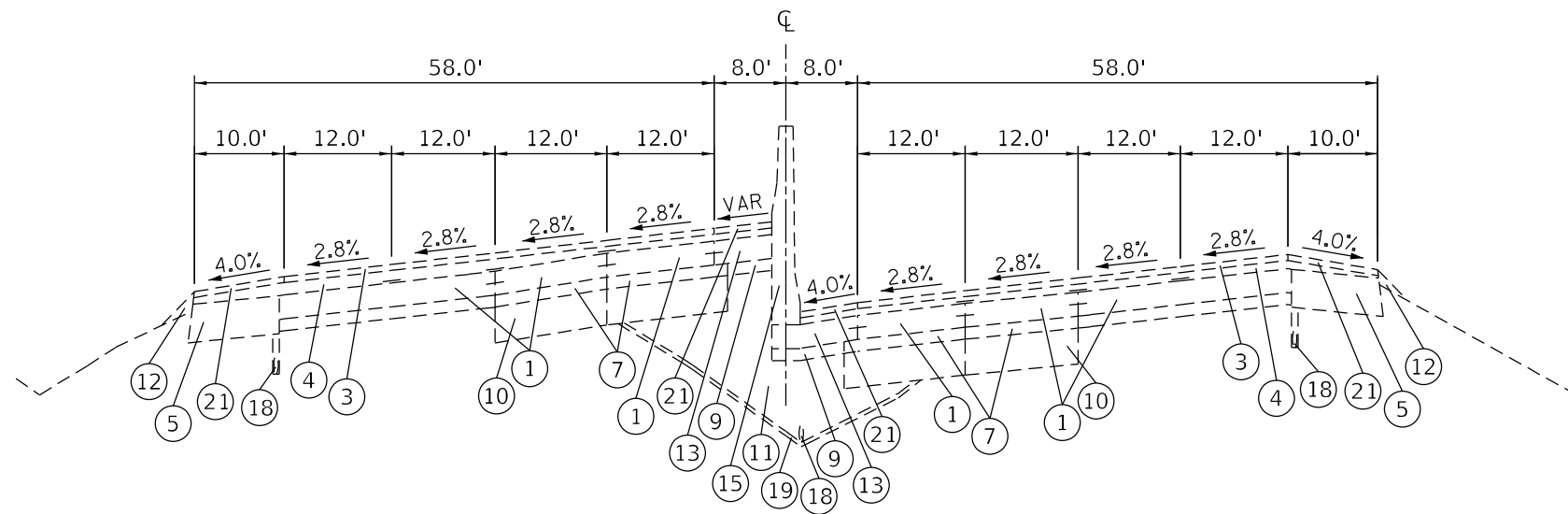

EXISTING TYPICAL SECTION

FAI 64 (I-64)

STA 547+70.40 TO STA 560+38.12 (WB) STA 548+60.20 TO STA 559+48.32 (EB)

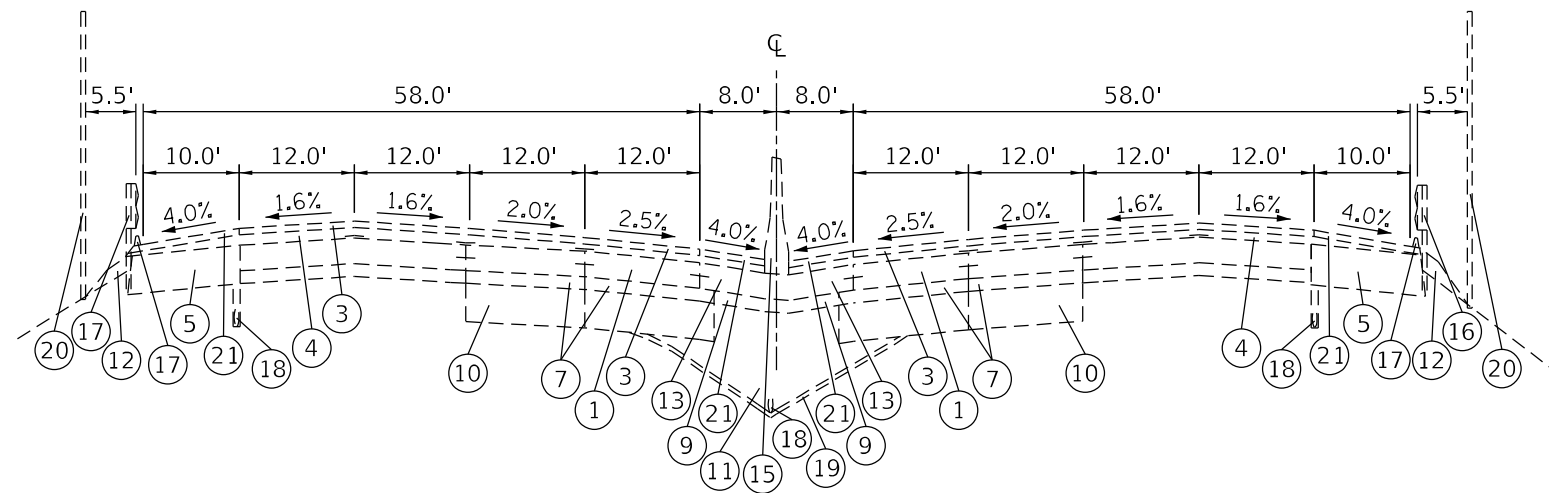

EXISTING TYPICAL SECTION

FAI 64 (I-64)

STA 560+38.12 TO STA 586+21.18 (WB) STA 559+48.32 TO STA 585+31.38 (EB)

LEGEND

- | | | | |
|---|--|------------------------------|--|
| ① CONTINUOUSLY REINFORCED P.C.C. PAVEMENT, 8" | ⑥ HOT-MIX ASPHALT SHOULDER, 8" | ⑫ AGGREGATE SHOULDER, TYPE B | ⑱ PIPE UNDERDRAINS, 6" |
| ② CONTINUOUSLY REINFORCED P.C.C. PAVEMENT, 9" | ⑦ STABILIZED SUB-BASE, 4" | ⑬ P.C.C. SHOULDER, 8" | ⑲ FILTER FABRIC |
| ③ POLYMERIZED BITUMINOUS SURFACE COURSE, STONE MATRIX ASPHALT, CLASS I, VARIES 1 1/2" TO 2" | ⑧ GRANULAR MATERIAL, TYPE B, 12" | ⑭ P.C.C. SHOULDER, 9" | ⑳ NOISE ABATEMENT WALL |
| ④ POLYMERIZED BITUMINOUS BINDER COURSE, SUPERPAVE, VARIES 2" TO 2 1/2" | ⑨ GRANULAR MATERIAL, TYPE A, 4" | ⑮ CONCRETE BARRIER | ㉑ BITUMINOUS SURFACE COURSE, SUPERPAVE, 2" |
| ⑤ HOT-MIX ASPHALT SHOULDER, 13" | ⑩ AGGREGATE SUBGRADE, 12" | ⑯ STEEL PLATE BEAM GUARDRAIL | ㉒ BITUMINOUS SHOULDER, SUPERPAVE, 3 3/4" |
| | ⑪ POROUS GRANULAR EMBANKMENT, SUBGRADE | ⑰ BITUMINOUS SHOULDER CURB | ㉓ EMBANKMENT |

MODEL: Default
 FILE NAME: p:\projects\paw_benefix.com\p\INDOT\Documents\INDOT_Offices\Director_E\Projects\087648\CADD\Drawings\CADD\Drawings\087648-shs-typical.dgn
 PLOT SCALE = 40,0000 * / in.
 PLOT DATE = 12/21/2022

USER NAME = Brandon.Humphreys	DESIGNED -	REVISED -
	DRAWN -	REVISED -
	CHECKED -	REVISED -
	DATE -	REVISED -

**STATE OF ILLINOIS
DEPARTMENT OF TRANSPORTATION**

EXISTING TYPICAL SECTIONS			
SCALE: N/A	SHEET 2	OF 8 SHEETS	STA. TO STA.

F.A.I. RTE.	SECTION	COUNTY	TOTAL SHEETS	SHEET NO.
64	82-(5,6,7)PP-1	ST. CLAIR	14	5
ILLINOIS FED. AID PROJECT			CONTRACT NO. 76R48	

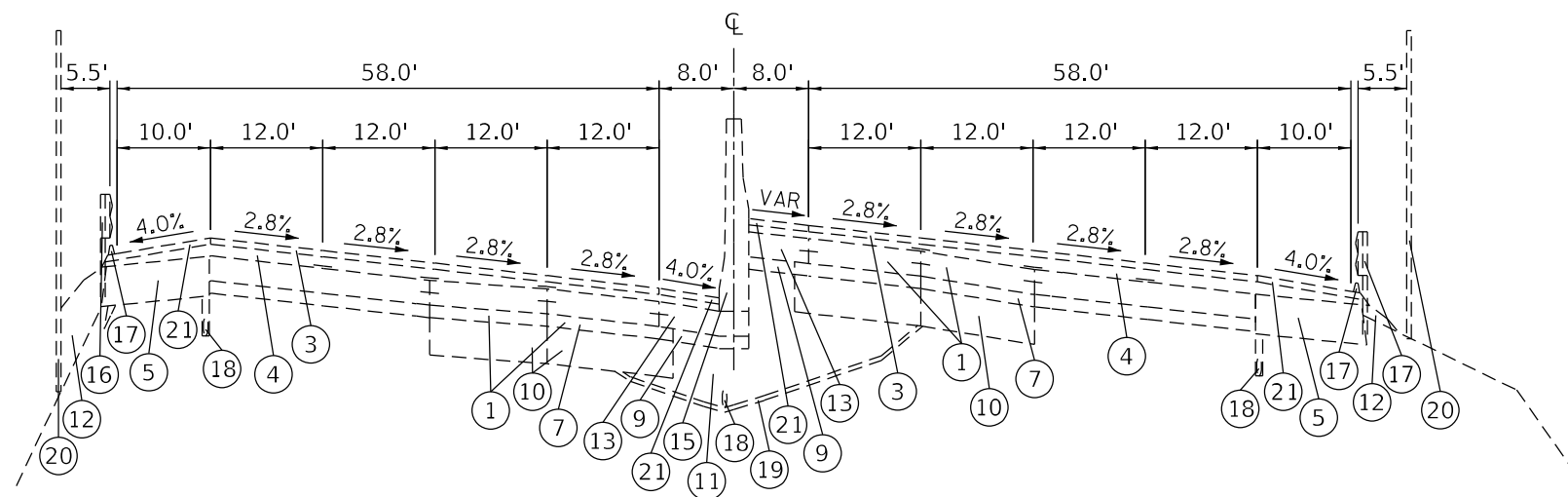

EXISTING TYPICAL SECTION

FAI 64 (I-64)

STA 586+21.18 TO STA 606+93.98 (WB) STA 585+31.38 TO STA 607+83.78 (EB)
 BRIDGE OMISSION: STA 589+97 TO 591+49 (SN 082-0309 WB & SN 082-0308 EB)

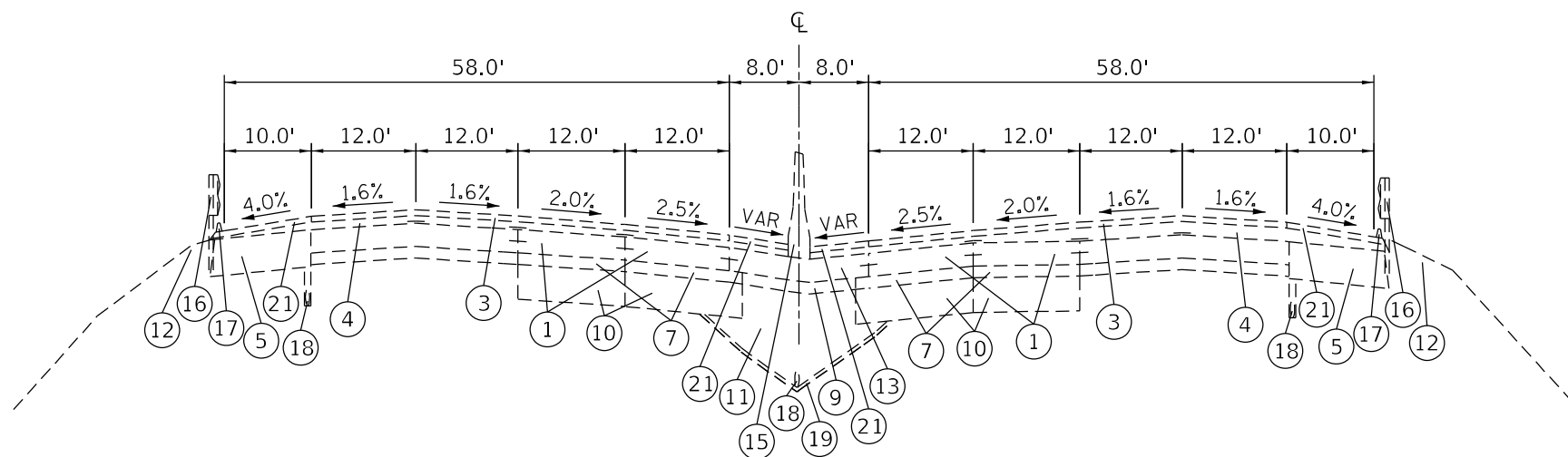

EXISTING TYPICAL SECTION

FAI 64 (I-64)

STA 606+93.98 TO STA 613+80.02 (WB) STA 607+83.78 TO STA 613+80.02 (EB)
 STA 692+18.71 TO STA 730+77.89 (WB) STA 693+92.51 TO STA 732+09.69 (EB)

LEGEND

- | | | | |
|---|--|------------------------------|--|
| ① CONTINUOUSLY REINFORCED P.C.C. PAVEMENT, 8" | ⑥ HOT-MIX ASPHALT SHOULDER, 8" | ⑫ AGGREGATE SHOULDER, TYPE B | ⑱ PIPE UNDERDRAINS, 6" |
| ② CONTINUOUSLY REINFORCED P.C.C. PAVEMENT, 9" | ⑦ STABILIZED SUB-BASE, 4" | ⑬ P.C.C. SHOULDER, 8" | ⑲ FILTER FABRIC |
| ③ POLYMERIZED BITUMINOUS SURFACE COURSE, STONE MATRIX ASPHALT, CLASS I, VARIES 1 1/2" TO 2" | ⑧ GRANULAR MATERIAL, TYPE B, 12" | ⑭ P.C.C. SHOULDER, 9" | ⑳ NOISE ABATEMENT WALL |
| ④ POLYMERIZED BITUMINOUS BINDER COURSE, SUPERPAVE, VARIES 2" TO 2 1/2" | ⑨ GRANULAR MATERIAL, TYPE A, 4" | ⑮ CONCRETE BARRIER | ㉑ BITUMINOUS SURFACE COURSE, SUPERPAVE, 2" |
| ⑤ HOT-MIX ASPHALT SHOULDER, 13" | ⑩ AGGREGATE SUBGRADE, 12" | ⑯ STEEL PLATE BEAM GUARDRAIL | ㉒ BITUMINOUS SHOULDER, SUPERPAVE, 3 3/4" |
| | ⑪ POROUS GRANULAR EMBANKMENT, SUBGRADE | ⑰ BITUMINOUS SHOULDER CURB | ㉓ EMBANKMENT |

MODEL: Default
 FILE: NAME: p:\subdirect-pw-bentley.com\p\indot\Documents\INDOT_Offices\Director_E\Projects\087648\CAD\Drawings\087648-shs-typical.dgn

USER NAME = Brandon.Humphreys	DESIGNED -	REVISED -
	DRAWN -	REVISED -
PLOT SCALE = 40,0000 */ in.	CHECKED -	REVISED -
PLOT DATE = 12/21/2022	DATE -	REVISED -

**STATE OF ILLINOIS
 DEPARTMENT OF TRANSPORTATION**

EXISTING TYPICAL SECTIONS

SCALE: N/A SHEET 3 OF 8 SHEETS STA. TO STA.

F.A.I. RTE.	SECTION	COUNTY	TOTAL SHEETS	SHEET NO.
64	82-(5,6,7)PP-1	ST. CLAIR	14	6
CONTRACT NO. 76R48			ILLINOIS FED. AID PROJECT	

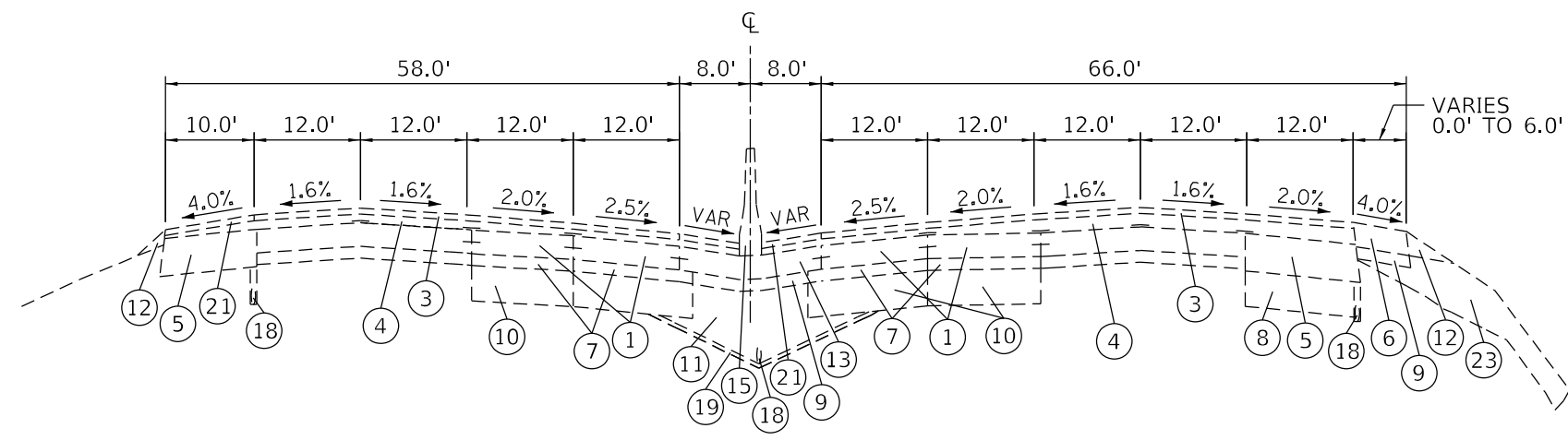

EXISTING TYPICAL SECTION

FAI 64 (I-64)

STA 613+80.02 TO STA 652+43.94 (WB) STA 613+80.02 TO STA 657+24.79 (EB)

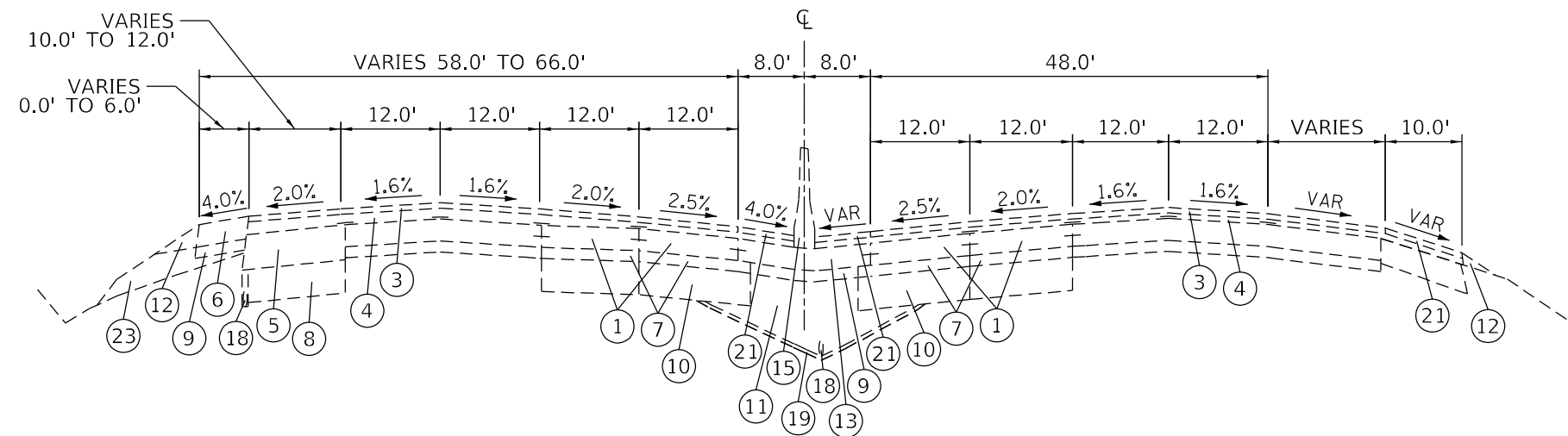

EXISTING TYPICAL SECTION

FAI 64 (I-64)

STA 652+43.94 TO STA 658+54.90 (WB) STA 657+24.79 TO STA 658+69.57 (EB)

LEGEND

- | | | | |
|---|--|------------------------------|--|
| ① CONTINUOUSLY REINFORCED P.C.C. PAVEMENT, 8" | ⑥ HOT-MIX ASPHALT SHOULDER, 8" | ⑫ AGGREGATE SHOULDER, TYPE B | ⑱ PIPE UNDERDRAINS, 6" |
| ② CONTINUOUSLY REINFORCED P.C.C. PAVEMENT, 9" | ⑦ STABILIZED SUB-BASE, 4" | ⑬ P.C.C. SHOULDER, 8" | ⑲ FILTER FABRIC |
| ③ POLYMERIZED BITUMINOUS SURFACE COURSE, STONE MATRIX ASPHALT, CLASS I, VARIES 1 1/2" TO 2" | ⑧ GRANULAR MATERIAL, TYPE B, 12" | ⑭ P.C.C. SHOULDER, 9" | ⑳ NOISE ABATEMENT WALL |
| ④ POLYMERIZED BITUMINOUS BINDER COURSE, SUPERPAVE, VARIES 2" TO 2 1/2" | ⑨ GRANULAR MATERIAL, TYPE A, 4" | ⑮ CONCRETE BARRIER | ㉑ BITUMINOUS SURFACE COURSE, SUPERPAVE, 2" |
| ⑤ HOT-MIX ASPHALT SHOULDER, 13" | ⑩ AGGREGATE SUBGRADE, 12" | ⑯ STEEL PLATE BEAM GUARDRAIL | ㉒ BITUMINOUS SHOULDER, SUPERPAVE, 3 3/4" |
| | ⑪ POROUS GRANULAR EMBANKMENT, SUBGRADE | ⑰ BITUMINOUS SHOULDER CURB | ㉓ EMBANKMENT |

MODEL: Default
 FILE: MainE_PlanSubsect-pw_benefits.com\FIN\DOT\Documents\DOT_Offices\Director_E\Projects\I-64\CAD\Drawings\CAD\Sheets\I-64\8-shs-typical.dgn

USER NAME = Brandon.Humphreys	DESIGNED -	REVISED -
	DRAWN -	REVISED -
PLOT SCALE = 40,0000 */ in.	CHECKED -	REVISED -
PLOT DATE = 12/21/2022	DATE -	REVISED -

**STATE OF ILLINOIS
DEPARTMENT OF TRANSPORTATION**

EXISTING TYPICAL SECTIONS

SCALE: N/A SHEET 4 OF 8 SHEETS STA. TO STA.

F.A.I. RTE.	SECTION	COUNTY	TOTAL SHEETS	SHEET NO.
64	82-(5,6,7)PP-1	ST. CLAIR	14	7
CONTRACT NO. 76R48			ILLINOIS FED. AID PROJECT	

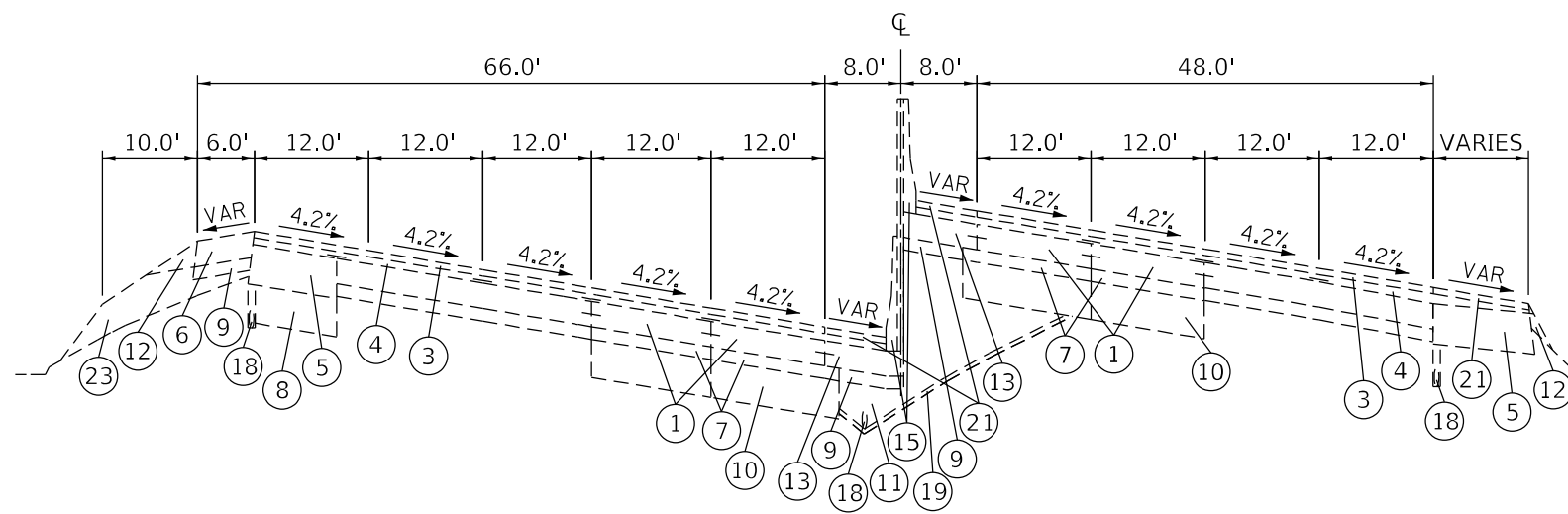

EXISTING TYPICAL SECTION

FAI 64 (I-64)

STA 658+54.90 TO STA 661+10.04 (WB) STA 658+69.57 TO STA 661+10.04 (EB)
 STA 662+84.20 TO STA 672+93.94

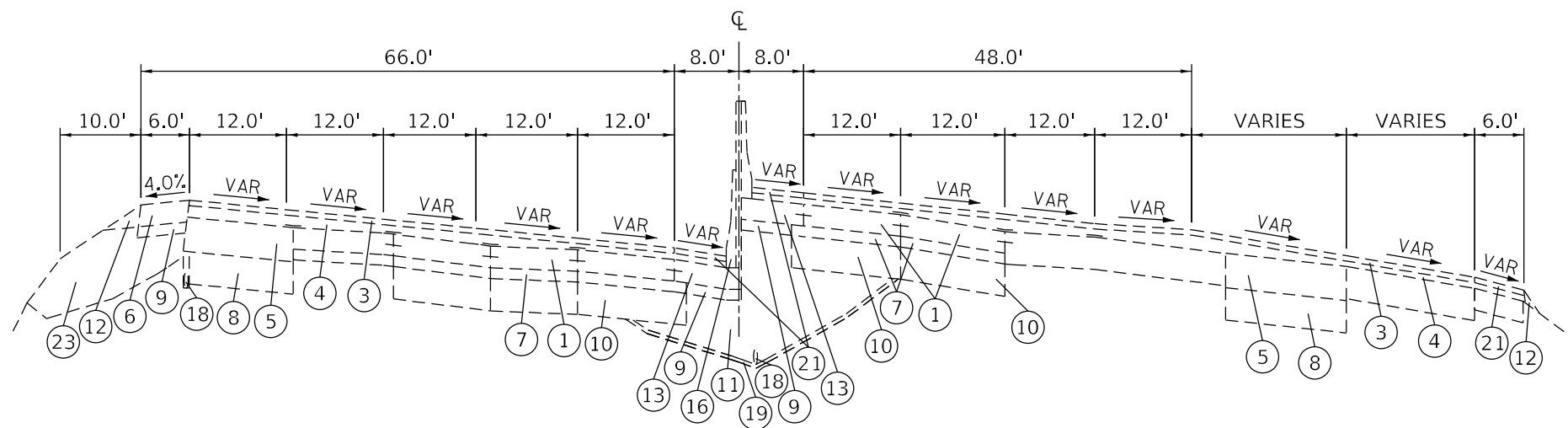

EXISTING TYPICAL SECTION

FAI 64 (I-64)

STA 661+10.04 TO STA 662+23.36

LEGEND

- | | | | |
|---|--|------------------------------|--|
| ① CONTINUOUSLY REINFORCED P.C.C. PAVEMENT, 8" | ⑥ HOT-MIX ASPHALT SHOULDER, 8" | ⑫ AGGREGATE SHOULDER, TYPE B | ⑱ PIPE UNDERDRAINS, 6" |
| ② CONTINUOUSLY REINFORCED P.C.C. PAVEMENT, 9" | ⑦ STABILIZED SUB-BASE, 4" | ⑬ P.C.C. SHOULDER, 8" | ⑲ FILTER FABRIC |
| ③ POLYMERIZED BITUMINOUS SURFACE COURSE, STONE MATRIX ASPHALT, CLASS I, VARIES 1 1/2" TO 2" | ⑧ GRANULAR MATERIAL, TYPE B, 12" | ⑭ P.C.C. SHOULDER, 9" | ⑳ NOISE ABATEMENT WALL |
| ④ POLYMERIZED BITUMINOUS BINDER COURSE, SUPERPAVE, VARIES 2" TO 2 1/2" | ⑨ GRANULAR MATERIAL, TYPE A, 4" | ⑮ CONCRETE BARRIER | ㉑ BITUMINOUS SURFACE COURSE, SUPERPAVE, 2" |
| ⑤ HOT-MIX ASPHALT SHOULDER, 13" | ⑩ AGGREGATE SUBGRADE, 12" | ⑯ STEEL PLATE BEAM GUARDRAIL | ㉒ BITUMINOUS SHOULDER, SUPERPAVE, 3 3/4" |
| | ⑪ POROUS GRANULAR EMBANKMENT, SUBGRADE | ⑰ BITUMINOUS SHOULDER CURB | ㉓ EMBANKMENT |

MODEL: Default
 FILE: MainE_pxl\uldet-pw-ben\fy.com\p\indot\Documents\DOT_Offices\Dir\rdt_8\Project\087648\CADD\Drawings\087648-shs-typical.dgn

USER NAME = Brandon.Humphreys	DESIGNED -	REVISED -
	DRAWN -	REVISED -
PLOT SCALE = 40,0000 * / in.	CHECKED -	REVISED -
PLOT DATE = 12/21/2022	DATE -	REVISED -

**STATE OF ILLINOIS
 DEPARTMENT OF TRANSPORTATION**

EXISTING TYPICAL SECTIONS

SCALE: N/A SHEET 5 OF 8 SHEETS STA. TO STA.

F.A.I. RTE.	SECTION	COUNTY	TOTAL SHEETS	SHEET NO.
64	82-(5,6,7)PP-1	ST. CLAIR	14	8
CONTRACT NO. 76R48			ILLINOIS FED. AID PROJECT	

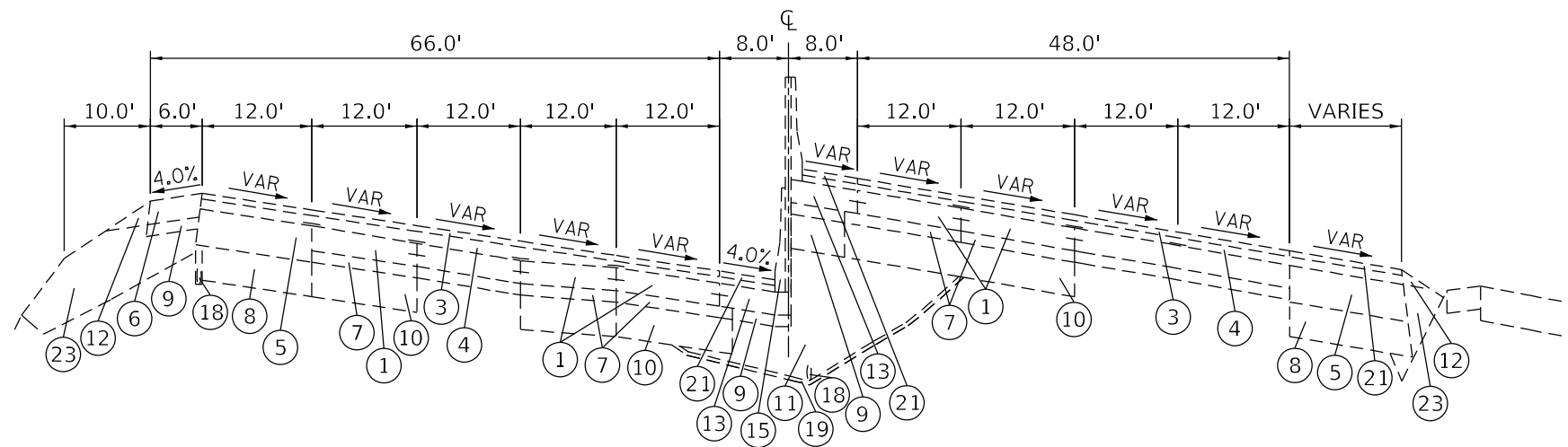

EXISTING TYPICAL SECTION
FAI 64 (I-64)

STA 662+23.36 TO STA 662+84.20

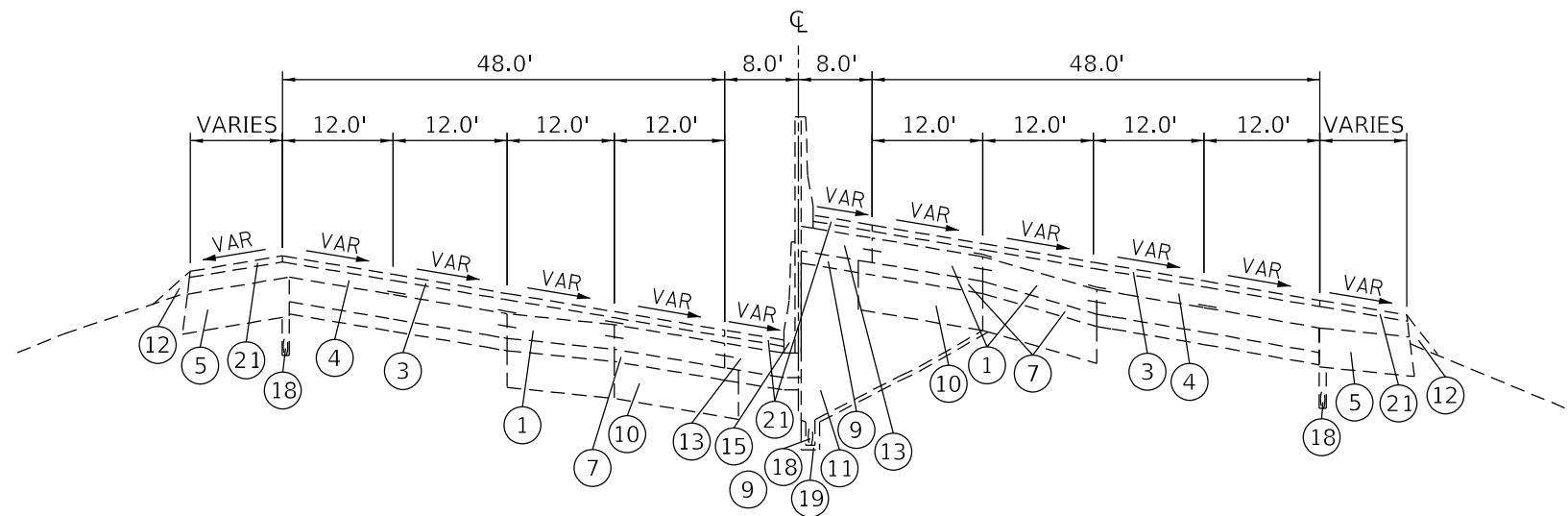

EXISTING TYPICAL SECTION
FAI 64 (I-64)

STA 672+93.94 TO STA 681+00.00
STA 689+15.00 TO STA 692+18.71 (WB) STA 689+15.00 TO STA 693+92.51 (EB)

LEGEND

- | | | | |
|---|--|------------------------------|--|
| ① CONTINUOUSLY REINFORCED P.C.C. PAVEMENT, 8" | ⑥ HOT-MIX ASPHALT SHOULDER, 8" | ⑫ AGGREGATE SHOULDER, TYPE B | ⑱ PIPE UNDERDRAINS, 6" |
| ② CONTINUOUSLY REINFORCED P.C.C. PAVEMENT, 9" | ⑦ STABILIZED SUB-BASE, 4" | ⑬ P.C.C. SHOULDER, 8" | ⑲ FILTER FABRIC |
| ③ POLYMERIZED BITUMINOUS SURFACE COURSE, STONE MATRIX ASPHALT, CLASS I, VARIES 1 1/2" TO 2" | ⑧ GRANULAR MATERIAL, TYPE B, 12" | ⑭ P.C.C. SHOULDER, 9" | ⑳ NOISE ABATEMENT WALL |
| ④ POLYMERIZED BITUMINOUS BINDER COURSE, SUPERPAVE, VARIES 2" TO 2 1/2" | ⑨ GRANULAR MATERIAL, TYPE A, 4" | ⑮ CONCRETE BARRIER | ㉑ BITUMINOUS SURFACE COURSE, SUPERPAVE, 2" |
| ⑤ HOT-MIX ASPHALT SHOULDER, 13" | ⑩ AGGREGATE SUBGRADE, 12" | ⑯ STEEL PLATE BEAM GUARDRAIL | ㉒ BITUMINOUS SHOULDER, SUPERPAVE, 3 3/4" |
| | ⑪ POROUS GRANULAR EMBANKMENT, SUBGRADE | ⑰ BITUMINOUS SHOULDER CURB | ㉓ EMBANKMENT |

MODEL: Default
 FILE: MainE_PlanSubsect-pw-bev.dwg, com: P:\IN\DOT\Documents\DOT Office\Dir\Dir: E:\Project\DOT\64\8\CAD\Drawings\DOT\64\8-shs-typical.dwg

USER NAME = Brandon.Humphreys	DESIGNED -	REVISED -
	DRAWN -	REVISED -
PLOT SCALE = 40,0000 */ in.	CHECKED -	REVISED -
PLOT DATE = 12/21/2022	DATE -	REVISED -

STATE OF ILLINOIS
DEPARTMENT OF TRANSPORTATION

EXISTING TYPICAL SECTIONS

SCALE: N/A SHEET 6 OF 8 SHEETS STA. TO STA.

F.A.I. RTE.	SECTION	COUNTY	TOTAL SHEETS	SHEET NO.
64	82-(5,6,7)PP-1	ST. CLAIR	14	9
CONTRACT NO. 76R48			ILLINOIS FED. AID PROJECT	

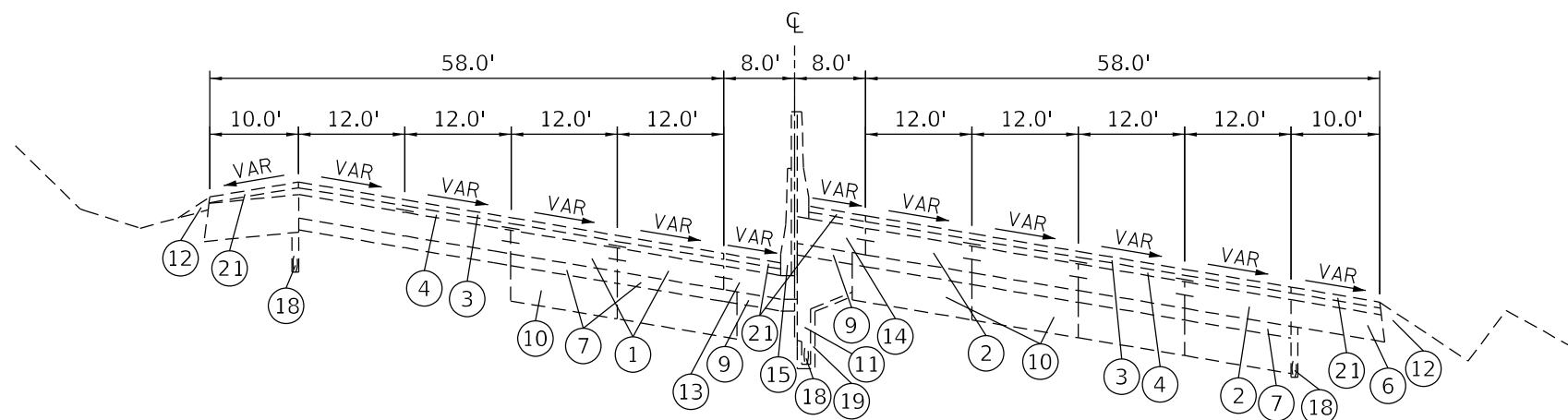

EXISTING TYPICAL SECTION
FAI 64 (I-64)
 STA 681+00.00 TO STA 689+15.00

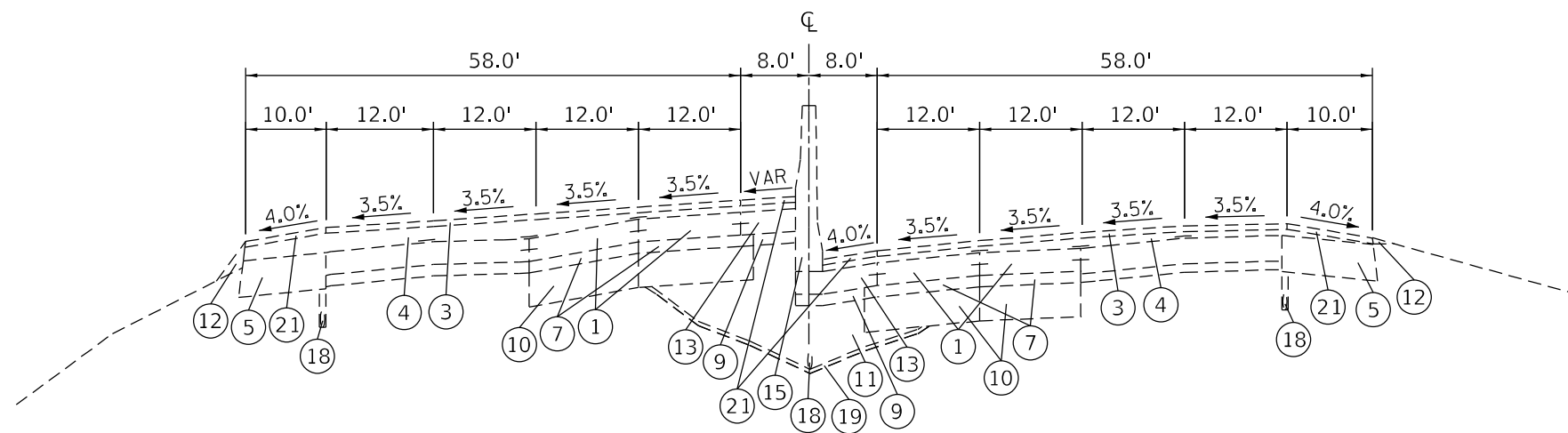

EXISTING TYPICAL SECTION
FAI 64 (I-64)
 STA 730+77.89 TO STA 735+74.76 (WB) STA 732+09.69 TO STA 735+74.76 (EB)

LEGEND

- | | | | |
|---|--|------------------------------|--|
| ① CONTINUOUSLY REINFORCED P.C.C. PAVEMENT, 8" | ⑥ HOT-MIX ASPHALT SHOULDER, 8" | ⑫ AGGREGATE SHOULDER, TYPE B | ⑱ PIPE UNDERDRAINS, 6" |
| ② CONTINUOUSLY REINFORCED P.C.C. PAVEMENT, 9" | ⑦ STABILIZED SUB-BASE, 4" | ⑬ P.C.C. SHOULDER, 8" | ⑲ FILTER FABRIC |
| ③ POLYMERIZED BITUMINOUS SURFACE COURSE, STONE MATRIX ASPHALT, CLASS I, VARIES 1 1/2" TO 2" | ⑧ GRANULAR MATERIAL, TYPE B, 12" | ⑭ P.C.C. SHOULDER, 9" | ⑳ NOISE ABATEMENT WALL |
| ④ POLYMERIZED BITUMINOUS BINDER COURSE, SUPERPAVE, VARIES 2" TO 2 1/2" | ⑨ GRANULAR MATERIAL, TYPE A, 4" | ⑮ CONCRETE BARRIER | ㉑ BITUMINOUS SURFACE COURSE, SUPERPAVE, 2" |
| ⑤ HOT-MIX ASPHALT SHOULDER, 13" | ⑩ AGGREGATE SUBGRADE, 12" | ⑯ STEEL PLATE BEAM GUARDRAIL | ㉒ BITUMINOUS SHOULDER, SUPERPAVE, 3 3/4" |
| | ⑪ POROUS GRANULAR EMBANKMENT, SUBGRADE | ⑰ BITUMINOUS SHOULDER CURB | ㉓ EMBANKMENT |

MODEL: Default
 FILE: MainE_pxl\uldrct-pw-benr-fy.com\p\indot\Documents\indot_office\Dir\drct_6\Project\1\087648\CAD\Sheet\087648-shs-typical.dgn

USER NAME = Brandon.Humphreys	DESIGNED -	REVISED -	STATE OF ILLINOIS DEPARTMENT OF TRANSPORTATION	EXISTING TYPICAL SECTIONS			F.A.I. RTE.	SECTION	COUNTY	TOTAL SHEETS	SHEET NO.
DRAWN -	REVISED -	REVISED -		64	82-(5,6,7)PP-1	ST. CLAIR	14	10			
PLOT SCALE = 40,0000 * / in.	CHECKED -	REVISED -		SCALE: N/A SHEET 7 OF 8 SHEETS STA. TO STA.			CONTRACT NO. 76R48				
PLOT DATE = 12/21/2022	DATE -	REVISED -		ILLINOIS		FED. AID PROJECT					

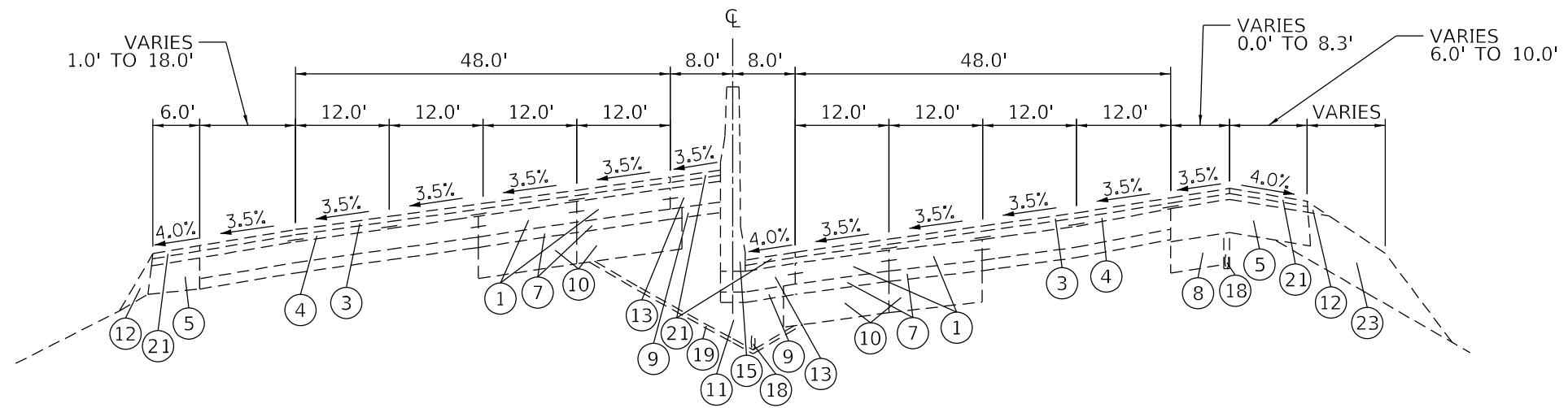

EXISTING TYPICAL SECTION

FAI 64 (I-64)

STA 735+74.76 TO STA 744+15.00

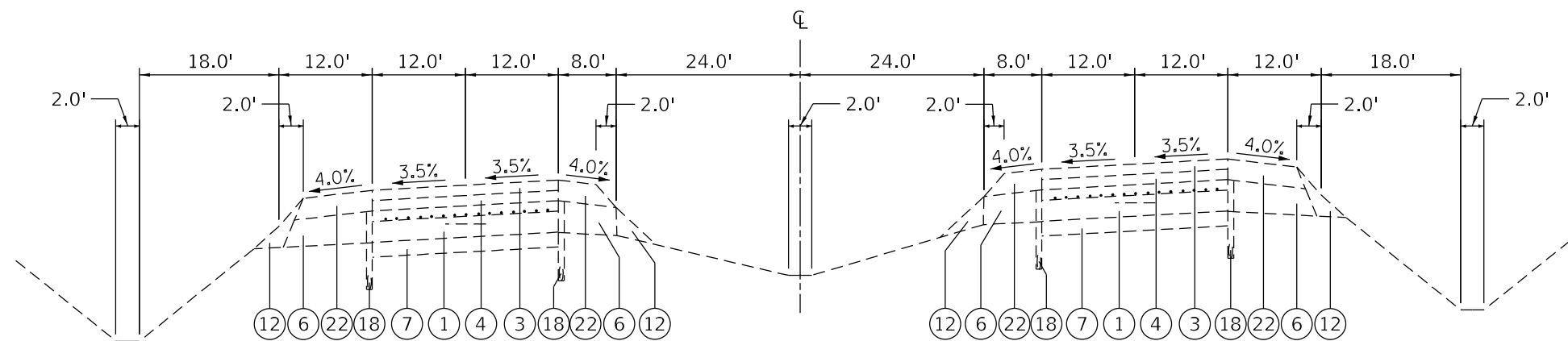

EXISTING TYPICAL SECTION

FAI 64 (I-64)

STA 744+15.00 TO STA 782+26.74

LEGEND

- | | | | |
|---|--|------------------------------|--|
| ① CONTINUOUSLY REINFORCED P.C.C. PAVEMENT, 8" | ⑥ HOT-MIX ASPHALT SHOULDER, 8" | ⑫ AGGREGATE SHOULDER, TYPE B | ⑱ PIPE UNDERDRAINS, 6" |
| ② CONTINUOUSLY REINFORCED P.C.C. PAVEMENT, 9" | ⑦ STABILIZED SUB-BASE, 4" | ⑬ P.C.C. SHOULDER, 8" | ⑲ FILTER FABRIC |
| ③ POLYMERIZED BITUMINOUS SURFACE COURSE, STONE MATRIX ASPHALT, CLASS I, VARIES 1 1/2" TO 2" | ⑧ GRANULAR MATERIAL, TYPE B, 12" | ⑭ P.C.C. SHOULDER, 9" | ⑳ NOISE ABATEMENT WALL |
| ④ POLYMERIZED BITUMINOUS BINDER COURSE, SUPERPAVE, VARIES 2" TO 2 1/2" | ⑨ GRANULAR MATERIAL, TYPE A, 4" | ⑮ CONCRETE BARRIER | ㉑ BITUMINOUS SURFACE COURSE, SUPERPAVE, 2" |
| ⑤ HOT-MIX ASPHALT SHOULDER, 13" | ⑩ AGGREGATE SUBGRADE, 12" | ⑯ STEEL PLATE BEAM GUARDRAIL | ㉒ BITUMINOUS SHOULDER, SUPERPAVE, 3 3/4" |
| | ⑪ POROUS GRANULAR EMBANKMENT, SUBGRADE | ⑰ BITUMINOUS SHOULDER CURB | ㉓ EMBANKMENT |

MODEL: Default
 FILE: MainE:public\sect-pw-bentley.com\p\indot\documents\indot_office\dir\dir: E:\Project\087648\CADD\data\CAD\sheet\087648-shs-typical.dgn

USER NAME = Brandon.Humphreys	DESIGNED -	REVISED -
	DRAWN -	REVISED -
PLOT SCALE = 40,0000 */ in.	CHECKED -	REVISED -
PLOT DATE = 12/21/2022	DATE -	REVISED -

**STATE OF ILLINOIS
DEPARTMENT OF TRANSPORTATION**

EXISTING TYPICAL SECTIONS

SCALE: N/A SHEET 8 OF 8 SHEETS STA. TO STA.

F.A.I. RTE.	SECTION	COUNTY	TOTAL SHEETS	SHEET NO.
64	82-(5,6,7)PP-1	ST. CLAIR	14	11
CONTRACT NO. 76R48			ILLINOIS FED. AID PROJECT	

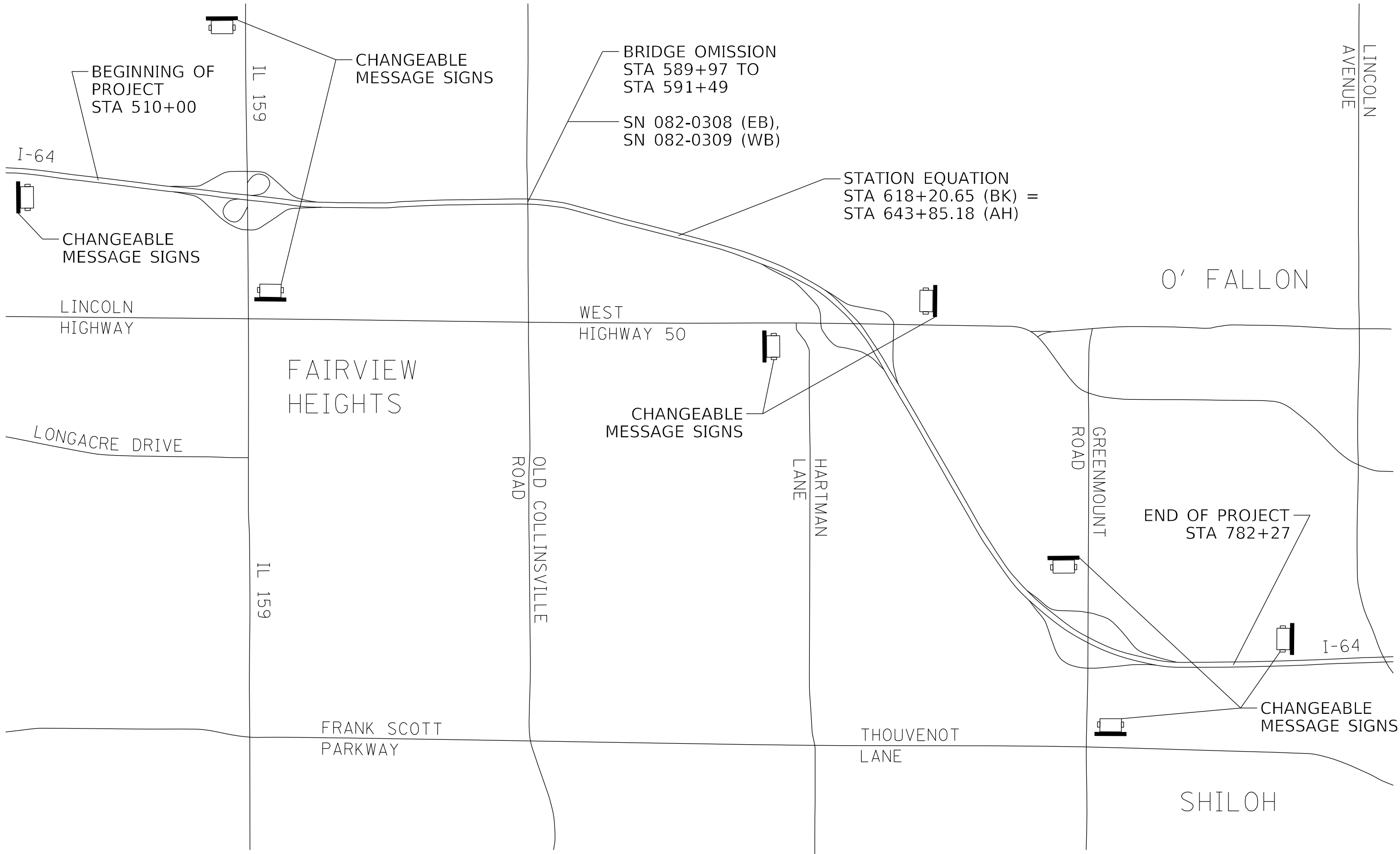

MODEL: Default
 FILE: \\mdepc-pw-bentley.com\P\INDOT\Documents\INDOT Office\Dir\drct_8\Project\087648\CADD\Drawings\CAD\Sheets\087648-shc-dtblk.dwg

USER NAME = Brandon.Humphreys	DESIGNED -	REVISED -
	DRAWN -	REVISED -
PLOT SCALE = 40,0000 * / in.	CHECKED -	REVISED -
PLOT DATE = 12/21/2022	DATE -	REVISED -

STATE OF ILLINOIS
DEPARTMENT OF TRANSPORTATION

LOCATION MAP SHEET			
SCALE: N/A	SHEET 1	OF 1 SHEETS	STA. TO STA.

F.A.I. RTE.	SECTION	COUNTY	TOTAL SHEETS	SHEET NO.
64	82-(5,6,7)PP-1	ST. CLAIR	14	12
CONTRACT NO. 76R48			ILLINOIS FED. AID PROJECT	

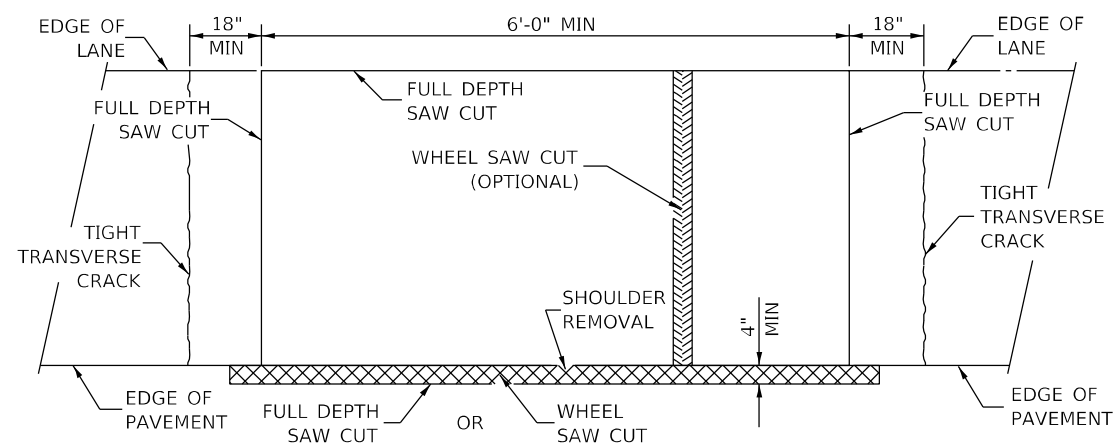

**PAVEMENT SAWING DETAIL
(HMA SHOULDER)**

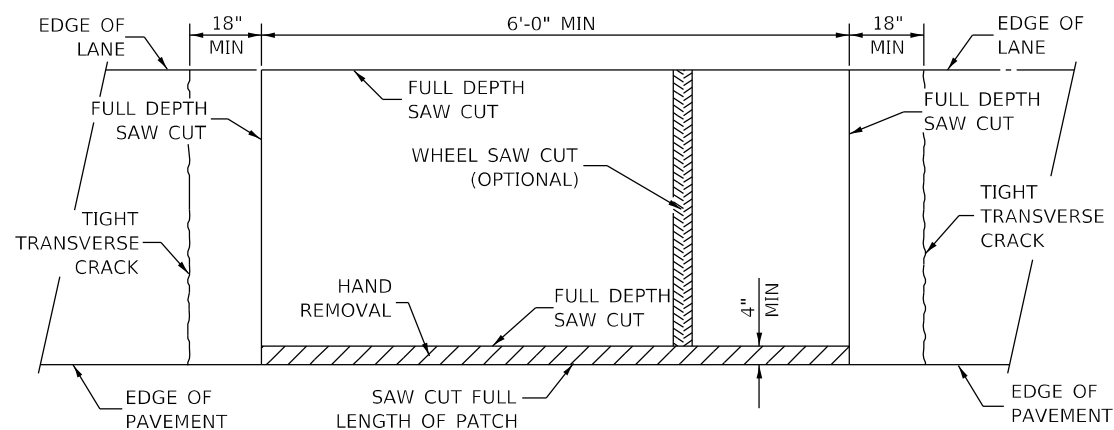

**PAVEMENT SAWING DETAIL
(PCC SHOULDER)**

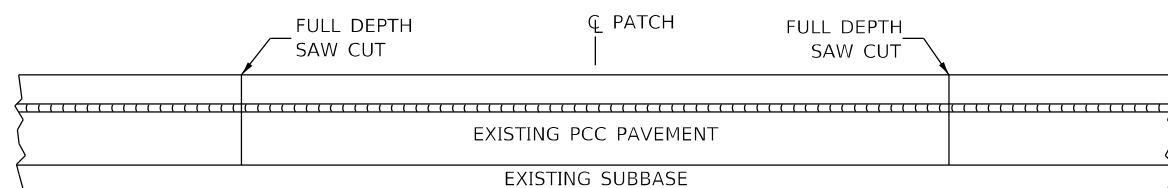

EXISTING PAVEMENT WITHOUT HMA SURFACE

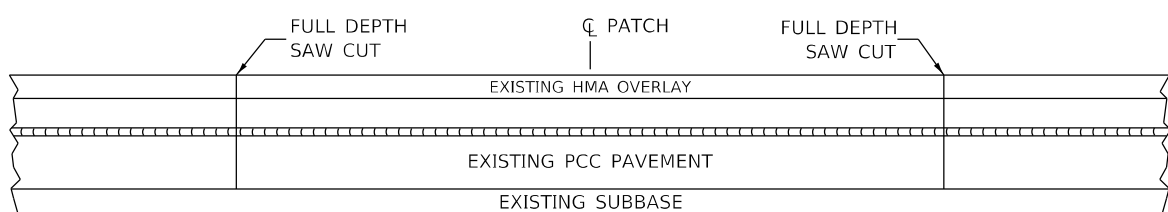

EXISTING PAVEMENT WITH HMA SURFACE

**PAVEMENT SAWING DETAIL FOR CLASS A PATCHING
(CRC PAVEMENT)**

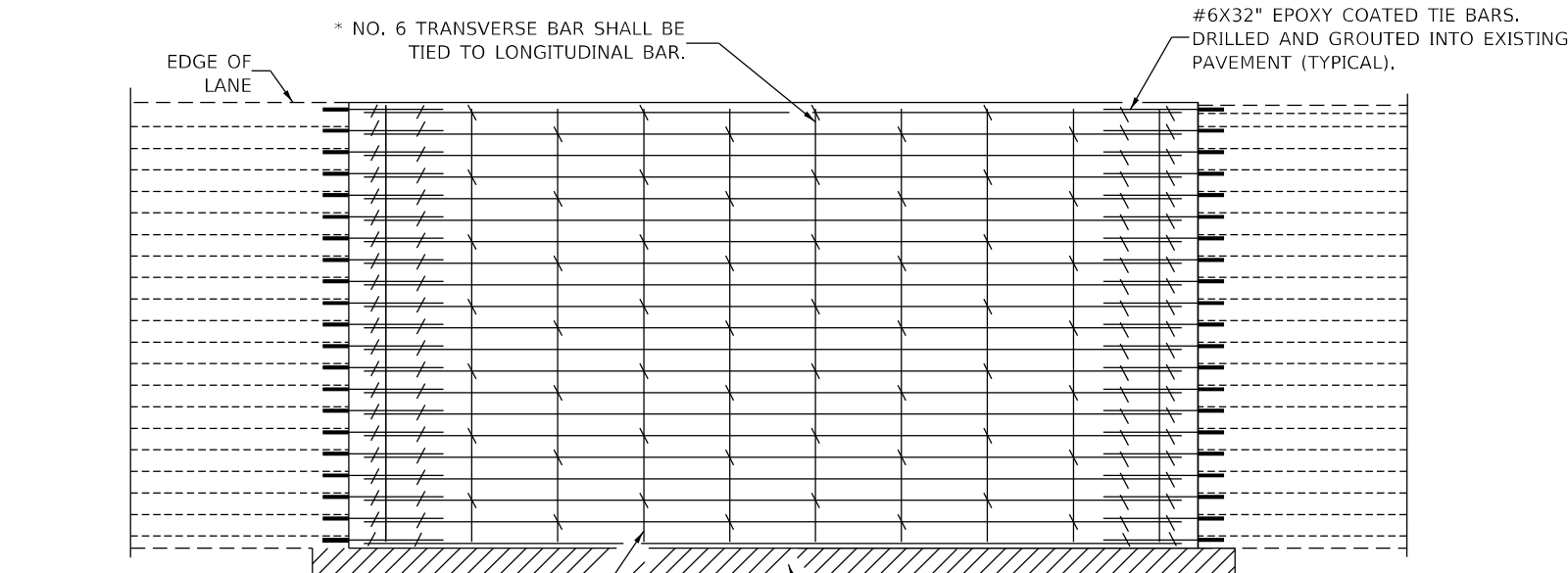

PAVEMENT REINFORCEMENT DETAIL

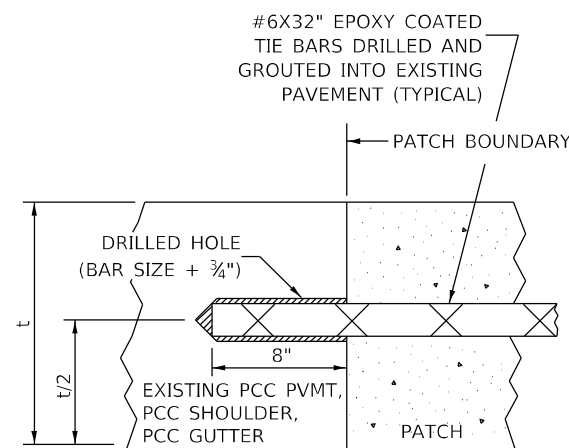

LONGITUDINAL CONSTRUCTION JOINT

PATCHES MORE THAN 20' IN LENGTH SHALL BE TIED TO ADJACENT PAVEMENT, PCC SHOULDERS OR PCC CURB AND GUTTER WITH #6x32" EPOXY COATED TIE BARS AT 36" CENTERS.

NOTES:

EXISTING LONGITUDINAL REINFORCEMENT SPACING; $\pm 6\frac{1}{2}$ ".
SPACING OF NEW LONGITUDINAL REINFORCEMENT AND NEW LONGITUDINAL TIE BARS SHALL MATCH SPACING OF EXISTING REINFORCEMENT AND SHALL BE TIED TOGETHER WITH A MINIMUM OF TWO TIES PER BAR.

SUPPORT CHAIRS SHALL BE REQUIRED WHENEVER PATCH LENGTH EXCEEDS 6'-0"

* EVERY THIRD INTERSECTION MUST BE TIED. WHEN THE MINIMUM CLEARANCE CANNOT BE OBTAINED WITH THE TRANSVERSE REBAR ON TOP, THEN THE TRANSVERSE REBAR SHALL BE TIED TO THE BOTTOM OF THE LONGITUDINAL REBAR.

** VARIABLES WHERE S₁ AND S₂ ARE 2½" MIN. AND 12" MAX.

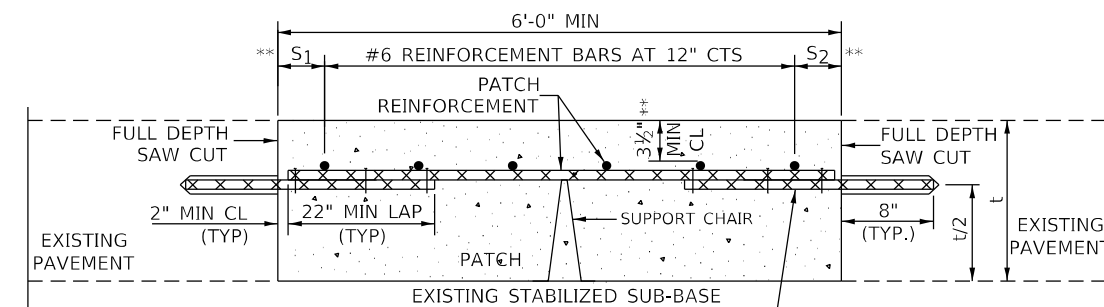

WITHOUT HMA OVERLAY

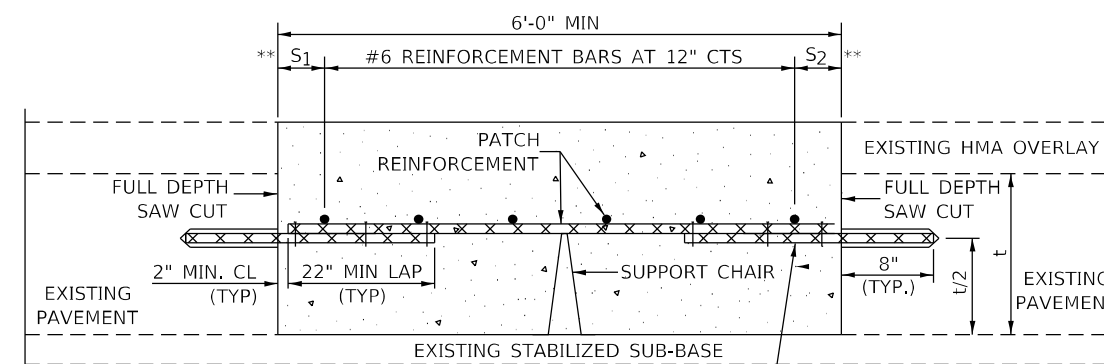

WITH HMA OVERLAY

**PATCHING DETAIL FOR CLASS A PATCHING
(CRC PAVEMENT)**

MODEL Default
 FILE Name: p:\projects\paw_benefly.com\p\INDOT\Documents\INDOT Office\Drawings\B\Projects\0876848\0876848\CADD\Drawings\CADD\Sheet\0876848-shc-detailed.dwg
 PROJECT: 0876848
 SHEET: 14
 DATE: 12/21/2022

USER NAME = Brandon.Humphreys	DESIGNED -	REVISED -
PLOT SCALE = 40,0000 * / in.	DRAWN -	REVISED -
PLOT DATE = 12/21/2022	CHECKED -	REVISED -
	DATE -	REVISED -

**STATE OF ILLINOIS
DEPARTMENT OF TRANSPORTATION**

CLASS A PATCHING (SPECIAL)

SCALE: N/A SHEET 1 OF 2 SHEETS STA. TO STA.

F.A.I. RTE.	SECTION	COUNTY	TOTAL SHEETS	SHEET NO.
64	82-(5,6,7)PP-1	ST. CLAIR	14	13
CONTRACT NO. 76R48				
ILLINOIS FED. AID PROJECT				

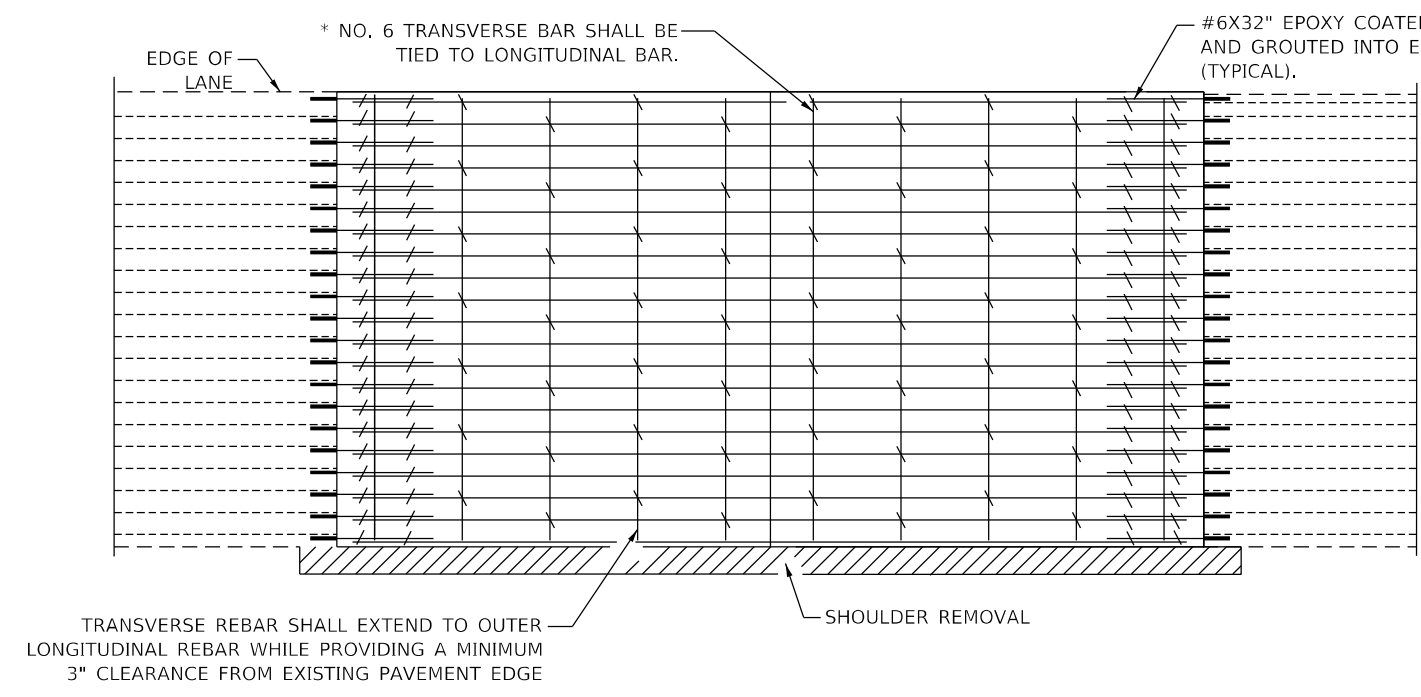

PAVEMENT REINFORCEMENT DETAIL

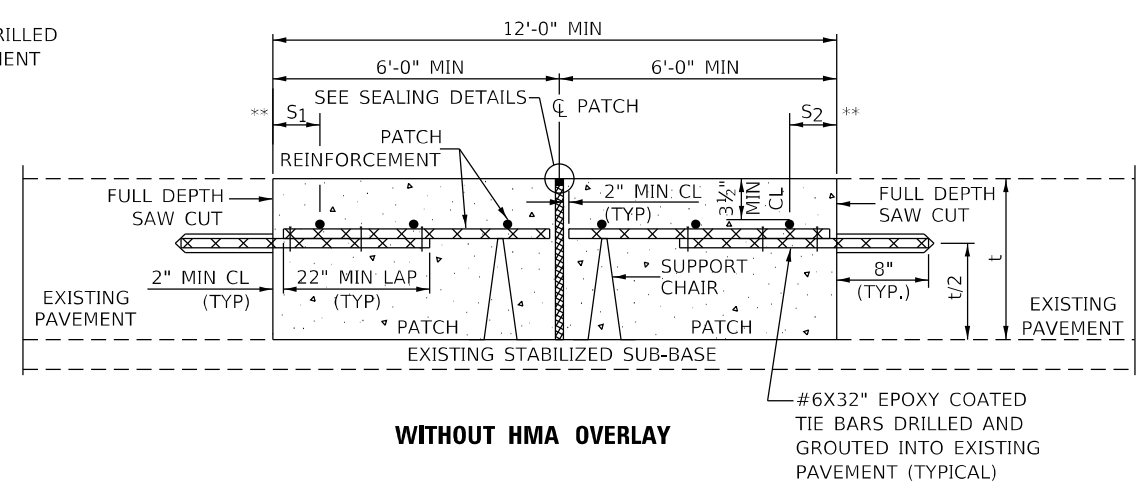

WITHOUT HMA OVERLAY

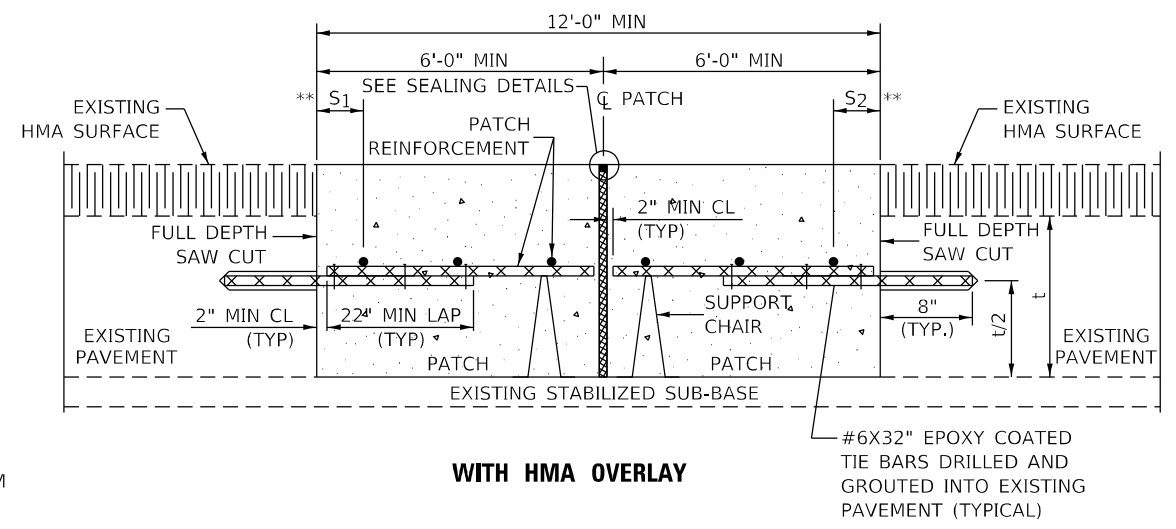

WITH HMA OVERLAY

CLASS A PATCH WITH EXPANSION JOINT

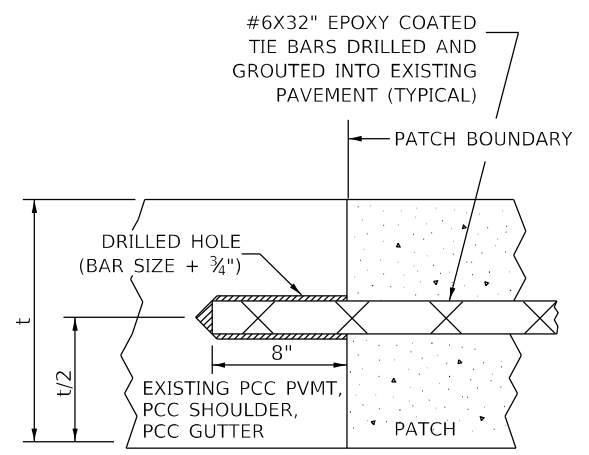

LONGITUDINAL CONSTRUCTION JOINT

PATCHES MORE THAN 20' IN LENGTH SHALL BE TIED TO ADJACENT PAVEMENT, PCC SHOULDERS OR PCC CURB AND GUTTER WITH #6x32" EPOXY COATED TIE BARS AT 36" CENTERS.

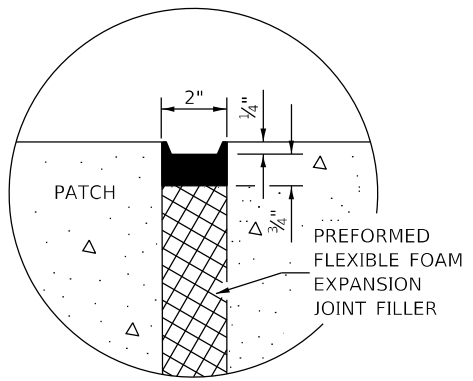

SEALING DETAIL

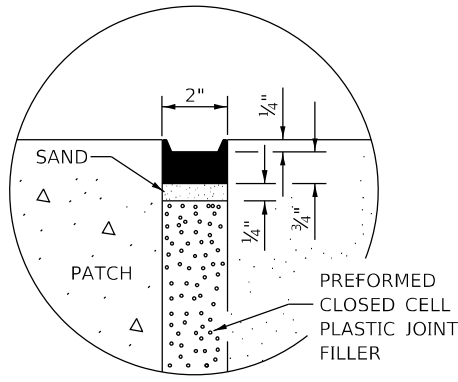

SEALING DETAIL

- NOTES:**
- EXISTING LONGITUDINAL REINFORCEMENT SPACING; $\pm 6\frac{1}{2}$ ".
 - SPACING OF NEW LONGITUDINAL REINFORCEMENT AND NEW LONGITUDINAL TIE BARS SHALL MATCH SPACING OF EXISTING REINFORCEMENT AND SHALL BE TIED TOGETHER WITH A MINIMUM OF TWO TIES PER BAR.
 - SUPPORT CHAIRS SHALL BE REQUIRED WHENEVER PATCH LENGTH EXCEEDS 6'-0"
 - * EVERY THIRD INTERSECTION MUST BE TIED, WHEN THE MINIMUM CLEARANCE CANNOT BE OBTAINED WITH THE TRANSVERSE REBAR ON TOP, THEN THE TRANSVERSE REBAR SHALL BE TIED TO THE BOTTOM OF THE LONGITUDINAL REBAR.
 - ** VARIABLES WHERE S_1 AND S_2 ARE $2\frac{1}{2}$ " MIN. AND 12" MAX.

MODEL: Default
FILE: N:\MISC_Plan\pilot\dot\Documents\DOT Office\Dir\drct_8\Project\DOT76R48\CADD\DATA\CADD\Sheet\DOT76R48-shc-detaillk.com

USER NAME = Brandon,Humphreys	DESIGNED -	REVISED -
	DRAWN -	REVISED -
PLOT SCALE = 40,0000 */ in.	CHECKED -	REVISED -
PLOT DATE = 12/21/2022	DATE -	REVISED -

**STATE OF ILLINOIS
DEPARTMENT OF TRANSPORTATION**

CLASS A PATCHING (SPECIAL)

SCALE: N/A SHEET 2 OF 2 SHEETS STA. TO STA.

F.A.I. RTE.	SECTION	COUNTY	TOTAL SHEETS	SHEET NO.
64	82-(5,6,7)PP-1	ST. CLAIR	14	14
CONTRACT NO. 76R48				
ILLINOIS FED. AID PROJECT				